

FAP NO.	SECTION	COUNTY	TOTAL SHEETS	SHEET NO.
338	(113 & 114) R-5	WILL	525	217
STA.	TO STA.			
FED. ROAD DIST. NO.	ILLINOIS	FAP 338 (IL RTE. 59)		

DATE	BY
DATE	BY
DATE	BY

DATE	BY
DATE	BY
DATE	BY

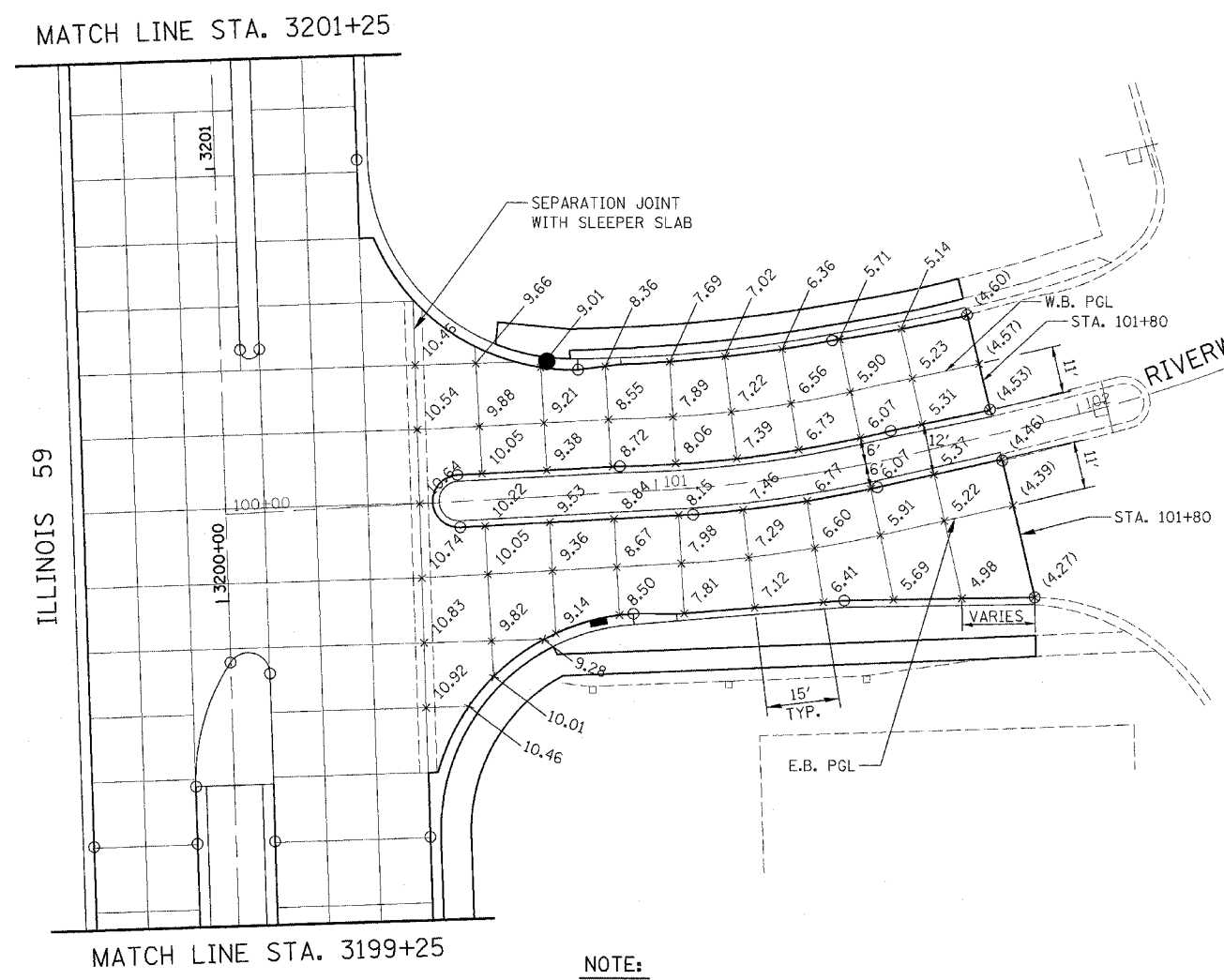

**NOTE:**  
SEPARATION JOINT WITH SLEEPER SLAB SHALL BE CONSTRUCTED IN ACCORDANCE WITH IDOT DISTRICT 1 DETAIL BD-52.

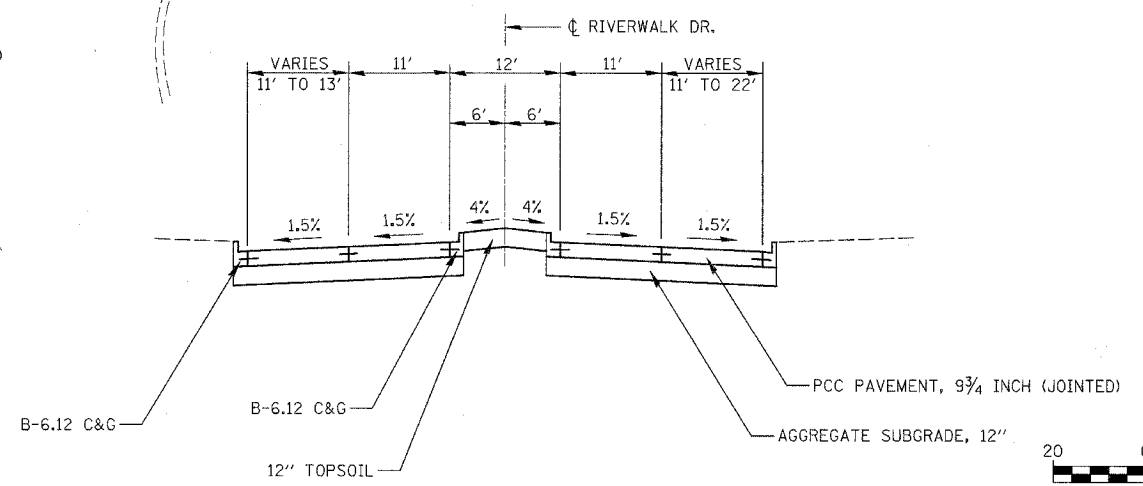
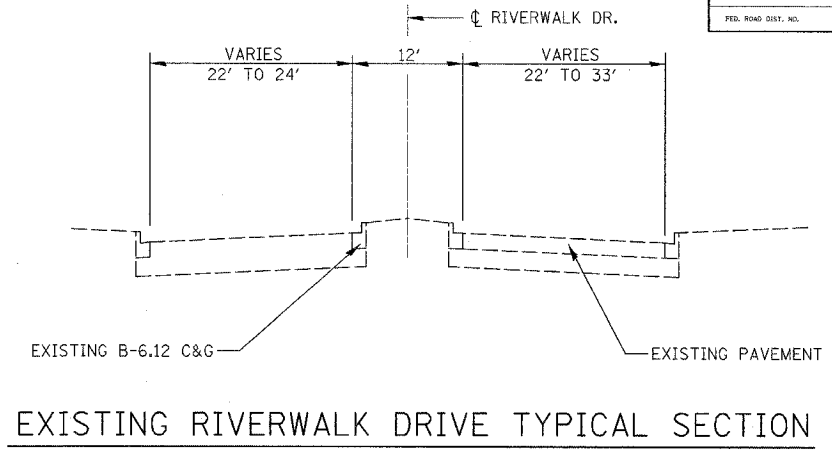

**NOTE:**  
-EL 9.83 = EL 609.83

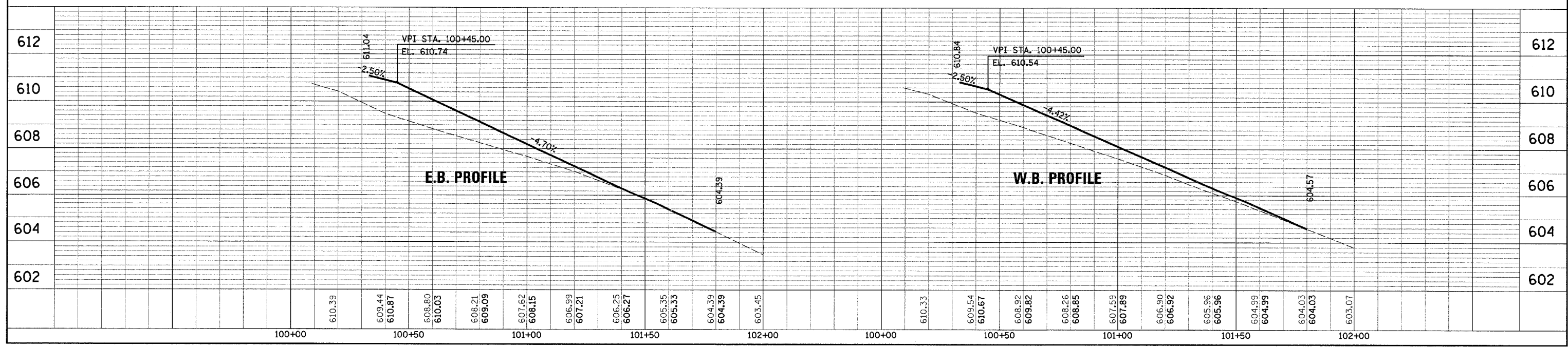
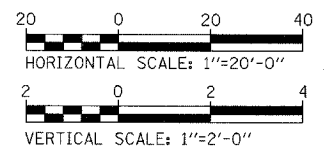

**INTERSECTION DETAILS - RIVERWALK DRIVE**