

FAP NO.	SECTION	COUNTY	TOTAL SHEETS	SHEET NO.
338	(113 & 114) R-5	WILL	525	226
STA.	TO STA.			
FED. ROAD DIST. NO.	ALIAS	FAP 338 (IL RTE. 59)		

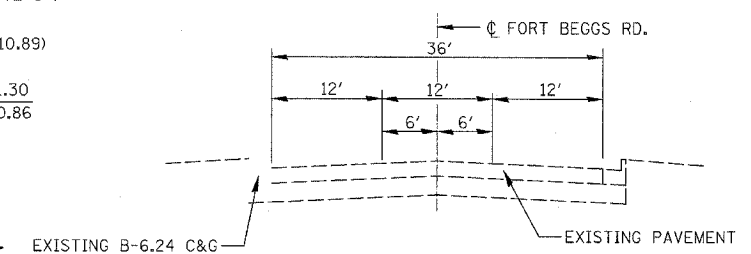

EXISTING FORT BEGGS DRIVE TYPICAL SECTION

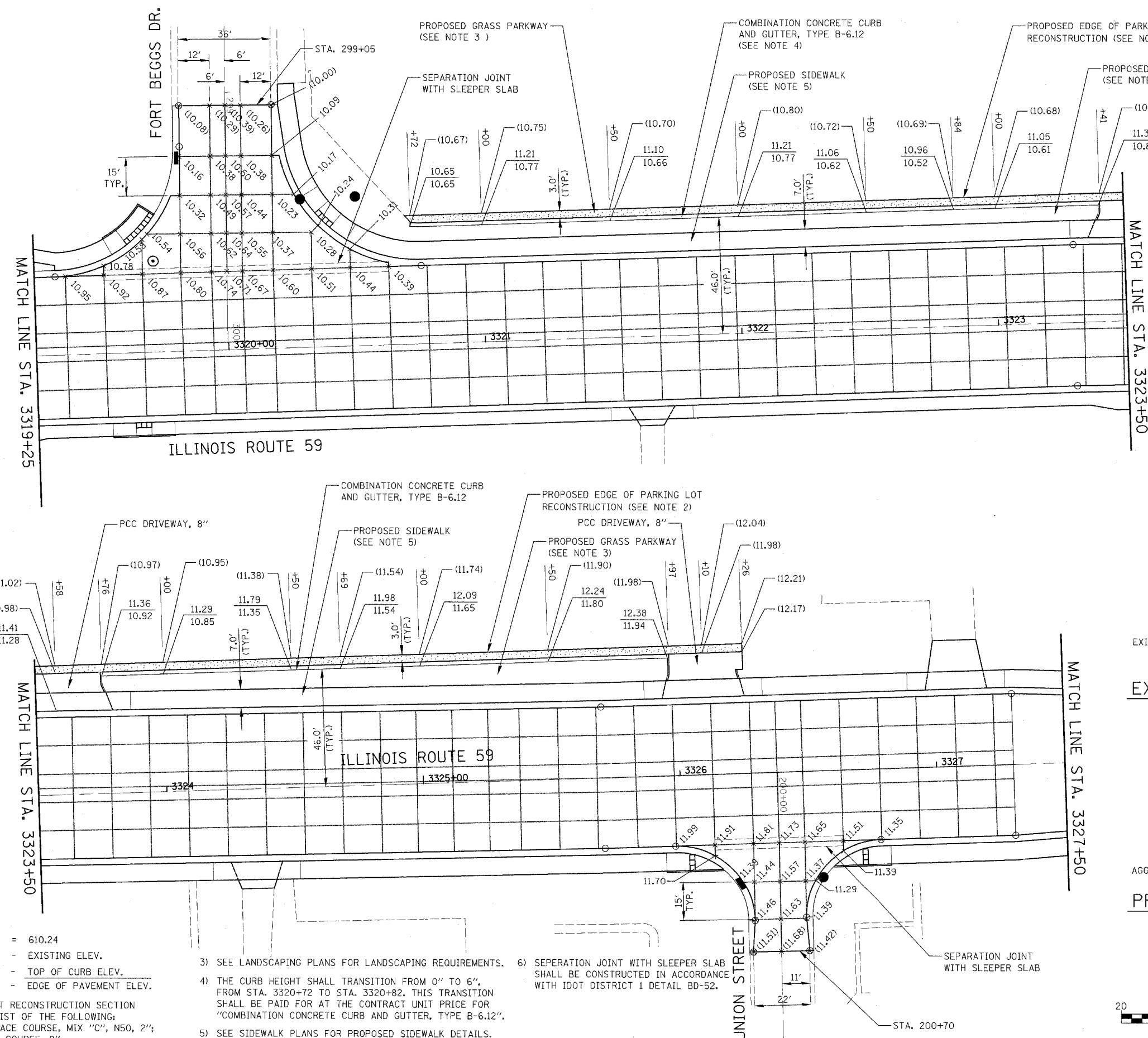
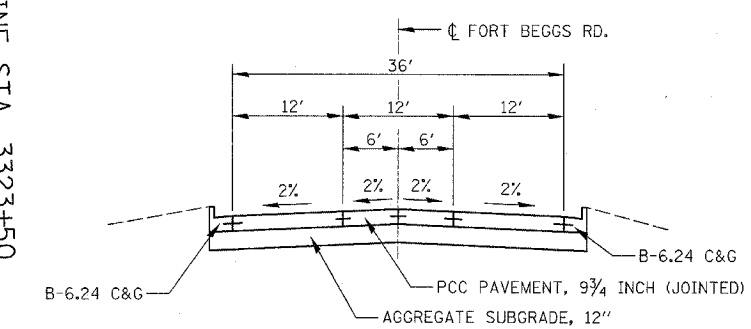

PROPOSED FORT BEGGS DRIVE TYPICAL SECTION

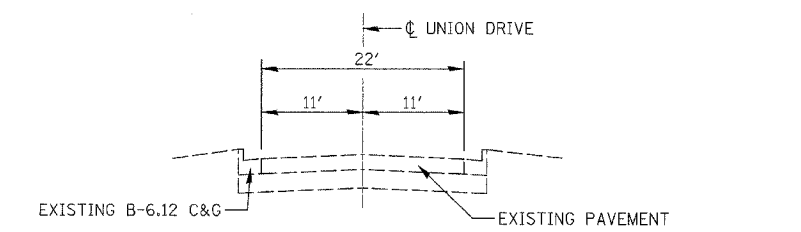

EXISTING UNION STREET TYPICAL SECTION

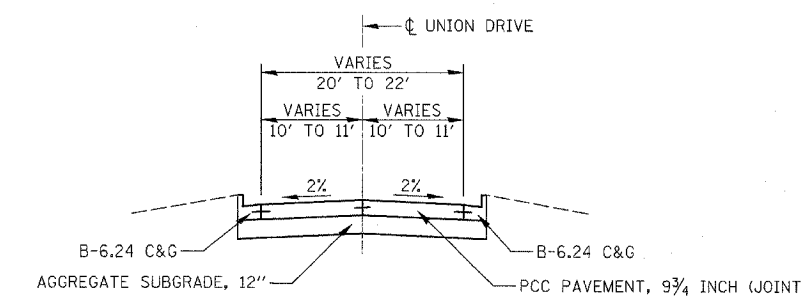

PROPOSED UNION STREET TYPICAL SECTION

- NOTES:
- 1) ELEV. 10.24 = 610.24
 - (10.75) - EXISTING ELEV.
 - 11.93 - TOP OF CURB ELEV.
 - 11.81 - EDGE OF PAVEMENT ELEV.

- 2) PARKING LOT RECONSTRUCTION SECTION SHALL CONSIST OF THE FOLLOWING:
 - HMA SURFACE COURSE, MIX "C", N50, 2";
 - HMA BASE COURSE, 8"
- 3) SEE LANDSCAPING PLANS FOR LANDSCAPING REQUIREMENTS.
- 4) THE CURB HEIGHT SHALL TRANSITION FROM 0" TO 6", FROM STA. 3320+72 TO STA. 3320+82. THIS TRANSITION SHALL BE PAID FOR AT THE CONTRACT UNIT PRICE FOR "COMBINATION CONCRETE CURB AND GUTTER, TYPE B-6.12".
- 5) SEE SIDEWALK PLANS FOR PROPOSED SIDEWALK DETAILS.
- 6) SEPERATION JOINT WITH SLEEPER SLAB SHALL BE CONSTRUCTED IN ACCORDANCE WITH IDOT DISTRICT 1 DETAIL BD-52.

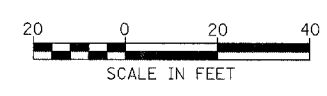

ILLINOIS DEPARTMENT OF TRANSPORTATION
 DISTRICT NO. 1 SCHAUMBURG
 INTERSECTION DETAILS
 FORT BEGGS DRIVE &
 UNION STREET

SCALE AS SHOWN
 DATE MARCH 18, 2008

DRAWN BY RTA
 CHECKED BY JCM/PO