

CONTRACT NO. 62417

SECTION	COUNTY	TOTAL SHEETS	SHEET NO.
338 (113 & 114) R-5	WILL	525	232
STA. 3260+00		TO STA. 3274+00	
FED. ROAD DIST. NO.		ILLINOIS	FAP 338 (IL RTE. 59)

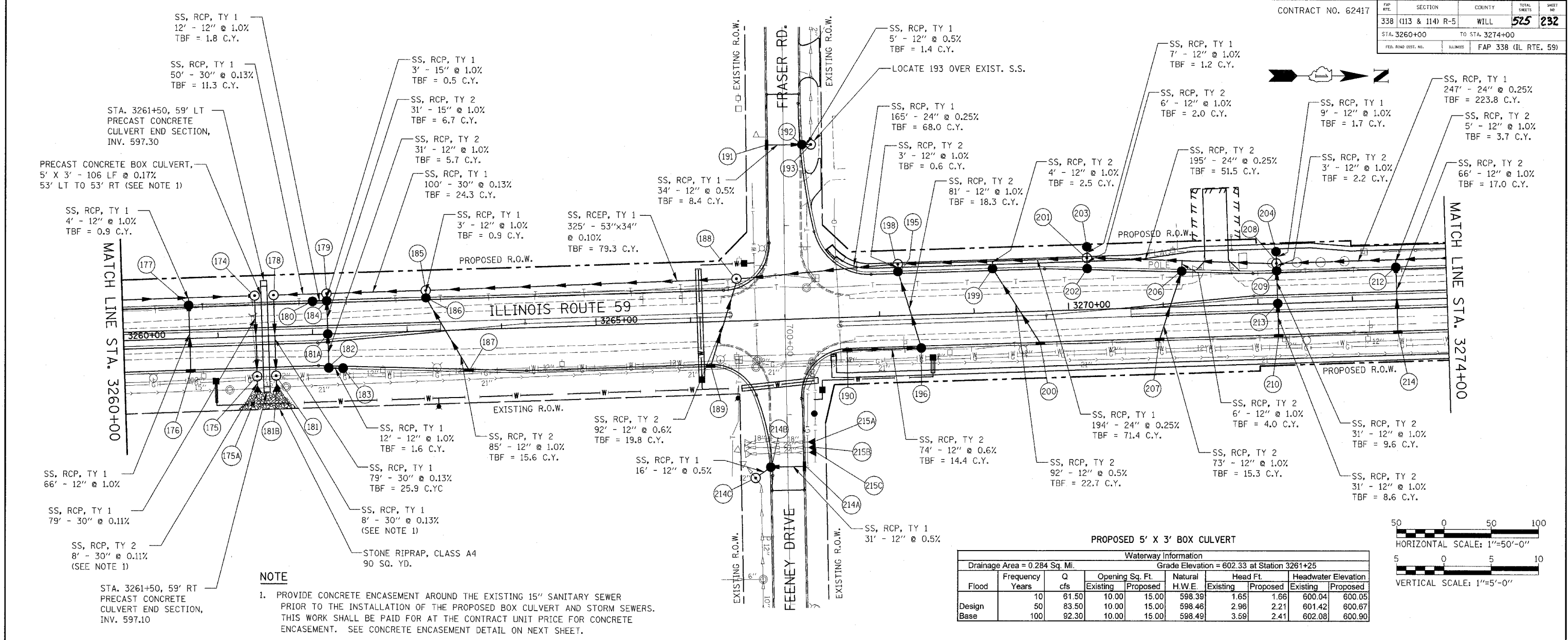

NOTE
 1. PROVIDE CONCRETE ENCASEMENT AROUND THE EXISTING 15" SANITARY SEWER PRIOR TO THE INSTALLATION OF THE PROPOSED BOX CULVERT AND STORM SEWERS. THIS WORK SHALL BE PAID FOR AT THE CONTRACT UNIT PRICE FOR CONCRETE ENCASEMENT. SEE CONCRETE ENCASEMENT DETAIL ON NEXT SHEET.

PROPOSED 5' X 3' BOX CULVERT

Drainage Area = 0.284 Sq. Mi.		Waterway Information							
		Grade Elevation = 602.33 at Station 3261+25							
Flood	Frequency Years	Q cfs	Opening Sq. Ft.		Natural H.W.E.		Headwater Elevation		
			Existing	Proposed	Existing	Proposed	Existing	Proposed	
Design	50	83.50	10.00	15.00	598.46	2.96	2.21	601.42	600.67
Base	100	92.30	10.00	15.00	598.49	3.59	2.41	602.08	600.90

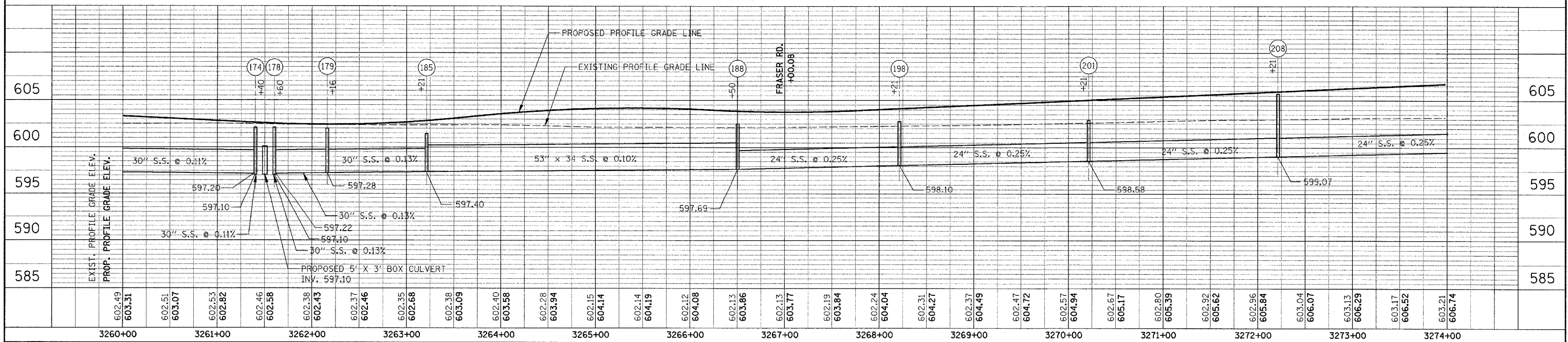
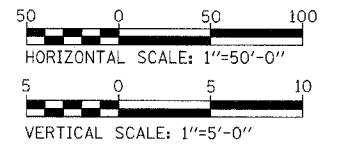

DRAINAGE PLAN /PROFILE - ILLINOIS ROUTE 59