

FAP RTE.	SECTION	COUNTY	TOTAL SHEETS	SHEET NO.
338	(113 & 114) R-5	WILL	535	247
STA.		TO STA.		
FED. ROAD DIST. NO.		BLANKS	FAP 338 (IL RTE. 59)	

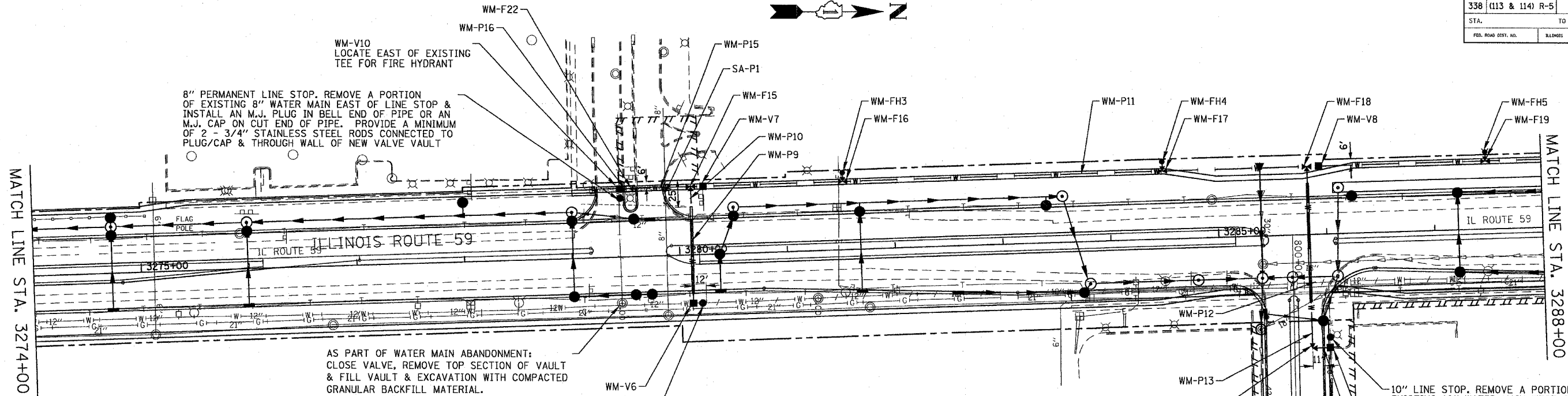

**WATER MAIN PIPE**

- WM-P8  
NOT USED
- WM-P9  
80 L.F. OF 12" WATER MAIN (RJT)  
INSIDE 24" CASING PIPE  
A MINIMUM OF 60 L.F. OF CASING TO BE INSTALLED BY BORING OR RAMMING, REMAINDER OF CASING CAN BE INSTALLED IN OPEN-CUT TRENCH.
- WM-P10  
30 L.F. OF 12" WATER MAIN (RJT)
- WM-P11  
790 L.F. OF 12" WATER MAIN
- WM-P12  
110 L.F. OF 12" WATER MAIN (RJT)  
INSIDE 24" CASING PIPE  
A MINIMUM OF 60 L.F. OF CASING TO BE INSTALLED BY BORING OR RAMMING, REMAINDER OF CASING CAN BE INSTALLED IN OPEN-CUT TRENCH.
- WM-P13  
55 L.F. OF 12" WATER MAIN (RJT)
- WM-P14  
22 L.F. OF 10" WATER MAIN (RJT)
- WM-P15  
60 L.F. OF 12" WATER MAIN
- WM-P16  
5 L.F. OF 8" WATER MAIN (RJT)
- WM-P17  
NOT USED

12" LINE STOP. REMOVE A PORTION OF EXISTING 12" WATER MAIN NORTH OF LINE STOP & INSTALL AN M.J. PLUG IN BELL END OF PIPE OR AN M.J. CAP ON CUT END OF PIPE. PROVIDE A MINIMUM OF 2 - 3/4" STAINLESS STEEL RODS CONNECTED TO PLUG/CAP & THROUGH WALL OF NEW VALVE VAULT.

**SANITARY SEWER PIPE**

SA-P1  
APPROXIMATELY 22 L.F. OF 8" SANITARY SEWER, BETWEEN 5.5 & 6 FEET DEEP. CONSTRUCT WITH WATER MAIN QUALITY P.V.C. PIPE. CONNECT TO EXISTING SANITARY SEWER PIPES AT BOTH ENDS OF SA-P1. INSTALL NEW PIPE WITH A UNIFORM SLOPE TO MATCH EXISTING SANITARY SEWER INVERT ELEVATIONS & SLOPE.

**WATER MAIN FITTINGS (RJT)**

- WM-F14  
NOT USED
- WM-F15  
12" x 12" TEE
- WM-F16  
12" x 6" TEE
- WM-F17  
12" x 6" TEE
- WM-F18  
12" x 12" TEE
- WM-F19  
12" x 6" TEE
- WM-F20  
12" x 10" REDUCER
- WM-F21  
10" - 90° BEND
- WM-F22  
12" x 8" REDUCER
- WM-F23  
NOT USED

**WATER MAIN VALVES**

- WM-V6  
12" x 12" TAPPING SLEEVE & 12" TAPPING VALVE WITH CONCRETE THRUST BLOCK IN 6 FOOT DIAMETER VALVE VAULT.
- WM-V7  
12" GATE VALVE IN 5 FOOT DIAMETER VALVE VAULT
- WM-V8  
12" GATE VALVE IN 5 FOOT DIAMETER VALVE VAULT
- WM-V9  
10" x 10" TAPPING SLEEVE & 10" TAPPING VALVE WITH CONCRETE THRUST BLOCK IN 5 FOOT DIAMETER VALVE VAULT.
- WM-V10  
8" x 8" TAPPING SLEEVE & 8" TAPPING VALVE WITH CONCRETE THRUST BLOCK IN 5 FOOT DIAMETER VALVE VAULT.
- WM-V11  
NOT USED

**FIRE HYDRANTS**

- WM-FH3  
FIRE HYDRANT WITH 3 L.F. OF 6" D.I. LEADER PIPE
- WM-FH4  
FIRE HYDRANT WITH 3 L.F. OF 6" D.I. LEADER PIPE
- WM-FH5  
FIRE HYDRANT WITH 3 L.F. OF 6" D.I. LEADER PIPE  
INSTALL FIRE HYDRANT 2 FEET WEST OF WEST RIGHT-OF-WAY LINE.
- WM-FH6  
NOT USED

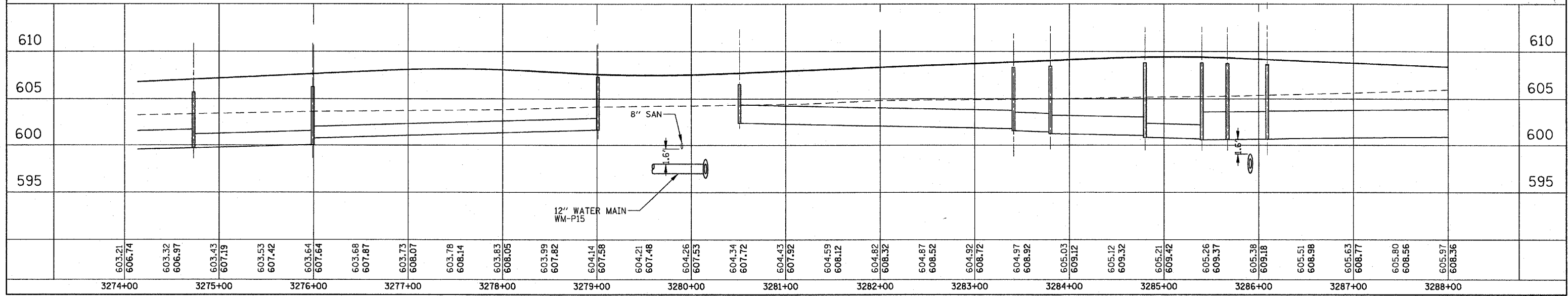
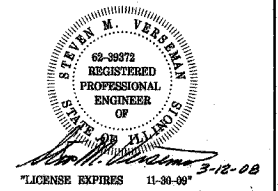
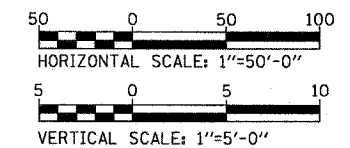

**WATER MAIN AND SANITARY SEWER REPLACEMENT PLAN /PROFILE - ILLINOIS ROUTE 59**