

FAP NO.	SECTION	COUNTY	TOTAL SHEETS	SHEET NO.
338	(113 & 114) R-5	WILL	525	315
STA. 3274+00	TO STA. 3288+00			
FED. ROAD DIST. NO.	ILLINOIS	FAP 338 (IL RTE. 59)		

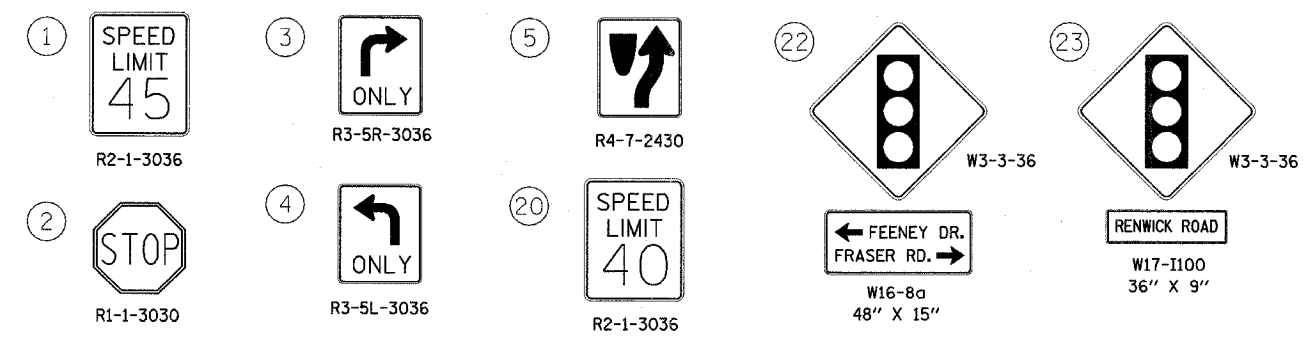

- NOTES:**
- PAVEMENT MARKINGS AND RAISED REFLECTIVE PAVEMENT MARKINGS SHALL BE PLACED IN ACCORDANCE WITH IDOT DISTRICT 1 DETAILS TC-11 AND TC-13.
 - SIGN LOCATIONS MAY VARY BASED ON FIELD CONDITIONS.
 - EXISTING SIGN TO BE REMOVED AND RE-ERECTED.
 - SIGN SHALL BE MOUNTED ON A TELESCOPING STEEL SIGN SUPPORT IN ACCORDANCE WITH HIGHWAY STANDARDS 720001 AND 728001.

ILLINOIS DEPARTMENT OF TRANSPORTATION
 DISTRICT NO. 1 SCHAUMBURG
**PAVEMENT MARKING
 AND SIGNING PLANS**

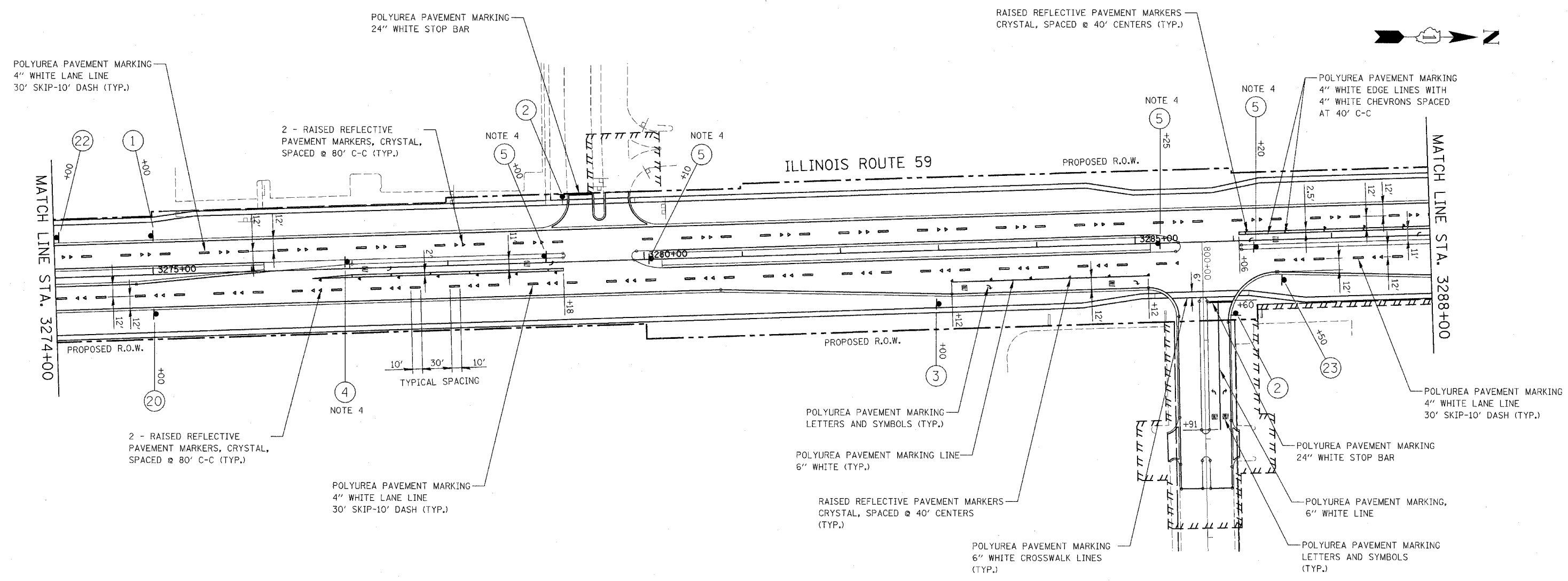