

CROSS SECTION  
 SURVEYED GRADES CHECKED  
 SECTION NO. \_\_\_\_\_  
 DATE \_\_\_\_\_  
 BY \_\_\_\_\_  
 NOTE BOOK NO. \_\_\_\_\_  
 DATE NOTED \_\_\_\_\_  
 SURVEYOR'S NOTATION CHRG \_\_\_\_\_

CROSS SECTION  
 SURVEYED ALIGNMENT CHECKED  
 SECTION NO. \_\_\_\_\_  
 DATE \_\_\_\_\_  
 BY \_\_\_\_\_  
 NOTE BOOK NO. \_\_\_\_\_  
 DATE NOTED \_\_\_\_\_  
 SURVEYOR'S NOTATION CHRG \_\_\_\_\_

PA. INT.	SECTION	COUNTY	TOTAL SHEETS	SHEET NO.
	(113 & 114) R-5	WILL.	525	448
STA. 3300+00	TO STA. 3203+03			
FED. ROAD DIST. NO.	ILLINOIS	FAP 338 (IL RTE. 59)		
CONTRACT NO. 62417				

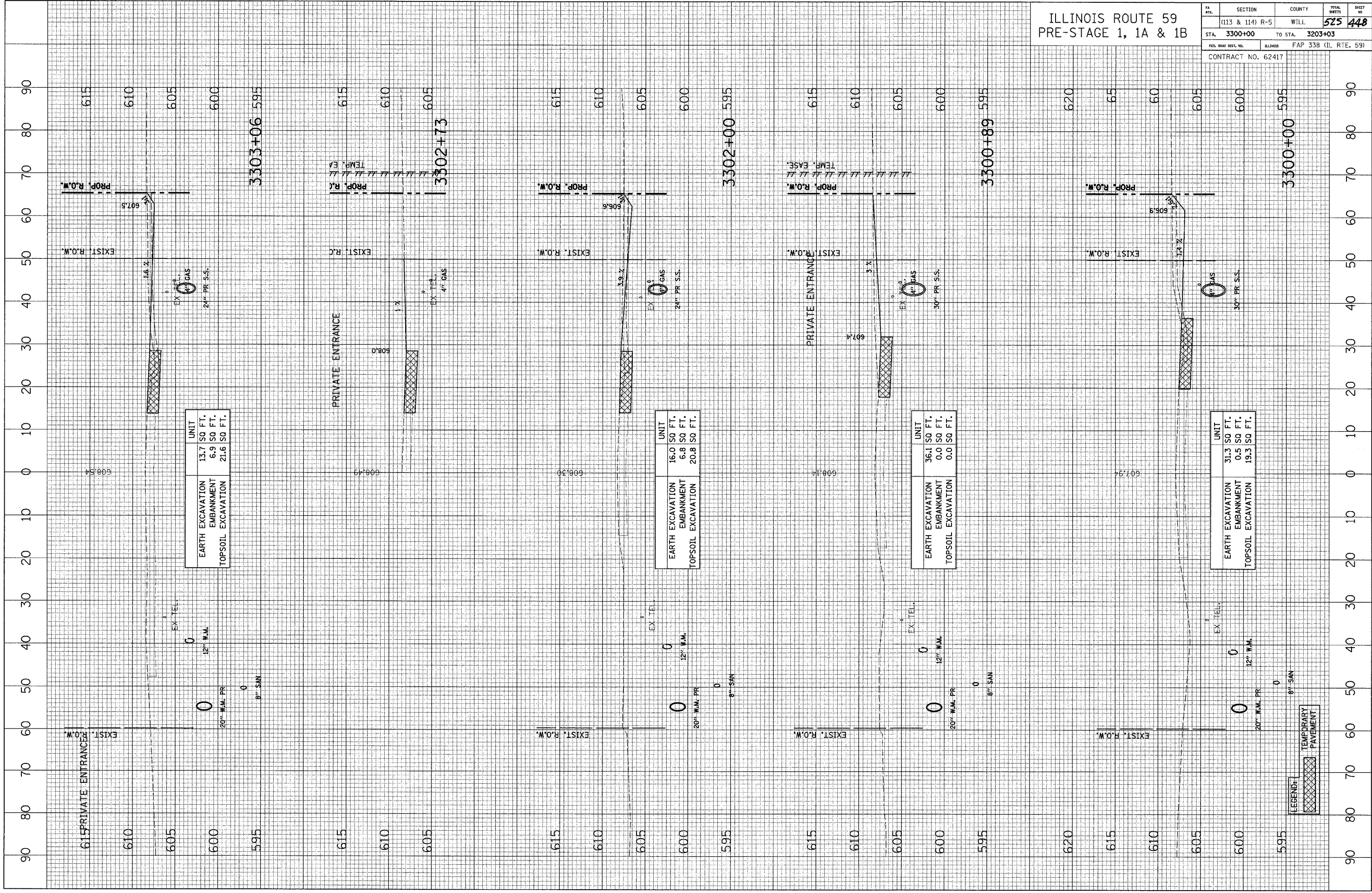

	UNIT
EARTH EXCAVATION	13.7 SQ FT.
EMBANKMENT	6.9 SQ FT.
TOPSOIL EXCAVATION	21.6 SQ FT.

	UNIT
EARTH EXCAVATION	16.0 SQ FT.
EMBANKMENT	6.8 SQ FT.
TOPSOIL EXCAVATION	20.8 SQ FT.

	UNIT
EARTH EXCAVATION	36.1 SQ FT.
EMBANKMENT	0.0 SQ FT.
TOPSOIL EXCAVATION	0.0 SQ FT.

	UNIT
EARTH EXCAVATION	31.3 SQ FT.
EMBANKMENT	0.5 SQ FT.
TOPSOIL EXCAVATION	19.3 SQ FT.

LEGEND:  

 TEMPORARY PAVEMENT