

\*REF: top003  
\*REF: pp03

F.A.P. RTE.	SECTION	COUNTY	TOTAL SHEETS	SHEET NO.
345	BR-1-N-1	COOK	196	20
STA. 79+00=228+91.7		TO STA. 92+35		
FED. ROAD DIST. NO. 1 ILLINOIS FED. AID PROJECT				

CONTRACT NO. 62617

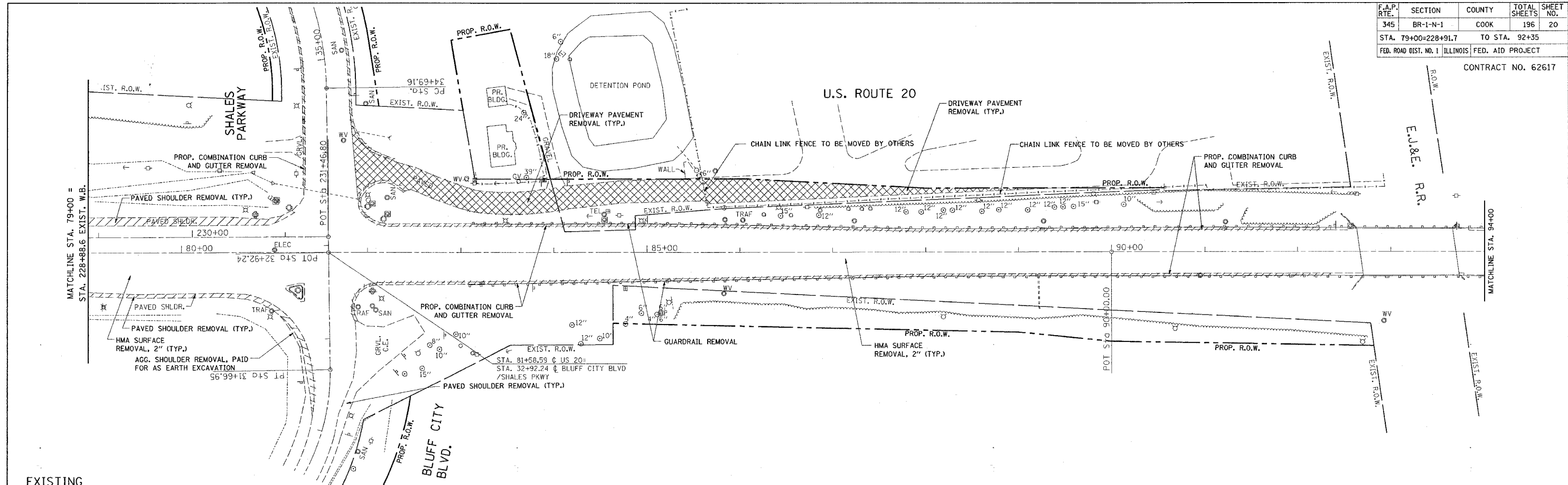

EXISTING

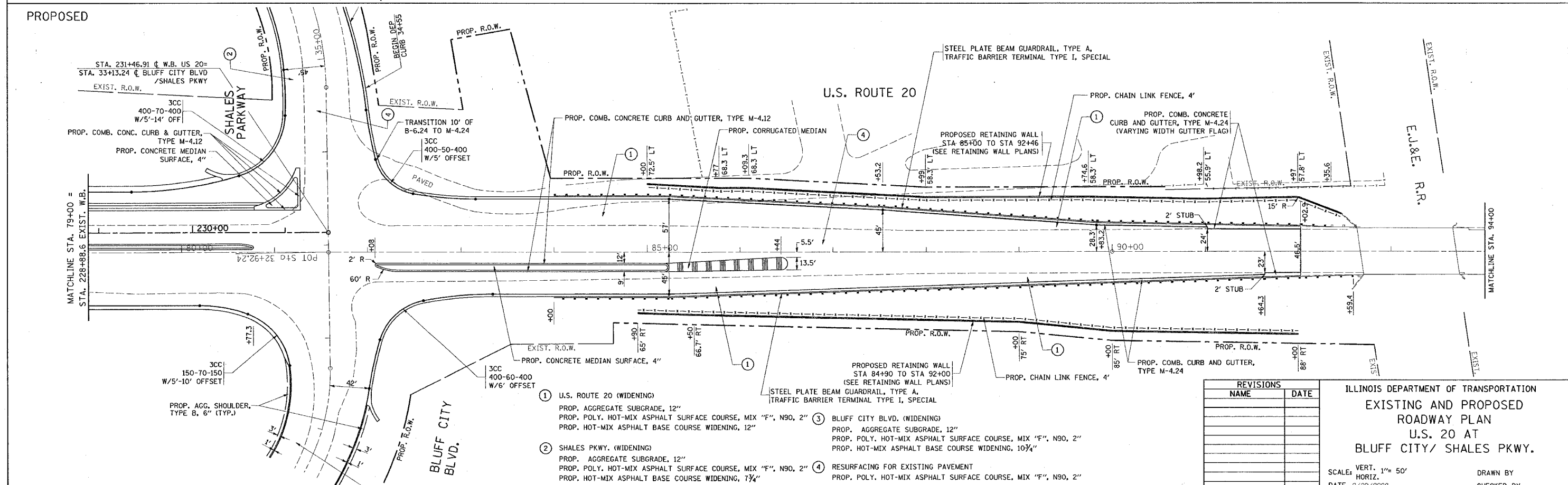

PROPOSED

- ① U.S. ROUTE 20 (WIDENING)  
PROP. AGGREGATE SUBGRADE, 12"  
PROP. POLY. HOT-MIX ASPHALT SURFACE COURSE, MIX "F", N90, 2"  
PROP. HOT-MIX ASPHALT BASE COURSE WIDENING, 12"
- ② SHALES PKWY. (WIDENING)  
PROP. AGGREGATE SUBGRADE, 12"  
PROP. POLY. HOT-MIX ASPHALT SURFACE COURSE, MIX "F", N90, 2"  
PROP. HOT-MIX ASPHALT BASE COURSE WIDENING, 7 3/4"
- ③ BLUFF CITY BLVD. (WIDENING)  
PROP. AGGREGATE SUBGRADE, 12"  
PROP. POLY. HOT-MIX ASPHALT SURFACE COURSE, MIX "F", N90, 2"  
PROP. HOT-MIX ASPHALT BASE COURSE WIDENING, 10 3/4"
- ④ RESURFACING FOR EXISTING PAVEMENT  
PROP. POLY. HOT-MIX ASPHALT SURFACE COURSE, MIX "F", N90, 2"

REVISIONS	
NAME	DATE

ILLINOIS DEPARTMENT OF TRANSPORTATION  
EXISTING AND PROPOSED  
ROADWAY PLAN  
U.S. 20 AT  
BLUFF CITY/ SHALES PKWY.

SCALE: VERT. 1"= 50'  
HORIZ. 1"= 100'  
DATE 2/29/2008

DRAWN BY  
CHECKED BY