

*REF-prof01
*REF-prof02

CONTRACT NO.: 62617			
F.A.P. RTE.	SECTION	COUNTY	TOTAL SHEETS
345	BR-1-N-1	Cook	196
STA. 201+00		TO STA. 231+00	
FED. ROAD DIST. NO. 1 ILLINOIS FED. AID PROJECT			

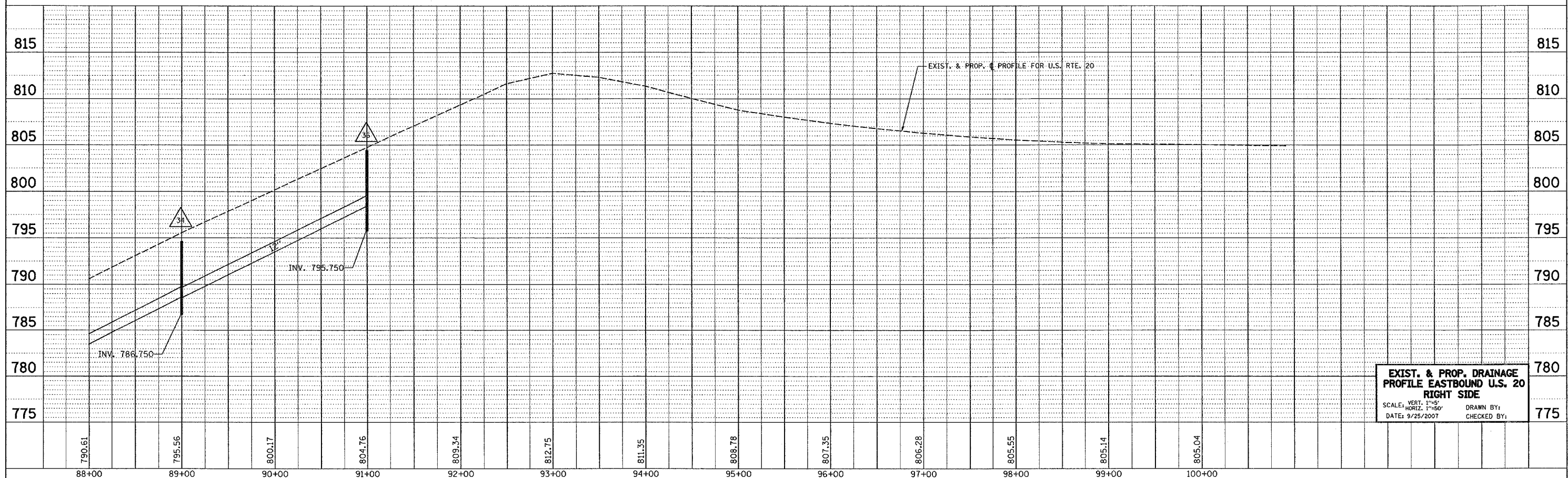
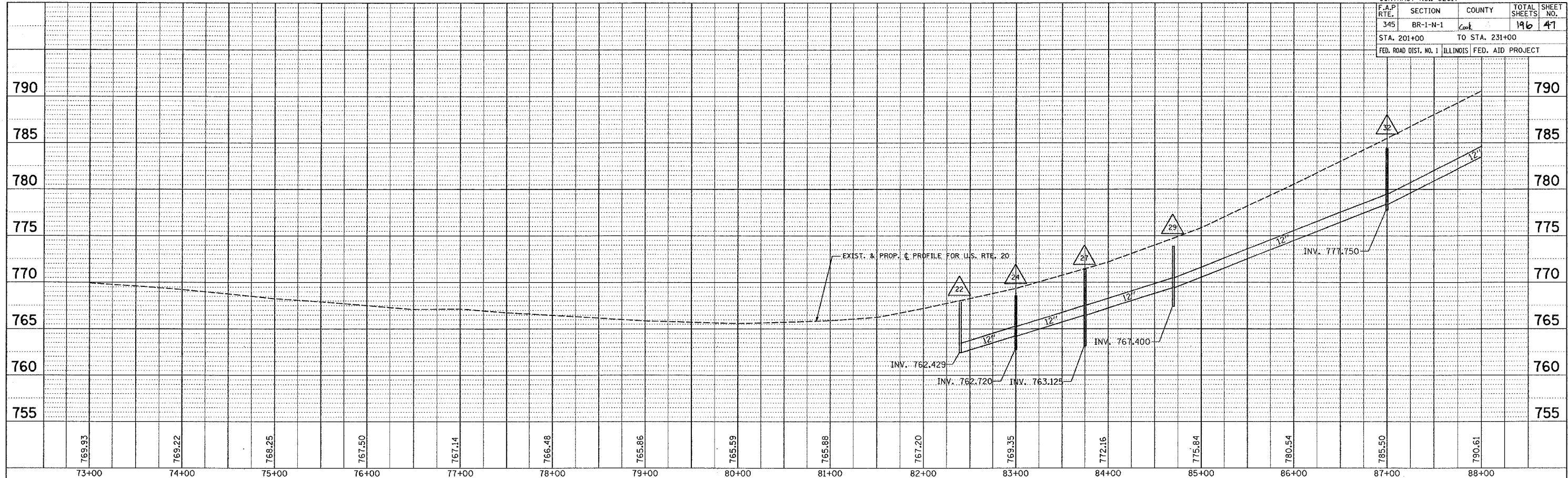

EXIST. & PROP. DRAINAGE PROFILE EASTBOUND U.S. 20 RIGHT SIDE
 VERT. SCALE: 1"=5'
 HORIZ. SCALE: 1"=50'
 DATE: 9/25/2007
 DRAWN BY:
 CHECKED BY: