

CONTRACT NO.				
F.A. RTE.	SECTION	COUNTY	TOTAL SHEETS	SHEET NO.
345	82-1-N-1	COOK	196	101
STA.		TO STA.		
FED. ROAD DIST. NO.		ILLINOIS FED. AID PROJECT		

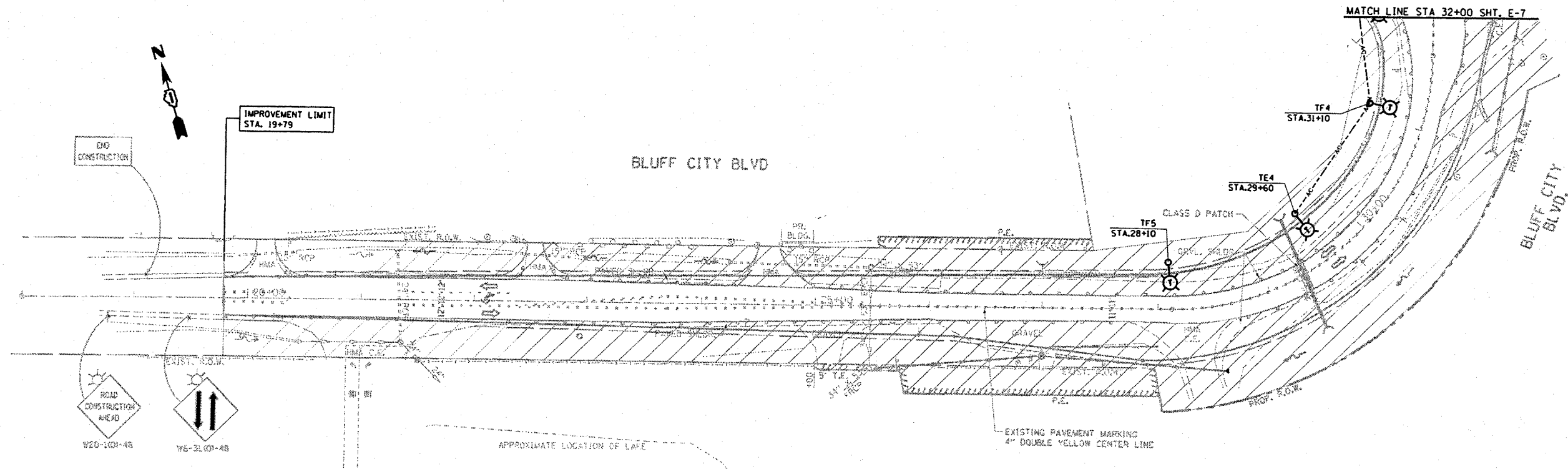

LEGEND

- SIGN
- DRUMS WITH STEADY BURN MONODIRECTIONAL LIGHT
- 50' C-C TANGENTS
- 25' C-C LANE SHIFTS & TAPERS
- 10' C-C RADII (TYP)
- WORK AREA

REVISIONS	
NAME	DATE

ILLINOIS DEPARTMENT OF TRANSPORTATION
STAGE I CONSTRUCTION LIGHTING PLAN 4
U.S. RTE. 20 @ SHALES PARKWAY AND BLUFF CITY BLVD.
 SCALE: VERT. 1"=50'
 HORIZ.
 DATE 3/25/2008
 DRAWN BY AC
 CHECKED BY MEA/MJ

PLOT DATE = 3/25/2008
 FILE NAME = c:\projects\113703\sh_stage.dgn
 PLOT SCALE = 1/8"=1'-0" / IN.
 USER NAME = goglianob