

LEGEND:

- ① PROPOSED THERMOPLASTIC PAVEMENT MARKING LINE 4", SKIP DASH @ 30' SKIP AND 10' DASH, WHITE (TYP.)
- ② PROPOSED THERMOPLASTIC PAVEMENT MARKING LINE 4", DOUBLE LINE @ 11" C-C, YELLOW (TYP.)
- ③ PROPOSED THERMOPLASTIC PAVEMENT MARKING LINE 6", TURN LANE, WHITE (TYP.)
- ④ PROPOSED THERMOPLASTIC PAVEMENT MARKING LINE 12", DIAGONALS @ 20' C-C, YELLOW (TYP.)
- ⑤ PROPOSED THERMOPLASTIC PAVEMENT MARKING LETTERS AND SYMBOLS, WHITE (TYP.)
- ⑥ PROPOSED THERMOPLASTIC PAVEMENT MARKING LINE 24", STOP BAR, WHITE (TYP.)
- ⑦ PROPOSED THERMOPLASTIC PAVEMENT MARKING LINE 6", CROSSWALK, WHITE (TYP.)
- ⑧ PROPOSED THERMOPLASTIC PAVEMENT MARKING LINE 12", SCHOOL CROSSWALK, WHITE (TYP.)
- ⑨ PROPOSED THERMOPLASTIC PAVEMENT MARKING LINE 6", DOTTED LINES @ 2' LINE AND 6' SPACE, WHITE (TYP.)

NOTE:

LIMIT OF RESURFACING ON SIDE ROADS AND STREETS SHALL BE TO THE RADIUS OF RETURN OR AS DIRECTED BY THE ENGINEER.

ALL PERMANENT PAVEMENT MARKINGS SHALL BE THERMOPLASTIC UNLESS OTHERWISE NOTED. SEE "DISTRICT ONE TYPICAL PAVEMENT MARKINGS" DETAIL (TC-13).

RAISED REFLECTIVE PAVEMENT MARKERS SHALL BE USED THROUGH THE IMPROVEMENT LIMITS. SEE "DISTRICT ONE TYPICAL APPLICATIONS RAISED REFLECTIVE PAVEMENT MARKERS" DETAIL (TC-11).

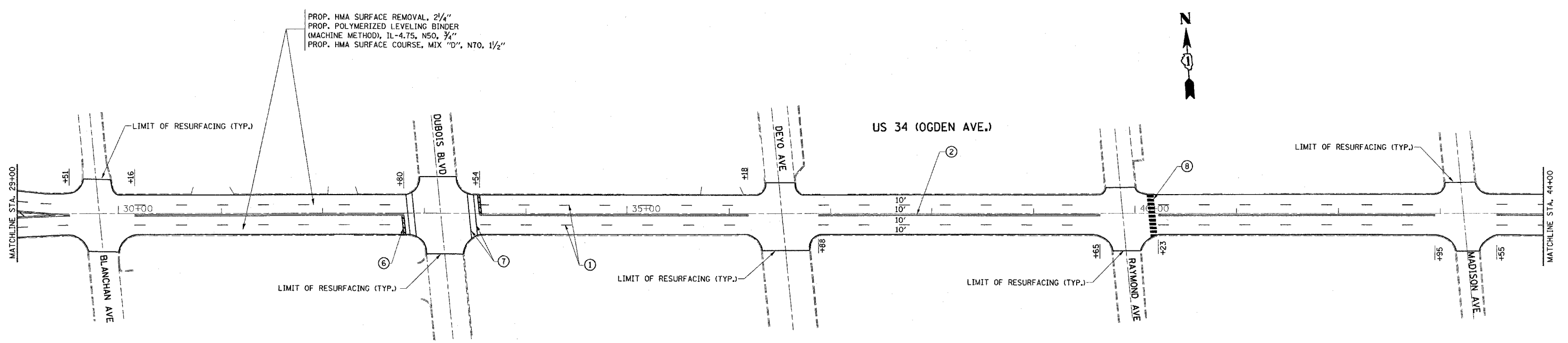

FILE NAME = c:\projects\dl04504\shurdaj.dgn	USER NAME = shuranjib	DESIGNED -	REVISED -	STATE OF ILLINOIS DEPARTMENT OF TRANSPORTATION	ROADWAY & PAVEMENT MARKING PLAN U.S. RTE. 34 (BN RAILROAD TO HARLEM AVE.)	F.A.P. RTE. 311	SECTION 2004-043 RS	COUNTY COOK	TOTAL SHEETS 30	SHEET NO. 6	
PLOT SCALE = 50,0000 1/4 IN.	CHECKED -	REVISED -	REVISED -		SCALE: 1"=50'	SHEET NO. 2 OF 7 SHEETS	STA. 15+00	TO STA. 44+00	CONTRACT NO. 62682		
PLOT DATE = 3/31/2008	DATE -	REVISED -	REVISED -		FED. ROAD DIST. NO. 1 ILLINOIS FED. AID PROJECT						