

F.A.P. RTE.	SECTION	COUNTY	TOTAL SHEETS	SHEET NO.
607	130 RS-3	WILL	17	1
FED. ROAD DIST. NO.	ILLINOIS	CONTRACT NO. 62787		

STATE OF ILLINOIS
DEPARTMENT OF TRANSPORTATION
DIVISION OF HIGHWAYS

PROPOSED HIGHWAY PLANS

FAP ROUTE 607/US 52 (TROY RD.)

SECTION: 130 RS-3

KENDALL CO. LINE TO RIVER RD.

RESURFACING (MAINTENANCE)

PROJECT: *ACNHF-0607(076)*

WILL COUNTY

C-91-256-04

FOR INDEX OF SHEETS, SEE SHEET NO. 2

PROJECT LOCATED
IN THE VILLAGE OF SHOREWOOD

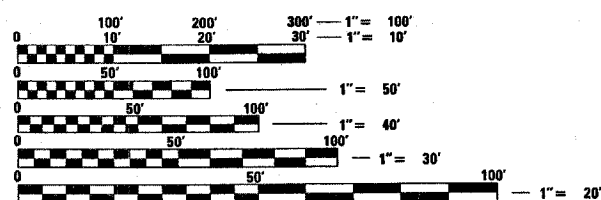
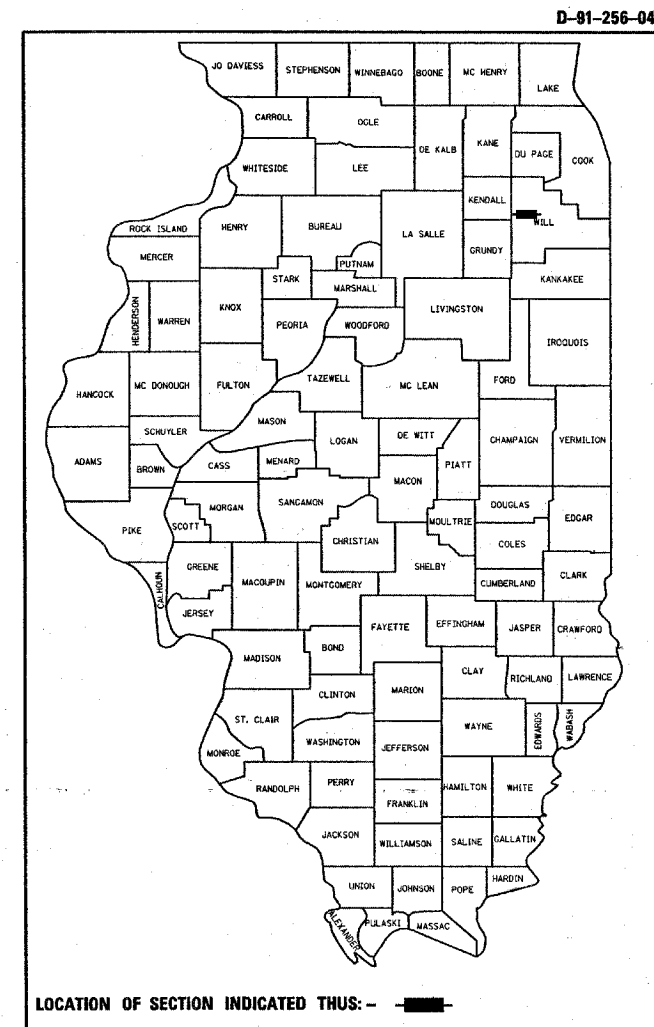

FULL SIZE PLANS HAVE BEEN PREPARED USING STANDARD ENGINEERING SCALES. REDUCED SIZED PLANS WILL NOT CONFORM TO STANDARD SCALES. IN MAKING MEASUREMENTS ON REDUCED PLANS, THE ABOVE SCALES MAY BE USED.

J.U.L.I.E.
JOINT UTILITY LOCATION INFORMATION FOR EXCAVATION
1-800-892-0123
OR 811

PROJECT ENGINEER - FRITZ GUILLAUME
PROJECT MANAGER - KEN ENG (847) 705-4247

CONTRACT NO. 62787

PROJECT BEGINS
STATION 493+16

OMISSION
STA 551+00 TO STA 551+15
STA 560+75 TO STA 574+65

PROJECT ENDS
STATION 600+47

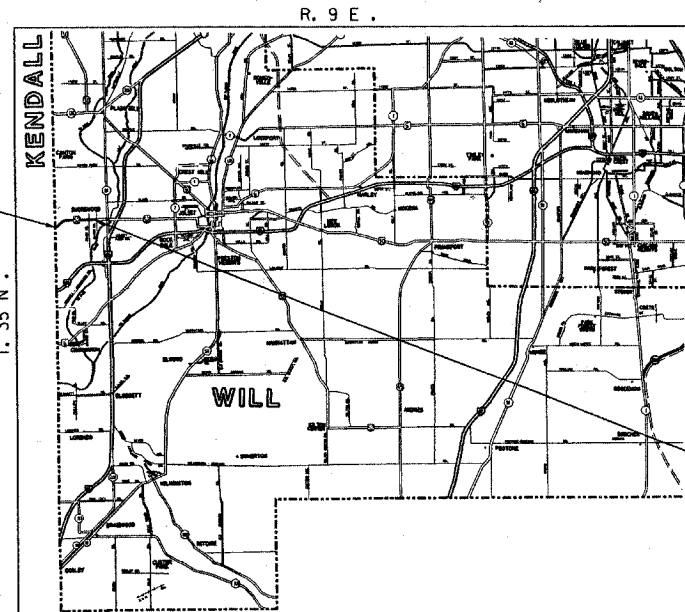

TRAFFIC DATA :
2001 ADT = 5900
POSTED SPEED LIMIT = 35-55 MPH

TROY TOWNSHIP

GROSS LENGTH OF PROJECT = 10,731 LIN. FT. = 2.03 MILES
NET LENGTH OF PROJECT = 9,326 LIN. FT. = 1.77 MILES

STATE OF ILLINOIS
DEPARTMENT OF TRANSPORTATION
DIVISION OF HIGHWAYS

SUBMITTED APRIL 3, 20 08

Diana M. O'Keefe
DEPUTY DIRECTOR OF HIGHWAYS, REGION ENGINEER

May 9, 20 08
Eric E. Horn
INTERIM ENGINEER OF DESIGN AND ENVIRONMENT

May 9, 20 08
Christine M. Reed
DIRECTOR OF HIGHWAYS, CHIEF ENGINEER

PRINTED BY THE AUTHORITY
OF THE STATE OF ILLINOIS