

F. A. NO.	SECTION	COUNTY	TOTAL SHEETS	SHEET NO.
	08-00146-00-TL	COOK	273	007
STA.	TO STA.			
FED. ROAD DIST. NO.	ILLINOIS	FED. AID PROJECT		

CONTRACT NO. 63003

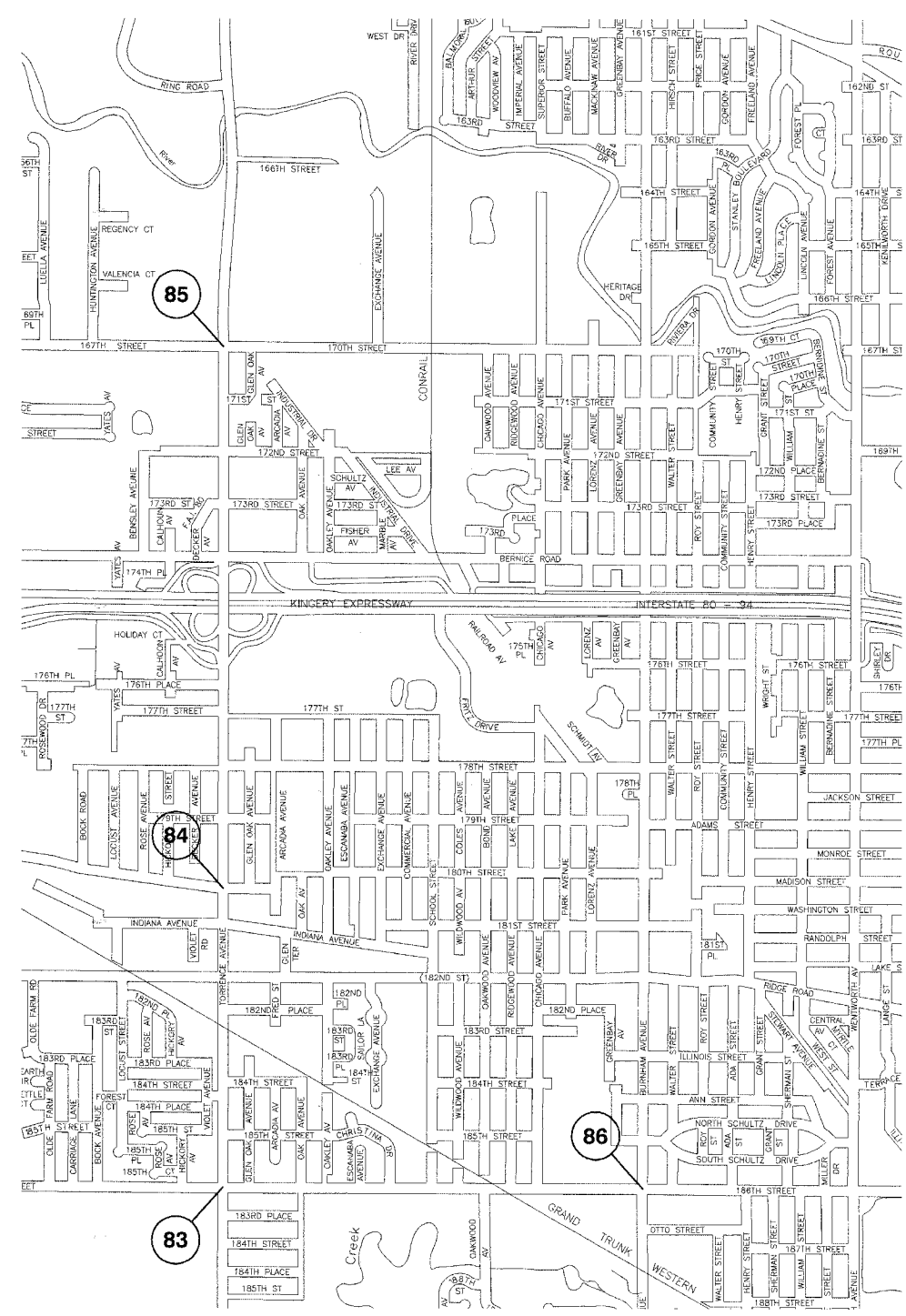
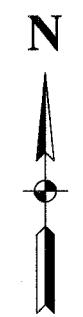

VILLAGE OF LANSING

NO.	LOCATION	JURISDICTION	SHEET NO.
83	TORRENCE AVENUE (IL RT 83) & 186TH ST	IDOT/COOK	185-186
84	TORRENCE AVENUE (IL RT 83) & THORNTON-LANSING ROAD	IDOT	187-188
85	TORRENCE AVENUE (IL RT 83) & 170TH STREET (167TH STREET)	IDOT/COOK	189-190
86	186TH STREET & BURNHAM AVENUE	IDOT	191-192

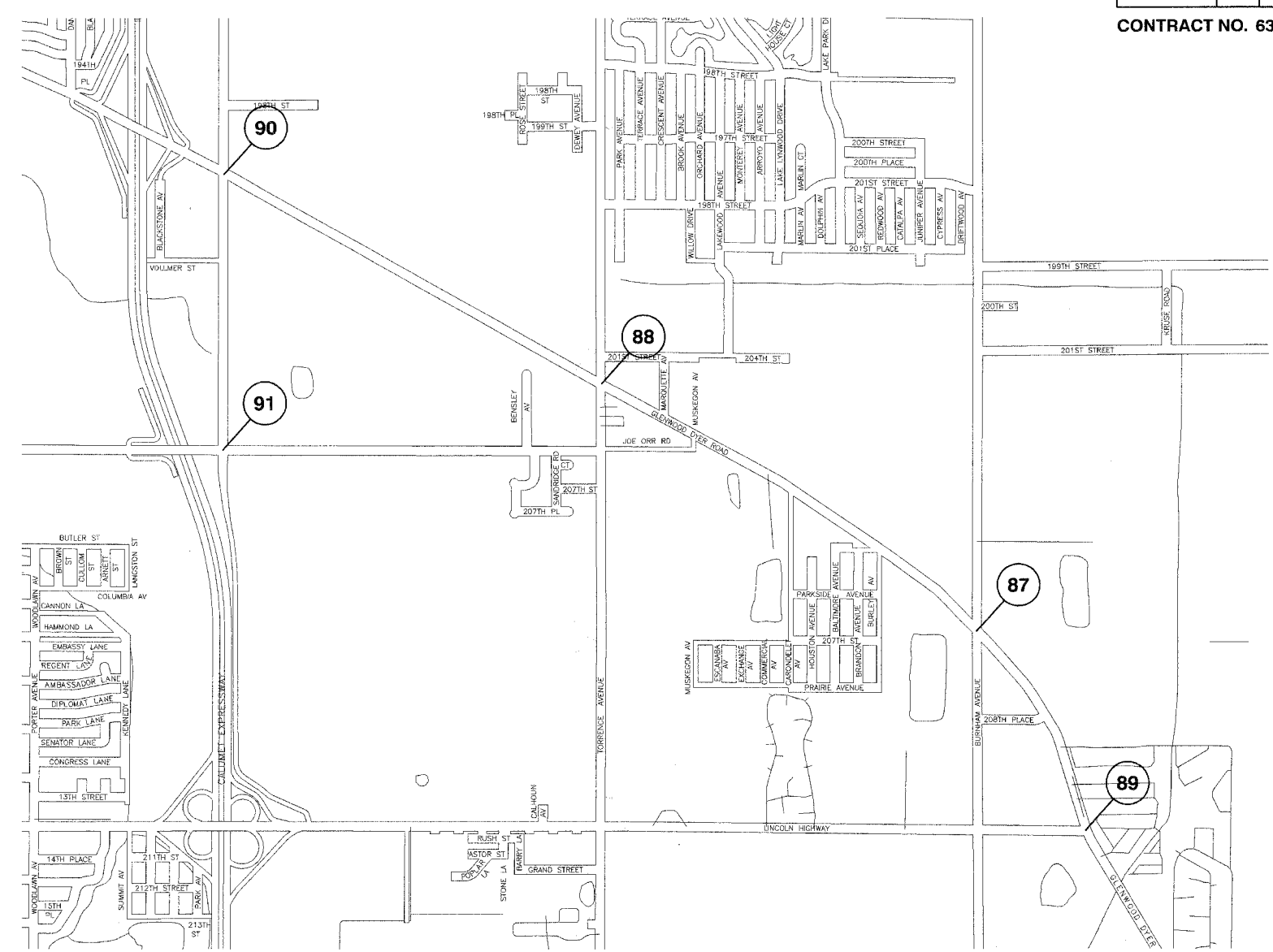

VILLAGE OF LYNWOOD

NO.	LOCATION	JURISDICTION	SHEET NO.
87	GLENWOOD DYER ROAD & BURNHAM AVENUE		193-194
88	GLENWOOD DYER ROAD & TORRENCE AVENUE (IL RT 83)	IDOT	195-196
89	GLENWOOD-DYER ROAD & ROUTE 30 (LINCOLN HIGHWAY)	IDOT	197-198
90	GLENWOOD-DYER ROAD & STONEY ISLAND AVENUE	IDOT/COOK	199-200
91	JOE ORR ROAD & STONEY ISLAND AVENUE	COOK	201-202

REVISIONS	
NAME	DATE

ILLINOIS DEPARTMENT OF TRANSPORTATION

**PROPOSED EMERGENCY VEHICLE PREEMPTION LOCATION MAP**  
**VILLAGE OF LANSING**  
**VILLAGE OF LYNWOOD**

SCALE: VERT. \_\_\_\_\_  
 HORIZ. \_\_\_\_\_  
 DATE 01/02/08

DRAWN BY BEK  
 CHECKED BY MRS

ROBINSON ENGINEERING, L.T.D.  
 3000 SOUTH PARK AVENUE, SOUTH HOLLAND, ILLINOIS 60473  
 (708) 381-0770 FAX (708) 381-3899  
 ILLINOIS DESIGN FIRM REGISTRATION NO. 184022-08

07248-LCTM-01