

SECTION	COUNTY	TOTAL SHEETS	SHEET NO.
08-00146-00-TL	COOK	273	191
STA.	TO STA.		
FED. ROAD DIST. NO.	ALIGNED	FED. AID PROJECT	

CONTRACT NO. 63003

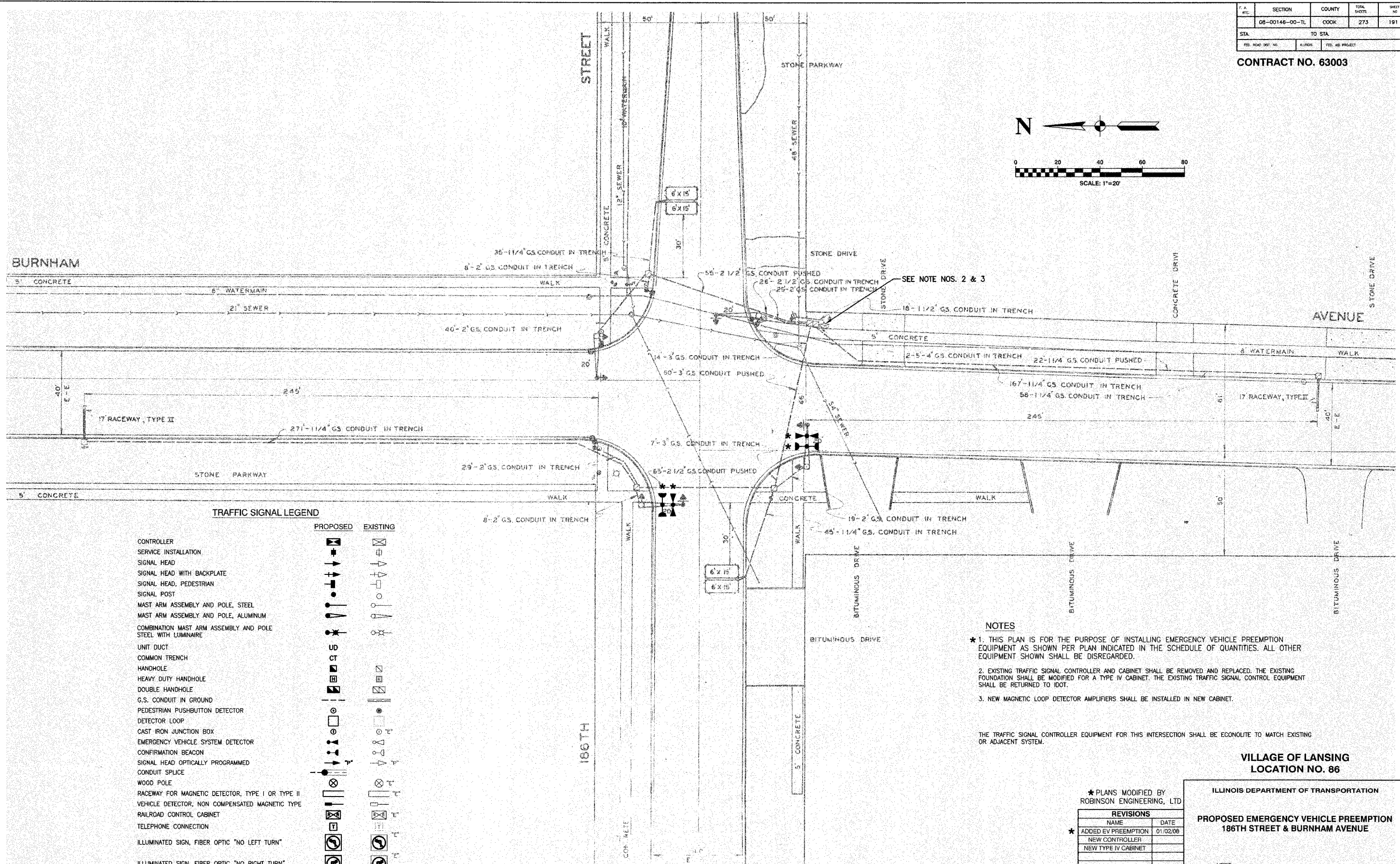
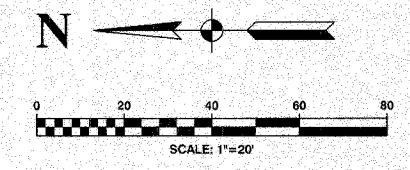

TRAFFIC SIGNAL LEGEND

	PROPOSED	EXISTING
CONTROLLER		
SERVICE INSTALLATION		
SIGNAL HEAD		
SIGNAL HEAD WITH BACKPLATE		
SIGNAL HEAD, PEDESTRIAN		
SIGNAL POST		
MAST ARM ASSEMBLY AND POLE, STEEL		
MAST ARM ASSEMBLY AND POLE, ALUMINUM		
COMBINATION MAST ARM ASSEMBLY AND POLE STEEL WITH LUMINAIRE		
UNIT DUCT		
COMMON TRENCH		
HANDHOLE		
HEAVY DUTY HANDHOLE		
DOUBLE HANDHOLE		
G.S. CONDUIT IN GROUND		
PEDESTRIAN PUSHBUTTON DETECTOR		
DETECTOR LOOP		
CAST IRON JUNCTION BOX		
EMERGENCY VEHICLE SYSTEM DETECTOR		
CONFIRMATION BEACON		
SIGNAL HEAD OPTICALLY PROGRAMMED		
CONDUIT SPLICE		
WOOD POLE		
RACEWAY FOR MAGNETIC DETECTOR, TYPE I OR TYPE II		
VEHICLE DETECTOR, NON COMPENSATED MAGNETIC TYPE		
RAILROAD CONTROL CABINET		
TELEPHONE CONNECTION		
ILLUMINATED SIGN, FIBER OPTIC "NO LEFT TURN"		
ILLUMINATED SIGN, FIBER OPTIC "NO RIGHT TURN"		

NOTES

- * 1. THIS PLAN IS FOR THE PURPOSE OF INSTALLING EMERGENCY VEHICLE PREEMPTION EQUIPMENT AS SHOWN PER PLAN INDICATED IN THE SCHEDULE OF QUANTITIES. ALL OTHER EQUIPMENT SHOWN SHALL BE DISREGARDED.
- 2. EXISTING TRAFFIC SIGNAL CONTROLLER AND CABINET SHALL BE REMOVED AND REPLACED. THE EXISTING FOUNDATION SHALL BE MODIFIED FOR A TYPE IV CABINET. THE EXISTING TRAFFIC SIGNAL CONTROL EQUIPMENT SHALL BE RETURNED TO IDOT.
- 3. NEW MAGNETIC LOOP DETECTOR AMPLIFIERS SHALL BE INSTALLED IN NEW CABINET.

THE TRAFFIC SIGNAL CONTROLLER EQUIPMENT FOR THIS INTERSECTION SHALL BE ECONOLITE TO MATCH EXISTING OR ADJACENT SYSTEM.

VILLAGE OF LANSING
LOCATION NO. 86

* PLANS MODIFIED BY
ROBINSON ENGINEERING, LTD

REVISIONS	
NAME	DATE
* ADDED EV PREEMPTION	01/02/08
NEW CONTROLLER	
NEW TYPE IV CABINET	

ILLINOIS DEPARTMENT OF TRANSPORTATION

**PROPOSED EMERGENCY VEHICLE PREEMPTION
186TH STREET & BURNHAM AVENUE**

SCALE: VERT. _____
HORIZ. _____

DATE _____ DRAWN BY _____
CHECKED BY _____