

F. A. NO.	SECTION	COUNTY	TOTAL SHEETS	SHEET NO.
	08-00146-00-TL	COOK	273	206
STA.		TO STA.		
FED. ROAD DIST. NO.	USPODS	FED. AID PROJECT		

CONTRACT NO. 63003

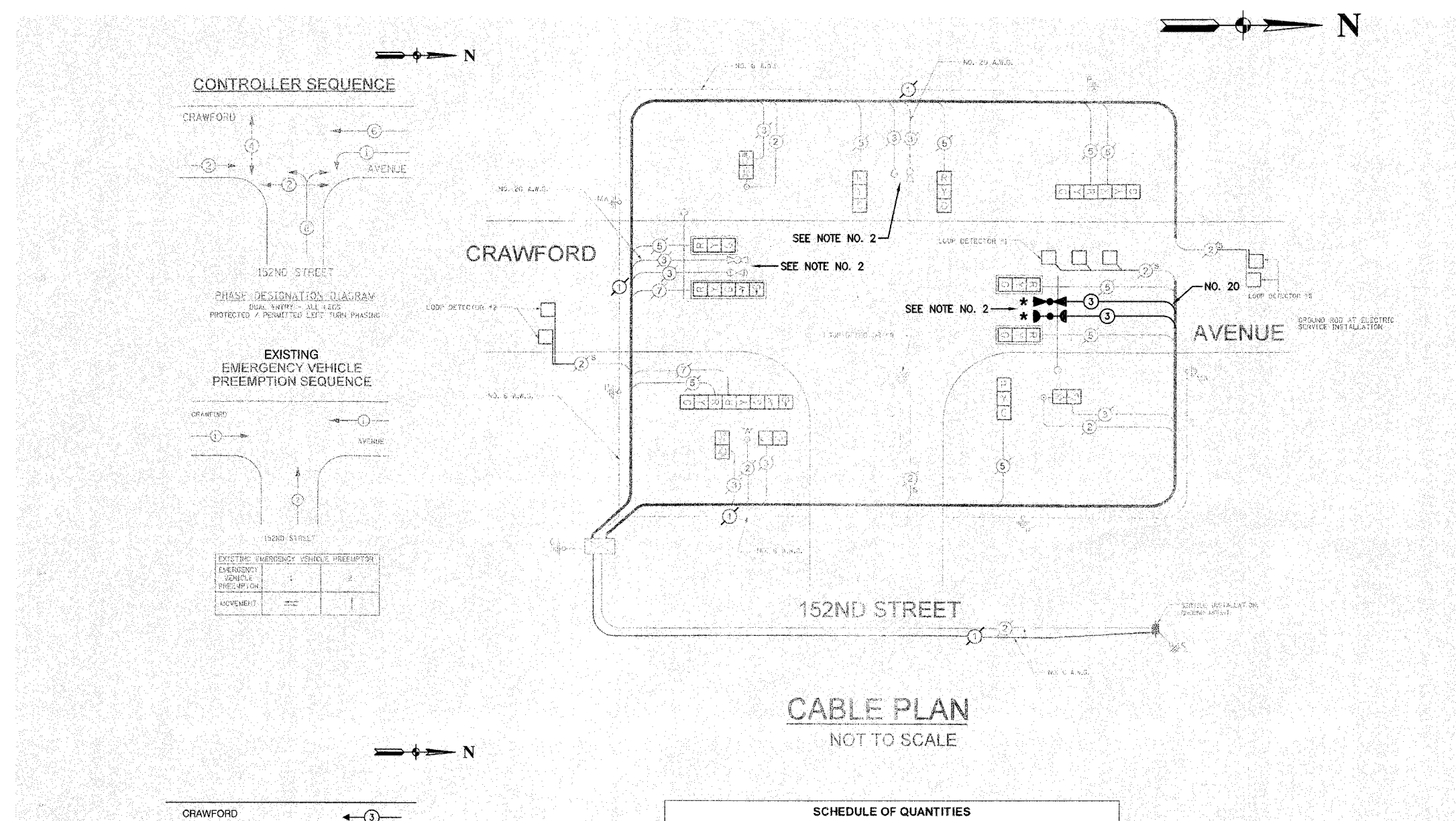

EXISTING	PROPOSED	
		8" TRAFFIC SIGNAL SECTION
		12" TRAFFIC SIGNAL SECTION
		12" PEDESTRIAN SIGNAL SECTION
		12" PEDESTRIAN SIGNAL SECTION
		CONTROLLER CABINET
		SERVICE INSTALLATION
		TELEPHONE CONNECTION
		MAGNETIC DETECTOR
		EMERGENCY VEHICLE LIGHT DETECTOR
		CONFIRMATION BEACON
		PUSHBUTTON DETECTOR
		VEHICLE DETECTOR, INDUCTION LOOP
		DENOTES NUMBER OF CONDUCTORS. ALL CABLE NO. 14 EXCEPT AS INDICATED. ALL LOOP DETECTOR CABLE TO BE SHIELDED.
		SIGNAL FACE WITH BACKPLATE
		"P" INDICATES PROGRAMMED HEAD
		RAILROAD CONTROL CABINET
		ILLUMINATED SIGN, FIBER OPTIC "NO LEFT TURN"
		ILLUMINATED SIGN, FIBER OPTIC "NO RIGHT TURN"
		H/C GROUND ROD AT HANDHOLE, DOUBLE HANDHOLE, OR CONTROLLER
		P GROUND ROD AT POST OR MAST ARM POLE
		S GROUND ROD AT ELECTRIC SERVICE INSTALLATION

CABLE PLAN
NOT TO SCALE

SCHEDULE OF QUANTITIES		
PAY ITEM	UNIT	QUANTITY
MAINTENANCE OF EXISTING TRAFFIC SIGNAL INSTALLATION	EACH	1
ELECTRIC CABLE IN CONDUIT, SIGNAL NO. 14 3C	FOOT	141
LIGHT DETECTOR	EACH	2
LIGHT DETECTOR AMPLIFIER	EACH	1
REMOVE EXISTING TRAFFIC SIGNAL EQUIPMENT	EACH	1
ELECTRIC CABLE IN CONDUIT NO. 20 3/C, TWISTED, SHIELDED	FOOT	141

- NOTES**
- THIS PLAN IS FOR THE PURPOSE OF INSTALLING EMERGENCY VEHICLE PREEMPTION EQUIPMENT AS SHOWN PER PLAN INDICATED IN THE SCHEDULE OF QUANTITIES. ALL OTHER EQUIPMENT SHOWN SHALL BE DISREGARDED.
 - THE EXISTING 152ND STREET EMERGENCY VEHICLE LIGHT DETECTOR, CONFIRMATION BEACON, AND THE LIGHT DETECTOR AMPLIFIER SHALL BE REMOVED AND REPLACED WITH NEW EQUIPMENT. EXISTING EQUIPMENT SHALL BE RETURNED TO THE VILLAGE OF MIDLOTHIAN.
 - THE EXISTING CRAWFORD AVENUE LIGHT DETECTOR, CONFIRMATION BEACON, 3/C AND NO. 20 WIRES SHALL BE REMOVED FROM THE EXISTING LOCATION. THE NEW LIGHT DETECTOR AND CONFIRMATION BEACON SHALL BE MOUNTED IN THE POSITIONS INDICATED IN THE CABLE AND SIGNAL PLANS. EXISTING EQUIPMENT SHALL BE RETURNED TO THE VILLAGE OF MIDLOTHIAN.

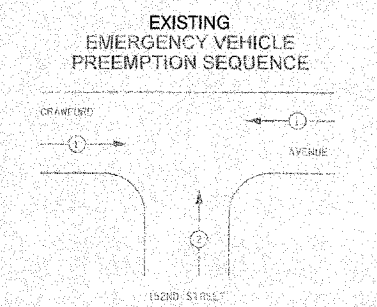
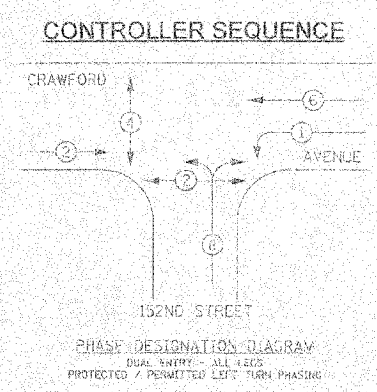

EXISTING EMERGENCY VEHICLE PREEMPTION		
EMERGENCY VEHICLE PREEMPTION	1	2
MOVEMENT	←	↑

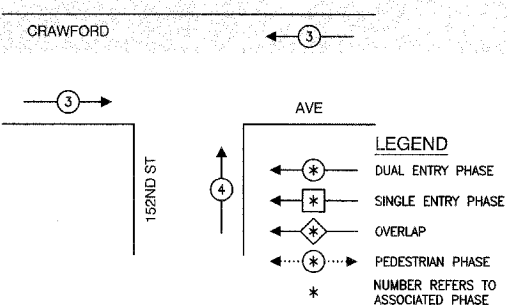

PROPOSED EMERGENCY VEHICLE PREEMPTION

PROPOSED EMERGENCY VEHICLE PREEMPTION		
EMERGENCY VEHICLE PREEMPTION	3	4
MOVEMENT	←	↑

VILLAGE OF MIDLOTHIAN
LOCATION NO. 98

ILLINOIS DEPARTMENT OF TRANSPORTATION

PROPOSED EMERGENCY VEHICLE PREEMPTION CABLE PLAN, PHASE DESIGNATION DIAGRAM & SCHEDULE OF QUANTITIES
152ND ST & PULASKI RD (CRAWFORD AVE)

SCALE: VERT. _____
HORIZ. _____
DATE _____ DRAWN BY _____
CHECKED BY _____

* PLANS MODIFIED BY ROBINSON ENGINEERING, LTD

REVISIONS	
NAME	DATE
* ADDED EV PREEMPTION	01/02/08