

FAU RTE.	SECTION	COUNTY	TOTAL SHEETS	SHEET NO.
1524	08-00027-00-RS	COOK	15	10
STA. 10+00		TO STA. 88+81.23		
FED. ROAD DIST. NO.		ILLINOIS	FED. AID PROJECT	
CONTRACT NO. 63017				

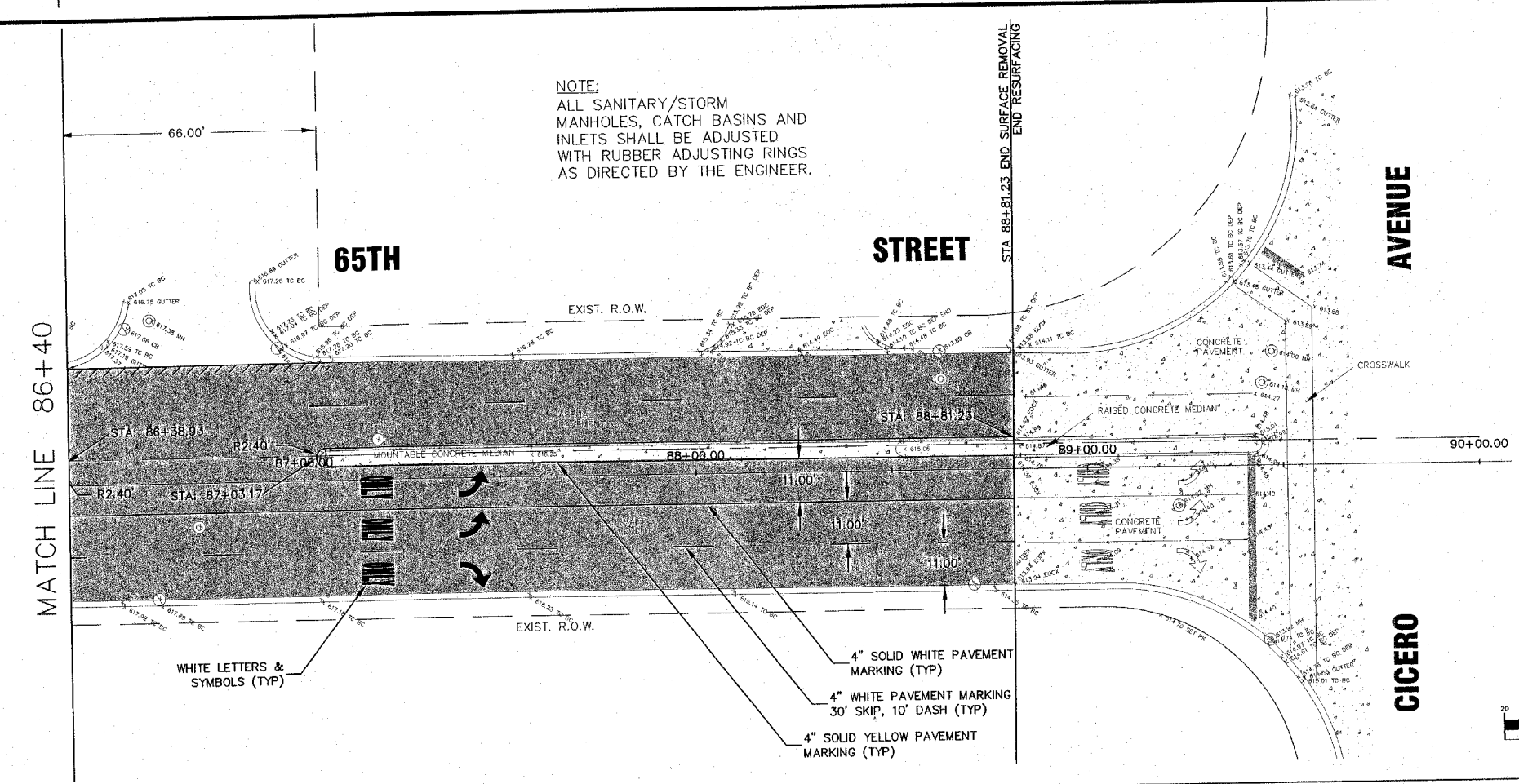
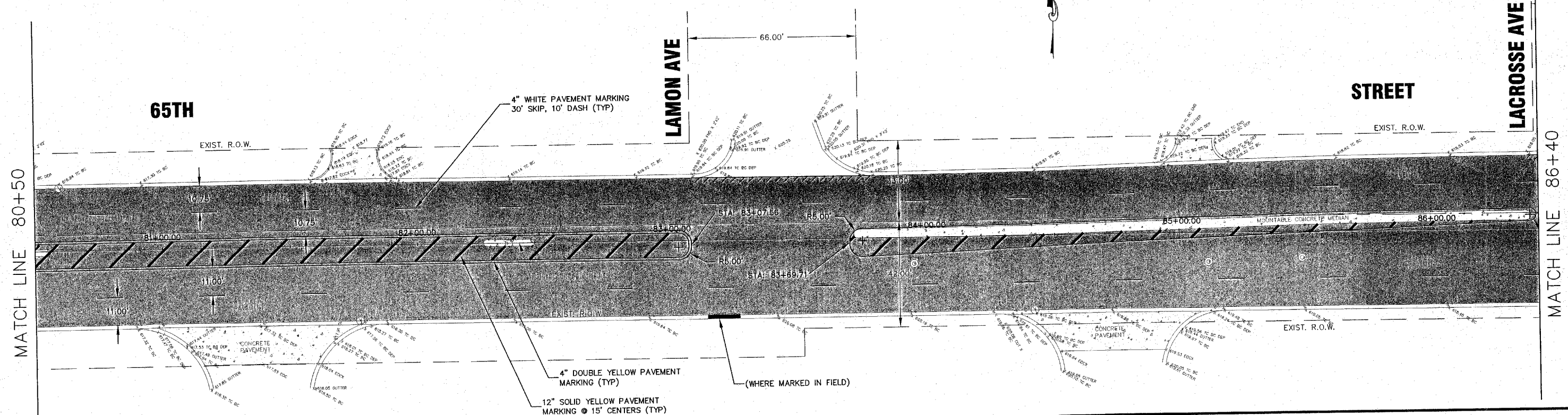

NOTE:  
ALL SANITARY/STORM  
MANHOLES, CATCH BASINS AND  
INLETS SHALL BE ADJUSTED  
WITH RUBBER ADJUSTING RINGS  
AS DIRECTED BY THE ENGINEER.

**LEGEND**

- PROPOSED CURB AND GUTTER REMOVAL AND REPLACEMENT
- PROPOSED HOT MIX ASPHALT SURFACE REMOVAL AND HOT MIX ASPHALT SURFACE COURSE, 2 1/4"
- LIMITS OF SURFACE REMOVAL - BUTT JOINT
- MEDIAN SURFACE REMOVAL AND HOT-MIX ASPHALT MEDIAN SURFACE REPLACEMENT, 2"

**PAVEMENT MARKING NOTES:**  
1) THERMOPLASTIC PAVEMENT MARKING SHALL BE INSTALLED ON BITUMINOUS PAVEMENT ONLY  
2) EPOXY PAVEMENT MARKING SHALL BE INSTALLED ON CONCRETE PAVEMENT ONLY



REVISIONS		DATE	ILLINOIS DEPARTMENT OF TRANSPORTATION VILLAGE OF BEDFORD PARK 65TH STREET RESURFACING AUSTIN AVE. TO CICERO AVE. PLAN VIEW STA. 80+50 - STA. 88+81.23
NAME	DATE		
S. LEIBER	02/15/08		

SCALE: 1"=20'  
HORIZ: 1"=20'  
DATE: 10/17/07

DRAWN BY: ECC  
CHECKED BY: SAL

**hbe** Hoeffler-Butler Engineering, Inc.  
Consulting Civil Engineers • Land Surveyors  
PROFESSIONAL DESIGN FIRM LICENSE NO. 084-008879  
8714 S. ROBERTS ROAD HICKORY HILLS, ILLINOIS 60457  
CH80 599-8988 FAX CH80 599-8790