

F.A.U. RTE.	SECTION	COUNTY	TOTAL SHEETS	SHEET NO.
2678	08-00169-00-LT	DUPAGE	39	7
STA. 12+00 TO STA. 13+85		FED. ROAD DIST. NO. ILLINOIS FED. AID PROJECT		
CONTRACT NO. 63027				

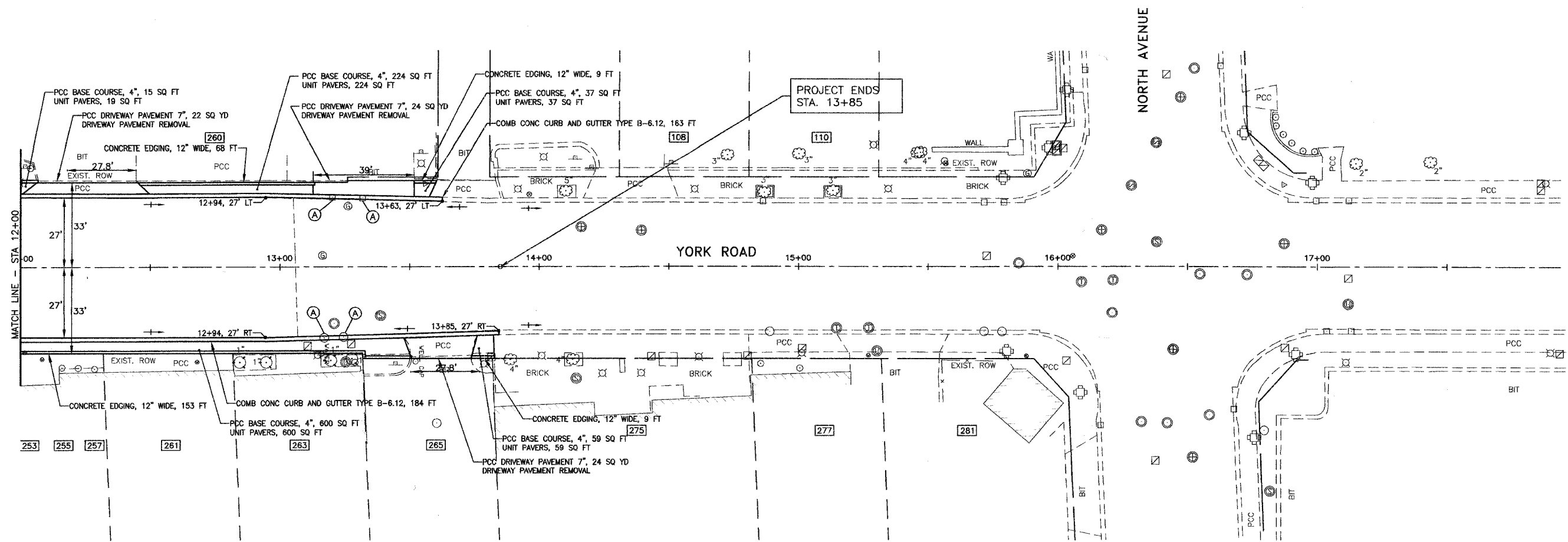
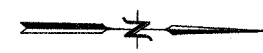

EDGE OF PAVEMENT ELEVATIONS
YORK STREET - LEFT

STATION	OFFSET (FOOT)	PROPOSED EDGE OF PAVEMENT ELEVATION
12+00	27 LT	689.03
12+25	27 LT	688.99
12+50	27 LT	688.93
12+75	27 LT	688.83
12+94	27 LT	688.78
13+00	26.87 LT	688.76
13+25	26.33 LT	688.45
13+50	25.78 LT	688.58
13+63	MATCH EXISTING	

EDGE OF PAVEMENT ELEVATIONS
YORK STREET - RIGHT

STATION	OFFSET (FOOT)	PROPOSED EDGE OF PAVEMENT ELEVATION
12+00	27 RT	688.64
12+25	27 RT	688.54
12+50	27 RT	688.45
12+75	27 RT	688.36
12+94	27 RT	688.33
13+00	26.85 RT	688.32
13+25	26.33 RT	688.34
13+50	25.61 RT	688.61
13+75	25 RT	688.72
13+85	MATCH EXISTING	

STRUCTURES TO BE ADJUSTED

STATION	OFFSET	PROPOSED FRAME TYPE	PROPOSED E/P ELEV.
13+17	27 RT	TYPE 3 FRAME & GRATE	688.30
13+21	26 LT	TYPE 23 FRAME & GRATE	688.51
13+24	27 RT	TYPE 3 FRAME & GRATE	688.34
13+32	25 LT	TYPE 23 FRAME & GRATE	688.37

- LEGEND
- [E] FILLING EXISTING STRUCTURE
 - (A) STRUCTURE TO BE ADJUSTED WITH NEW FRAME & LID
 - (R) STRUCTURE TO BE RECONSTRUCTED WITH NEW FRAME & LID
 - [REM] STRUCTURE TO BE REMOVED

REVISIONS

NAME	DATE

ILLINOIS DEPARTMENT OF TRANSPORTATION
F.A.U.
YORK ROAD

STREETScape PLAN SHEET

SCALE: 1"=20'
DATE: 12/22/07

DRAWN BY: BCD
CHECKED BY: JDS