

F.A.P. RTE.	SECTION	COUNTY	TOTAL SHEETS	SHEET NO.
17	15T-2	CARROLL	71	26
STA.		TO STA.		
FED. ROAD DIST. NO.		ILLINOIS FED. AID PROJECT		

# STAGE 1 STA. 1240 + 74

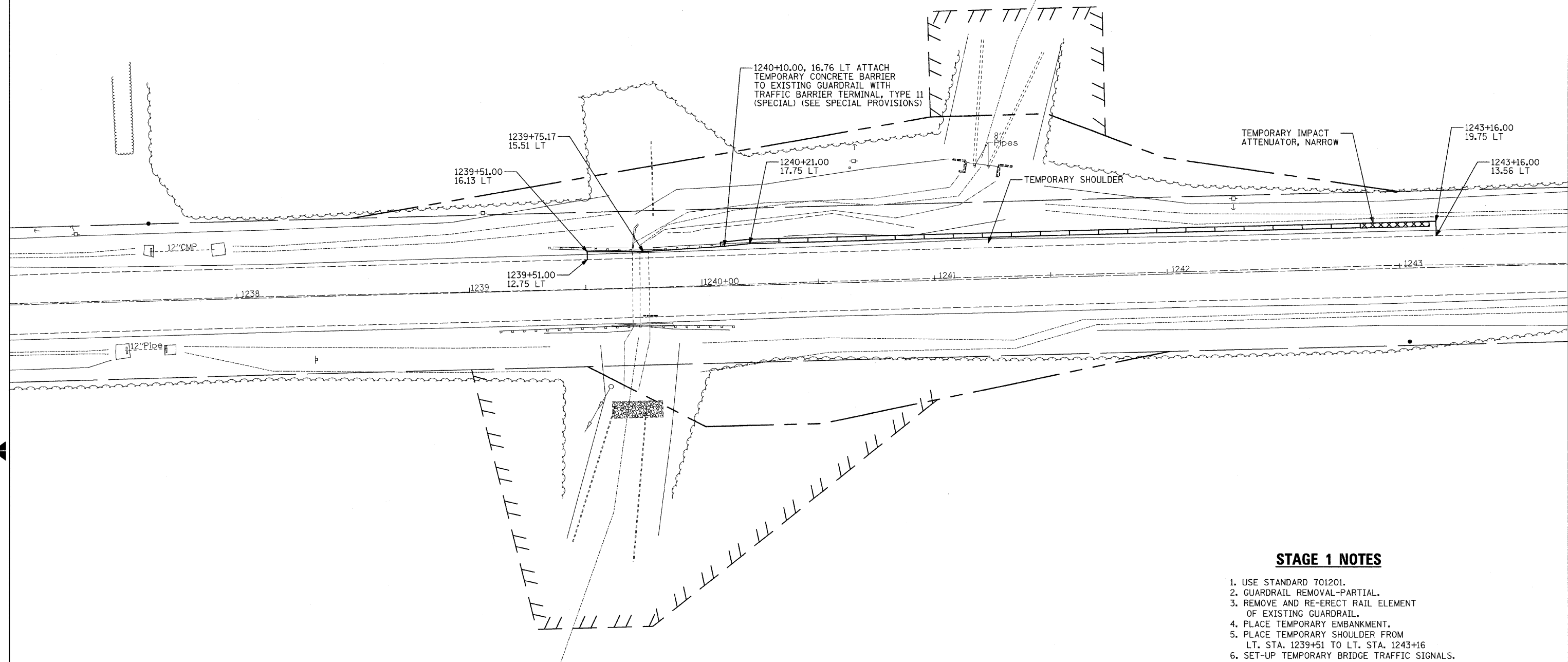

### STAGE 1 NOTES

1. USE STANDARD 701201.
2. GUARDRAIL REMOVAL-PARTIAL.
3. REMOVE AND RE-ERECT RAIL ELEMENT OF EXISTING GUARDRAIL.
4. PLACE TEMPORARY EMBANKMENT.
5. PLACE TEMPORARY SHOULDER FROM LT. STA. 1239+51 TO LT. STA. 1243+16
6. SET-UP TEMPORARY BRIDGE TRAFFIC SIGNALS.
7. COMPLETE SHOULDER EDGE TEMPORARY CONCRETE BARRIER, TEMPORARY IMPACT ATTENUATOR, NARROW AND TRAFFIC BARRIER TERMINAL TYPE 11 (SPECIAL).

REVISIONS	
NAME	DATE

ILLINOIS DEPARTMENT OF TRANSPORTATION

SCALE: VERT. \_\_\_\_\_  
HORIZ. \_\_\_\_\_

DATE \_\_\_\_\_

DRAWN BY \_\_\_\_\_  
CHECKED BY \_\_\_\_\_

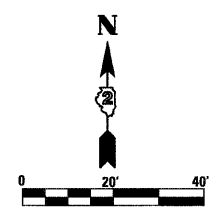

PLOT DATE = Mon Jan 28 09:06:10 2008  
 FILE NAME = K:\P\objects\Carroll\64C35\_IL64\_IL73.to.Dgfile.cool\ma\Hanson\project\17a\maurer-stutz\final.plans\Revised\Z0790651\17a\maurer-stutz\inc\maurer-stutz\inc.dwg  
 PLOT SCALE = 28.00000 / IN.  
 USER NAME = hansenko

