

STAGE I

- STAGE I
1. ERECT BARRICADES, SIGNS AND TEMPORARY TRAFFIC SIGNALS AS SHOWN ON THE DRAWINGS, STATE STANDARDS AND AS DIRECTED BY THE ENGINEER.
 2. CLOSE THE WEST BOUND LANE OF US 20 TO TRAFFIC. CONVERT THE EAST BOUND LANE AND SHOULDER INTO ONE WAY TRAFFIC.
 3. CONSTRUCT THE SOUTH SIDE OF THE CULVERT AND PLACE PAVEMENT PATCHING.
 4. PLACE TEMPORARY PAVEMENT MARKINGS.
- STAGE II
1. ERECT BARRICADES, SIGNS AND TEMPORARY TRAFFIC SIGNALS AS SHOWN ON THE DRAWINGS, STATE STANDARDS AND AS DIRECTED BY THE ENGINEER.
 2. CLOSE THE EAST BOUND LANE OF US 20 TO TRAFFIC. CONVERT THE WEST BOUND LANE AND SHOULDER INTO ONE WAY TRAFFIC.
 3. CONSTRUCT THE NORTH SIDE OF THE CULVERT, COMPLETE REMOVAL OF THE EXISTING CULVERT AND PLACE PAVEMENT PATCHING.
- STAGE III
1. CONSTRUCT PAVEMENT OVERLAY
 2. COMPLETE SITE RESTORATION AND INSTALLATION OF PERMANENT PAVEMENT MARKINGS.
- FOR ADDITIONAL STAGING INFORMATION SEE SHEET 11

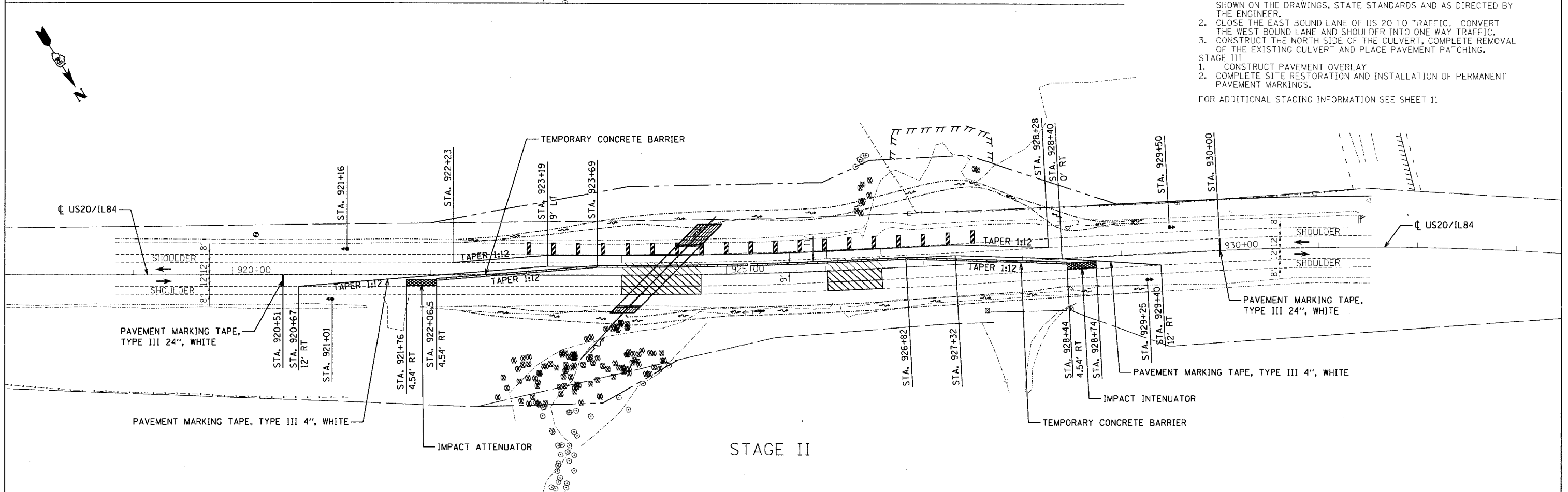

STAGE II

FILE NAME =	USER NAME = IDOTCAD	DESIGNED - SPF	REVISED -	STATE OF ILLINOIS DEPARTMENT OF TRANSPORTATION	TRAFFIC STAGING PLANS		F.A.P. RTE.	SECTION	COUNTY	TOTAL SHEETS	SHEET NO.
PA\2298-01 - US 20 Box Culvert\marostan	Files\00 Sheet Files\Z10106ST0.dgn	DRAWN - AJP	REVISED -				301	29T-1	JO DAVIESS	30	8
PLOT SCALE = 50,0000' / IN.	CHECKED - JMS	REVISED -	CONTRACT NO. 64C58								
PLOT DATE = 3/25/2008	DATE - 3-28-08	REVISED -	FED. ROAD DIST. NO. ILLINOIS FED. AID PROJECT								