

| F.A.S. RTE.         | SECTION    | COUNTY                    | TOTAL SHEETS | SHEET NO. |
|---------------------|------------|---------------------------|--------------|-----------|
| 1177                | (110,111)T | LEE                       | 59           | 15        |
| STA.                |            | TO STA.                   |              |           |
| FED. ROAD DIST. NO. |            | ILLINOIS FED. AID PROJECT |              |           |

# STA. 261+52 10' x 5' BOX CULVERT

PARAMOUNT GROUP, LLC

PARAMOUNT GROUP, LLC

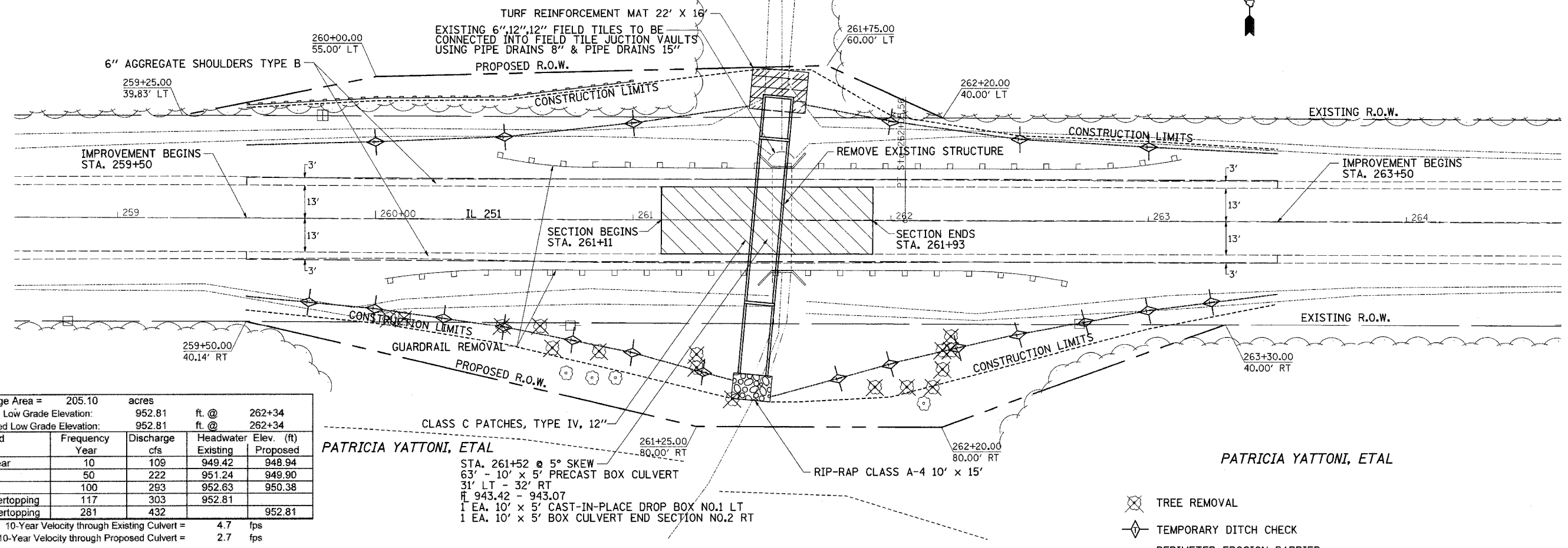

|   |           |               |                    |                     |
|---|-----------|---------------|--------------------|---------------------|
| Drainage Area =                             | 205.10    | acres         |                    |                     |
| Existing Low Grade Elevation:               | 952.81    | ft. @         | 262+34             |                     |
| Proposed Low Grade Elevation:               | 952.81    | ft. @         | 262+34             |                     |
| Flood Year                                  | Frequency | Discharge cfs | Headwater Existing | Elev. (ft) Proposed |
| Ten-Year                                    | 10        | 109           | 949.42             | 948.94              |
| Design                                      | 50        | 222           | 951.24             | 949.90              |
| Base  | 100       | 293           | 952.63             | 950.38              |
| EX Overtopping                              | 117       | 303           | 952.81             |                     |
| PR Overtopping                              | 281       | 432           |                    | 952.81              |
| 10-Year Velocity through Existing Culvert = |           | 4.7           | fps                |                     |
| 10-Year Velocity through Proposed Culvert = |           | 2.7           | fps                |                     |

PATRICIA YATTONI, ETAL

STA. 261+52 @ 5° SKEW  
63' - 10' x 5' PRECAST BOX CULVERT  
31' LT - 32' RT  
R 943.42 - 943.07  
1 EA. 10' x 5' CAST-IN-PLACE DROP BOX NO.1 LT  
1 EA. 10' x 5' BOX CULVERT END SECTION NO.2 RT

PATRICIA YATTONI, ETAL

- ⊗ TREE REMOVAL
- ◇ TEMPORARY DITCH CHECK
- PERIMETER EROSION BARRIER

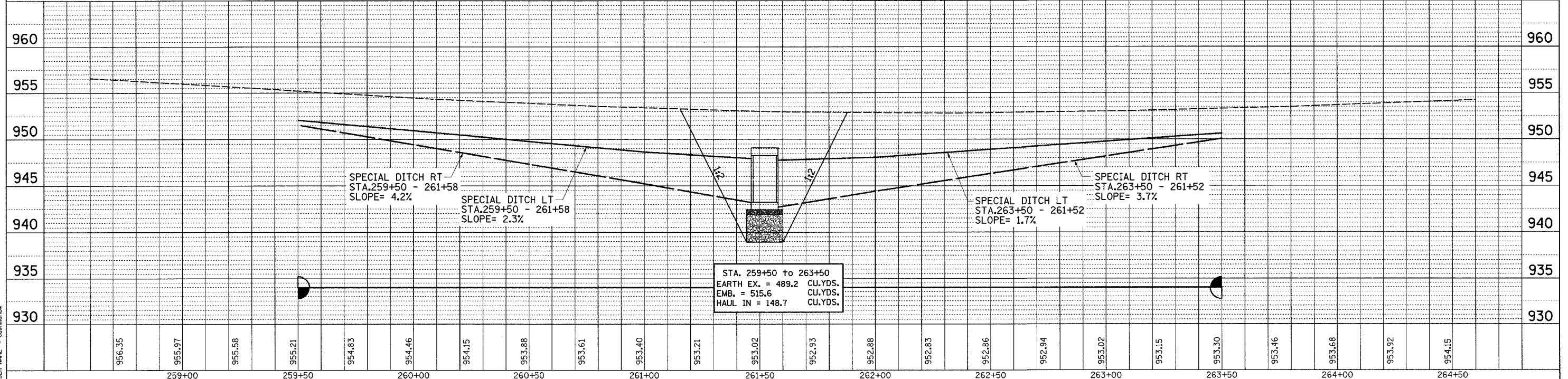

STA. 261+52 10' x 5' BOX CULVERT

DATE: \_\_\_\_\_ BY: \_\_\_\_\_  
 PLAT: \_\_\_\_\_  
 NO. \_\_\_\_\_

DATE: \_\_\_\_\_ BY: \_\_\_\_\_  
 PROFILE: \_\_\_\_\_  
 NO. \_\_\_\_\_

DATE: Tue Feb 28 10:28:54 2006  
 PLOT SCALE = 20.0000 1" = 40.0000'  
 USER NAME = cshimabmb