

PAVEMENT ELEVATIONS

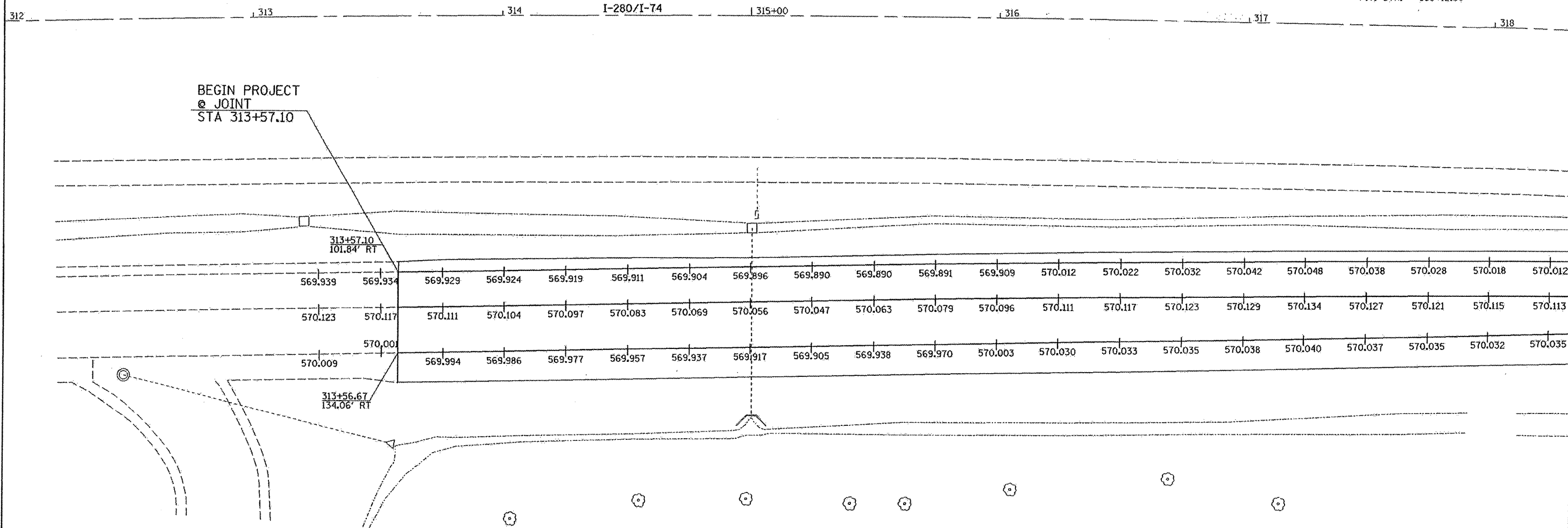

EXIST. CURVE 310
 PI STA. = 325+48.73
 $\Delta = 12^\circ 40' 58''$ (RT)
 $D = 0^\circ 29' 59''$
 $R = 11,464.32'$
 $T = 1,274.07'$
 $L = 2,537.72'$
 $E = 70.58'$
 $e = \text{-----}$
 $T.R. = \text{-----}$
 $S.E. \text{ RUN} = \text{-----}$
 $P.C. \text{ STA.} = 312+74.67$
 $P.T. \text{ STA.} = 338+12.39$



569.939	569.934	569.929	569.924	569.919	569.911	569.904	569.896	569.890	569.890	569.891	569.909	570.012	570.022	570.032	570.042	570.048	570.038	570.028	570.018	570.012
570.123	570.117	570.111	570.104	570.097	570.083	570.069	570.056	570.047	570.063	570.079	570.096	570.111	570.117	570.123	570.129	570.134	570.127	570.121	570.115	570.113
570.009	570.001	569.994	569.986	569.977	569.957	569.937	569.917	569.905	569.938	569.970	570.003	570.030	570.033	570.035	570.038	570.040	570.037	570.035	570.032	570.035

Station	Offset from I-74/I280 Left EOP of RAMP	LT	@ 14' Joint	Offset from I-74/I280 Right EOP of RAMP	RT	Total Pavement Width
31325		569.939	570.123		570.009	
31350		569.934	570.117		570.001	
31375		569.929	570.111		569.994	
31400	101.55	569.924	570.104	133.63	569.986	32.08
31425	101.17	569.919	570.097	133.26	569.977	32.09
31450	100.79	569.911	570.083	132.90	569.957	32.10
31475	100.41	569.904	570.069	132.53	569.937	32.12
31500	100.04	569.896	570.056	132.16	569.917	32.13
31525	99.50	569.890	570.047	131.57	569.905	32.07
31550	98.96	569.890	570.063	130.98	569.938	32.02
31575	98.41	569.891	570.079	130.38	569.970	31.97
31600	97.87	569.909	570.096	129.79	570.003	31.91
31625	97.28	570.012	570.111	129.01	570.030	31.72

Station	Offset from I-74/I280 Left EOP of RAMP	LT	@ 14' Joint	Offset from I-74/I280 Right EOP of RAMP	RT	Total Pavement Width
31650	96.69	570.022	570.117	128.22	570.033	31.53
31675	96.10	570.032	570.123	127.44	570.035	31.34
31700	95.51	570.042	570.129	126.65	570.038	31.15
31725	94.87	570.048	570.134	125.66	570.040	30.79
31750	94.24	570.038	570.127	124.67	570.037	30.43
31775	93.60	570.028	570.121	123.67	570.035	30.07
31800	92.97	570.018	570.115	122.68	570.032	29.71
31825	92.38	570.012	570.113	121.42	570.035	29.04



FILE NAME = c:\projects\p203003\d03003shs.dgn	USER NAME = ditzleresa	DESIGNED -	REVISED -
	PLDT SCALE = 20.0000' / IN.	DRAWN -	REVISED -
	PLDT DATE = Mon Feb 04 10:04:36 2008	CHECKED -	REVISED -
		DATE -	REVISED -

**STATE OF ILLINOIS
 DEPARTMENT OF TRANSPORTATION**

PAVEMENT ELEVATIONS			
SCALE: 1" = 20'-0"	SHEET NO.	OF	SHEETS
STA.	TO STA.		

F.A.I. RTE.	SECTION	COUNTY	TOTAL SHEETS	SHEET NO.
74	161-3WSM-1	ROCK ISLAND	12	12
CONTRACT NO. 64D94				
FED. ROAD DIST. NO. ILLINOIS FED. AID PROJECT				