

Illinois Route 84 bridge over Plum River.
 Existing structure number is 008-0028.
 Remove and reconstruct three expansion joints
 One joint at each abutment and one at pier 3.

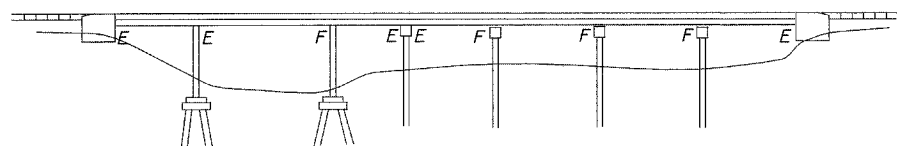

Elevation

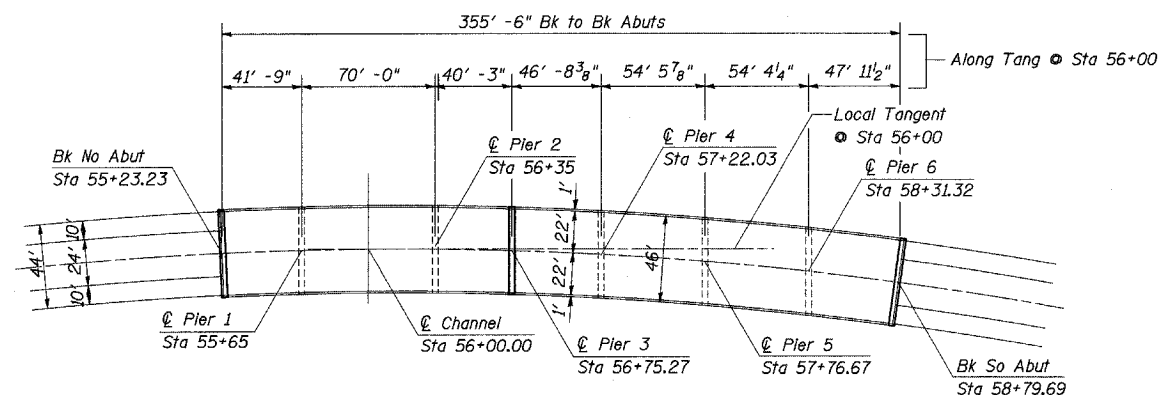

Plan

EXISTING HORIZONTAL CURVE DATA

P.I. STA= 56+64.72
 $\Delta = 31^\circ - 36'$
 $D = 2^\circ 54'$
 $R = 1975.72'$
 $T = 559.07'$
 $L = 1089.66'$
 $E = 77.58'$

S.E. = 0.065 '"/>
 P.C. STA= 51+05.65
 P.T. STA= 61+93.31



General Notes

Reinforcement bars shall conform to the requirements of ASTM A 706 Gr 60 (IL Modified). See Special Provisions.

Reinforcement bars designated (E) shall be epoxy coated.

Prior to pouring the new concrete deck, all heavy or loose rust, loose mill scale, and other loose or potentially detrimental foreign material shall be removed from the surfaces in contact with concrete. Tightly adhered paint may remain unless otherwise noted. Removal shall be accomplished by methods that will not damage the steel and the cost will be included in the pay item covering removal of the existing concrete.

Plan dimensions and details relative to existing plans are subject to routine variations. The Contractor shall field verify existing dimensions and details affecting new construction and make necessary approved adjustments prior to construction or ordering of materials. Such variations shall not be cause for additional compensation for a change in scope of the work, however, the Contractor will be paid for the quantity actually furnished based upon the unit price bid for the work.

The existing structural steel coating contains lead. The Contractor shall take appropriate precautions to deal with the presence of lead on this project.

Existing reinforcement bars extending into the removal area shall be cleaned, straightened and incorporated into the new construction. Any reinforcement bars that are damaged during concrete removal shall be replaced with an approved bar splicer or anchorage system. Cost included with Concrete Removal.

Joint openings shall be adjusted according to Article 520.04 of the Standard Specifications when the deck is poured at an ambient temperature other than 50° F.

TOTAL BILL OF MATERIAL

ITEM	UNIT	TOTAL
CONCRETE SUPERSTRUCTURE	CU YD	18.0
CONCRETE REMOVAL	CU YD	18.0
REINFORCEMENT BARS, EPOXY COATED	POUND	2,550
PREFORMED JOINT STRIP SEAL	FOOT	135
BAR SPLICERS	EACH	38
REM REIN T B TERM T1	EACH	4

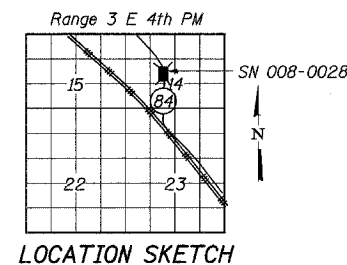

GENERAL PLAN & ELEVATION
 IL 84 OVER PLUM RIVER
 FA ROUTE 18 (IL 84)
 SECTION 106BR
 CARROLL COUNTY
 STRUCTURE NUMBER 008-0028

FILE NAME =	USER NAME = lmkdj	DESIGNED -	REVISED -
C:\BR\CADD\plans\Various Counties\Contract #64099 2008 expansion joints\0080028.dgn		DRAWN -	REVISED -
	PLOT SCALE = 50.0000 ' / IN.	CHECKED -	REVISED -
	PLOT DATE = Sat Mar 15 11:12:57 2008	DATE -	REVISED -

STATE OF ILLINOIS
 DEPARTMENT OF TRANSPORTATION

General Plan & Elevation

SCALE: None SHEET NO. 1 OF 7 SHEETS STA. TO STA.

F.A. RTE.	SECTION	COUNTY	TOTAL SHEETS	SHEET NO.
*	**	Various	26	10
ILLINOIS CONTRACT NO. 64099			ILLINOIS FED. AID PROJECT	

* Various
 ** (106BR)M, (4B-2)M & 177-4B-3)M