

F.A. RTE.	SECTION	COUNTY	TOTAL SHEETS	SHEET NO.
326	(111CS)W&RS-2.1	GRUNDY	85	22

STA. 8+00	TO STA. 13+50
FED. ROAD DIST. NO. 1	ILLINOIS FED. AID PROJECT

NOTES:
 1. ALL STORM SEWER TO BE CLASS "A" UNLESS NOTED OTHERWISE.
 2. RIM ELEVATIONS & OFFSETS FOR DRAINAGE STRUCTURES CONSTRUCTED IN CONJUNCTION WITH GUTTER OR CURB & GUTTER ARE CALLED OUT TO THE EDGE OF THE GUTTER PAN. ALL OTHER DRAINAGE STRUCTURES ARE CALLED OUT TO THE CENTER OF STRUCTURE.

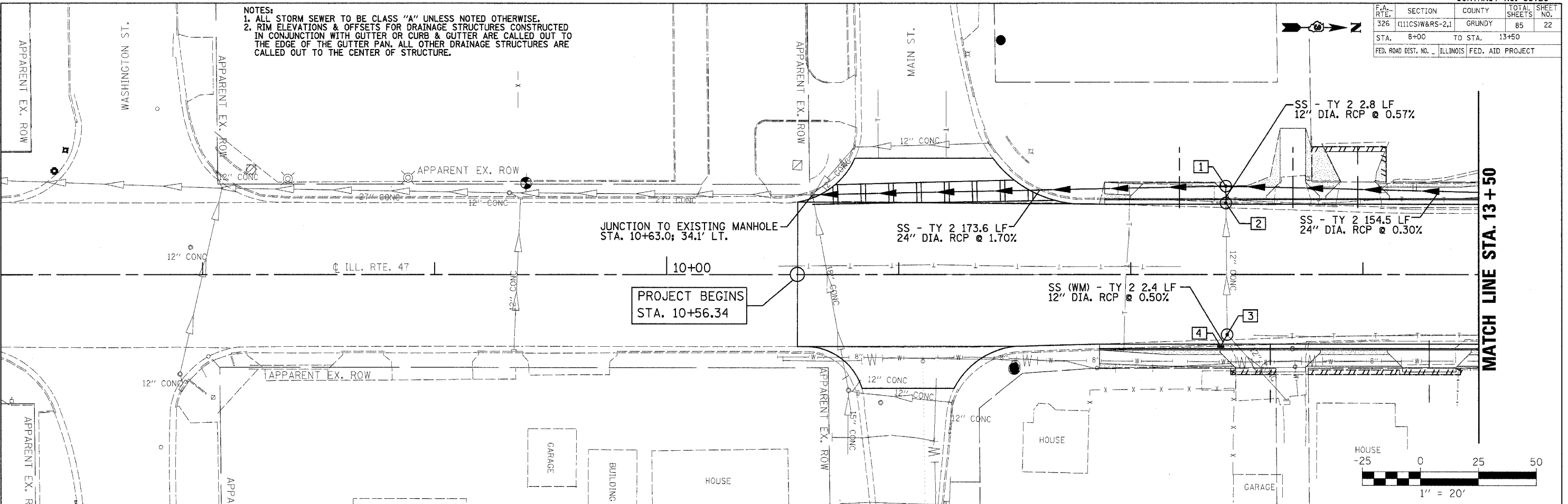

PROJECT BEGINS
 STA. 10+56.34

MATCH LINE STA. 13+50

STRUCT NUMBER	STATION	OFFSET	RIM ELEV.	INVERT ELEV.		STRUCTURE TYPE
535	1	12+41.0	37.9' LT.	520.50	515.90 N; 515.02 S; 515.76 E	MANHOLE TYPE A 5' DIA. W/ TYPE 1 FRAME CL
	2	12+41.0	30.1' LT.	520.07	515.80 E; 515.80 W	MANHOLE TYPE A 5' DIA. W/ TYPE 3 FRAME & GRATE
	3	12+41.5	25.8' RT.	520.13	516.02 W; 516.07 NE; 516.02 SE	MANHOLE TYPE A 5' DIA. W/ TYPE 1 FRAME CL
	4	12+38.8	29.9' RT.	520.07	516.05 NW	INLET TYPE A W/ TYPE 3 FRAME & GRATE
530						
525						
520						
515						
510						
505						
500						
495						

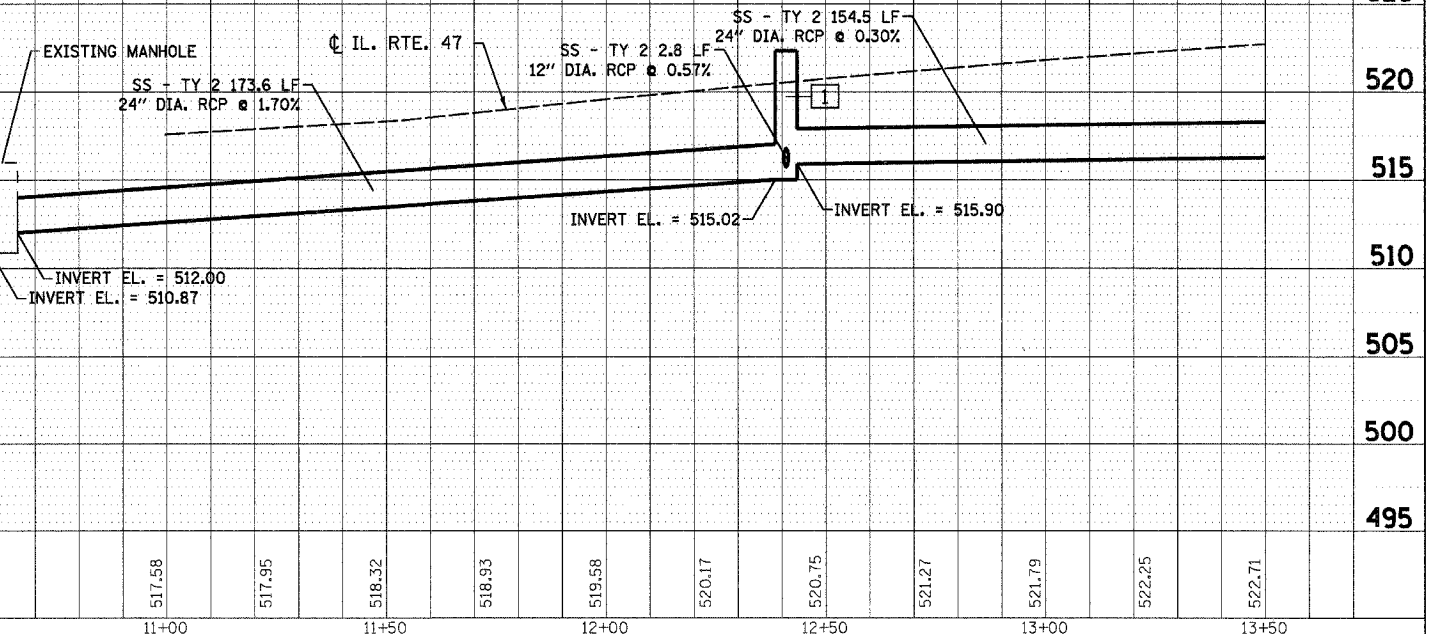

PLAN

DATE	BY
SURVEYED	ALIGNED
NOTE BOOK	NO. OF WA CHECKED
	ROAD FILE NAME

PROFILE

DATE	BY
SURVEYED	GRADES CHECKED
NOTE BOOK	NO. NOTED
	STRUCTURE NOTATIONS: EROD

DATE - TIME

CON - SPEC