

F.A. RTE.	SECTION	COUNTY	TOTAL SHEETS	SHEET NO.
326	111CSW&RS-2.1	GRUNDY	85	24
STA. 19+50	TO STA. 25+50			
FED. ROAD DIST. NO.		ILLINOIS		FED. AID PROJECT

NOTES:
 1. ALL STORM SEWER TO BE CLASS "A" UNLESS NOTED OTHERWISE.
 2. RIM ELEVATIONS & OFFSETS FOR DRAINAGE STRUCTURES CONSTRUCTED IN CONJUNCTION WITH GUTTER OR CURB & GUTTER ARE CALLED OUT TO THE EDGE OF THE GUTTER PAN. ALL OTHER DRAINAGE STRUCTURES ARE CALLED OUT TO THE CENTER OF STRUCTURE.

MATCH LINE STA. 19+50

MATCH LINE STA. 25+50

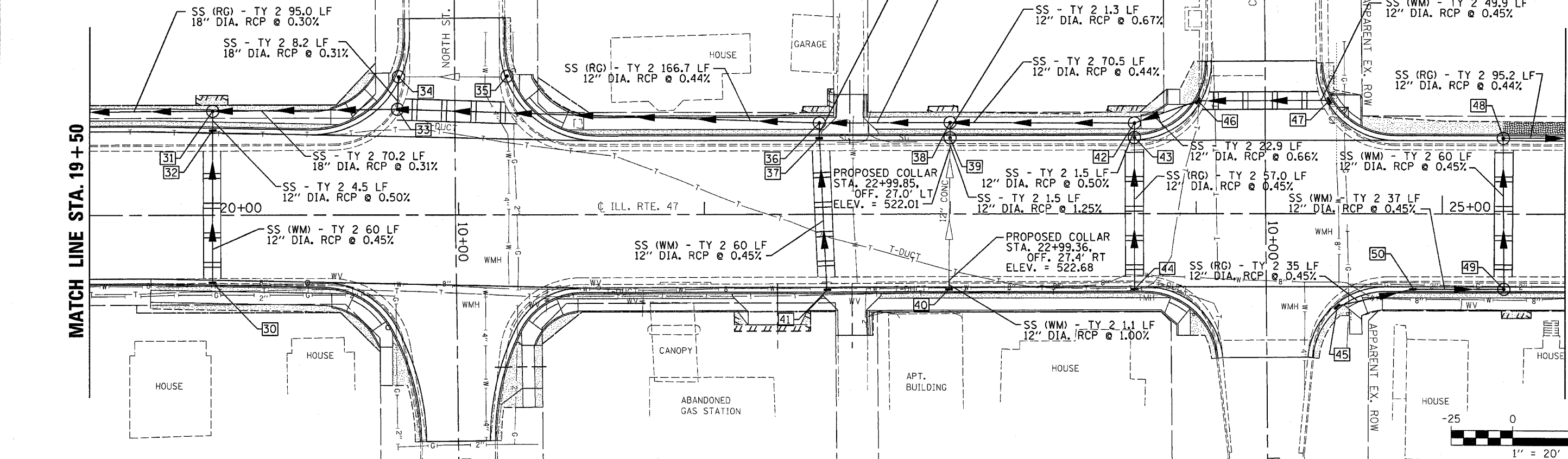

DATE	
BY	
REVISION	
NO.	
DESCRIPTION	

DATE	
BY	
REVISION	
NO.	
DESCRIPTION	

STRUCT NUMBER	STATION	OFFSET	RIM ELEV.	INVERT ELEV.	STRUCTURE TYPE	STRUCT NUMBER	STATION	OFFSET	RIM ELEV.	INVERT ELEV.	STRUCTURE TYPE	
545	30	20+00.0 26.5' RT.	525.91	521.77 W	INLET TYPE A W/ TYPE 3 FRAME & GRATE	41	22+50.0	30.0' RT.	525.73	519.71 W	INLET TYPE A W/ TYPE 3 FRAME & GRATE	545
	31	20+00.0 42.6' LT.	526.41	518.18 N; 518.18 S; 521.36 E	MANHOLE TYPE A 5' DIA. W/ TYPE 1 FRAME CL	42	23+75.0	37.0' LT.	526.09	520.81 N; 520.57 S; 520.57 E	MANHOLE TYPE A 5' DIA. W/ TYPE 1 FRAME CL	
	32	20+00.0 33.4' LT.	525.91	521.40 W; 521.50 E	INLET TYPE B W/ TYPE 3 FRAME & GRATE	43	23+75.0	30.0' LT.	525.84	520.60 E; 520.60 W	MANHOLE TYPE A 5' DIA. W/ TYPE 3 FRAME & GRATE	
540	33	20+75.0 43.2' LT.	525.50	518.54 N; 518.41 S; 520.29 W	MANHOLE TYPE A 5' DIA. W/ TYPE 1 FRAME CL	44	23+75.0	30.0' RT.	525.84	520.88 W; 520.88 NE	INLET TYPE B W/ TYPE 3 FRAME & GRATE	540
	34	20+75.4 55.1' LT.	525.19	521.27 N; 520.33 E	MANHOLE TYPE A 6' DIA. W/ TYPE 3 FRAME & GRATE	45	24+54.0	39.8' RT.	525.89	523.01 N	INLET TYPE A W/ TYPE 3 FRAME & GRATE	
	35	21+20.0 56.2' LT.	525.08	521.95 S	MANHOLE TYPE A 5' DIA. W/ TYPE 3 FRAME & GRATE	46	24+00.7	46.1' LT.	525.58	520.96 N; 520.96 S	INLET TYPE B W/ TYPE 3 FRAME & GRATE	
535	36	22+46.7 37.3' LT.	525.94	520.00 N; 519.30 S; 519.30 E	MANHOLE TYPE A 5' DIA. W/ TYPE 1 FRAME CL	47	24+54.1	46.4' LT.	525.68	521.20 S	INLET TYPE A W/ TYPE 3 FRAME & GRATE	535
	37	22+46.7 30.0' LT.	525.73	519.34 W; 519.44 E	INLET TYPE B W/ TYPE 3 FRAME & GRATE	48	25+25.0	30.0' LT.	525.90	522.17 N; 522.25 E	MANHOLE TYPE A 4' DIA. W/ TYPE 3 FRAME & GRATE	
	38	23+00.0 37.3' LT.	526.18	520.24 N; 520.24 S; 520.70 E	MANHOLE TYPE A 5' DIA. W/ TYPE 1 FRAME CL	49	25+25.0	30.0' RT.	525.90	522.52 W; 522.60 S	MANHOLE TYPE A 4' DIA. W/ TYPE 3 FRAME & GRATE	
530	39	23+00.0 30.0' LT.	525.65	521.96 E; 520.74 W	MANHOLE TYPE A 5' DIA. W/ TYPE 3 FRAME & GRATE	50	24+88	30.0' RT.	525.99	522.77 N; 522.85 S	INLET TYPE B W/ TYPE 3 FRAME & GRATE	530
	40	23+00.0 30.0' RT.	525.65	522.72 S; 522.72 W	INLET TYPE B W/ TYPE 3 FRAME & GRATE							

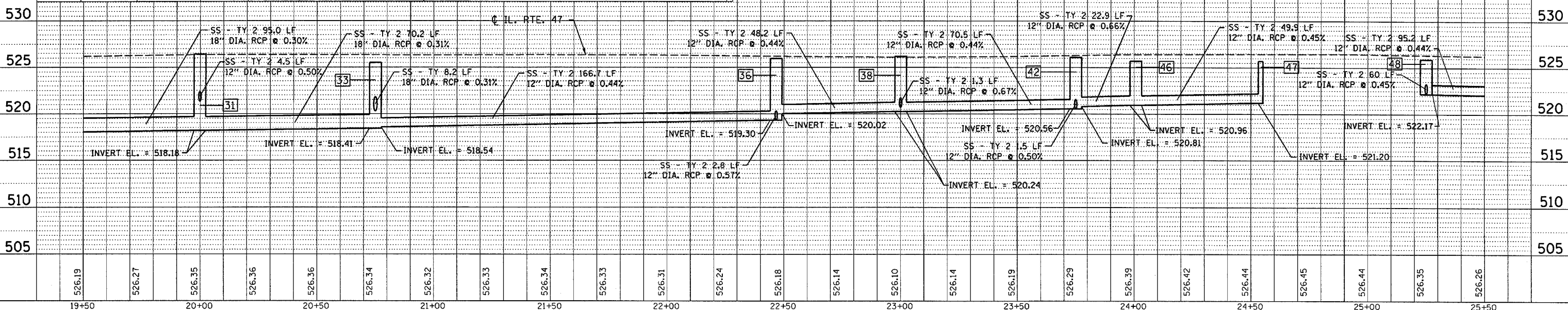

May 15, 2008 - 04:04:23 PM
 c:\pro\sect\p05802\constr\11\phase 2\ldp.dwg