

GENERAL NOTES

PLAN DIMENSIONS AND DETAILS RELATIVE TO EXISTING ROADWAY OR STRUCTURE HAVE BEEN TAKEN FROM EXISTING PLANS AND ARE SUBJECT TO NOMINAL CONSTRUCTION VARIATIONS. IT SHALL BE THE CONTRACTOR'S RESPONSIBILITY TO VERIFY SUCH DIMENSIONS AND DETAILS IN THE FIELD AND TO MAKE NECESSARY APPROVED ADJUSTMENTS PRIOR TO CONSTRUCTION OR ORDERING OF MATERIALS. SUCH VARIATIONS SHALL NOT BE CAUSE FOR ADDITIONAL COMPENSATION FOR A CHANGE IN THE SCOPE OF THE WORK, HOWEVER, THE CONTRACTOR WILL BE PAID FOR THE QUANTITY ACTUALLY FURNISHED AT THE UNIT BID FOR THE WORK.

FOR STABILIZATION, ALL TYPE III BARRICADES SHALL REQUIRE A MINIMUM OF FOUR SAND BAGS PER BARRICADE.

THE CONTRACTOR SHALL BE RESPONSIBLE FOR PROTECTING UTILITY PROPERTY FROM CONSTRUCTION OPERATIONS AS OUTLINED IN ARTICLE 107.31 OF THE STANDARD SPECIFICATIONS. THE "JULIE" NUMBER IS 1-800-892-0123. A MINIMUM OF FORTY-EIGHT (48) HOURS ADVANCE NOTICE IS REQUIRED.

WHERE SECTION OR SUBSECTION MONUMENTS ARE ENCOUNTERED, THE ENGINEER SHALL BE NOTIFIED BEFORE SUCH MONUMENTS ARE REMOVED. THE CONTRACTOR SHALL PROTECT AND CAREFULLY PRESERVE ALL MONUMENTS UNTIL AN AUTHORIZED SURVEYOR OR AGENT HAS WITNESSED OR OTHERWISE REFERENCED THEIR LOCATION. THE CONTRACTOR SHALL BE RESPONSIBLE FOR HAVING AN AUTHORIZED SURVEYOR REESTABLISH ANY SECTION OR SUBSECTION MONUMENTS DESTROYED BY HIS OPERATIONS.

ABANDONED UNDERGROUND UTILITIES THAT CONFLICT WITH CONSTRUCTION SHALL BE DISPOSED OF OUTSIDE THE LIMITS OF THE RIGHT OF WAY ACCORDING TO ARTICLE 202.03 OF THE STANDARD SPECIFICATIONS AND AS DIRECTED BY THE ENGINEER. THIS WORK WILL NOT BE PAID FOR SEPARATELY BUT SHALL BE INCLUDED IN THE COST OF CLASS A PATCHING.

THE THICKNESS OF HMA SHOWN ON THE PLANS IS THE NOMINAL THICKNESS. DEVIATIONS FROM THE NOMINAL THICKNESS WILL BE PERMITTED WHEN SUCH DEVIATIONS OCCUR DUE TO IRREGULARITIES IN THE EXISTING SURFACE OR BASE ON WHICH THE HMA IS PLACED.

ANY REFERENCE TO A STANDARD IN THESE PLANS SHALL BE INTERPRETED TO MEAN THE EDITION AS INDICATED BY THE SUBNUMBER LISTED ON THE INDEX OF SHEETS OR THE COPY OF THE STANDARD INCLUDED IN THESE PLANS.

ALL NEW REINFORCEMENT BARS SHALL BE "EPOXY COATED" EXCEPT AS SHOWN.

EXISTING REINFORCEMENT BARS EXTENDING INTO REMOVAL AREA SHALL BE CLEANED, STRAIGHTENED AND INCORPORATED INTO THE NEW CONSTRUCTION. ANY REINFORCEMENT BARS THAT ARE DAMAGED DURING CONCRETE REMOVAL SHALL BE REPLACED WITH AN APPROVED BAR SPLICER OR ANCHORAGE SYSTEM. COST INCLUDED WITH CONCRETE REMOVAL.

DATE: 3.25.08

PREPARED BY: R. Powell
DISTRICT STUDIES & PLANS ENGINEER

EXAMINED BY: Herbert K. Jorgensen
DISTRICT CONSTRUCTION ENGINEER

J. J. [Signature]
DISTRICT MATERIALS ENGINEER

Bruce Hucker
DISTRICT OPERATIONS ENGINEER

FILE NAME = c:\projects\main\09\cm310\details.dgn	USER NAME = woodshankr1	DESIGNED - RLW	REVISED - ---
		DRAWN - RLW	REVISED - ---
	PLOT SCALE = 1/8" = 1'-0" IN.	CHECKED - ---	REVISED - ---
	PLOT DATE = Mar 14, 2008 - 04:22:25 PM	DATE - ---	REVISED - ---

**STATE OF ILLINOIS
DEPARTMENT OF TRANSPORTATION**

GENERAL NOTES

SCALE: _____ SHEET NO. 1 OF 1 SHEETS

*FAI 57 & FAP 332 **D3 PAVEMENT PATCHING 2009-02			
SECTION	COUNTY	TOTAL SHEETS	SHEET NO.
•	•	16	2
•	•	ILLINOIS	
FED. ROAD DIST. NO. - ILLINOIS		CONTRACT NO. 66800	

SUMMARY OF QUANTITIES

FAP.332 RURAL 100% STATE F.A.I.57
 PROJECT 1 PPS# 0-00859-3010
 PROJECT 2 PPS# 0-00859-3011

CODE NO.	ITEM	UNIT	TOTAL QUANTITY	J000	J000
44200676	CLASS A PATCHES, TYPE II	SQ YD	430	430	
44200680	CLASS A PATCHES, TYPE IV	SQ YD	27	27	
44201076	CLASS B PATCHES, TYPE II	SQ YD	504		504
44201078	CLASS B PATCHES, TYPE III	SQ YD	109		109
44201080	CLASS B PATCHES, TYPE IV	SQ YD	87		87
44213000	PATCHING REINFORCEMENT	SQ YD	457	457	
44213100	PAVEMENT FABRIC	SQ YD	1354	457	897
44213200	SAW CUTS	FOOT	6540	3276	3264
67100100	MOBILIZATION	L SUM	1	0.5	0.5
70100420	TRAFFIC CONTROL AND PROTECTION, STANDARD 701411	EACH	12	12	
70100600	TRAFFIC CONTROL AND PROTECTION, STANDARD 701336	L SUM	1		1
70100800	TRAFFIC CONTROL AND PROTECTION, STANDARD 701401	L SUM	1	1	
70103815	TRAFFIC CONTROL SURVEILLANCE	CAL DA	15	6	9
* 78008210	POLYUREA PAVEMENT MARKING TYPE 1 - LINE 4"	FOOT	839	354	485
* 78008230	POLYUREA PAVEMENT MARKING TYPE 1 - LINE 6"	FOOT	186	89	97
Z0017202	DOWEL BARS 1 1/2"	EACH	1293		1293
Z0075310	TIE BARS 3/4"	EACH	30	10	20

* SPECIALTY ITEM

FILE NAME = c:\projects\cmain09\cm310\detais.dgn	USER NAME = woodshankr1	DESIGNED - RLW	REVISED - ---
		DRAWN - RLW	REVISED - ---
		CHECKED - ---	REVISED - ---
		DATE - ---	REVISED - ---

STATE OF ILLINOIS
 DEPARTMENT OF TRANSPORTATION

SUMMARY OF QUANTITIES
 SCALE: _____ SHEET NO. 1 OF 1 SHEETS

*FAI 57 & FAP 332 **03 PAVEMENT PATCHING 2009-02	
SECTION	COUNTY
ILLINOIS	ILLINOIS
TOTAL SHEETS	SHEET NO.
16	3
CONTRACT NO. 66800	
FED. ROAD DIST. NO. - ILLINOIS	

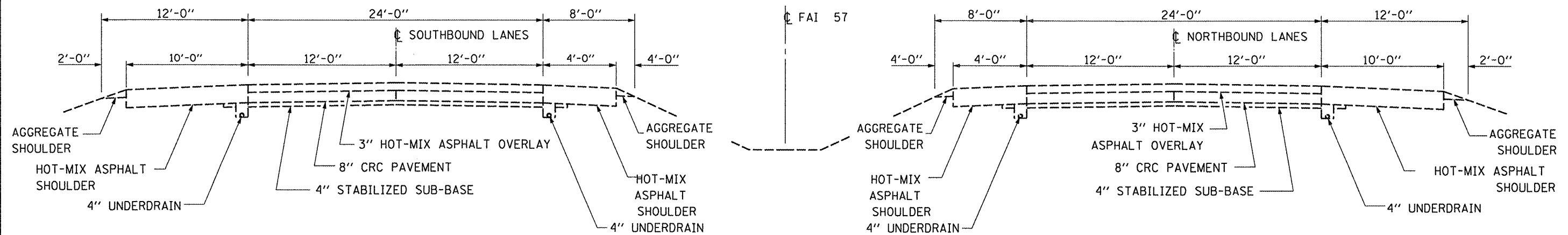

TYPICAL SECTION 1

M.P. 263.49 TO M.P. 281.04

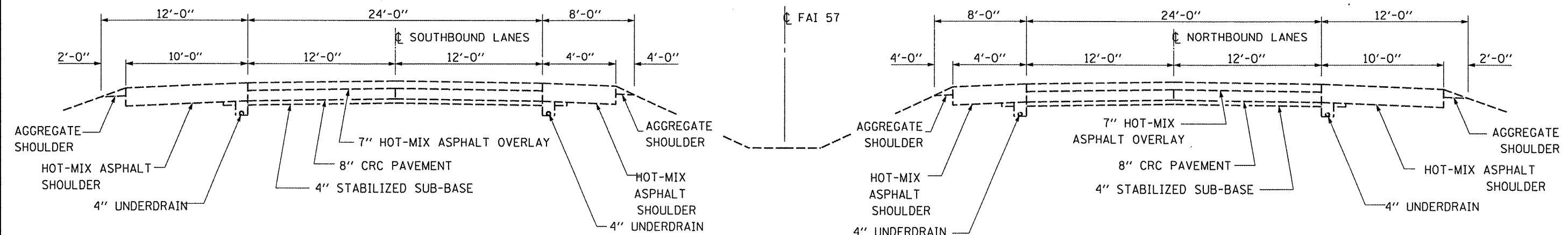

TYPICAL SECTION 2

M.P. 281.04 TO M.P. 285.54

FILE NAME =	USER NAME = woodshenkr1	DESIGNED - RLW	REVISED - ---
c:\projects\main\09\on310\details.dgn		DRAWN - RLW	REVISED - ---
PLOT SCALE = 1/8" = 1'-0"		CHECKED - ---	REVISED - ---
PLOT DATE = Mar 14, 2008 - 04:22:36 PM		DATE - ---	REVISED - ---

STATE OF ILLINOIS
DEPARTMENT OF TRANSPORTATION

EXSITING TYPICAL SECTIONS - FAI 57

SCALE: _____ SHEET NO. 1 OF 2 SHEETS

*FAI 57 & FAP 332		**D3 PAVEMENT PATCHING 2009-02	
SECTION	COUNTY	TOTAL SHEETS	SHEET NO.
**	IROQUOIS	16	4
FED. ROAD DIST. NO. - ILLINOIS		CONTRACT NO. 66800	

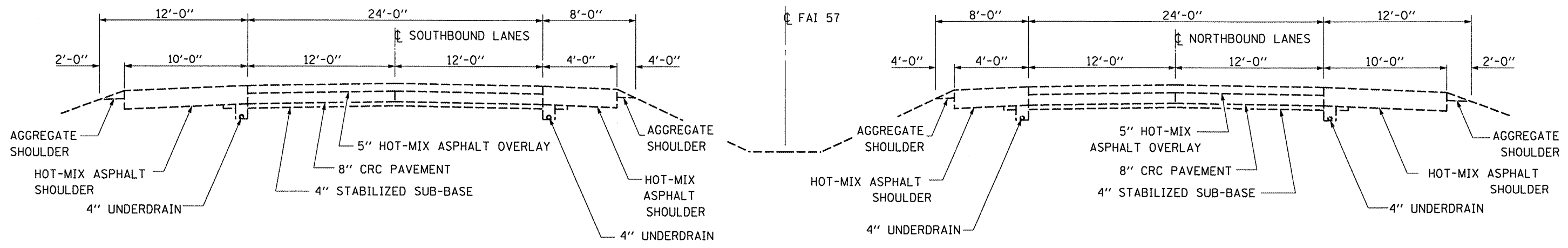

TYPICAL SECTION 3
M.P. 285.54 TO M.P. 296.65

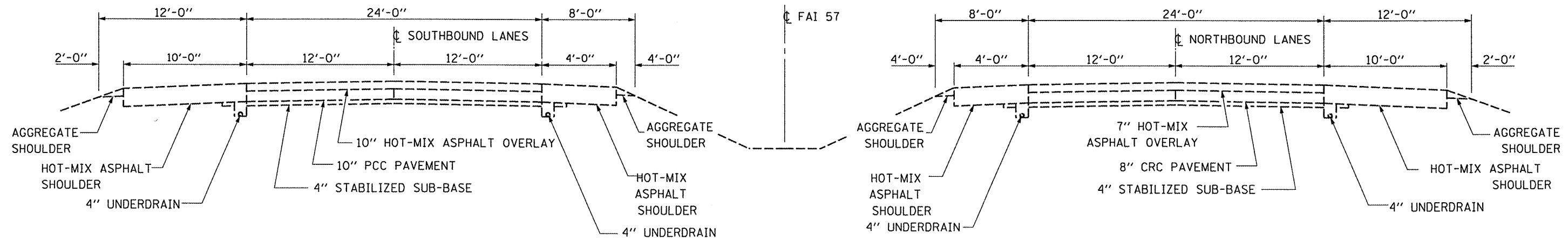

TYPICAL SECTION 4
M.P. 296.65 TO M.P. 301.96

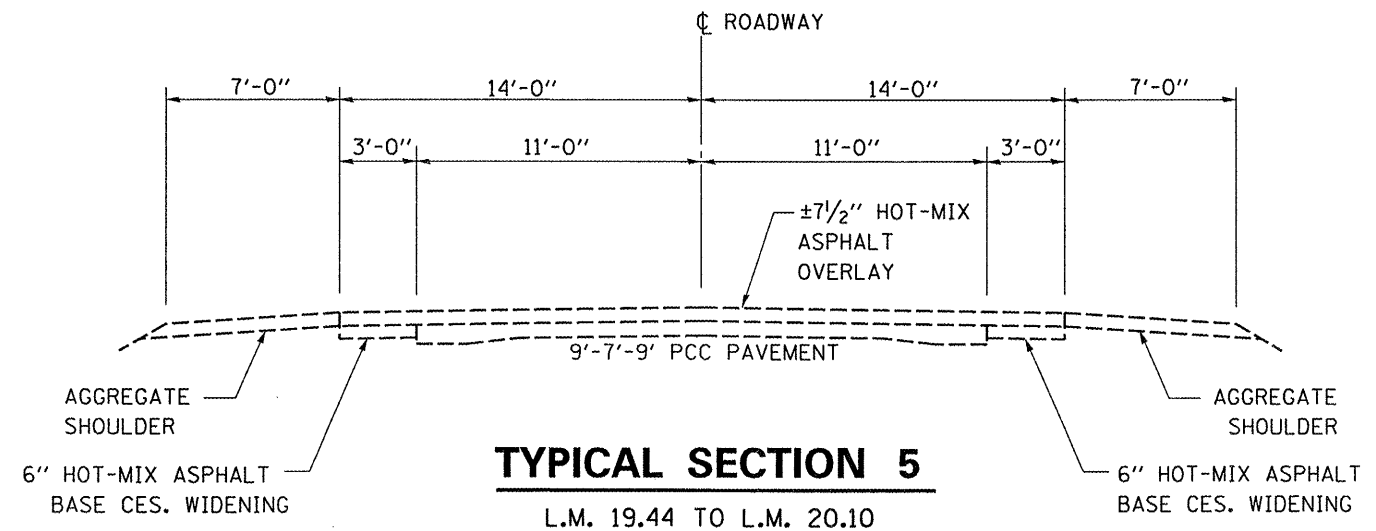
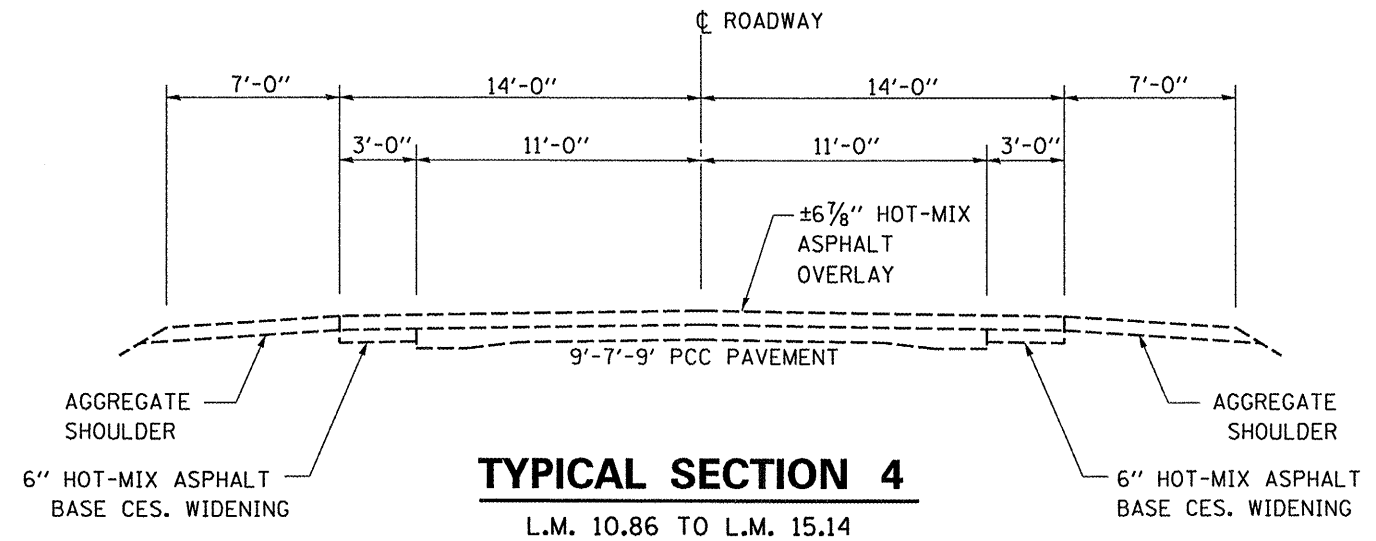
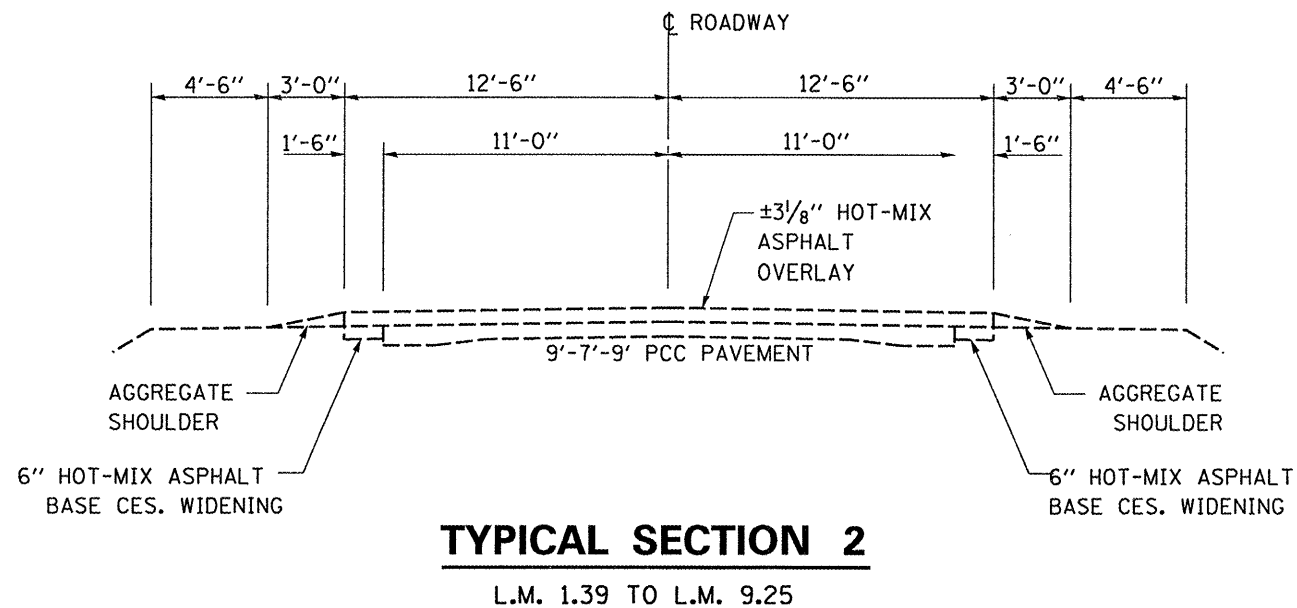
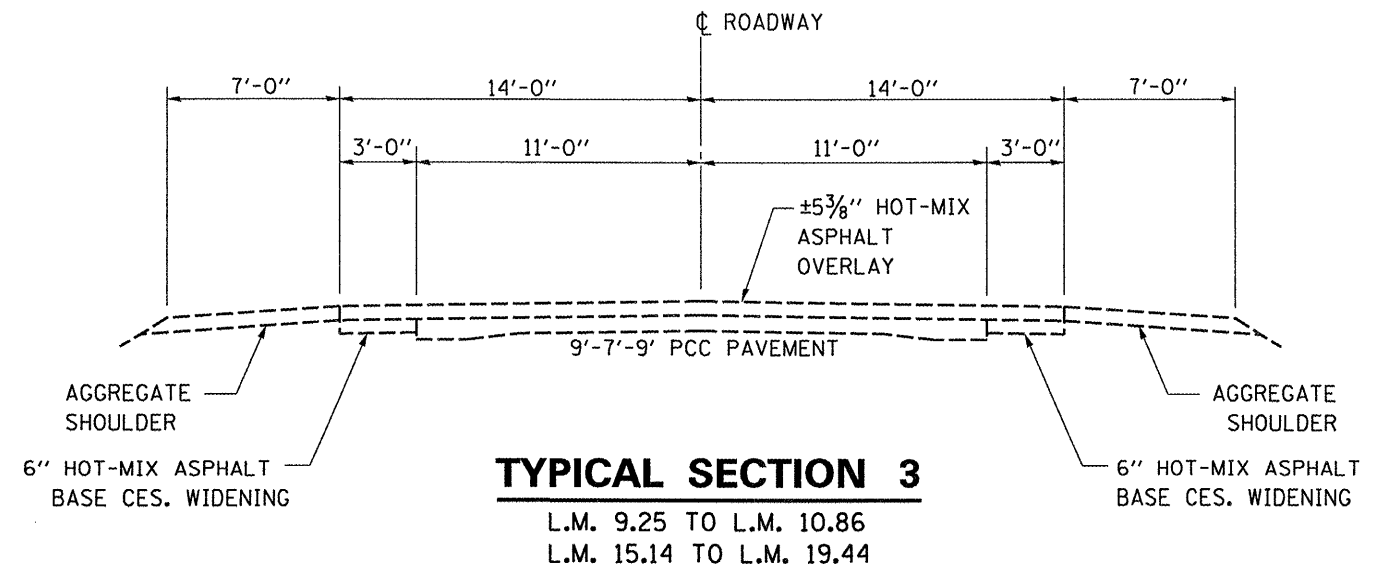
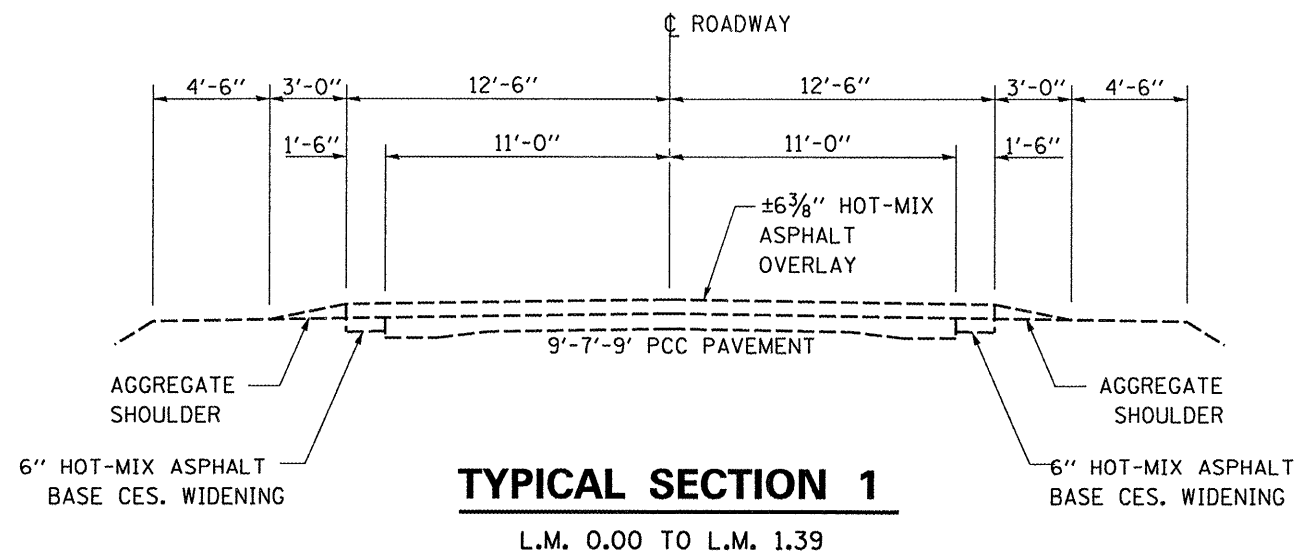

FILE NAME =	USER NAME = woodshankr1	DESIGNED - RLW	REVISED - ---
c:\projects\main\09\cm310\details.dgn		DRAWN - RLW	REVISED - ---
PLOT SCALE = 1/8" = 1' / IN.	CHECKED - ---	REVISED - ---	REVISED - ---
PLOT DATE = Mar 14, 2008 - 04:22:53 PM	DATE - ---	REVISED - ---	REVISED - ---

STATE OF ILLINOIS
DEPARTMENT OF TRANSPORTATION

EXISTING TYPICAL SECTIONS - FAP 332

SCALE: _____ SHEET NO. 1 OF 1 SHEETS

*FAI 57 & FAP 332	**D3 PAVEMENT PATCHING 2009-02		
SECTION	COUNTY	TOTAL SHEETS	SHEET NO.
**	IRROUOIS	16	6
FED. ROAD DIST. NO. - ILLINOIS		CONTRACT NO. 66800	

CLASS A PATCHING SCHEDULE - NORTHBOUND LANES

LOCATION		PASSING LANE						DRIVING LANE					
MILE POST	LANE	CLASS A PATCHING		PATCH REINF.	PAVEMENT FABRIC	SAW CUTS	TIE BARS	CLASS A PATCHING		PATCH REINF.	PAVEMENT FABRIC	SAW CUTS	TIE BARS
		TYPE II	TYPE IV					TYPE II	TYPE IV				
		SQ YD	SQ YD	SQ YD	SQ YD	FOOT	EACH	SQ YD	SQ YD	SQ YD	SQ YD	FOOT	EACH
263.49	NB	FORD COUNTY LINE											
269.70	NB							8		8	8	60	
277.30	NB							8		8	8	60	
277.40	NB							8		8	8	60	
279.80	NB							8		8	8	60	
280.13	NB	ILL ROUTE 54 INTERCHANGE (ONARGA)											
283.10	NB							8		8	8	60	
283.04	NB	US ROUTE 24 INTERCHANGE (GILMAN)											
292.84	NB	ILL ROUTE 116 INTERCHANGE (ASHKUM)											
*293.40	NB							8		8	8	60	
293.60	NB	8		8	8	60						0	
293.70	NB		27	27	27	88	10					0	
293.80	NB	8		8	8	60		8		8	8	60	
294.70	NB	8		8	8	60						0	
295.60	NB	8		8	8	60		8		8	8	60	
295.65	NB	8		8	8	60		8		8	8	60	
295.80	NB	8		8	8	60		8		8	8	60	
295.80	NB	8		8	8	60						0	
295.90	NB							8		8	8	60	
296.80	NB	8		8	8	60						0	
296.85	NB							8		8	8	60	
297.20	NB							8		8	8	60	
298.01	NB	8		8	8	60		8		8	8	60	
301.96	NB	KANKAKEE COUNTY LINE											
TOTAL		72	27	99	99	628	10	112		112	112	840	

FILE NAME = c:\projects\main\cm310\details.dgn

USER NAME = woodshenrj
 PLOT SCALE = 1/8" = 1' IN.
 PLOT DATE = Mar 14, 2009 - 04:22:59 PM

DESIGNED - RLW
 DRAWN - RLW
 CHECKED -
 DATE -

REVISED -
 REVISIONS -
 REVISIONS -
 REVISIONS -

**STATE OF ILLINOIS
 DEPARTMENT OF TRANSPORTATION**

SCHEDULES - FAI 57

SCALE: SHEET NO. 1 OF 3 SHEETS

*FAI 57 & FAP 332 **D3 PAVEMENT PATCHING 2009-02

SECTION	COUNTY	TOTAL SHEETS	SHEET NO.
**	ILLINOIS	17	7
		CONTRACT NO. 66800	

FED. ROAD DIST. NO. - ILLINOIS

CLASS A PATCHING SCHEDULE - SOUTHBOUND LANES

LOCATION		PASSING LANE					DRIVING LANE						
MILE POST	LANE	CLASS A PATCHING TYPE II SQ YD	CLASS A PATCHING TYPE IV SQ YD	PATCH REINF. SQ YD	PAVEMENT FABRIC SQ YD	SAW CUTS FOOT	TIE BARS EACH	CLASS A PATCHING TYPE II SQ YD	CLASS A PATCHING TYPE IV SQ YD	PATCH REINF. SQ YD	PAVEMENT FABRIC SQ YD	SAW CUTS FOOT	TIE BARS EACH
301.96	SB	KANKAKEE COUNTY LINE											
296.40	SB	8		8	8	60							
292.84	SB	ILL ROUTE 116 INTERCHANGE (ASHKUM)											
292.80	SB	8		8	8	60		8		8	8	60	
292.20	SB	8		8	8	60		8		8	8	60	
283.04	SB	US ROUTE 24 INTERCHANGE (GILMAN)											
281.20	SB	8		8	8	60		8		8	8	60	
281.10	SB							8		8	8	60	
280.90	SB	8		8	8	60							
280.60	SB							8		8	8	60	
280.13	SB	ILL ROUTE 54 INTERCHANGE (ONARGA)											
279.90	SB							8		8	8	60	
279.80	SB	8		8	8	60		8		8	8	60	
279.70	SB							8		8	8	60	
278.70	SB							8		8	8	60	
278.40	SB							8		8	8	60	
278.40	SB							8		8	8	60	
276.60	SB							8		8	8	60	
276.20	SB							8		8	8	60	
275.80	SB							8		8	8	60	
275.50	SB							8		8	8	60	
275.50	SB							8		8	8	60	
275.00	SB							8		8	8	60	
271.15	SB	8		8	8	60		8		8	8	60	
269.60	SB	11		11	11	64		11		11	11	64	
269.50	SB							8		8	8	60	
268.50	SB	8		8	8	60		8		8	8	60	
263.49	SB	FORD COUNTY LINE											
TOTAL		75		75	75	544		171		171	171	1264	

FILE NAME = c:\projects\main09\cm310\details.dgn	USER NAME = woodshenkr1	DESIGNED - RLW	REVISED -
		DRAWN - RLW	REVISED -
		CHECKED -	REVISED -
		DATE -	REVISED -

**STATE OF ILLINOIS
DEPARTMENT OF TRANSPORTATION**

SCHEDULES - FAI 57

SCALE: _____ SHEET NO. 2 OF 3 SHEETS

*FAI 57 & FAP 332	**D3 PAVEMENT PATCHING 2009-02
SECTION	COUNTY TOTAL SHEETS
**	ILLINOIS 17 8
CONTRACT NO. 66800	

FED. ROAD DIST. NO. - ILLINOIS

PAVEMENT MARKING SCHEDULE - NORTHBOUND LANES				
LOCATION		POLYUREA PAVEMENT MARKING TYPE 1 LINE 4"		POLYUREA PAVEMENT MARKING TYPE 1 LINE 6"
MILE POST	LANE	FEET		FEET
		YELLOW	WHITE	WHITE
263.49	NB	FORD COUNTY LINE		
269.70	NB		6	2
277.30	NB		6	2
277.40	NB		6	2
279.80	NB		6	2
280.13	NB	ILL ROUTE 54 INTERCHANGE (ONARGA)		
283.10	NB		6	2
283.04	NB	ILL ROUTE 54 INTERCHANGE (ONARGA)		
292.84	NB	ILL ROUTE 116 INTERCHANGE (ASHKUM)		
*293.40	NB		6	2
293.60	NB	6		2
293.70	NB	20		5
293.80	NB	6	6	2
294.70	NB	6		2
295.60	NB	6	6	2
295.65	NB	6	6	2
295.80	NB	6	6	2
295.80	NB	6		2
295.90	NB		6	2
296.80	NB	6		2
296.85	NB		6	2
297.20	NB		6	2
298.01	NB	6	6	2
301.96	NB	KANKAKEE COUNTY LINE		
TOTAL		158		41

*DENOTES RAMP PAVEMENT

PAVEMENT MARKING SCHEDULE - SOUTHBOUND LANES				
LOCATION		POLYUREA PAVEMENT MARKING TYPE 1 LINE 4"		POLYUREA PAVEMENT MARKING TYPE 1 LINE 6"
MILE POST	LANE	FEET		FEET
		YELLOW	WHITE	WHITE
301.96	NB	KANKAKEE COUNTY LINE		
297.75	NB	6	6	2
296.40	NB	6		2
292.84	NB	ILL ROUTE 116 INTERCHANGE (ASHKUM)		
292.80	NB	6	6	2
292.20	NB	6	6	2
283.04	NB	ILL ROUTE 54 INTERCHANGE (ONARGA)		
281.20	NB	6	6	2
281.10	NB		6	2
280.90	NB	6		2
280.60	NB		6	2
280.13	NB	ILL ROUTE 54 INTERCHANGE (ONARGA)		
279.90	NB		6	2
279.80	NB	6	6	2
279.70	NB		6	2
278.70	NB		6	2
278.40	NB		6	2
278.40	NB		6	2
276.60	NB		6	2
276.20	NB		6	2
275.80	NB		6	2
275.50	NB		6	2
275.50	NB		6	2
275.00	NB		6	2
271.15	NB	6	6	2
269.60	NB	8	8	2
269.50	NB		6	2
268.50	NB	6	6	2
263.49	NB	FORD COUNTY LINE		
TOTAL		196		48

FILE NAME = c:\projects\main\09\cm310\details.dgn

USER NAME = woodshenkr1

DESIGNED - RLW

REVISED - ---

DRAWN - RLW

REVISED - ---

PLOT SCALE = 1/8" = 1' / IN.

CHECKED - ---

REVISED - ---

PLOT DATE = Mar 14, 2008 - 04:23:09 PM

DATE - ---

REVISED - ---

STATE OF ILLINOIS
DEPARTMENT OF TRANSPORTATION

SCHEDULES - FAI 57

SCALE: SHEET NO. 3 OF 3 SHEETS

*FAI 57 & FAP 332 **D3 PAVEMENT PATCHING 2009-02

SECTION	COUNTY	TOTAL SHEETS	SHEET NO.
**	ILLINOIS	17	9
CONTRACT NO. 66800			

FED. ROAD DIST. NO. ILLINOIS

CLASS B PATCHING SCHEDULE

LOCATION LOG MILE	NORTHBOUND LANE							SOUTHBOUND LANE								
	CLASS B PATCHING			DOWEL	SAW	PVMT	TIE	CLASS B PATCHING			DOWEL	SAW	PVMT	TIE		
	TYPE II	TYPE III	TYPE IV	BARS	CUTS	FABRIC	BARS	TYPE II	TYPE III	TYPE IV	BARS	CUTS	FABRIC	BARS		
SQ YD	SQ YD	SQ YD	EACH	FOOT	SQ YD	EACH	SQ YD	SQ YD	SQ YD	EACH	FOOT	SQ YD	EACH			
0.00	US ROUTE 24															
0.277		21		21	68	42			21			21	68	42		
0.283										25			21	74	50	
1.648								8					21	50	8	
1.661	8			21	50	8		8					21	50	8	
1.776	8			21	50	8		8					21	50	8	
1.902								8					21	50	8	
2.313	8			21	50	8		8					21	50	8	
2.449									21				21	68	42	
2.850	8			21	50	8		8					21	50	8	
3.173	8			21	50	8										
3.363	11			21	54	11		11					21	54	11	
3.877	8			21	50	8		8					21	50	8	
3.953	8			21	50	8		8					21	50	8	
4.105	11			21	54	11		11					21	54	11	
4.533	8			21	50	8		14					21	58	14	
5.479								11					21	54	11	
5.921	14			21	58	14		14					21	58	14	
6.165	14			21	58	14										
6.475	8			21	50	8		8					21	50	8	
6.803	11			21	54	11		11					21	54	11	
6.518	8			21	50	8		8					21	50	8	
6.977								8					21	50	8	
7.296								8					21	50	8	
8.354	8			21	50	8										
9.197	8			21	50	8		8					21	50	8	
9.761	11			21	54	11										
15.425	12			24	58	12			23				24	72	47	
15.805	9			24	54	9										
15.916								9					24	54	9	
16.435								12					24	58	12	
16.982	12			24	58	12		12					24	58	12	
17.099								9					24	54	9	
17.355								9					24	54	9	
17.392	9			24	54	9										
17.506		23		24	72	47										
17.657			31	24	82	62	10			31			24	82	62	10
19.325	9			24	54	9										
19.516	12			24	58	12		12					24	58	12	
19.910	9			24	54	9										
19.945								12					24	58	12	
20.110	VERMILION COUNTY LINE															
TOTAL	246	44	31	615	1535	397	10	258	65	56	678	1729	500	10		

FILE NAME = c:\projects\main\09\cm310\details.dgn
 USER NAME = woodshankr
 PLOT SCALE = 1/8" = 100'-0" IN.
 PLOT DATE = Mar 14, 2008 - 04:23:13 PM

DESIGNED - RLW
 DRAWN - RLW
 CHECKED -
 DATE -

REVISED -
 REVISED -
 REVISED -
 REVISED -

**STATE OF ILLINOIS
 DEPARTMENT OF TRANSPORTATION**

SCHEDULES - FAP 332
 SCALE: SHEET NO. 1 OF 3 SHEETS

*FAI 57 & FAP 332 **D3 PAVEMENT PATCHING 2009-02
 SECTION COUNTY TOTAL SHEETS SHEET NO.
 IROUOIS 17 10
 CONTRACT NO. 66800
 FED. ROAD DIST. NO. ILLINOIS

PAVEMENT MARKING SCHEDULE			
LOCATION MILE POST	POLYUREA PAVEMENT MARKING TYPE 1 LINE 4"		POLYUREA PAVEMENT MARKING TYPE 1 LINE 6"
	FEET		FEET
	YELLOW	WHITE	YELLOW
0.00	US ROUTE 24		
0.277	15	15	4
0.283		18	5
1.648		6	2
1.661	6	6	2
1.776	6	6	2
1.902		6	2
2.313	6	6	2
2.449		15	4
2.850	6	6	2
3.173	6		2
3.363	8	8	2
3.877	6	6	2
3.953	6	6	2
4.105	8	8	2
4.533	6	10	3
5.479		8	2
5.921	10	10	3
6.165	10		3
6.475	6	6	2
6.803	8	8	2
6.518	6	6	2
6.977		6	2
7.296		6	2
8.354	6		2
9.197	6	6	2
9.761	8		2
15.425	8	15	4
15.805	6		2
15.916		6	2
16.435		8	2
16.982	8	8	2
17.099		6	2
17.355		6	2
17.392	6		2
17.506	15		4
17.657	20	20	5
19.325	6		2
19.516	8	8	2
19.910	6		2
19.945		8	2
20.11	VERMILION COUNTY LINE		
TOTAL	485		97

FILE NAME =	USER NAME = woodshenkr1	DESIGNED - RLW	REVISED - ---
c:\projects\main\310\details.dgn		DRAWN - RLW	REVISED - ---
	PLOT SCALE = 103.4629' / IN.	CHECKED - ---	REVISED - ---
	PLOT DATE = Mar 14, 2008 - 04:23:18 PM	DATE - ---	REVISED - ---

STATE OF ILLINOIS
DEPARTMENT OF TRANSPORTATION

SCHEDULES - FAP 332

SCALE: _____ SHEET NO. 2 OF 3 SHEETS

*FAI 57 & FAP 332 **D3 PAVEMENT PATCHING 2009-02		SECTION	COUNTY	TOTAL SHEET NO.
*	**	IRROQUOIS	17	11
			CONTRACT NO. 66800	
FED. ROAD DIST. NO. - ILLINOIS				

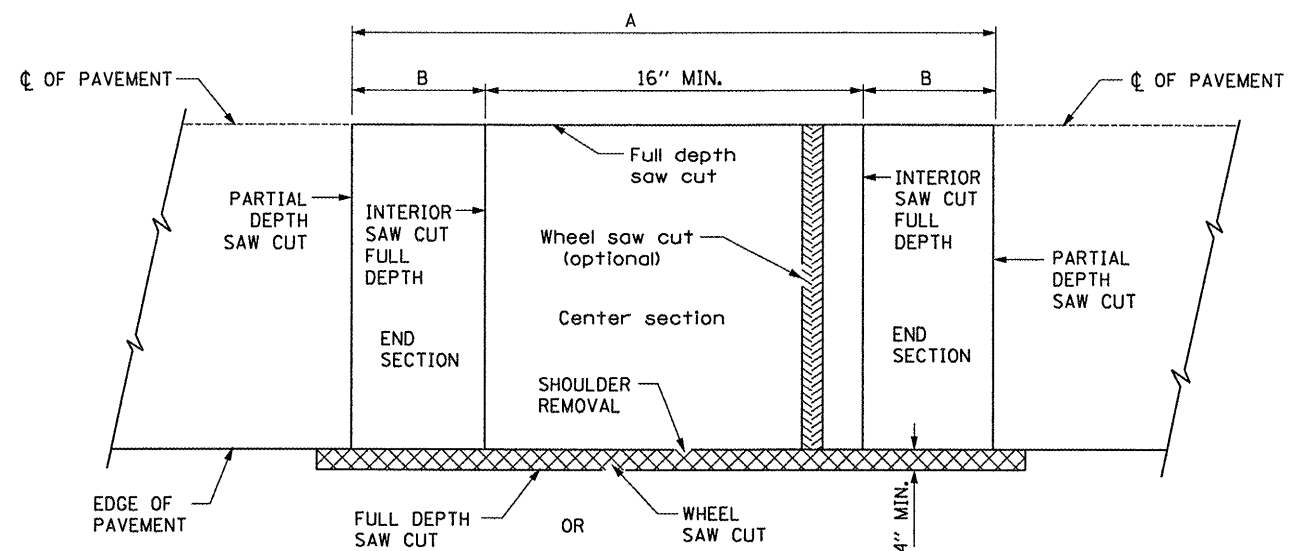

EXISTING PAVEMENT SAWING DETAIL
(AGAINST BITUMINOUS SHOULDER)

EXISTING LONGITUDINAL REINFORCEMENT BARS	A (min.)	B (min.)	C (min.)
No. 6	6'-0"	24"	19"

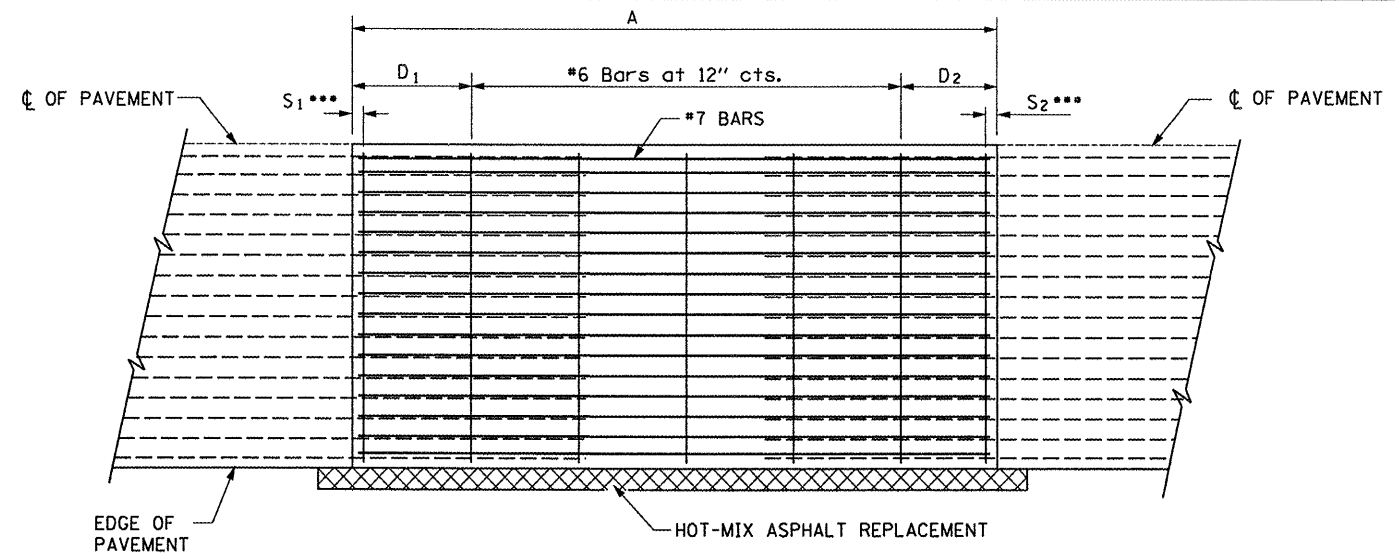

PROPOSED PAVEMENT DETAIL
(AGAINST BITUMINOUS SHOULDER)

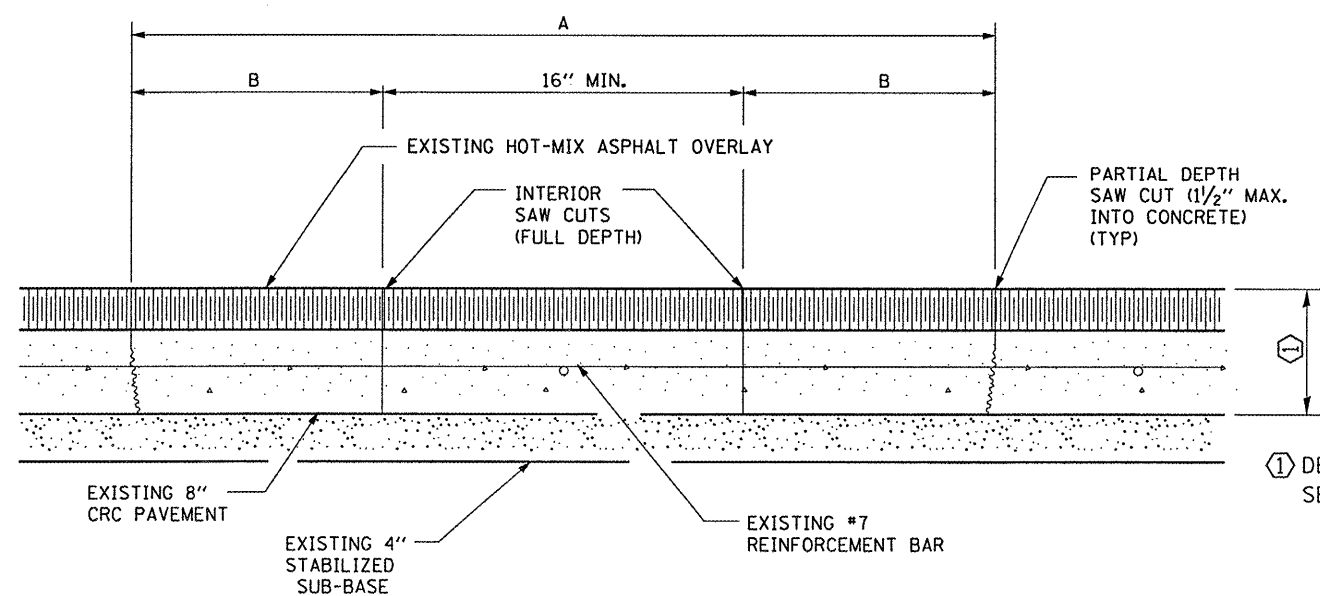

EXISTING PAVEMENT SAW CUTTING DETAIL

① DEPTH VARIES
SEE TYPICAL SECTIONS

NOTES:

- EVERY 3rd INTERSECTION MUST BE TIED
- LAP NEW REINFORCEMENT WITH EXISTING LONGITUDINAL REINFORCEMENT
- VARIABLES: WHERE S₁ AND S₂ ARE 2 1/2" MIN. AND 12" MAX. D₁ = 2(S₁) AND D₂ = 2(S₂)

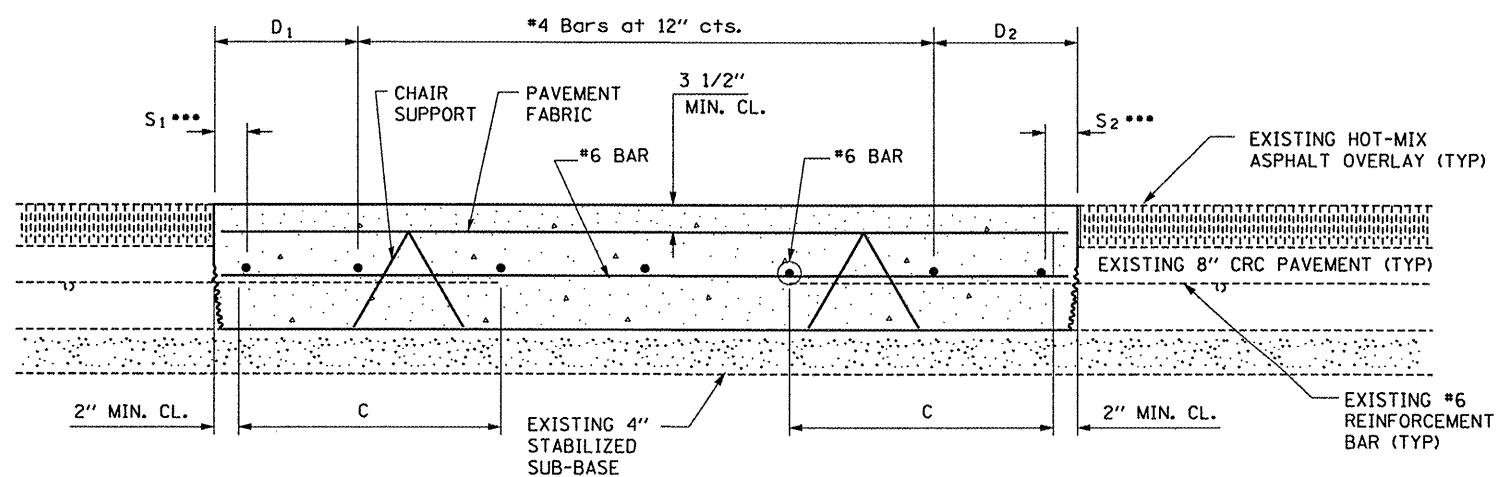

PROPOSED CLASS A PATCHING DETAIL

FILE NAME =	USER NAME = woodshenkr1	DESIGNED - RLW	REVISED - ---
ct:\projects\cmain09\cm310\details.dgn		DRAWN - RLW	REVISED - ---
	PLOT SCALE = 1/83,4829' / IN.	CHECKED - ---	REVISED - ---
	PLOT DATE = Mar 14, 2008 - 04:23:24 PM	DATE - ---	REVISED - ---

**STATE OF ILLINOIS
DEPARTMENT OF TRANSPORTATION**

CLASS A PATCHING
SCALE: _____ SHEET NO. 1 OF 1 SHEETS

*FAI 57 & FAP 332 **03 PAVEMENT PATCHING 2009-02			
SECTION	COUNTY	TOTAL SHEETS	SHEET NO.
**	IRROUOIS	17	12
CONTRACT NO. 66800			
FED. ROAD DIST. NO. - [ILLINOIS]			

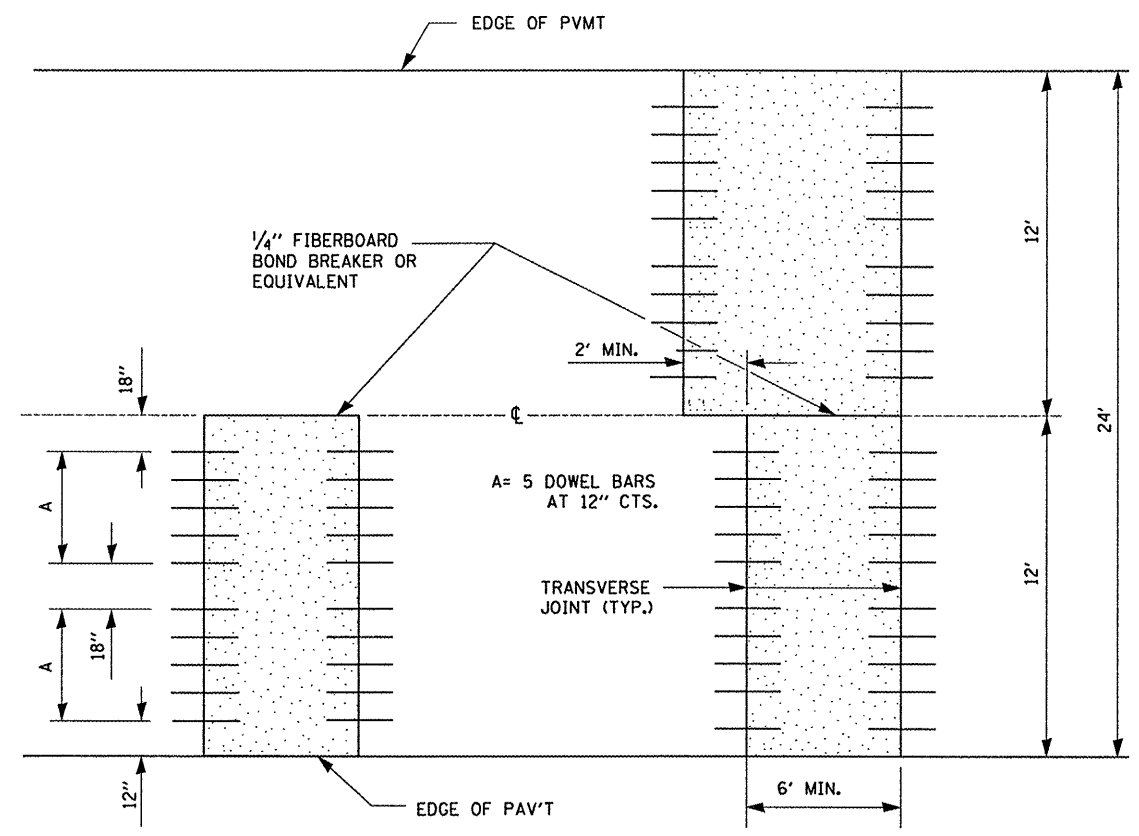

12' WIDE LANES

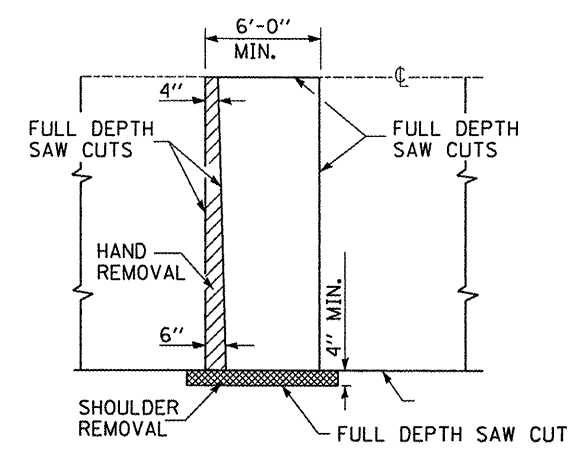

PAVEMENT SAWING DETAIL
(HMA SHOULDER)

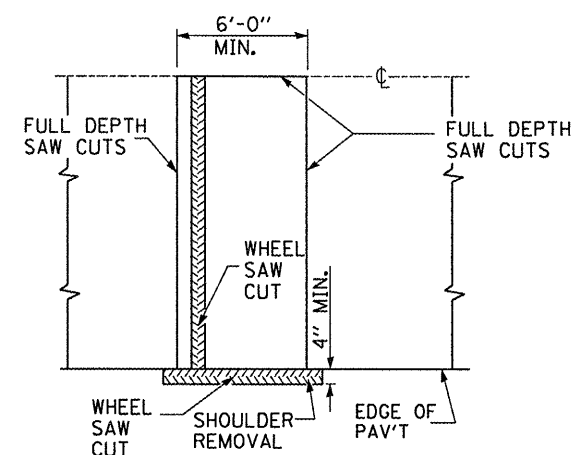

ALTERNATE SAWING DETAIL
(HMA SHOULDER)

DOWEL BAR TABLE		
PAVEMENT THICKNESS	DOWEL BAR DIAMETER	HOLE DIAMETER
8" OR GREATER	1 1/2"	1 5/8"
7" THRU 7.99"	1 1/4"	1 3/8"
LESS THAN 7"	1"	1 1/8"

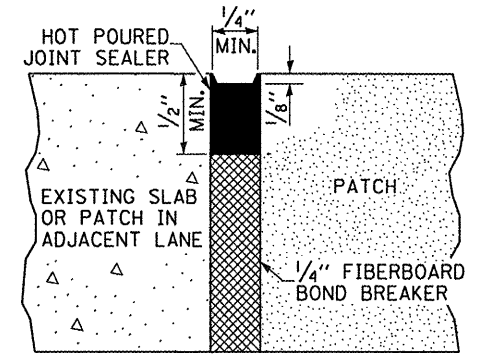

SEALING DETAIL
CENTERLINE JOINT

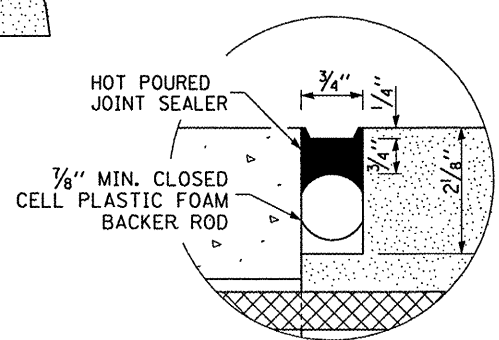

SEALING DETAIL
TRANSVERSE JOINT

① DEPTH VARIES
SEE TYPICAL SECTIONS

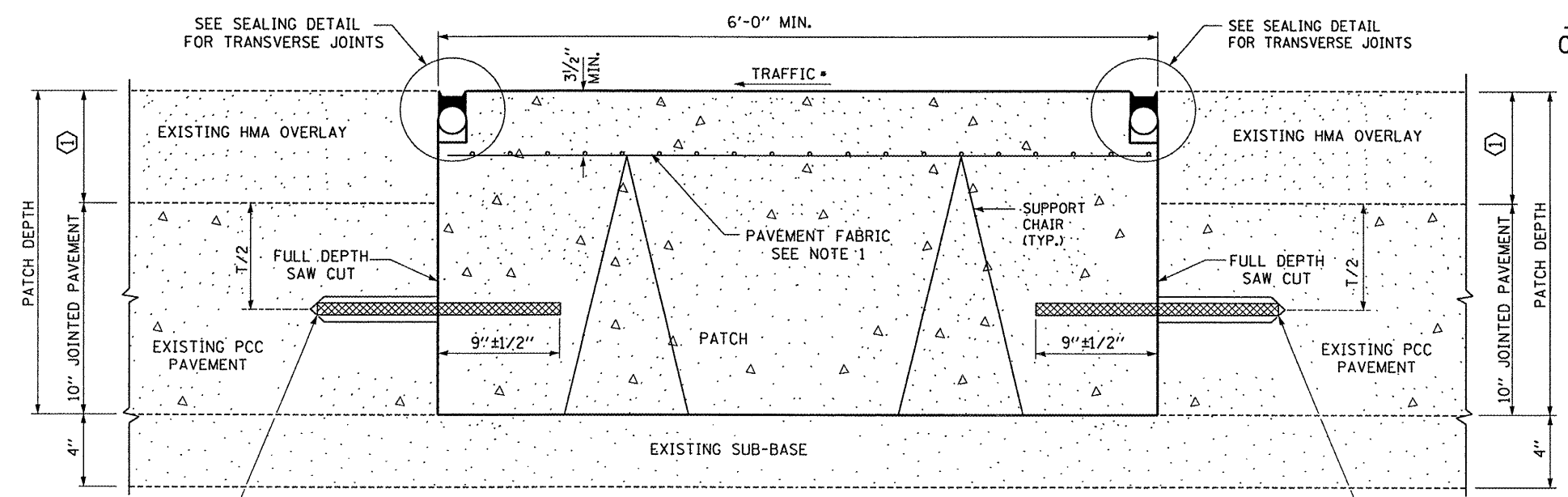

CLASS B PATCH
(WITH RESURFACING)

GENERAL NOTES

THE TRANSVERSE JOINTS FOR CLASS PATCHES SHALL ALIGN WITH JOINTS OR CRACKS IN THE ADJACENT LANE WHENEVER POSSIBLE.
SEE STANDARD 420701 FOR DETAILS OF PAVEMENT FABRIC.

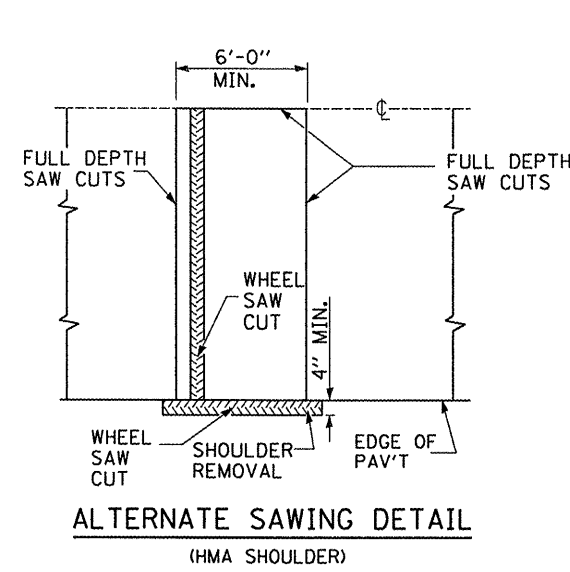
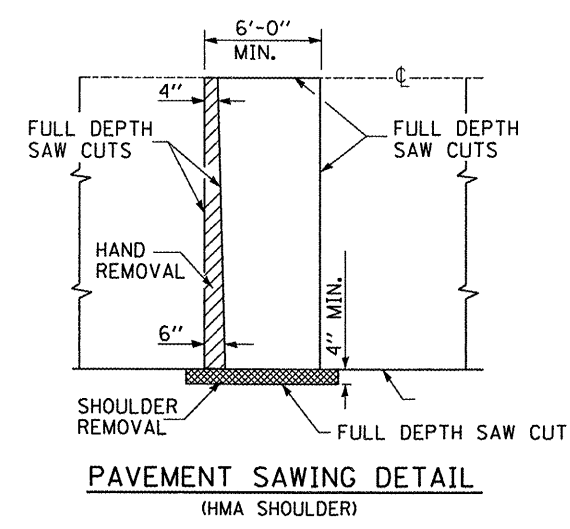
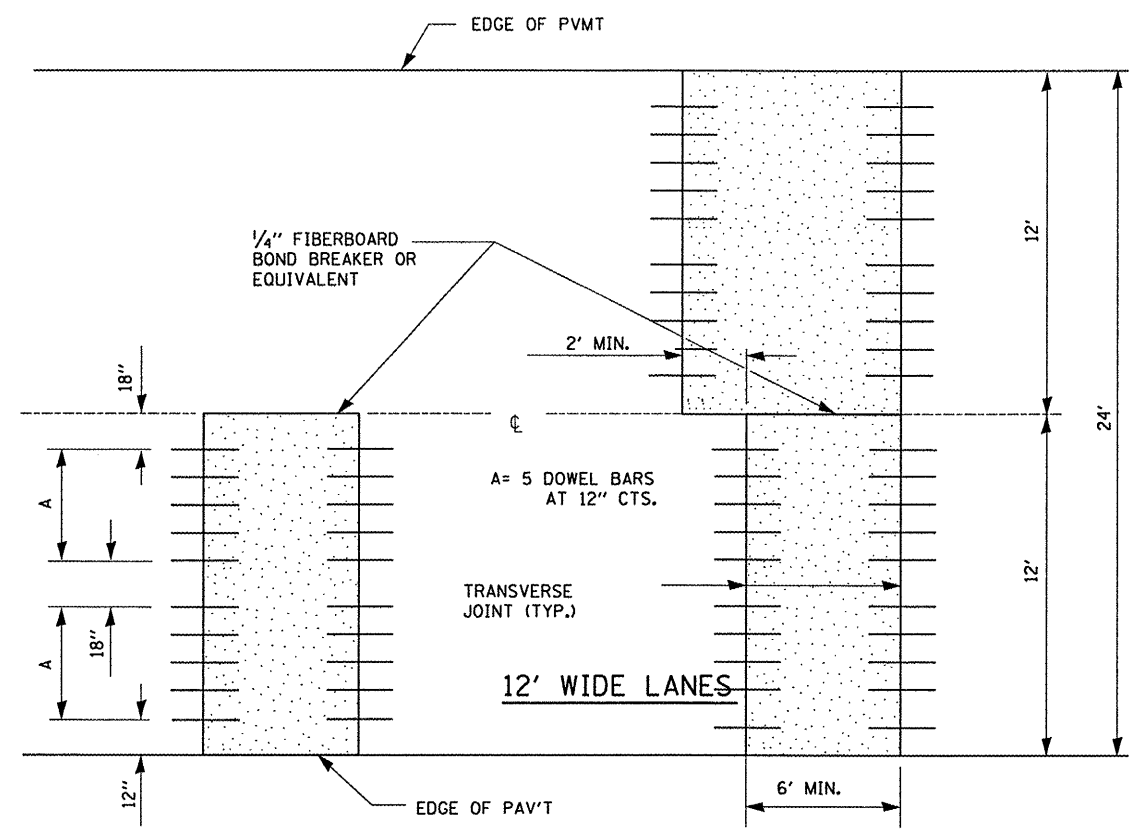

DOWEL BAR TABLE		
PAVEMENT THICKNESS	DOWEL BAR DIAMETER	HOLE DIAMETER
8" OR GREATER	1 1/2"	1 5/8"
7" THRU 7.99"	1 1/4"	1 3/8"
LESS THAN 7"	1"	1 1/8"

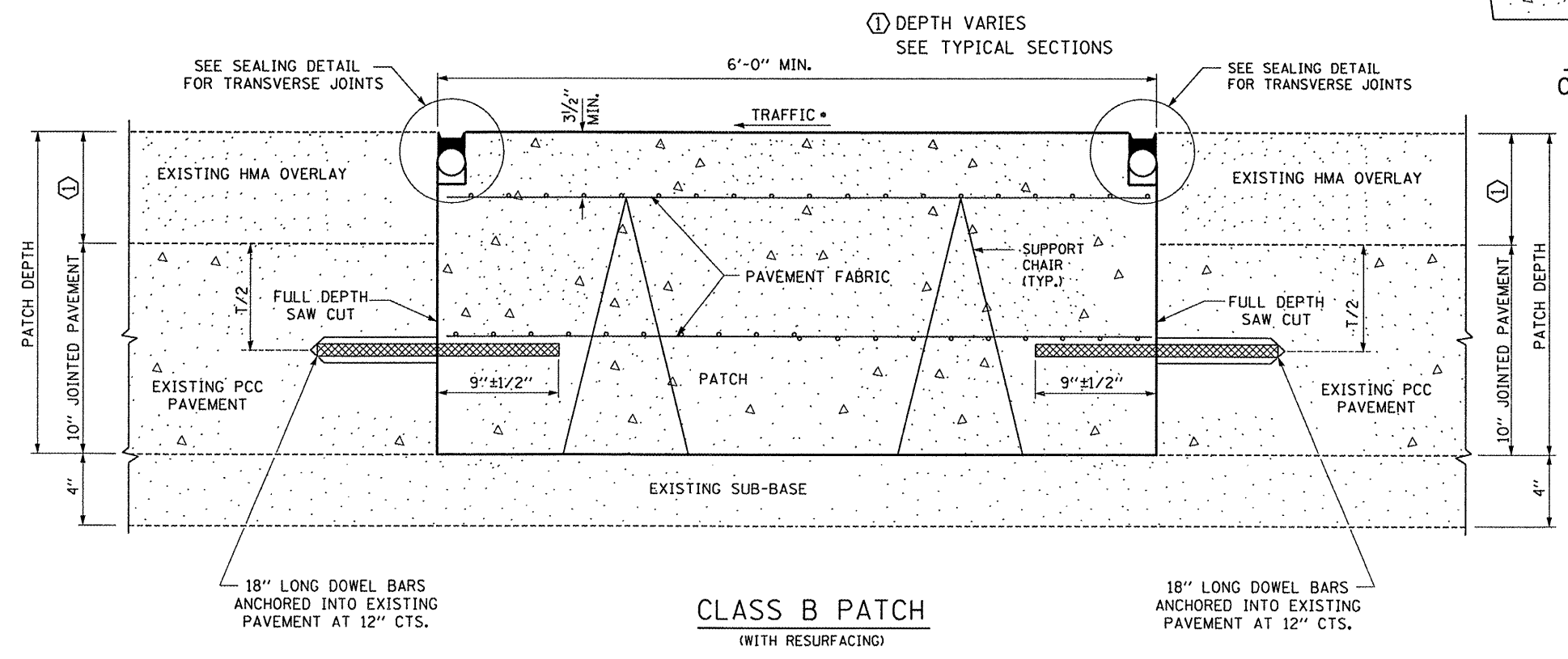
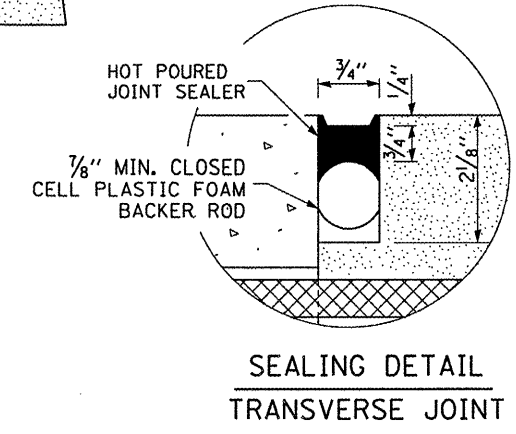
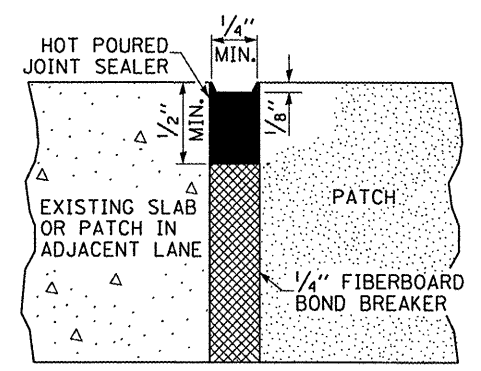

SEALING DETAIL
CENTERLINE JOINT

SEALING DETAIL
TRANSVERSE JOINT

GENERAL NOTES
 THE TRANSVERSE JOINTS FOR CLASS PATCHES SHALL ALIGN WITH JOINTS OR CRACKS IN THE ADJACENT LANE WHENEVER POSSIBLE.
 SEE STANDARD 420701 FOR DETAILS OF PAVEMENT FABRIC.

FILE NAME =	USER NAME = woodshankr1	DESIGNED - RLW	REVISED -
cr\projects\cmain\09\cm310\details.dgn		DRAWN - RLW	REVISED -
PLOT SCALE = 1/83.4829 "/>		CHECKED -	REVISED -
PLOT DATE = Mar 14, 2008 - 04:23:32 PM		DATE -	REVISED -

STATE OF ILLINOIS
DEPARTMENT OF TRANSPORTATION

CLASS B PATCHING - TYPE III & IV

SCALE: _____ SHEET NO. 2 OF 2 SHEETS

*FAI 57 & FAP 332	**D3 PAVEMENT PATCHING 2009-02		
SECTION	COUNTY	TOTAL SHEETS	SHEET NO.
**	IROQUOIS	17	14
FED. ROAD DIST. NO. - ILLINOIS		CONTRACT NO. 66800	

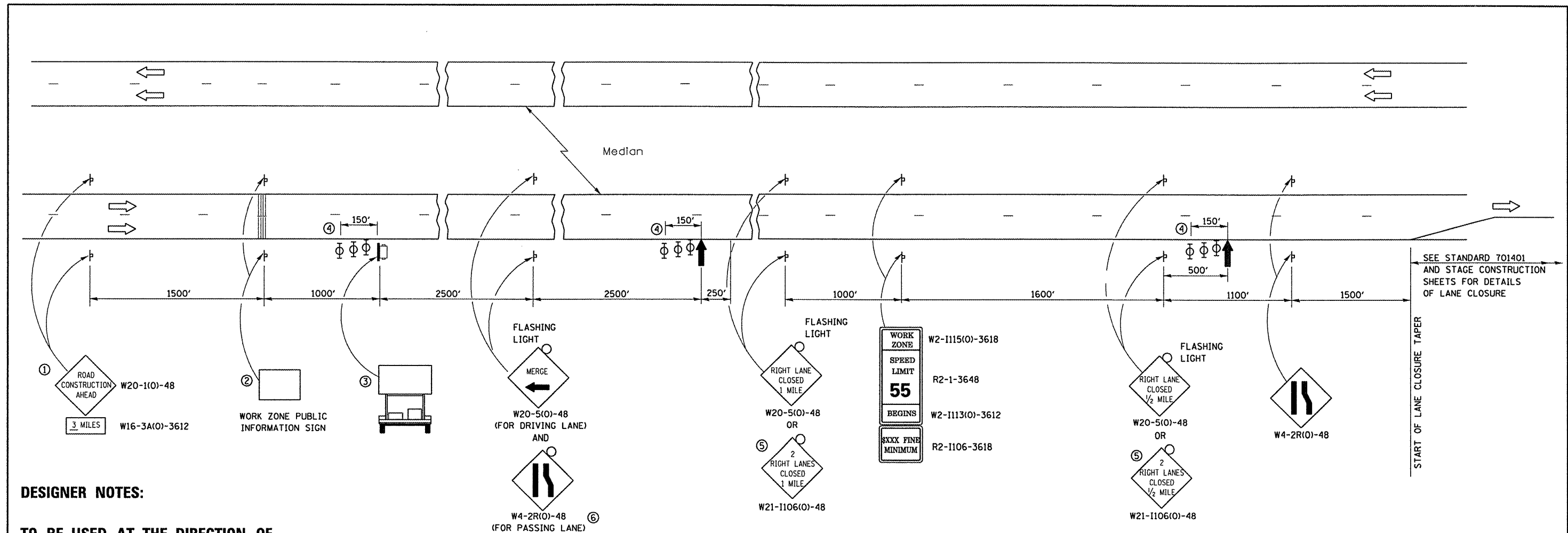

DESIGNER NOTES:

TO BE USED AT THE DIRECTION OF BUREAU OF CONSTRUCTION

ASK BUREAU OF CONSTRUCTION ON THE OFF-PEAK HOUR USAGE FOR PROJECT

INCLUDE EXTRA MESSAGE BOARDS WHEN NEAR MAJOR INTERCHANGES

USE DISTRICT 3 SPECIAL PROVISION FOR TRAFFIC CONTROL AND PROTECTION, STANDARD 701400 (MODIFIED)

USE DISTRICT 3 SPECIAL PROVISION FOR PORTABLE VEHICLE MOUNTED CHANGEABLE MESSAGE BOARD

INCLUDE AN ALTERNATE ROUTE SIGNING DETOUR DETAIL IN PLANS

USE DISTRICT 3 SPECIAL PROVISION FOR TEMPORARY THERMOPLASTIC RUMBLE STRIPS

- ↑ ARROW BOARD
- ☐ PORTABLE CHANGEABLE MESSAGE SIGN
- ⊥ SIGN
- ⊕ TYPE II BARRICADE, DRUM, OR VERTICAL BARRICADE WITH MONODIRECTIONAL FLASHING LIGHT

- ① THE ROAD CONSTRUCTION AHEAD SIGN SHALL BE LOCATED 3 MILES IN ADVANCE OF THE PROJECT LIMITS.
- ② THE MESSAGE AND SIZE OF THE WORK ZONE PUBLIC INFORMATION SIGN SHALL BE AS SPECIFIED BY THE DEPARTMENT.
- ③ TO BE PLACED IN THE MEDIAN WHEN FEASIBLE. THE MESSAGE BOARD SHALL BE USED TO DISPLAY STATUS OF LANES WITHIN THE PROJECT. THE PRIMARY MESSAGES SHALL BE:
"RIGHT LANE CLOSED" / " x MILES AHEAD"
"LEFT LANE CLOSED" / " x MILES AHEAD"
"ALL LANES OPEN"
- ④ THREE, TYPE II BARRICADES, DRUMS OR VERTICAL BARRICADES AT 50' CENTERS.
- ⑤ THIS SIGN SHALL BE USED WHEN 2 LANES ARE CLOSED.
- ⑥ SWITCH THESE TWO SIGNS AND THE DIRECTION OF THE MERGE ARROW WHEN PASSING LANE IS CLOSED.
- ⑦ 48"x48" SIGN WITH 7" LETTER HEIGHT.

GENERAL NOTE:

THIS STANDARD IS USED WHERE AT ANY TIME A LANE IS CLOSED ON A FREEWAY/EXPRESSWAY.

WHEN THE LEFT LANE IS CLOSED, LEFT LANE CLOSED SIGNS SHALL BE SUBSTITUTED FOR THE RIGHT LANE CLOSED SIGNS.

ALL SIGNS, MESSAGE BOARDS AND OTHER TRAFFIC CONTROL DEVICES UP TO AND INCLUDING THE FIRST ARROW BOARD ARE STATIONARY. THE OTHER SIGNS AND OTHER ARROWBOARD SHALL BE MOVED AS NECESSARY TO MAINTAIN THE REQUIRED DISTANCE FROM THE START OF THE LANE CLOSURE TAPER(S).

SEE SPECIAL PROVISIONS.

FILE NAME = c:\projects\main\cm310\details.dgn	USER NAME = woodshenkv1	DESIGNED - DRAWN -	REVISED - REVISED -
PLOT SCALE = 1/8" = 1' IN.	CHECKED -	REVISED -	REVISED -
PLOT DATE = Mar 14, 2008 - 04:23:37 PM	DATE -	REVISED -	REVISED -

STATE OF ILLINOIS
DEPARTMENT OF TRANSPORTATION

STANDARD 701400 (MODIFIED)

SCALE: _____ SHEET NO. 1 OF 1 SHEETS STA. _____ TO STA. _____

*FAI 57 & FAP 332 **03 PAVEMENT PATCHING 2009-02	
SECTION	COUNTY
IRROUOIS	IRROUOIS
TOTAL SHEETS	SHEET NO.
17	15
CONTRACT NO. 66800	
FED. ROAD DIST. NO. - ILLINOIS FED. AID PROJECT	

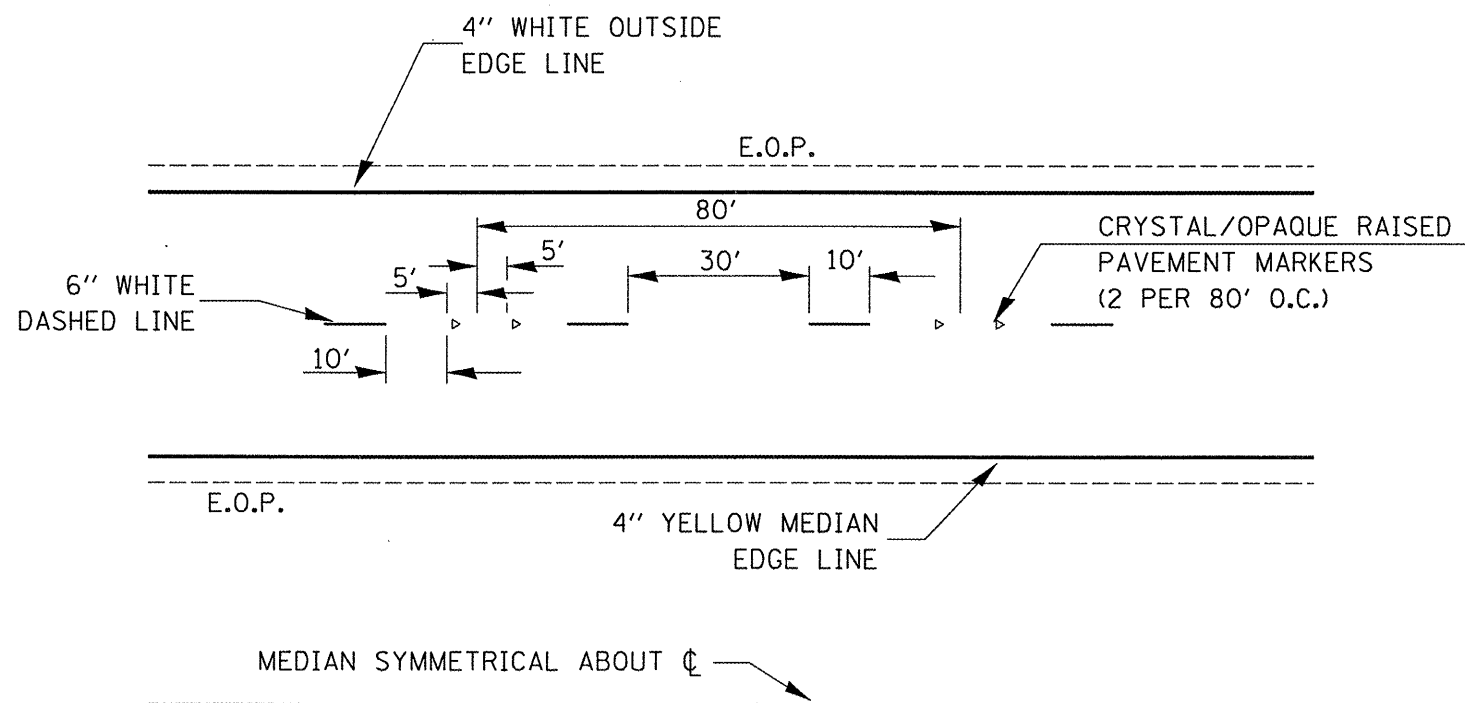

TYPICAL PAVEMENT MARKINGS

4 LANE ROAD OR INTERSTATE

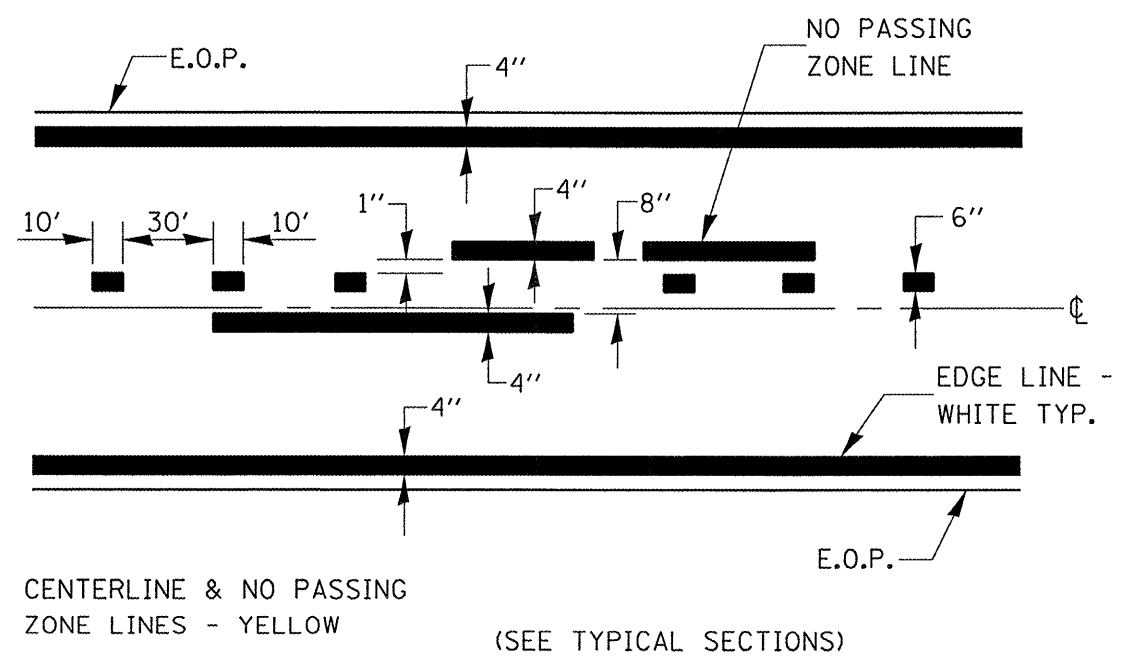

PAVEMENT MARKING

TWO LANE ROAD

FILE NAME =	USER NAME = woodshenkr1	DESIGNED - RLW	REVISED - ---
ca:\projects\main\09\cm310\details.dgn		DRAWN - RLW	REVISED - ---
	PLOT SCALE = 1/8" = 1' IN.	CHECKED - ---	REVISED - ---
	PLOT DATE = Mar 14, 2008 - 04:23:41 PM	DATE - ---	REVISED - ---

STATE OF ILLINOIS
DEPARTMENT OF TRANSPORTATION

TYPICAL PAVEMENT MARKING

SCALE: _____ SHEET NO. 1 OF 2 SHEETS

*FAI 57 & FAP 332 **D3 PAVEMENT PATCHING 2009-02			
SECTION	COUNTY	TOTAL SHEETS	SHEET NO.
**	IROUOIS	17	16
FED. ROAD DIST. NO. - ILLINOIS		CONTRACT NO. 66800	

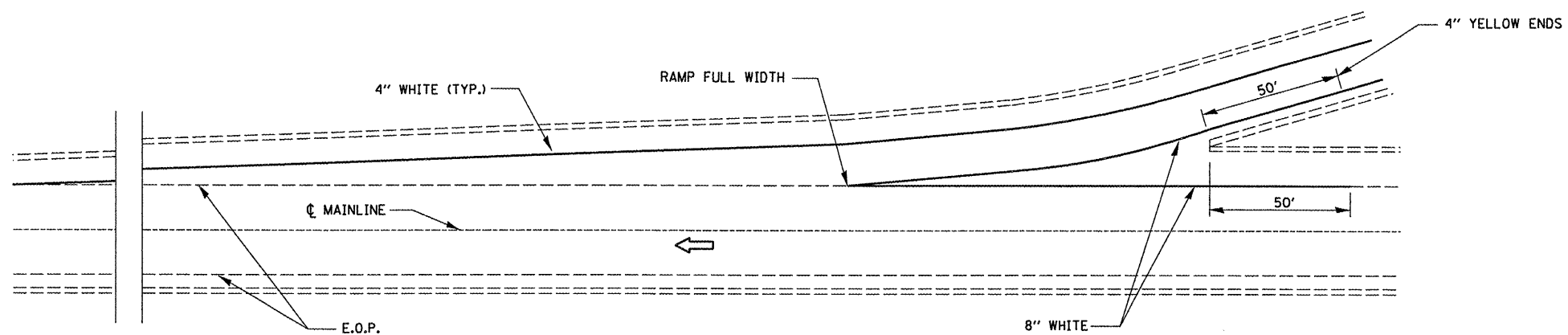

TYPICAL PAVEMENT MARKING FOR ENTRANCE RAMP TERMINALS

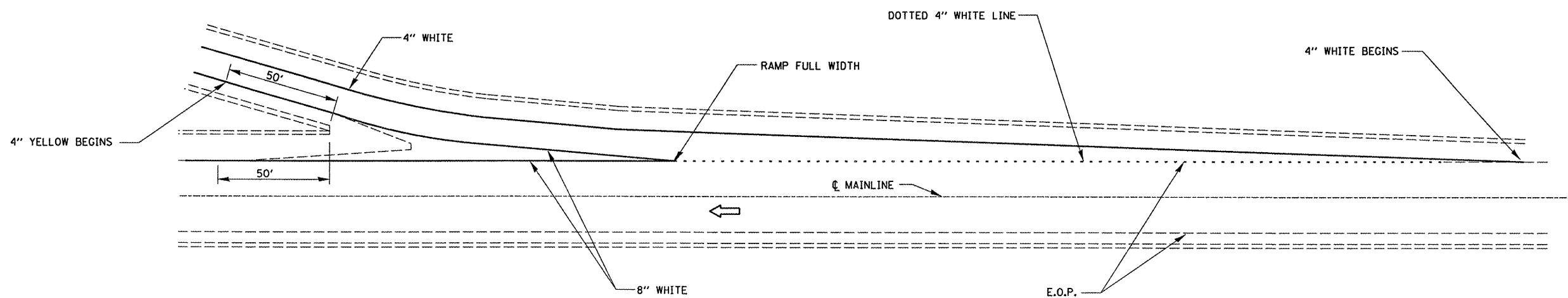

TYPICAL PAVEMENT MARKINGS FOR EXIT RAMP TERMINALS

FILE NAME = c:\projects\am310\am310\details.dgn	USER NAME = woodshenk1	DESIGNED - RLW	REVISED - ---
		DRAWN - RLW	REVISED - ---
		CHECKED - ---	REVISED - ---
		DATE - ---	REVISED - ---
PLOT SCALE = 1/8" = 1'-0"			
PLOT DATE = Mar 14, 2008 - 04:23:46 PM			

STATE OF ILLINOIS
DEPARTMENT OF TRANSPORTATION

TYPICAL PAVEMENT MARKING

SCALE: _____ SHEET NO. 2 OF 2 SHEETS

*FA1 57 & FAP 332 **D3 PAVEMENT PATCHING 2009-02			
SECTION	COUNTY	TOTAL SHEETS	SHEET NO.
**	IROQUOIS	17	17
FED. ROAD DIST. NO. - ILLINOIS		CONTRACT NO. 66800	