

F.A.P. RTE.	SECTION	COUNTY	TOTAL SHEETS	SHEET NO.
653	(8,29)RS-3	LASALLE	12	1
FED. ROAD DIST. NO.	ILLINOIS	CONTRACT NO. 66806		

**INDEX OF SHEETS**

- 1 COVER SHEET
- 2 GENERAL NOTES
- 3 SUMMARY OF QUANTITIES
- 4 TYPICAL SECTIONS
- 5 SCHEDULES
- 6 SURVEY TIES
- 7 PROJECT LAYOUT
- 8-9 PAVEMENT MARKING DETAILS
- 10-12 DETAILS

**STATE OF ILLINOIS**  
**DEPARTMENT OF TRANSPORTATION**  
**DIVISION OF HIGHWAYS**  
**PROPOSED**  
**HIGHWAY PLANS**

**FAP ROUTE 653 (IL 18 & IL 18 ALT.)**  
**SECTION (8,29)RS-3**  
**PROJECT F-0653(026)**  
**LASALLE COUNTY**

**C - 93 - 083 - 08**

**3P RESURFACING FROM THE**  
**WCL OF STREATOR TO OTTER CREEK RD. IN STREATOR**  
**(W.B. ONLY IN COUPLE)**

D-93-052-08

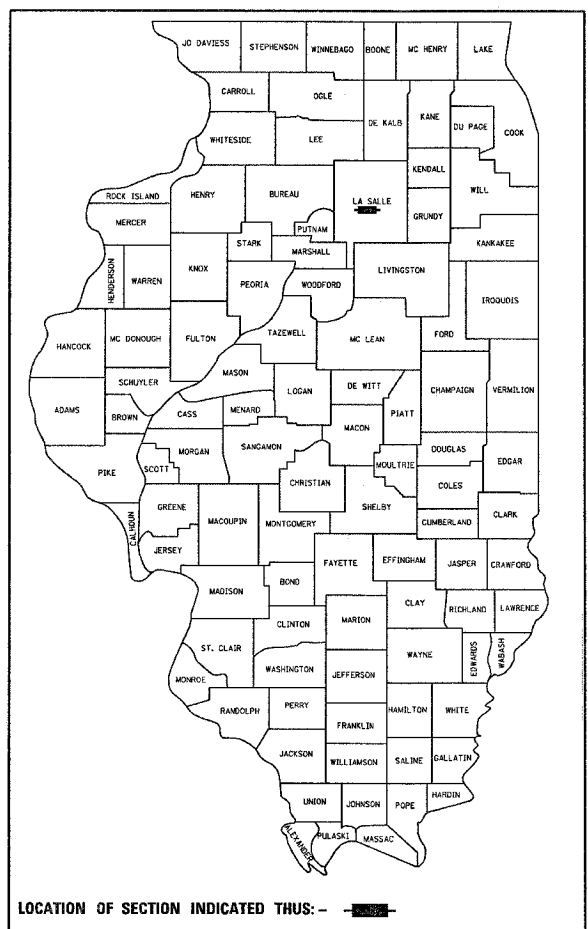

LOCATION OF SECTION INDICATED THUS: - [Red Box] -

**STANDARDS**

- 000001-05 STANDARD SYMBOLS, ABBREVIATIONS AND PATTERNS
- 001006 DECIMAL OF AN INCH AND OF A FOOT
- 602401-01 MANHOLE, TYPE A
- 604001-02 FRAME AND LIDS, TYPE 1
- 667101 PERMANENT SURVEY MARKERS
- 701006-02 OFF-ROAD OPERATIONS 2L, 2W, 4.5 m (15') TO 600 mm (24") FROM PAVEMENT EDGE
- 701301-02 LANE CLOSURE, 2L, 2W, SHORT TIME OPERATIONS
- 701306-01 LANE CLOSURE, 2L, 2W, SLOW MOVING OPERATIONS DAY ONLY, FOR SPEEDS ≥ 45 MPH
- 701311-02 LANE CLOSURE, 2L, 2W, MOVING OPERATIONS - DAY ONLY
- 701426-02 LANE CLOSURE, MULTILANE INTERMITTENT OR MOVING OPERATION, FOR SPEEDS ≥ 45 MPH
- 701601-05 URBAN LANE CLOSURE, MULTILANE, 1W OR 2W WITH NONTRAVERSABLE MEDIAN
- 701701-05 URBAN LANE CLOSURE, MULTILANE INTERSECTION
- 701901 TRAFFIC CONTROL DEVICES
- 780001-01 TYPICAL PAVEMENT MARKINGS
- 781001-02 TYPICAL APPLICATIONS RAISED REFLECTIVE PAVEMENT MARKERS

MICROFILMED \_\_\_\_\_  
 REEL NUMBER \_\_\_\_\_  
 AWARDED \_\_\_\_\_  
 RESIDENT ENGINEER \_\_\_\_\_  
 AS BUILT CHANGES WERE MADE  
 ON THE FOLLOWING SHEETS \_\_\_\_\_

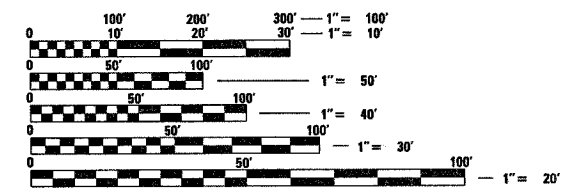

FULL SIZE PLANS HAVE BEEN PREPARED USING STANDARD ENGINEERING SCALES. REDUCED SIZED PLANS WILL NOT CONFORM TO STANDARD SCALES. IN MAKING MEASUREMENTS ON REDUCED PLANS, THE ABOVE SCALES MAY BE USED.

**J.U.L.I.E.**  
**JOINT UTILITY LOCATION INFORMATION FOR EXCAVATION**  
**1-800-892-0123**  
**OR 811**

**PROJECT ENGINEER : JOE KANNEL**  
**UNIT CHIEF : MICHELE LINDEMANN**  
 DISTRICT 3 NO. (815) 434-6131  
**CONTRACT NO. 66806**

**BEGIN IMPROVEMENT**  
**STA. 754 + 88**

**END IMPROVEMENT**  
**STA. 867 + 45**

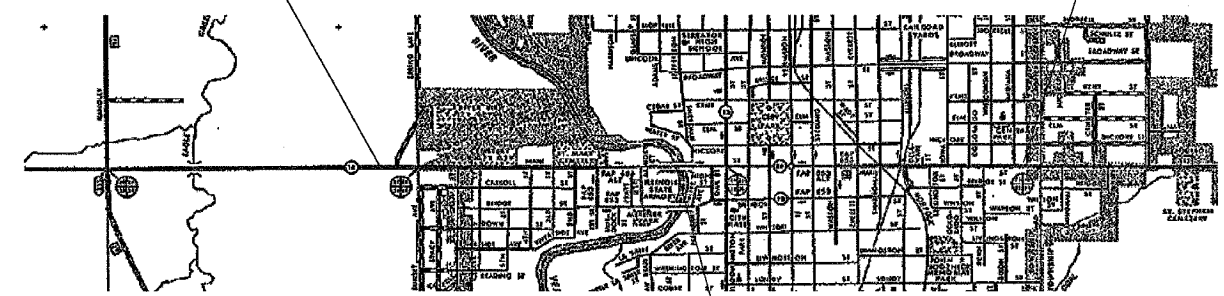

**OMISSIONS**  
 STA. 786+60 TO 792+75 (NEW PVMT)  
 STA. 804+74.32 TO STA. 809+09.68 (SN 050-0202)  
 STA. 839+82.14 TO STA. 839+96.53 (RR)  
 STA. 844+23.2 TO STA. 844+97.2 (RR)

**SN 050-0202 - OMISSION**  
**STA. 786 + 60 TO 792 + 75**

**GROSS LENGTH = 11,257 FT. = 2.132 MI.**  
**NET LENGTH = 10,118.25 FT. = 1.916 MI.**

**URBAN OTHER PRINCIPAL ARTERIAL**

**2008 ADT = 7500**  
**P.V. = 88.5% S.U. = 9.5% M.U. = 2.0%**

STATE OF ILLINOIS  
 DEPARTMENT OF TRANSPORTATION  
 DIVISION OF HIGHWAYS

SUBMITTED 3/25 2008

*George F. Ryan*  
 DEPUTY DIRECTOR OF HIGHWAYS, REGION ENGINEER

May 9, 2008  
*Eric E. Harnick*  
 INTERIM ENGINEER OF DESIGN AND ENVIRONMENT

May 9, 2008  
*Christine M. Reed*  
 DIRECTOR OF HIGHWAYS, CHIEF ENGINEER

PLOT DATE = Mar 25, 2008 - 02:00:53 PM  
 FILE NAME = c:\projects\66806\66806-sh-t-cover.dgn  
 PLOT SCALE = 50.0000 / IN.  
 USER NAME = carpenter-dj

**PRINTED BY THE AUTHORITY**  
**OF THE STATE OF ILLINOIS**

GENERAL NOTES

THE THICKNESS OF HMA SHOWN ON THE PLANS IS THE NOMINAL THICKNESS. DEVIATIONS FROM THE NOMINAL THICKNESS WILL BE PERMITTED WHEN SUCH DEVIATIONS OCCUR DUE TO IRREGULARITIES IN THE EXISTING SURFACE OR BASE ON WHICH THE HMA IS PLACED.

THE HMA SURFACE OF ALL MAILBOX TURNOUTS, PRIVATE ENTRANCES, COMMERCIAL ENTRANCES, AND SIDE ROADS SHALL BE MADE NEATLY, IN A WORKMANLIKE MANNER, AND SHALL ACCURATELY CONFORM TO THE SHAPES AND DIMENSIONS SHOWN ON THE PLAN DETAILS. IF REQUIRED BY THE ENGINEER, THE CONTRACTOR SHALL BE REQUIRED TO SAW CUT THE HMA SURFACE TO CONFORM TO THE SHAPES AND DIMENSIONS SHOWN ON THE PLAN DETAILS. THIS WORK SHALL BE INCLUDED IN THE COST OF THE HMA SURFACE

THE ENGINEER WILL BE THE SOLE JUDGE CONCERNING CURING TIME FOR THE VARIOUS HMA LIFTS.

ON EXISTING PAVEMENT WHICH MAY BE SUPERELEVATED, THE NEW HMA PAVEMENT SHALL BE BUILT WITH THE SAME SUPERELEVATION UNLESS NEW SUPERELEVATION RATES ARE GIVEN ON THE PLANS.

ANY REFERENCE TO A STANDARD IN THESE PLANS SHALL BE INTERPRETED TO MEAN THE EDITION AS INDICATED BY THE SUBNUMBER SHOWN IN THE LIST OF STANDARDS OR THE COPY INCLUDED IN THESE PLANS.

THE FOLLOWING RATES OF APPLICATION HAVE BEEN USED IN CALCULATING PLAN QUANTITIES:

GRANULAR MATERIALS	2.05	TONS / CU YD
BITUMINOUS MAT PRIME COAT	0.08	GAL / SQ YD OR
	0.375	GAL / SQ YD
AGGREGATE PRIME COAT	0.002	TONS / SQ YD
HMA RESURFACING	112	LBS / SQ YD / IN
SHORT TERM PAVEMENT MARKING	10	FT /100 FT OF APPLICATION
MIX FOR CRACKS, JTS & FLGWYS	0.0003	TONS / SQ YD
LEVEL BINDER (HAND METHOD)	0.0005	TONS / SQ YD

ALL DAMAGE TO DEPARTMENT OWNED UNDERGROUND FACILITIES, CAUSED BY THE CONTRACTOR SHALL BE REPAIRED TO THE SATISFACTION OF THE DEPARTMENT AT THE CONTRACTOR'S EXPENSE. THIS SHALL INCLUDE ALL TEMPORARY REPAIRS REQUIRED TO KEEP THE FACILITY OPERATIONAL WHILE MATERIAL IS BEING OBTAINED TO MAKE PERMANENT REPAIRS. SPLICING OF ELECTRIC CABLE SHALL NOT BE ALLOWED. ELECTRIC CABLE SHALL BE REPLACED FROM POLE TO POLE OR CONTROLLER.

STATE OF ILLINOIS  
DEPARTMENT OF TRANSPORTATION  
DISTRICT THREE

PREPARED BY: *R. Paul*  
DISTRICT STUDIES & PLANS ENGINEER

DATE: 3-25-08

EXAMINED BY: *Herb Jones SD*  
DISTRICT CONSTRUCTION ENGINEER

*J. J. Smith*  
DISTRICT MATERIALS ENGINEER

*Chris Hachinger*  
DISTRICT OPERATIONS ENGINEER

FILE NAME =	USER NAME = carpenterdj	DESIGNED -	REVISED -	<b>STATE OF ILLINOIS DEPARTMENT OF TRANSPORTATION</b>	<b>GENERAL NOTES</b>	F.A.P. RTE.	SECTION	COUNTY	TOTAL SHEETS	SHEET NO.	
c:\projects\0366806\0366806-sht-cover.dgn		DRAWN -	REVISED -			653	(8,29)RS-3	LASALLE	12	2	
		CHECKED -	REVISED -			CONTRACT NO. 66806					
		DATE -	REVISED -			SCALE:	SHEET NO. OF SHEETS	STA. TO STA.	FED. ROAD DIST. NO. [ILLINOIS] FED. AID PROJECT		
		PLOT SCALE = 50.0000' / IN.									
		PLOT DATE = Mar 25, 2008 - 02:20:37 PM									

SUMMARY OF QUANTITIES			URBAN 80% FED. 20% ST. 1000
CODE NO.	CONSTRUCTION CODE TYPE: ITEM	UNIT	TOTAL QUANTITY
40600100	BITUMINOUS MATERIALS (PRIME COAT)	GALLON	4577
40600300	AGGREGATE (PRIME COAT)	TON	115
40600400	MIXTURE FOR CRACKS, JOINTS, AND FLANGEWAYS	TON	13
40600545	LEVELING BINDER (HAND METHOD), N90	TON	29
40600645	LEVELING BINDER (MACHINE METHOD), N90	TON	605
40600895	CONSTRUCTING TEST STRIP	EACH	1
40600990	TEMPORARY RAMP	SQ YD	980
40603345	HOT-MIX ASPHALT SURFACE COURSE, MIX "D", N90	TON	3345
44000155	HOT-MIX ASPHALT SURFACE REMOVAL, 1 1/2"	SQ YD	16454
44000158	HOT-MIX ASPHALT SURFACE REMOVAL, 2 1/4"	SQ YD	14405
44000198	HOT-MIX ASPHALT SURFACE REMOVAL, VARIABLE DEPTH	SQ YD	11946
56109210	WATER VALVES TO BE ADJUSTED	EACH	5
60255500	MANHOLES TO BE ADJUSTED	EACH	5
60255800	MANHOLES TO BE ADJUSTED WITH NEW TYPE 1 FRAME, CLOSED LID	EACH	5
66700095	PERMANENT SURVEY MARKERS	EACH	6
67000400	ENGINEER'S FIELD OFFICE, TYPE A	CAL MO	3
67100100	MOBILIZATION	L SUM	1
70100460	TRAFFIC CONTROL AND PROTECTION, STANDARD 701306	L SUM	1
70102630	TRAFFIC CONTROL AND PROTECTION, STANDARD 701601	L SUM	1
70102635	TRAFFIC CONTROL AND PROTECTION, STANDARD 701701	L SUM	1

SUMMARY OF QUANTITIES (CONTINUED)			URBAN 80% FED. 20% ST. 1000
CODE NO.	CONSTRUCTION CODE TYPE: ITEM	UNIT	TOTAL QUANTITY
70300100	SHORT-TERM PAVEMENT MARKING	FOOT	3811
70300210	TEMPORARY PAVEMENT MARKING - LETTERS AND SYMBOLS	SQ FT	553
70300220	TEMPORARY PAVEMENT MARKING - LINE 4"	FOOT	2628
70300240	TEMPORARY PAVEMENT MARKING - LINE 6"	FOOT	4061
70300250	TEMPORARY PAVEMENT MARKING - LINE 8"	FOOT	360
70300260	TEMPORARY PAVEMENT MARKING - LINE 12"	FOOT	1402
70300280	TEMPORARY PAVEMENT MARKING - LINE 24"	FOOT	447
70301000	WORK ZONE PAVEMENT MARKING REMOVAL	SQ FT	636
78000100	THERMOPLASTIC PAVEMENT MARKING - LETTERS AND SYMBOLS	SQ FT	553
78000200	THERMOPLASTIC PAVEMENT MARKING - LINE 4"	FOOT	2628
78000400	THERMOPLASTIC PAVEMENT MARKING - LINE 6"	FOOT	4061
78000500	THERMOPLASTIC PAVEMENT MARKING - LINE 8"	FOOT	360
78000600	THERMOPLASTIC PAVEMENT MARKING - LINE 12"	FOOT	1402
78000650	THERMOPLASTIC PAVEMENT MARKING - LINE 24"	FOOT	447
Z0024430	FLAGGER	HOUR	100
Z0048665	RAILROAD PROTECTIVE LIABILITY INSURANCE	L SUM	1

• SPECIALTY ITEMS

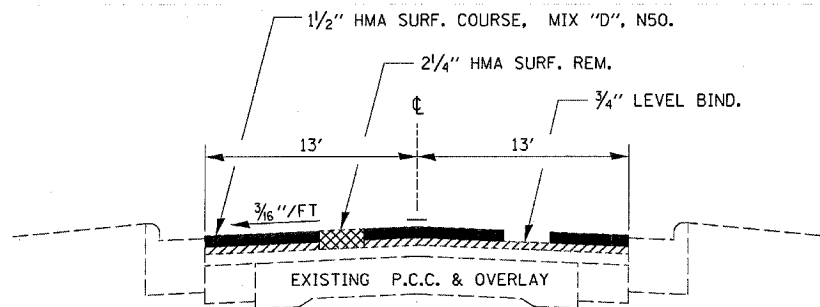

STATION 754+88 TO STATION 804+74.32

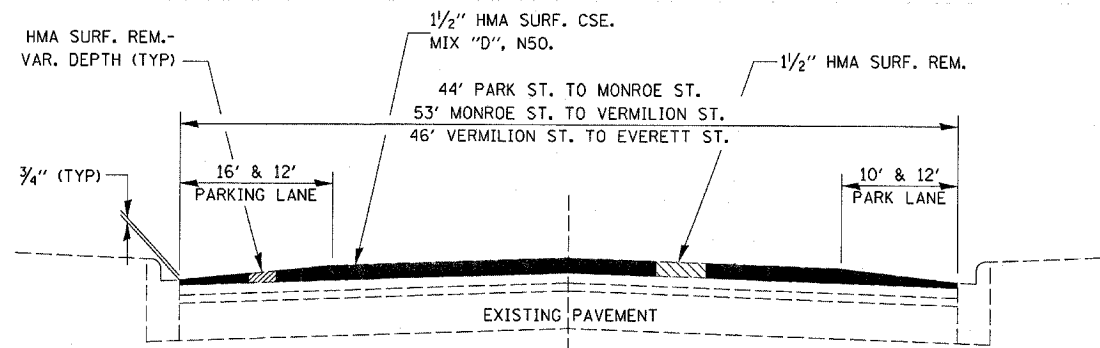

STATION 818+00.3 TO STATION 836+53.87

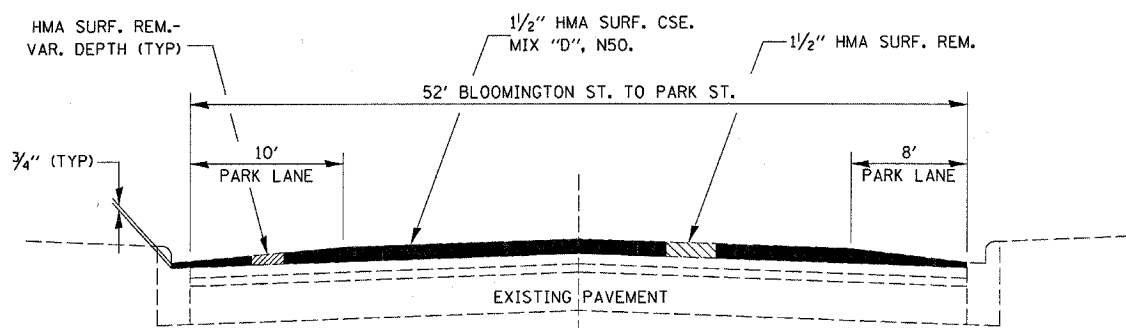

STATION 809+04.68 TO STATION 818+00.3

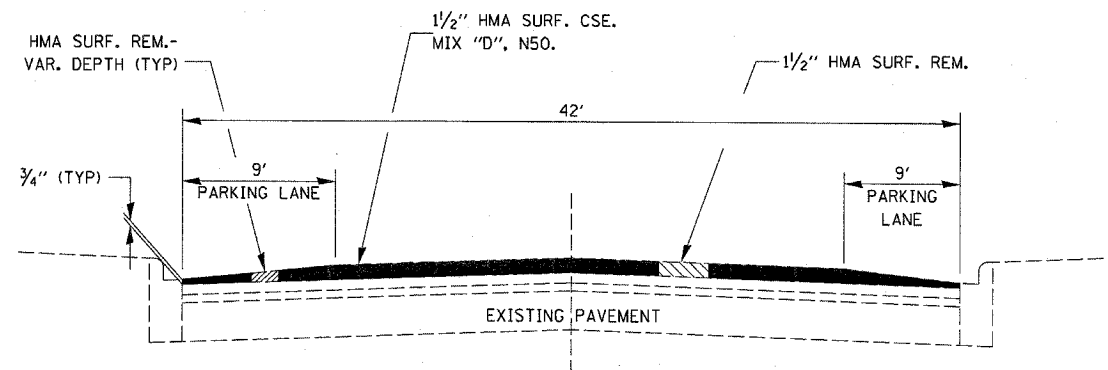

STATION 836+53.87 TO STATION 867+45

MIX DESIGN						
MIX	PG GRADE	MAX % RAP ALLOWABLE*	DESIGN AIR VOIDS	MIX COMPOSITION	FRICTION AGG	DENSITY CONTROL
HOT-MIX ASPHALT SURFACE COURSE	PG 70-22	15%	4.0% @N50	1L 12.5 OR 1L 9.5	MIXTURE D	CORRELATION
LEVELING BINDER	PG 70-22	25%	4.0% @N50	IL 9.5		SATISFACTION OF ENGINEER

\* IF RAP PERCENTAGE IS DIFFERENT THAN LISTED ABOVE, THE PG GRADE MAY NEED TO BE ADJUSTED. THIS WILL BE DETERMINED BY THE ENGINEER.

OMISSIONS  
 STA. 786+60 TO 792+75 (NEW PVMT)  
 STA. 804+74.32 TO STA. 809+09.68 (SN C50-0202)  
 STA. 839+82.14 TO STA. 839+96.53 (RR)  
 STA. 844+23.2 TO STA. 844+97.2 (RR)

TEMPORARY PAVEMENT MARKING SCHEDULE							
LOCATION	TEMPORARY PVMT MARK YELLOW 4" FOOT	TEMPORARY PVMT MARKING		TEMPORARY PVMT MARK WHITE 8" FOOT	TEMPORARY PVMT MARK WHITE 12" FOOT	TEMPORARY PVMT MARK WHITE 24" FOOT	TEMPORARY PVMT MARK LETTERS & SYMBOLS SQ FT
		WHITE 6" FOOT	YELLOW 6" FOOT				
		FOOT	FOOT				
STA. 754+88 TO STA. 786+60		66	317		61		
STA. 792+75 TO STA. 804+74.32		120		113			31.2
STA. 809+04.68 TO STA. 814+25.55		499			249		
STA. 814+25.55 TO STA. 818+00.3		586		247	191	52	117.6
STA. 818+00.3 TO STA. 821+67.52		405			176	44	42.7
STA. 821+67.52 TO STA. 825+33.35		424			202	53	42.7
STA. 825+33.35 TO STA. 829+00.22		370			176	44	42.7
STA. 829+00.22 TO STA. 832+70.45	620	440			299	44	38.1
STA. 832+70.45 TO STA. 836+53.87	588		186		24		
STA. 836+53.87 TO STA. 839+82.14	420		35		36		59.6
STA. 839+82.14 TO STA. 844+23.20	600				72		119.2
STA. 844+23.20 TO STA. 848+76	400		100		36		59.6
STA. 848+76 TO STA. 867+45		52	461		48	42	
SUBTOTAL	2628	2962	1099	360	1402	447	553.4
TOTAL	2628	4061		360	1402	447	553.4

• PROPOSED NO PASSING ZONES SHALL BE STRIPED AS EXISTING.

SHORT-TERM PAVEMENT MARKING SCHEDULE			
LOCATION	SHORT-TERM PAVEMENT MARKING		WORK ZONE PVMT MARKING REMOVAL
	WHITE FOOT	YELLOW FOOT	SQ FT
	STA. 754+88 TO STA. 786+60		380
STA. 792+75 TO STA. 804+74.32	455		76
STA. 809+04.68 TO STA. 814+25.55	96		16
STA. 814+25.55 TO STA. 818+00.3	904		151
STA. 818+00.3 TO STA. 821+67.52	334		56
STA. 821+67.52 TO STA. 825+33.35	320		53
STA. 825+33.35 TO STA. 829+00.22	334		56
STA. 829+00.22 TO STA. 832+70.45	334		56
STA. 832+70.45 TO STA. 836+53.87		60	10
STA. 836+53.87 TO STA. 839+82.14		70	12
STA. 839+82.14 TO STA. 844+23.20		70	12
STA. 844+23.20 TO STA. 848+76		80	13
STA. 848+76 TO STA. 867+45		374	62
SUBTOTAL	2777	1034	636
TOTAL		3811	636

PAVING SCHEDULE													
LOCATION	LENGTH	AVE PVMT WIDTH	HMA PVMT AREA	HMA SURF CSE	HMA LEVEL BIND	HMA SURF REM 1 1/2"	HMA SURF REM 2 1/4"	HMA SURF REM VAR. DEPTH	TEMP RAMPS	BIT MAT (PR CT)	AGG (PR CT)	MIX FOR CRACKS, JOINTS & FLANGEWAYS	LEVEL BINDER (H.M.)
	FOOT	FOOT	SQ YD	TON	TON	SQ YD	SQ YD	SQ YD	SQ YD	GALLON	TON	TON	TON
STA. 754+88 TO STA. 804+74.32	4986.32	26	14405	1210	605		14405		390	2304.8	57.6	4.3	14.4
STA. 809+04.68 TO STA. 814+25.55	520.87	44	2546	201.7		1968		578	29	203.7	5.1	0.8	1.3
STA. 814+25.55 TO STA. 818+00.3	374.75	52	2165	166.1		1416		749	53	173.2	4.3	0.6	1.1
STA. 818+00.3 TO STA. 821+67.52	367.22	44	1795	133.6		979		816	45	143.6	3.6	0.5	0.9
STA. 821+67.52 TO STA. 825+33.35	365.83	53	2154	158.7		1097		1057	43	172.3	4.3	0.6	1.1
STA. 825+33.35 TO STA. 829+00.22	366.87	46	1875	138.7		978		897	44	150	3.8	0.6	0.9
STA. 829+00.22 TO STA. 832+70.45	370.23	46	1892	139.9		987		905	44	151.4	3.8	0.6	0.9
STA. 832+70.45 TO STA. 836+53.87	383.42	46	1960	144.9		1022		938	44	156.8	3.9	0.6	1
STA. 836+53.87 TO STA. 839+82.14	328.27	42	1532	114.9		875		657	44	122.6	3.1	0.5	0.8
STA. 839+82.14 TO STA. 844+23.20	426.67	42	1991	149.3		1138		853	44	159.3	4	0.6	1
STA. 844+23.20 TO STA. 867+45	2247.8	42	10490	786.7		5994		4496	200	839.2	21	3.1	5.2
TOTAL				3344.5	605	16454	14405	11946	980	4576.9	114.5	12.8	28.6

MANHOLE TO BE ADJUSTED	
LOCATION	EACH
TO BE DETERMINED BY ENGINEER IN FIELD	5
TOTAL	5

MANHOLES TO BE ADJUSTED WITH NEW TYPE 1 FRAME, CLOSED LID	
LOCATION	EACH
TO BE DETERMINED BY ENGINEER IN FIELD	5
TOTAL	5

WATER VALVES TO BE ADJUSTED	
LOCATION	EACH
TO BE DETERMINED BY ENGINEER IN FIELD	5
TOTAL	5

THERMOPLASTIC PAVEMENT MARKING SCHEDULE								
LOCATION	THERMO PVMT MARK		THERMOPLASTIC PVMT MARKING		THERMO PVMT MARK WHITE 8" FOOT	THERMO PVMT MARK WHITE 12" FOOT	THERMO PVMT MARK WHITE 24" FOOT	THERMO PVMT MARK LETTERS & SYMBOLS SQ FT
	YELLOW 4" FOOT	WHITE 6" FOOT	YELLOW 6" FOOT	WHITE 8" FOOT				
	FOOT	FOOT	FOOT	FOOT				
STA. 754+88 TO STA. 786+60		66	317		61			
STA. 792+75 TO STA. 804+74.32		120		113			31.2	
STA. 809+04.68 TO STA. 814+25.55		499			249			
STA. 814+25.55 TO STA. 818+00.3		586		247	191	52	117.6	
STA. 818+00.3 TO STA. 821+67.52		405			176	44	42.7	
STA. 821+67.52 TO STA. 825+33.35		424			202	53	42.7	
STA. 825+33.35 TO STA. 829+00.22		370			176	44	42.7	
STA. 829+00.22 TO STA. 832+70.45	620	440			299	44	38.1	
STA. 832+70.45 TO STA. 836+53.87	588		186		24			
STA. 836+53.87 TO STA. 839+82.14	420		35		36		59.6	
STA. 839+82.14 TO STA. 844+23.20	600				72		119.2	
STA. 844+23.20 TO STA. 848+76	400		100		36		59.6	
STA. 848+76 TO STA. 867+45		52	461		48	42		
SUBTOTAL	2628	2962	1099	360	1402	447	553.4	
TOTAL	2628	4061		360	1402	447	553.4	

• PROPOSED NO PASSING ZONES SHALL BE STRIPED AS EXISTING.

OMISSIONS  
 STA. 786+60 TO 792+75 (NEW PVMT)  
 STA. 804+74.32 TO STA. 809+09.68 (SN 050-0202)  
 STA. 839+82.14 TO STA. 839+96.53 (RR)  
 STA. 844+23.2 TO STA. 844+97.2 (RR)

FILE NAME =	USER NAME = carpenterdj	DESIGNED -	REVISED -	STATE OF ILLINOIS DEPARTMENT OF TRANSPORTATION	SCHEDULE OF QUANTITIES			F.A.P. RTE.	SECTION	COUNTY	TOTAL SHEETS	SHEET NO.
oz:\proj\jcts\d366806\d366806-shr-soq.dgn		DRAWN -	REVISED -		SCALE:	SHEET NO.	OF SHEETS	STA.	TO STA.	LASALLE	12	5
		CHECKED -	REVISED -							ILLINOIS FED. AID PROJECT		
		DATE -	REVISED -							CONTRACT NO. 66806		

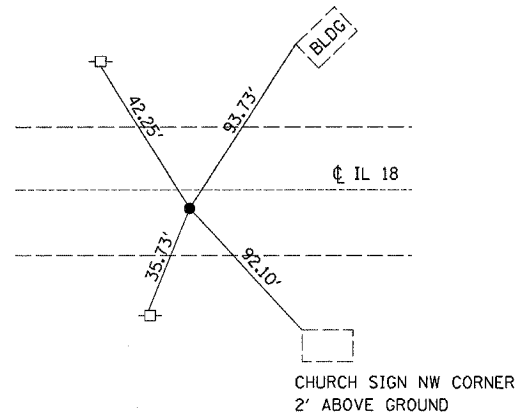

NORTHEAST CORNER  
 SEC 34 T31N R3E THIRD PM LASALLE COUNTY  
 FOUND BRASS DISK ±2.7' S. OF  $\text{CL}$  IL 18

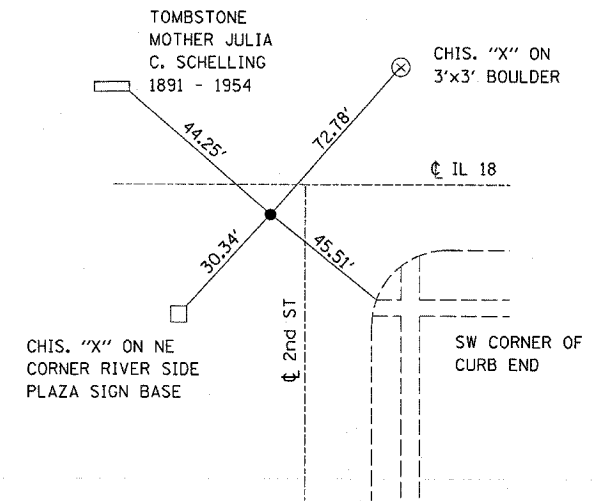

N 1/4 CORNER  
 SEC 35 T31N R3E THIRD PM LASALLE COUNTY  
 FOUND BRASS DISK ±5.1' S. OF  $\text{CL}$  IL 18

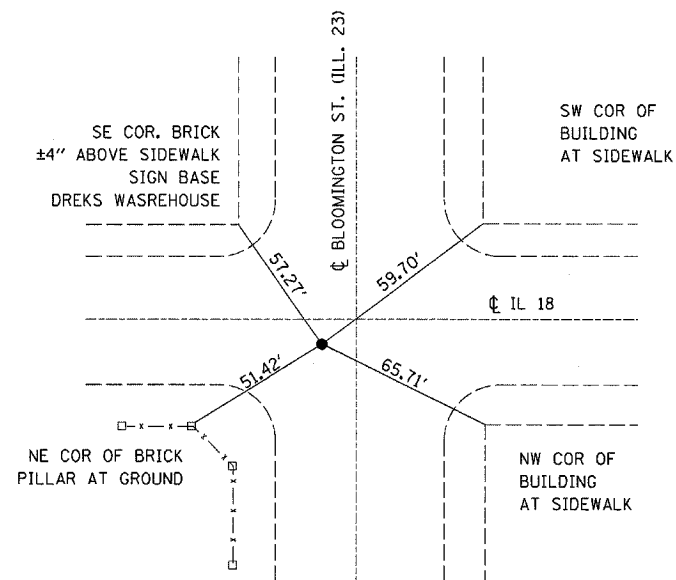

NORTHEAST CORNER  
 SEC 35 T31N R3E THIRD PM LASALLE COUNTY  
 FOUND BRASS DISK ± 1.8' S. OF  $\text{CL}$  IL 18

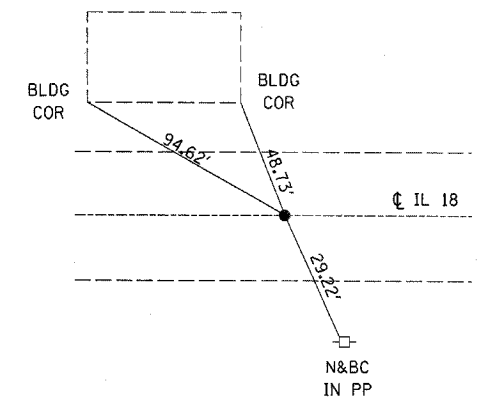

N 1/4 CORNER  
 SEC 36 T31N R3E THIRD PM LASALLE COUNTY  
 SET PK NAIL  $\text{CL}$  IL 18

FILE NAME =	USER NAME = oarpentardj	DESIGNED -	REVISED -
ci:\projects\4366806\4366806-shr-details.dgn		DRAWN -	REVISED -
		CHECKED -	REVISED -
		DATE -	REVISED -

**STATE OF ILLINOIS  
 DEPARTMENT OF TRANSPORTATION**

SURVEY TIES			
SCALE:	SHEET NO.	OF SHEETS	STA. TO STA.

F.A.P. RTE.	SECTION	COUNTY	TOTAL SHEETS	SHEET NO.
653	(8,29)RS-3	LASALLE	12	6
CONTRACT NO. 66806				
FED. ROAD DIST. NO. ILLINOIS FED. AID PROJECT				

OMISSION SN 050-0202  
 STA. 804+74.32 TO STA. 809+09.68



BEGIN IMPROVEMENT  
 STA. 754+88

E. 16TH RD. (SPRING LAKE RD.)  
 STA. 758+10.5

OMISSION - NEW PAVEMENT  
 STA. 786+60 TO STA. 792+75

CEMETARY ENTRANCE  
 STA. 775+02.5

N. 1ST ST. (IL 18 EASTBOUND)

VERMILION RIVER

OAK ST.  
 STA. 811+75

E. 16TH RD.

STACY AVE.

COLUMBUS RD.  
 STA. 768+60.3

CLARK ST.  
 STA. 772+28.65

N. 4TH ST.  
 STA. 780+88.93

N. 3RD ST.  
 STA. 784+70.80

N. 2ND ST.  
 STA. 788+55.07

ARMORY ST.  
 STA. 799+49

BLOOMINGTON ST.  
 (IL 23 SOUTHBOUND)  
 STA. 814+25.55

PARK ST.  
 (IL 23 NORTHBOUND)  
 STA. 818+00.3

MONROE ST.  
 STA. 821+67.52

VERMILION ST.  
 STA. 825+33.35

STERLING ST.  
 STA. 829+00.22

WASSON ST.  
 STA. 832+70.45

EVERETT ST.  
 STA. 836+53.87

NORFOLK SOUTHERN RR

SHABONA ST.  
 STA. 840+55.75

BNSF RR  
 ILLINOIS ST.  
 STA. 844+90

ILLINOIS ST.  
 STA. 845+79

LEXINGTON AVE.  
 STA. 848+76

IOWA AVE.  
 STA. 851+71

N. COLORADO AVE.  
 STA. 855+41

WISCONSIN AVE.  
 STA. 859+10

INDIANA AVE.  
 STA. 862+80

N. OTTER CREEK RD.

MAIN ST. (IL 18)

RAILROAD OMISSION  
 STA. 839+82.14 TO 839+96.53

RAILROAD OMISSION  
 STA. 844+23.2 TO 844+97.20

END IMPROVEMENT  
 STA. 867+45

FILE NAME = c:\projects\4366886\4366886-shr-detail.sgn	USER NAME = carpenterd.j	DESIGNED -	REVISED -	<b>STATE OF ILLINOIS DEPARTMENT OF TRANSPORTATION</b>	<b>PROJECT LAYOUT</b>				F.A.P. RTE. 653	SECTION (8,29)RS-3	COUNTY LASALLE	TOTAL SHEETS 12	SHEET NO. 7
PLLOT SCALE = 50,0000' / IN.	PLLOT DATE = Mar 25, 2008 - 01:58:32 PM	DRAWN -	REVISED -						SCALE:	SHEET NO.	OF	SHEETS	STA.
CHECKED -	DATE -	REVISED -	REVISED -		FED. ROAD DIST. NO. ILLINOIS FED. AID PROJECT								

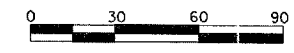
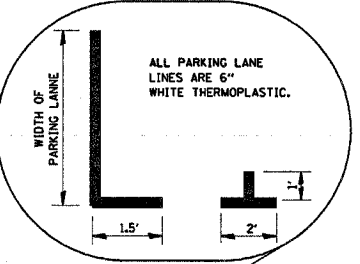
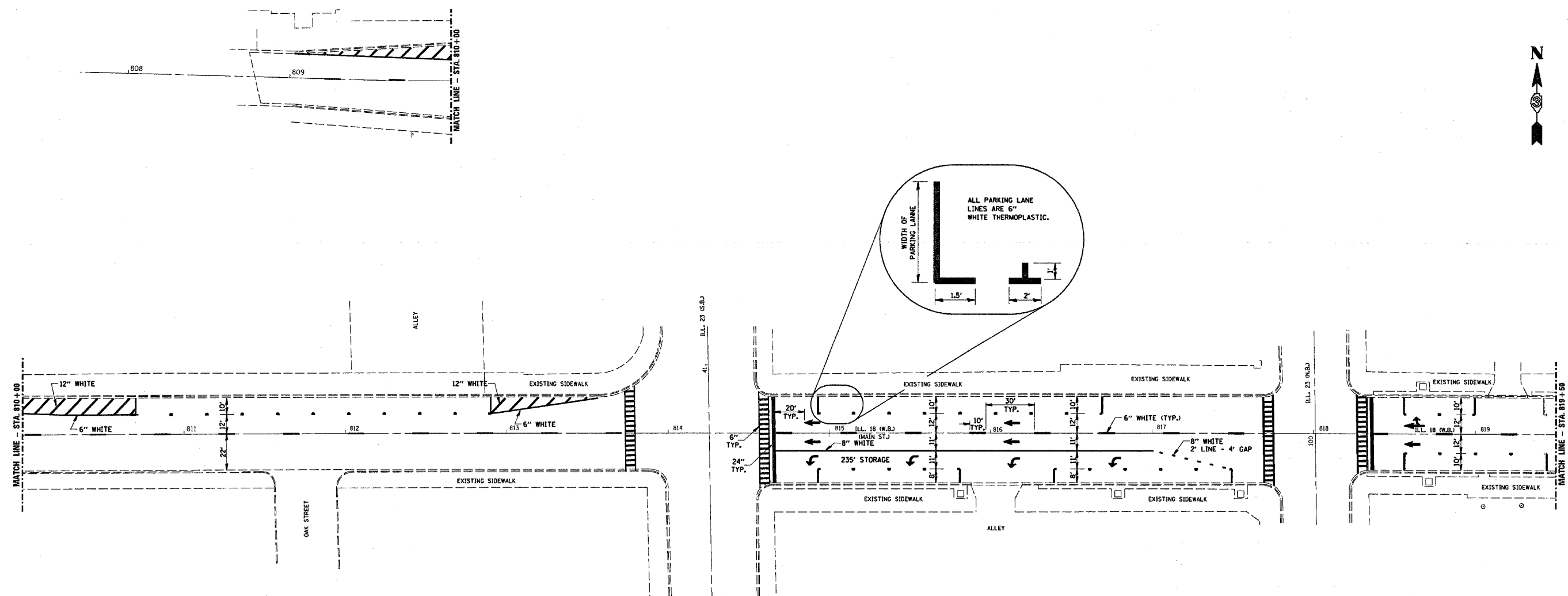

FILE NAME = c:\projects\366806\366806-sht-details.dgn	USER NAME = carpenterd.j	DESIGNED -	REVISED -	<b>STATE OF ILLINOIS DEPARTMENT OF TRANSPORTATION</b>	<b>PAVEMENT MARKING</b>			F.A.P. RTE. 653	SECTION (8,29)RS-3	COUNTY LASALLE	TOTAL SHEETS 12	SHEET NO. 8
	PLOT SCALE = 50.0000' / IN.	CHECKED -	REVISED -					CONTRACT NO. 66806				
	PLOT DATE = Mar 25, 2008 - 01:58:24 PM	DATE -	REVISED -					FED. ROAD DIST. NO. ILLINOIS FED. AID PROJECT				
				SCALE: SHEET NO. OF SHEETS STA. TO STA.								



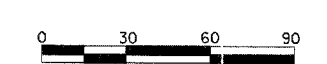
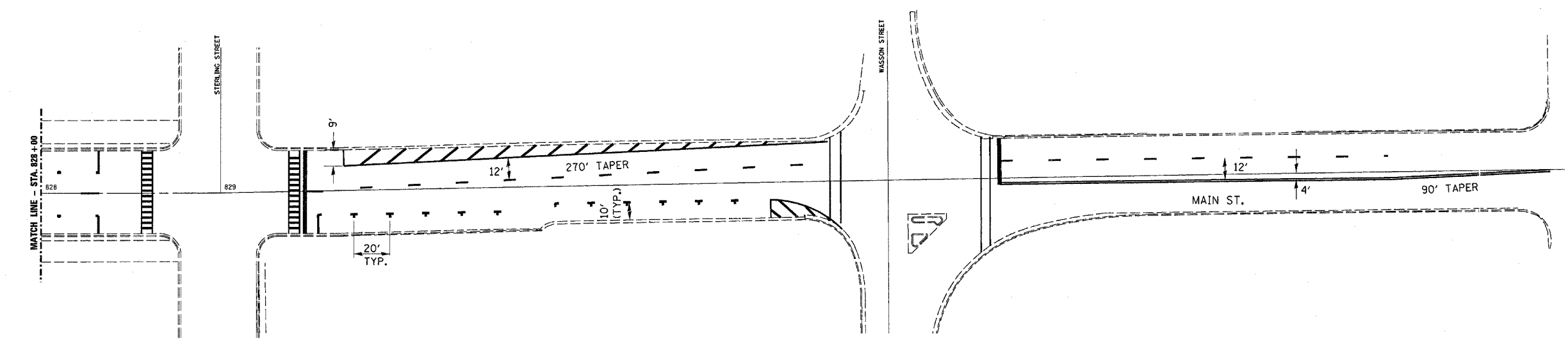
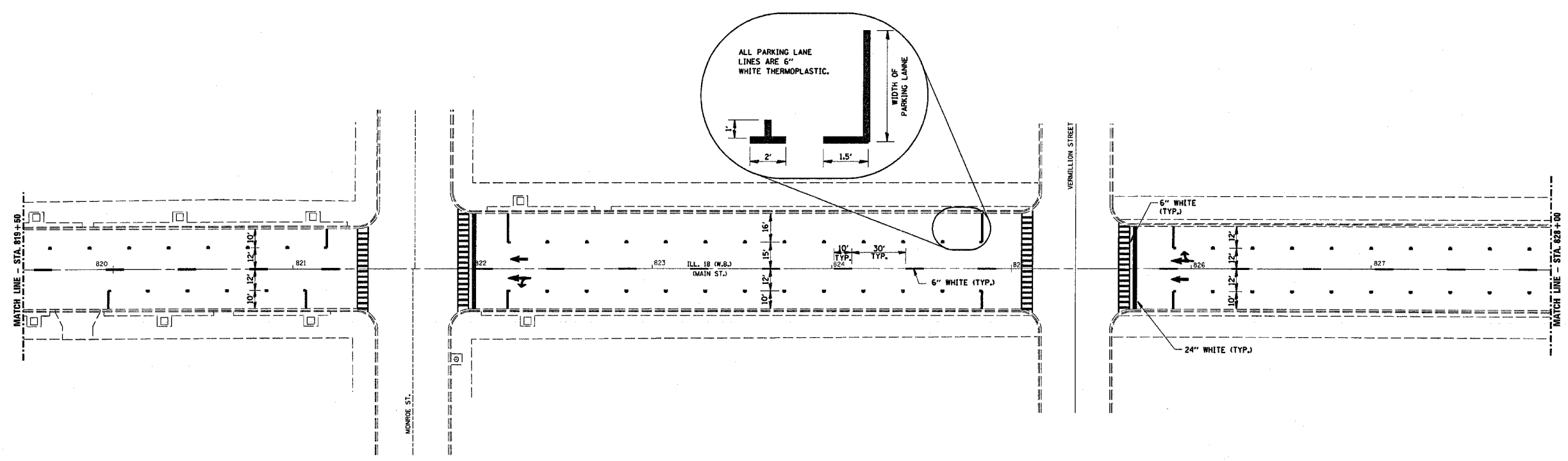

FILE NAME =	USER NAME = carpenterd.j	DESIGNED -	REVISED -	<b>STATE OF ILLINOIS DEPARTMENT OF TRANSPORTATION</b>	<b>PAVEMENT MARKING</b>				F.A.P. RTE.	SECTION	COUNTY	TOTAL SHEETS	SHEET NO.
cr\projects\4366806\4366806-ah-detailed.sgn	PLLOT SCALE = 50.0000' / IN.	DRAWN -	REVISED -						653	(8,29)RS-3	LASALLE	12	9
PLLOT DATE = Mar 25, 2008 - 01:58:14 PM	DATE -	CHECKED -	REVISED -		SCALE: SHEET NO. OF SHEETS STA. TO STA.				CONTRACT NO. 66806				
		DATE -	REVISED -						FED. ROAD DIST. NO. ILLINOIS FED. AID PROJECT				

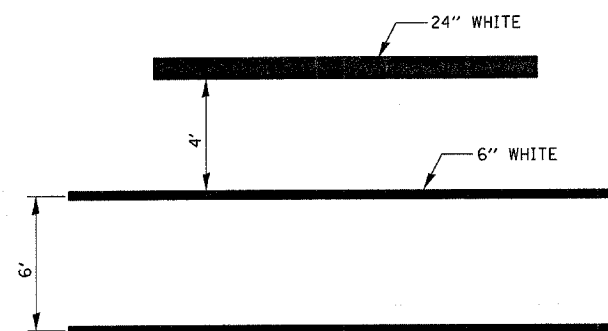

**TYPICAL SPACING DETAIL FOR CROSSWALKS AND STOP BARS**

**OPTION 1**

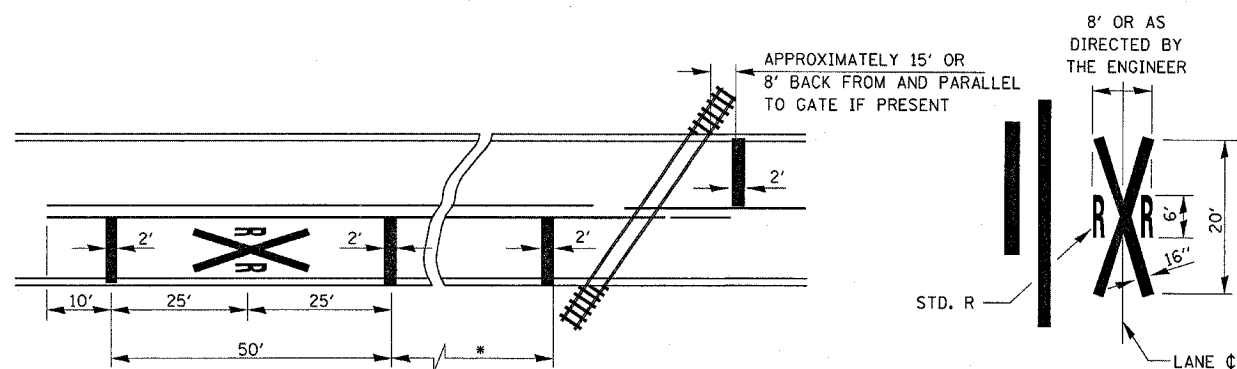

**PAVEMENT MARKINGS AT RAILROAD-HIGHWAY GRADE CROSSING**

NOTES:  
 THE TRANSVERSE SPREAD OF THE "X" MAY VARY ACCORDING TO LANE WIDTH.  
 ON MULTI-LANE ROADS, THE STOP LINES SHALL EXTEND ACROSS ALL APPROACH LANES AND SEPARATE RXR SYMBOLS SHALL BE PLACED ADJACENT TO EACH OTHER IN EACH LANE.

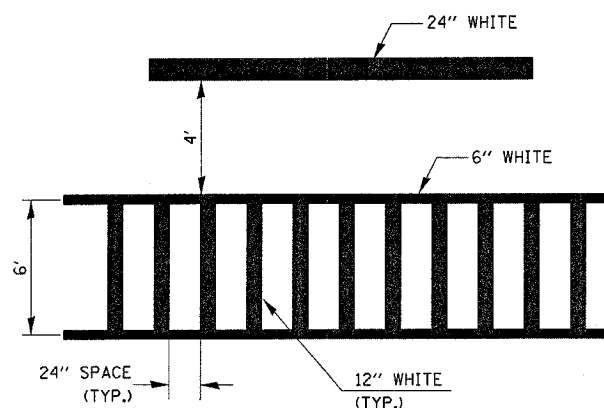

**TYPICAL SPACING DETAIL FOR CROSSWALKS AND STOP BARS**

**OPTION 2**

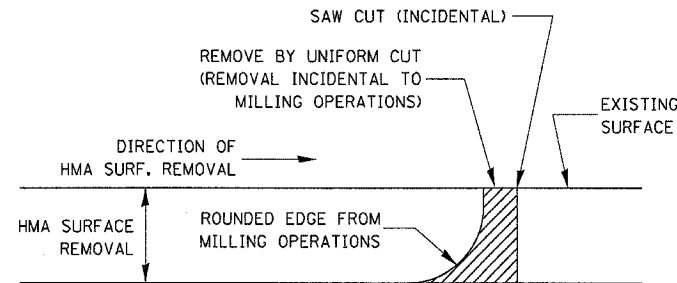

NOTE:  
 WHEN MILLING OPERATIONS PRODUCE A ROUNDED EDGE, THEN A SAW CUT SHALL BE USED TO MANUFACTURE A PERPENDICULAR EDGE AS SHOWN IN THE DETAIL. THE ENGINEER SHALL BE THE SOLE JUDGE CONCERNING THE USE OF THIS DETAIL.

**HMA DETAIL AT BUTT JOINTS**

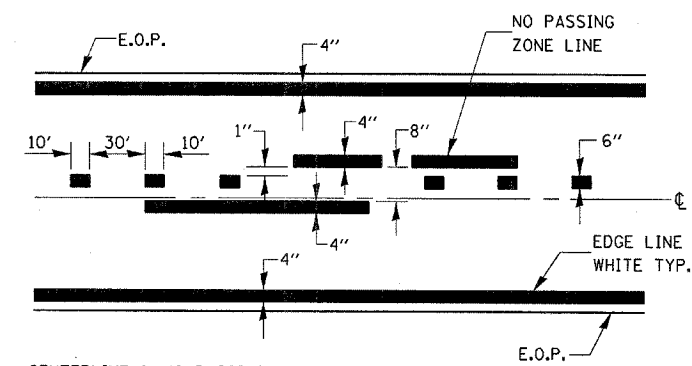

CENTERLINE & NO PASSING ZONE LINES - YELLOW  
 (SEE TYPICAL SECTIONS)

**PAVEMENT MARKING**

FILE NAME =	USER NAME = oarpentardj	DESIGNED -	REVISED -
ca:\projects\66806\66806-ht-details.dgn		DRAWN -	REVISED -
PLOT SCALE = 50.0000 / IN.		CHECKED -	REVISED -
PLOT DATE = Mar 25, 2008 - 01:58:06 PM		DATE -	REVISED -

STATE OF ILLINOIS  
 DEPARTMENT OF TRANSPORTATION

DETAILS

SCALE: SHEET NO. OF SHEETS STA. TO STA.

F.A.P. RTE.	SECTION	COUNTY	TOTAL SHEETS	SHEET NO.
653	(8,29)RS-3	LASALLE	12	10
FED. ROAD DIST. NO.		ILLINOIS FED. AID PROJECT		

CONTRACT NO. 66806

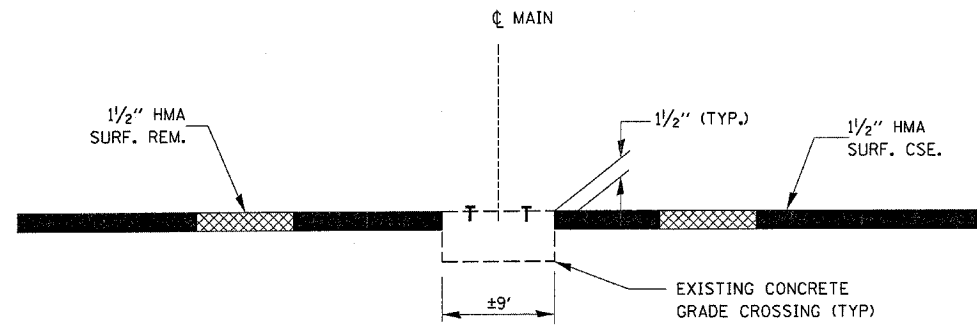

**PROPOSED RESURFACING DETAIL  
AT NORFOLK SOUTHERN RR GRADE CROSSING**

IL 18 - NORFOLK SOUTHERN RAILWAY (DOT/AAR NO. 534 407 M)

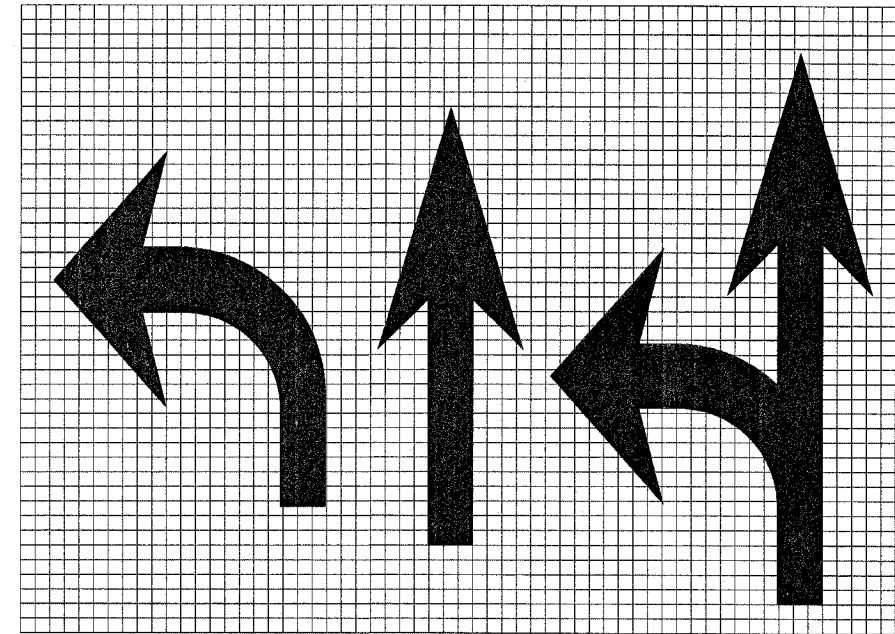

LEGEND HEIGHT	ARROW SIZE	a
6'	SMALL	2.9
8'	LARGE	3.8

**ARROW GRID SCALE**

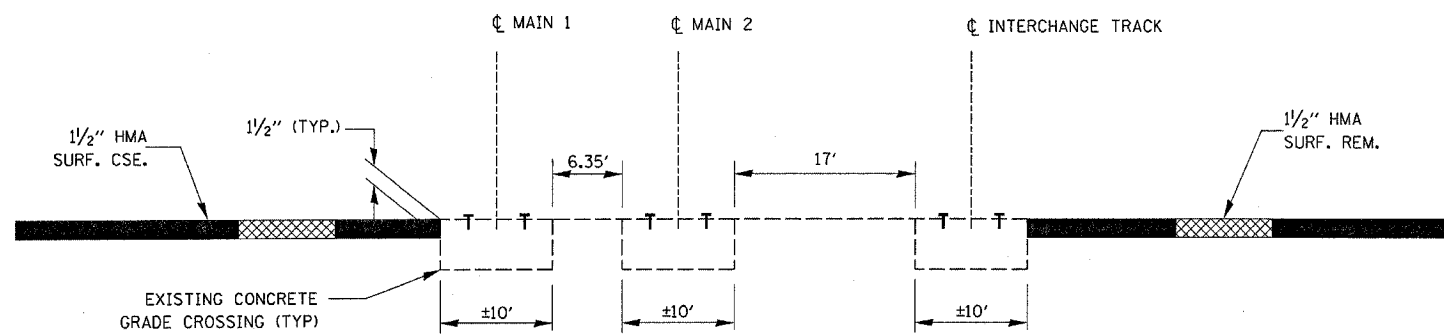

**PROPOSED RESURFACING DETAIL  
AT BNSF RR GRADE CROSSING**

IL 18 - BNSF RAILWAY (DOT/AAR NO. 004 481 J)

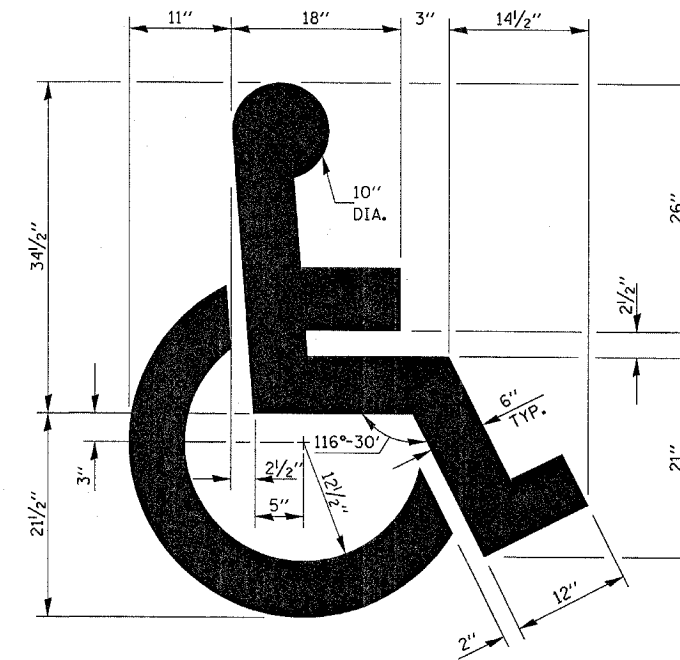

**TYPICAL DETAIL FOR  
PAINTING HANDICAP MARKINGS**

FILE NAME =	USER NAME = carpenterdj	DESIGNED -	REVISED -
ca\projects\4366886\4366886-sht-details.dgn		DRAWN -	REVISED -
	PLOT SCALE = 50.0000' / IN.	CHECKED -	REVISED -
	PLOT DATE = Mar 25, 2008 - 01:57:59 PM	DATE -	REVISED -

**STATE OF ILLINOIS  
DEPARTMENT OF TRANSPORTATION**

**DETAILS**

SCALE: SHEET NO. OF SHEETS STA. TO STA.

F.A.P. RTE.	SECTION	COUNTY	TOTAL SHEETS	SHEET NO.
653	(8,29)RS-3	ASALLE	12	11
FED. ROAD DIST. NO.		ILLINOIS FED. AID PROJECT		
CONTRACT NO. 66806				

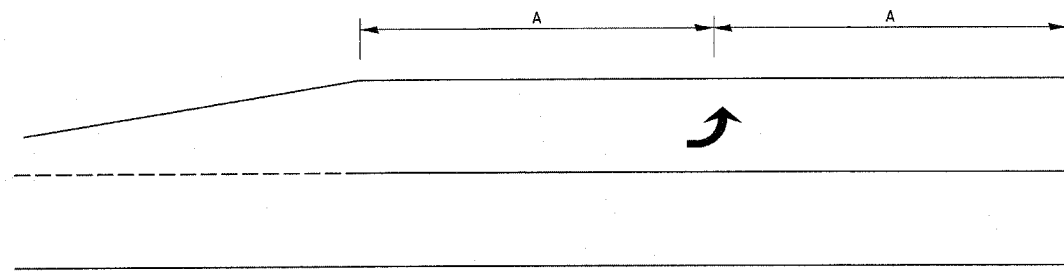

**99' AND UNDER**

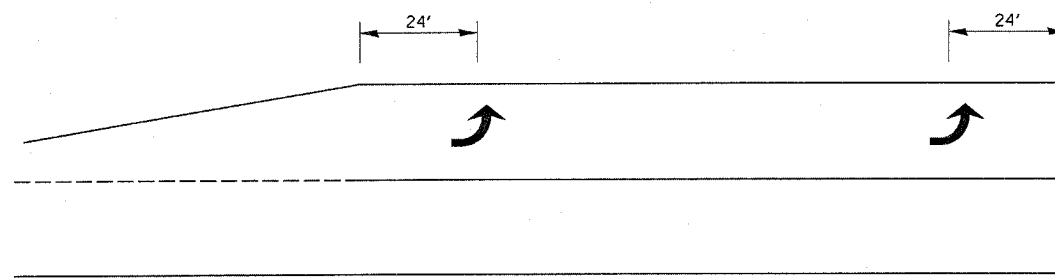

**100' TO 149'**

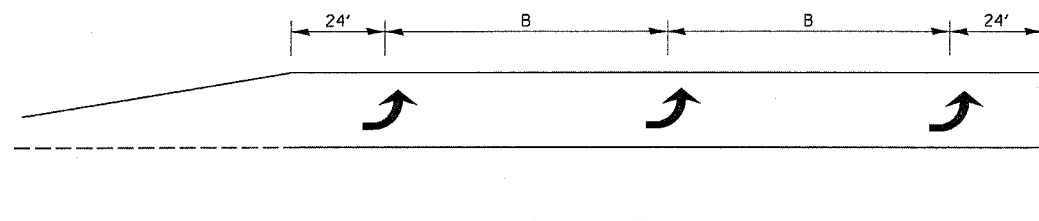

**150' AND LONGER**

**TYPICAL PLACEMENT OF ARROWS  
IN TURN LANES**

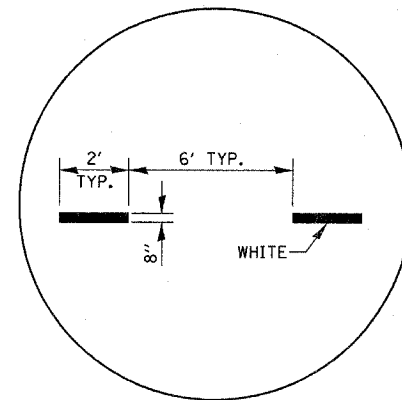

**ADVANCE AND INTERSECTION LANE  
DIVIDER LINES**

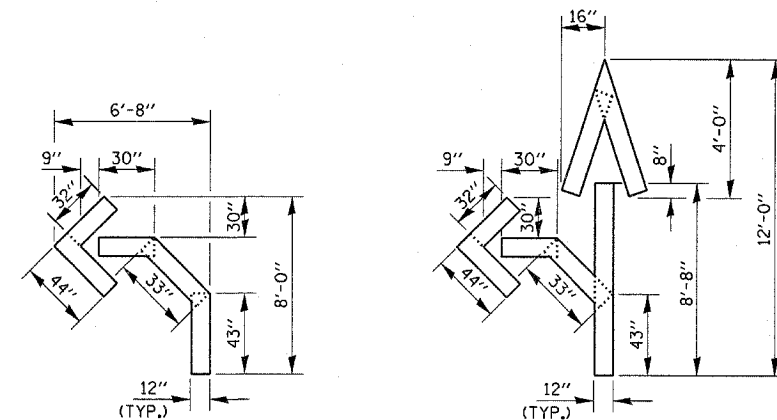

**QUANTITY**  
12" LINE = 16 LIN. FT.  
OR 4" LINE = 48 LIN. FT.

**QUANTITY**  
12" LINE = 29 LIN. FT.  
OR 4" LINE = 87 LIN. FT.

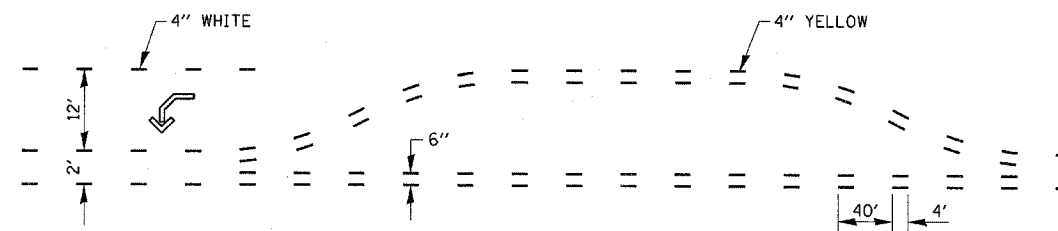

**SHORT-TERM PAVEMENT MARKING  
FOR MEDIANS AND ARROWS**

FILE NAME =	USER NAME = carpenterdj	DESIGNED -	REVISED -	<b>STATE OF ILLINOIS DEPARTMENT OF TRANSPORTATION</b>	<b>DETAILS</b>	F.A.P. RTE.	SECTION	COUNTY	TOTAL SHEETS	SHEET NO.	
c:\projects\4366806\4366806-shr-details.dgn		DRAWN -	REVISED -			653	(8,29)RS-3	I. ASALLE	12	12	
PLOT SCALE = 50.0000' / IN.		CHECKED -	REVISED -			CONTRACT NO. 66806					
PLOT DATE = Mar 25, 2008 - 01:57:50 PM		DATE -	REVISED -			FED. ROAD DIST. NO. ILLINOIS FED. AID PROJECT					
					SCALE:	SHEET NO.	OF	SHEETS	STA.	TO STA.	