

① Spacing 80 ft max. for first 400 ft or curve spacing shown in Standard 635001, whichever is less (min. 4 reflectors regardless of length).

② After 400 ft, transition to normal delineator spacing shown in Standard 635001, and continue as required.

ONE-WAY TRAFFIC

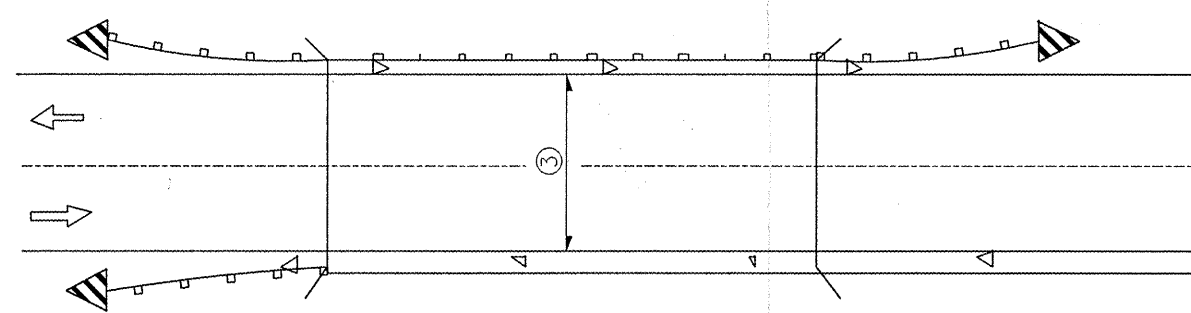

③ Bidirectional silver/silver should be used in lieu of monodirectional silver on both sides of two-lane bridges where the pavement is less than 24' wider than the pavement approaching the bridge.

- △ Monodirectional silver
- ▲ Monodirectional amber
- ▴ Terminal Marker - Black/Yellow Left or Right as appropriate

TWO-WAY TRAFFIC

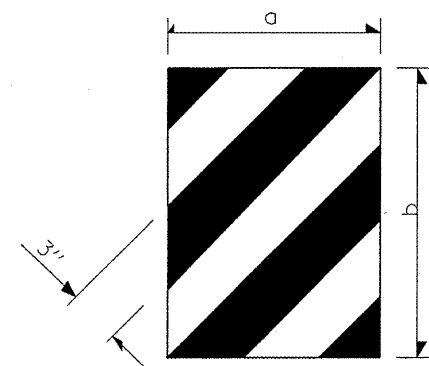

DIMENSION	CASE I	CASE II
a	*	450 (18)
b	*	406 (16)

\* The width and height (a, b) of the terminal marker shall be within approximately 25 mm (1 inch) of the outer edge of the terminal end, with a minimum reflective area of 0.18 m<sup>2</sup> (288 sq. in.)

TERMINAL MARKER DETAILS  
Color: Black / Yellow reflectorized

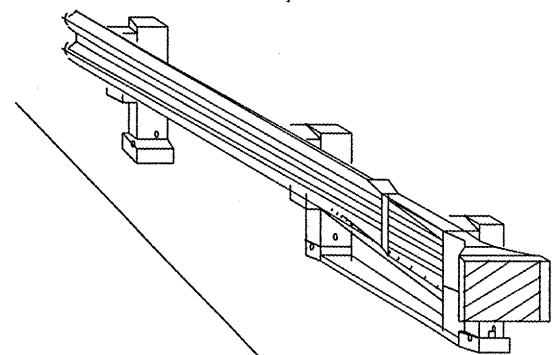

REFLECTOR AND TERMINAL MARKER PLACEMENT

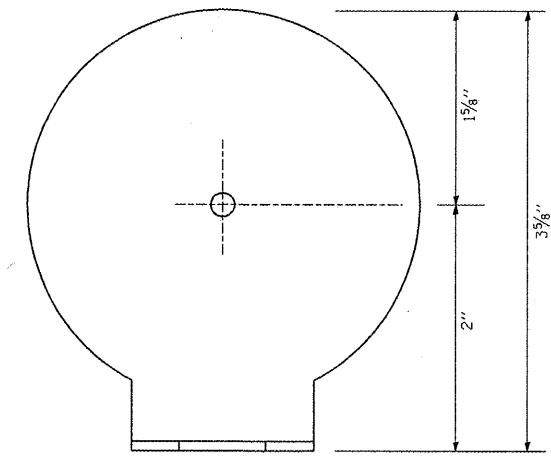
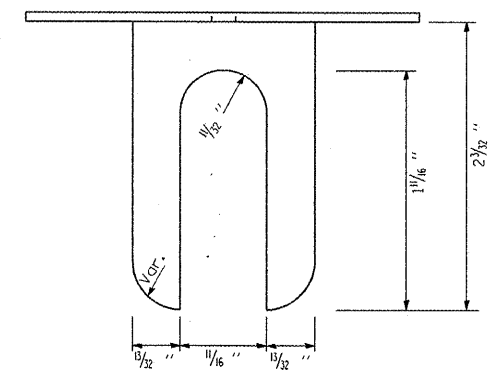

REFLECTOR MARKER TYPE A

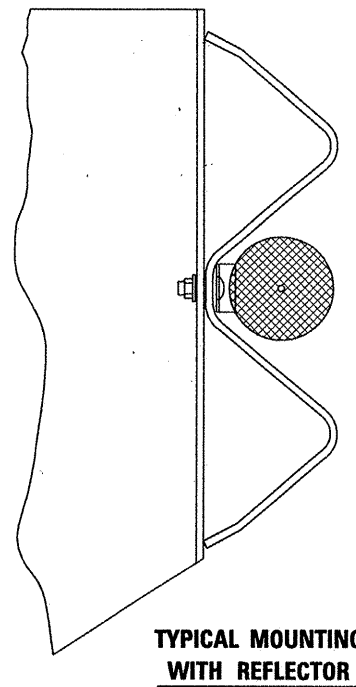

TYPICAL MOUNTING WITH REFLECTOR

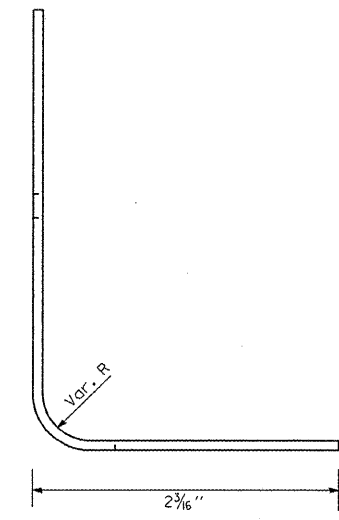

- NOTES:**
- BRACKET IS TO BE FABRICATED FROM 12 GA. (MIN) STEEL GALVANIZED IN ACCORDANCE WITH AASHTO M III.
  - MIN. 3 REFLECTORS PER SIDE.
  - BRACKET "FOOT" SHALL BE PLACED BETWEEN THE BOLT HEAD AND THE PLATE WASHER (IF PRESENT).
  - ON THRIE BEAM RAIL, THE BRACKETS SHALL BE ATTACHED TO THE UPPER SPLICE BOLTS.
  - USE CRYSTAL COLOR, BI-DIRECTIONAL REFLECTORS USE AMBER (LEFT) AND CRYSTAL (RIGHT), MONODIRECTIONAL REFLECTORS ON INTERSTATES
  - ALL DIMENSIONS SHOWN ARE MINIMUM

REFLECTOR DETAIL

FILE NAME =	USER NAME = schwankerg	DESIGNED -	REVISED -
c:\projects\d366812\d366812-sht-details.dgn		DRAWN -	REVISED -
	PLOT SCALE = 103.1218 "/ IN.	CHECKED -	REVISED -
	PLOT DATE = May 21, 2008 - 03:34:20 PM	DATE -	REVISED -

STATE OF ILLINOIS  
DEPARTMENT OF TRANSPORTATION

REFLECTOR AND TERMINAL MARKER PLACEMENT DETAIL			
SCALE:	SHEET NO. OF SHEETS	STA. TO STA.	

F.A. RTE.	SECTION	COUNTY	TOTAL SHEETS	SHEET NO.
VAR.	*	VAR.	36	6
CONTRACT NO. 66812				
FED. ROAD DIST. NO. ILLINOIS FED. AID PROJECT				