

STATE OF ILLINOIS
DEPARTMENT OF TRANSPORTATION

ROUTE NO.	SECTION	COUNTY	SHEET	SHEET	SHEET NO.
F.A.P. 313	(21-HB-11)	KNOX	55	18	35 SHEETS
FED. ROAD DIST. NO. 7		ILLINOIS	FED. AID PROJECT		

Contract #68216

Bench Mark: A264, located at the Galesburg Municipal Airport, set vertically in the southwest face of the terminal building, about 30' southeast of the west corner of the building, and 30" above the sidewalk. Elevation 764.933

Existing Structure: The existing structures were originally built in 1965 as F.A. Route 29, Section 21HB. The existing structures are four span continuous, non-composite, rolled steel girder structures on pile bent abutments and multi-column piers on pile supported footings. The back to back of abutments measures 239'-0" and out to out bridge width varies. Traffic is to be maintained utilizing stage construction.

SCOPE OF WORK

1. Remove and replace bearings at the abutments.
2. Repair substructure.
3. Remove existing wingwalls as shown.
4. Repair slopewall. For slopewall Repair, see Roadway Plans.

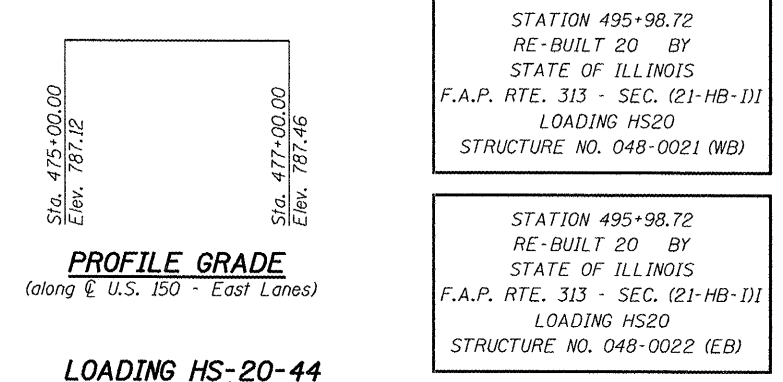
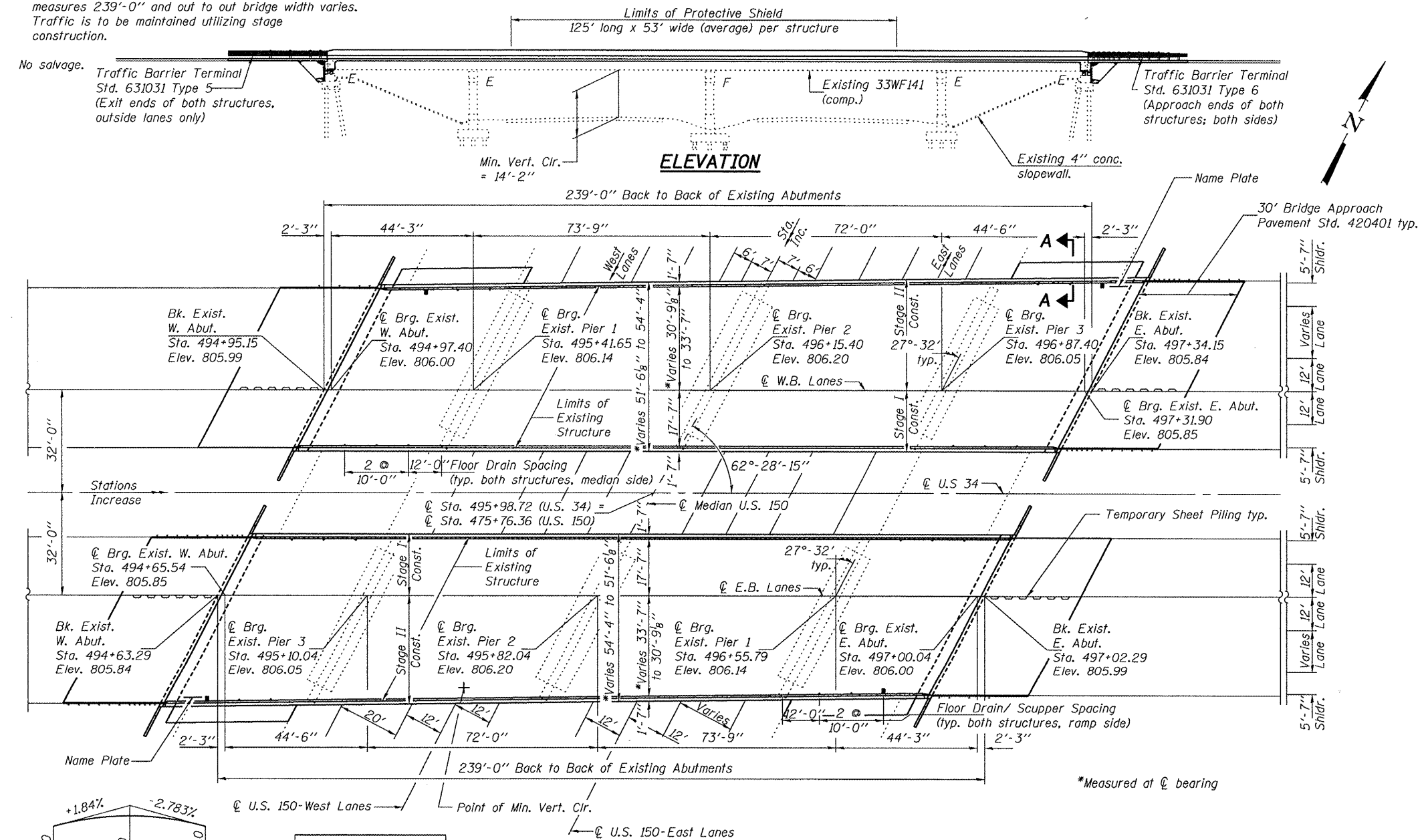

NAME PLATE

See Std. 515001
Existing Name Plates shall be cleaned and relocated next to new Name Plate. Cost included with "Name Plates".

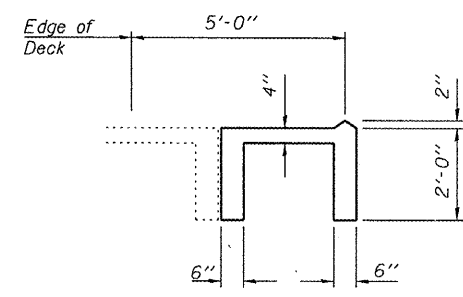

SECTION A-A

Slopewall shall be reinforced with welded wire fabric, 6" x 6" - W4.0 x W4.0, weighing 58 lbs. per 100 sq. ft.

DESIGN STRESSES

FIELD UNITS
New Construction
 f'_c = 3,500 psi
 f_y = 60,000 psi (reinforcement)
 f_y = 36,000 psi (structural steel)
Existing Construction
 f'_c = 3,500 psi
 f_y = 40,000 psi (reinforcement)
 f_y = 36,000 psi (Structural Steel)

SEISMIC DATA

Seismic Performance Category (SPC) = A
Bedrock Acceleration Coefficient (A) = 0.048g
Site Coefficient (S) = 1.1

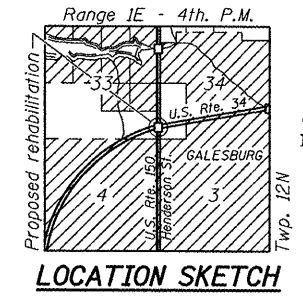

GENERAL PLAN & ELEVATION
U.S. ROUTE 34 OVER
U.S. ROUTE 150 (HENDERSON STREET)
F.A.P. ROUTE 313 - SECTION (21-HB-11)
KNOX COUNTY
STA. 495+98.72
STRUCTURE NO. 048-0021 (WB)
STRUCTURE NO. 048-0022 (EB)

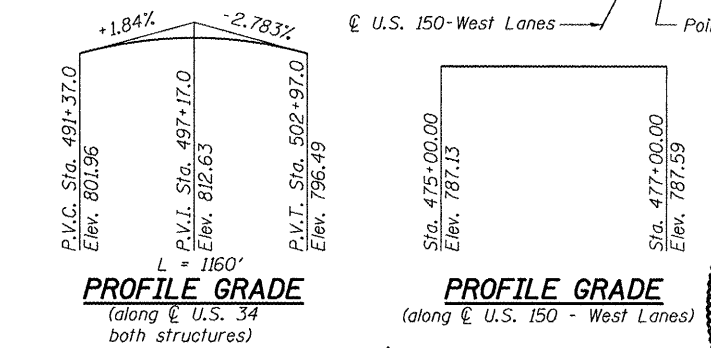

EXPIRES 11-30-2008

DESIGNED: Fess Teklehaimanot
CHECKED: Shum Shun
DRAWN: Greg Farmer
CHECKED: FT/DPN

APRIL 29 2009
EXAMINED: [Signature]
PASSED: [Signature]