

STATE OF ILLINOIS  
DEPARTMENT OF TRANSPORTATION

ROUTE NO.	SECTION	COUNTY	SHEET NO.	SHEET	SHEET NO.
F.A.P. 313	(21-HB-11)	KNOX	55	41	35 SHEETS
FED. ROAD DIST. NO. 7	ELLIPSE	FED. AID PROJECT	Contract #68216		

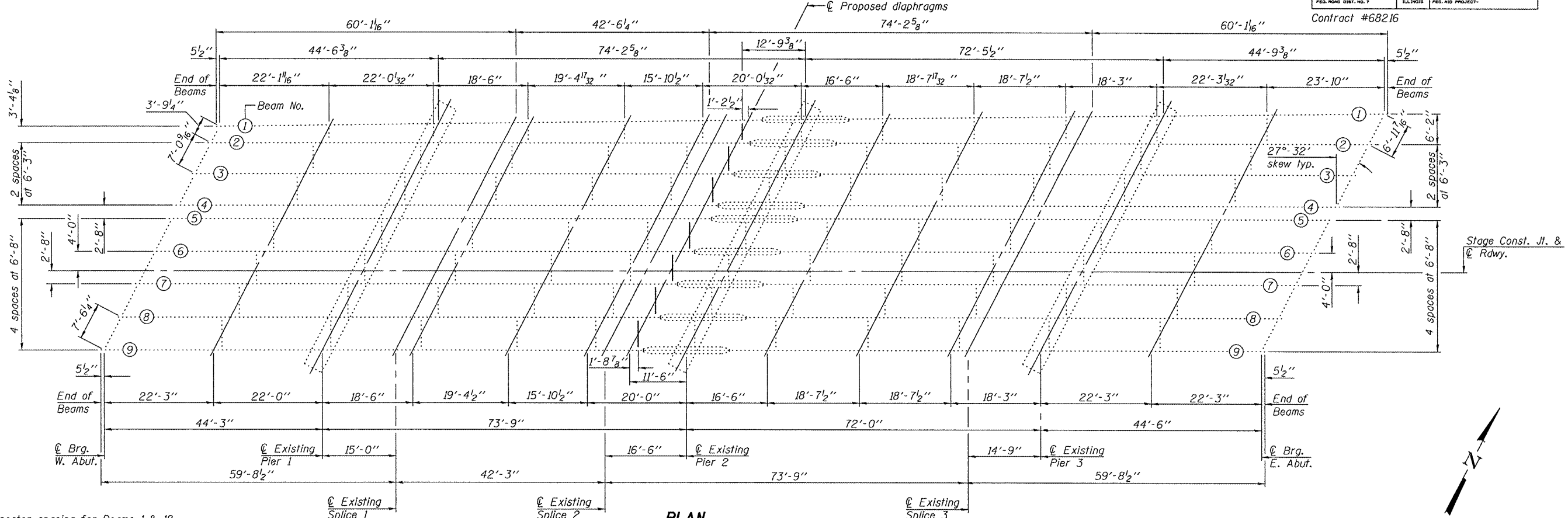

\*Stud shear connector spacing for Beams 1 & 18 are same as spacing for Beams 2 thru 17, except as shown.

(W.B. shown, E.B. similar by rotation 180°, except for beam numbers. For beam numbers, see sheet 5 of 35.)

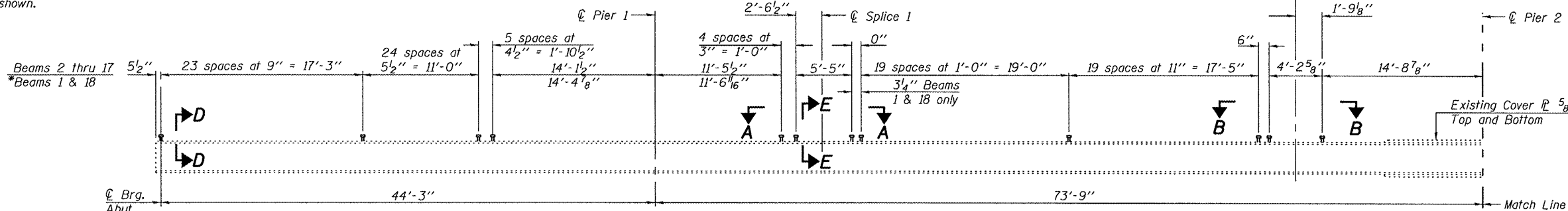

Note:  
For View A-A, B-B, C-C, and Sections D-D and E-E see sheet 25 of 35.

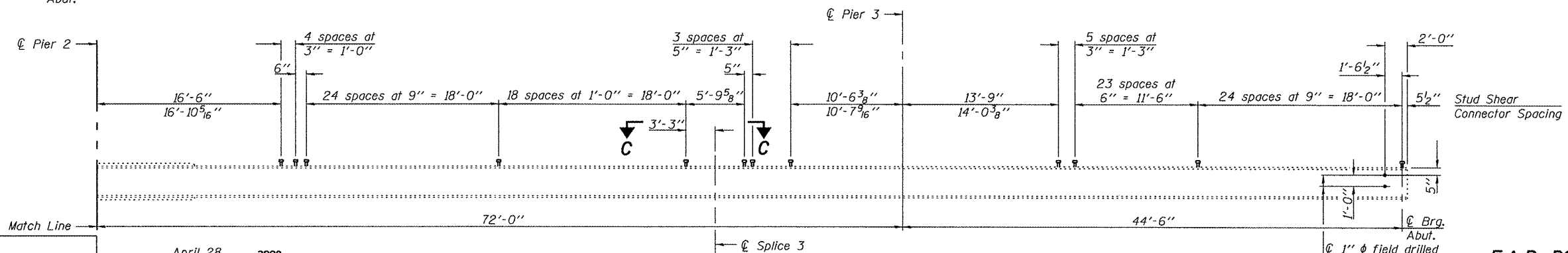

**BEAM ELEVATION**  
(All existing beams are 33WF141)

DESIGNED FT	April 28 2008
CHECKED DPN	EXAMINED <i>Thomas J. Demagali</i>
DRAWN Gregory D. Farmer	PASSED <i>Ralph C. Anderson</i>
CHECKED FT/DPN	

**STRUCTURAL STEEL**  
F.A.P. ROUTE 313 - SECTION (21-HB-11)  
KNOX COUNTY  
STA. 495+98.72  
STRUCTURE NO. 048-0021  
STRUCTURE NO. 048-0022