

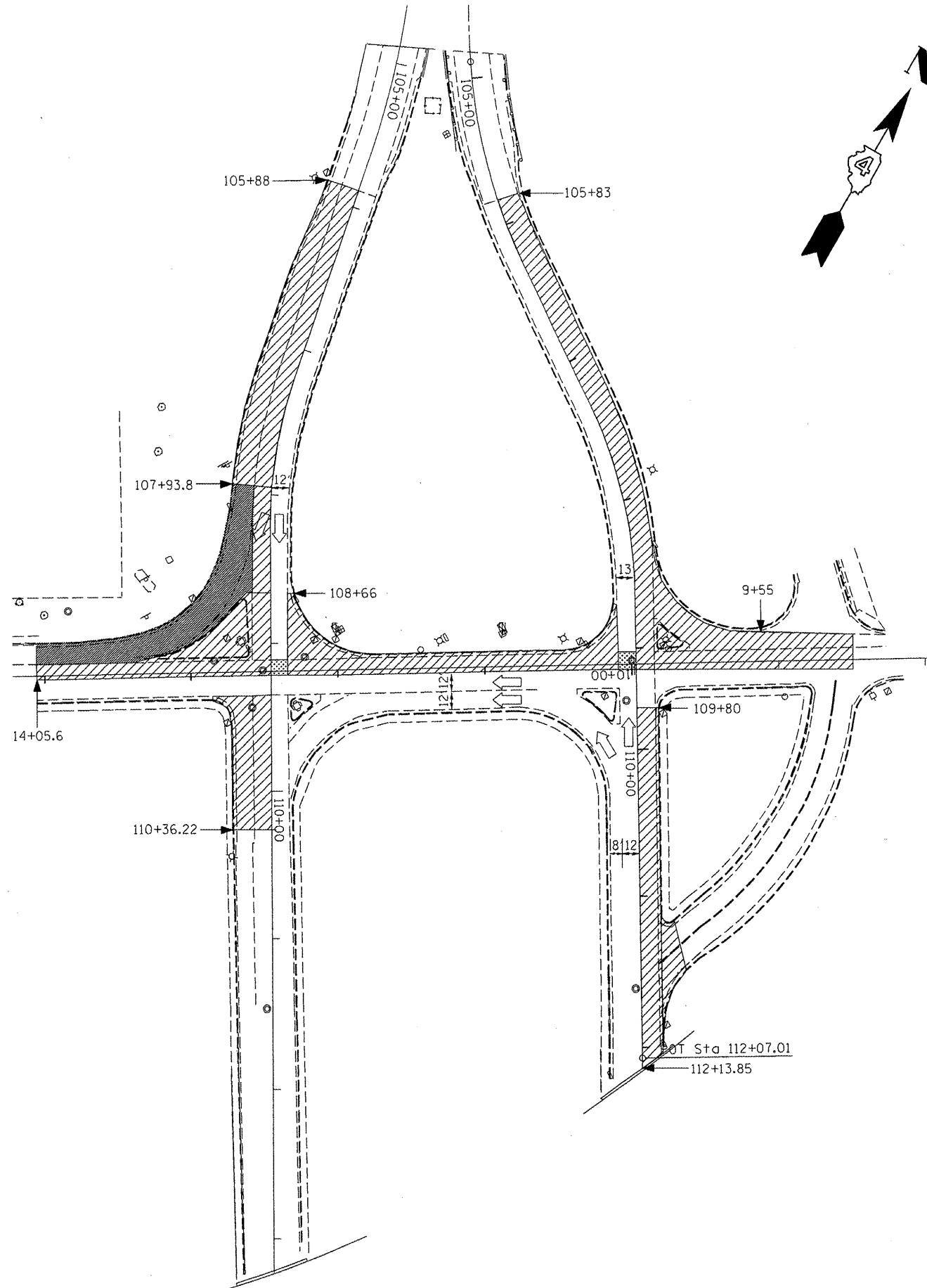





F.A.P. RTE.	SECTION	COUNTY	TOTAL SHEETS	SHEET NO.
693		TAZEWELL	82	31
STA. _____		TO STA. _____		
FED. ROAD DIST. NO. _____		ILLINOIS FED. AID PROJECT		

*13R-1:(9)TS;(12B)L,1-1



1. PROVIDE TWO MESSAGE BOARDS FOR THE DURATION OF THE PROJECT. PLACE ONE ON THE WEST END OF THE PEKIN BRIDGE AND PLACE THE OTHER ON ANN ELIZA EAST OF THE RAIL ROAD TRACKS.
2. INSTALL TEMPORARY SIGNALS FOR IL 29 AND IL 9 TRAFFIC, BEFORE REMOVING ANY EXISTING TRAFFIC SIGNALS AT IL 29 AND IL 9 INTERSECTION.
3. REMOVE EXISTING CONCRETE CURB AND GUTTER AND OUTSIDE LANE ON WEST BOUND IL. 9 AND ON SECOND STREET. REMOVE EXISTING CONCRETE CURB AND GUTTER, RIGHT TURN LANE AND OUTSIDE LANE ON EAST BOUND IL. 9, OMITTING THE OUTSIDE LANE FROM STA. 107+93.8 TO STA. 108+66 ALLOWING RIGHT TURN TO SOUTHBOUND IL 29. CONSTRUCT PROPOSED PAVEMENT AND CURB AND GUTTER.
4. REMOVE AND CONSTRUCT REMAINING SECTIONS OF SECOND STREET USING A HIGH EARLY STRENGTH CONCRETE OR SIMILAR MIX. REMOVE AND CONSTRUCT REMAINING SECTION OF EASTBOUND IL. 9 FROM STA. 107+93.8 TO STA. 108+66.
5. CONTRACTOR HAS THE OPTION TO USE HIGH EARLY OR WAIT FOR THE CONCRETE TO CURE BEFORE SWITCHING TRAFFIC.

LEGEND

-  REMOVAL/REPLACEMENT
-  TEMPORARY PAVEMENT
-  NOT TO BE DISTURBED
-  TEMP PAVEMENT REMOVAL
-  OPTIONAL HIGH EARLY STRENGTH CONCRETE (SEE NOTE 5)

PLOT DATE = 3/25/2008
 PLOT SCALE = 1/8" = 20' / IN.
 USER NAME = brunson

REVISIONS	
NAME	DATE

ILLINOIS DEPARTMENT OF TRANSPORTATION

CONSTRUCTION STAGING
STAGE 1

SCALE: VERT.
HORIZ.
DATE

DRAWN BY
CHECKED BY