

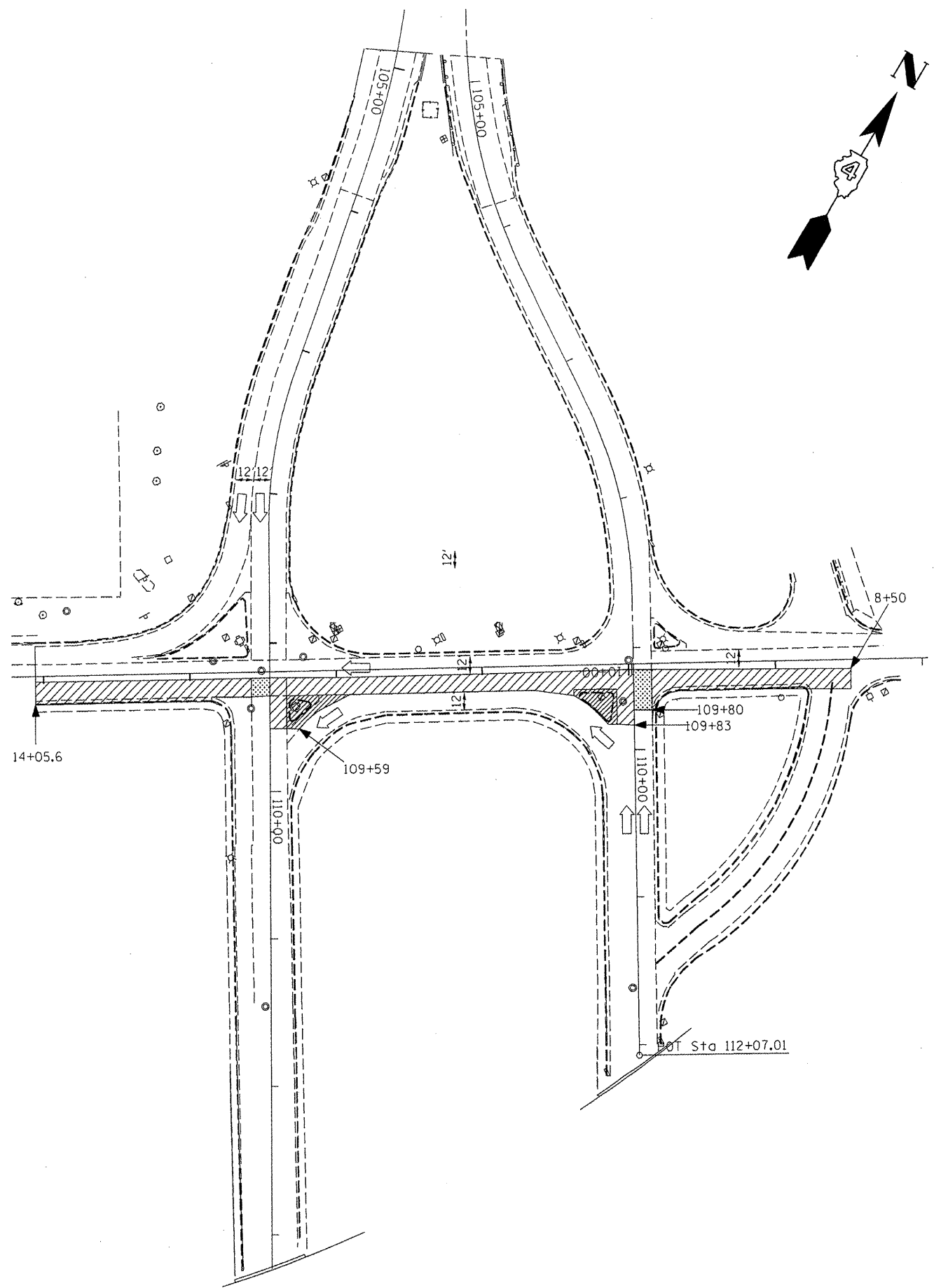





F.A.P. RTE.	SECTION	COUNTY	TOTAL SHEETS	SHEET NO.
693	.	TAZEWELL	82	33
STA. _____		TO STA. _____		
FED. ROAD DIST. NO. _____		ILLINOIS FED. AID PROJECT		
*13R-1(9)TS(12B)L-1-1				

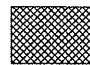

1. REMOVE TEMPORARY PAVEMENT, AT MARGARET AND SECOND ST, CONSTRUCT CONCRETE ISLAND. REMOVE EXISTING PAVEMENT AND CURB AND GUTTER ON THE INSIDE LANE OF SECOND ST EXCLUDING STA. 9+96.99 TO STA. 10+65 AND REPLACE WITH PROPOSED PAVEMENT AND CURB AND GUTTER.
2. REMOVE TEMPORARY PAVEMENT, AT ANN ELIZA AND SECOND ST, CONSTRUCT CONCRETE ISLAND. REMOVE EXISTING PAVEMENT ON SECOND ST FROM STA. 9+96.99 TO STA. 10+65 AND REPLACE WITH PROPOSED PAVEMENT.
3. REMOVE AND CONSTRUCT REMAINING SECTIONS OF SECOND STREET AND WESTBOUND IL. 9, USING A HIGH EARLY STRENGTH CONCRETE OR SIMILAR MIX.
4. CONTRACTOR HAS THE OPTION TO USE HIGH EARLY OR WAIT FOR THE CONCRETE TO CURE BEFORE SWITCHING TRAFFIC.

LEGEND

-  REMOVAL/REPLACEMENT
-  TEMPORARY PAVEMENT
-  NOT TO BE DISTURBED
-  TEMP PAVEMENT REMOVAL
-  OPTIONAL HIGH EARLY STRENGTH CONCRETE (SEE NOTE 4)

PLOT DATE : 2/28/2008  
 FILE NAME : S:\VEN\DRM\T\ST01PLN\5\SO040\NEW\Active\Contract\68608\IL 9 Pktn - plan\ldg  
 PLOT SCALE : 1/8" = 1'-0"  
 USER NAME : bccrean

REVISIONS	
NAME	DATE

ILLINOIS DEPARTMENT OF TRANSPORTATION

**CONSTRUCTION STAGING  
STAGE 3**

SCALE: VERT. \_\_\_\_\_  
 HORIZ. \_\_\_\_\_  
 DATE \_\_\_\_\_

DRAWN BY \_\_\_\_\_  
 CHECKED BY \_\_\_\_\_