

F.A.P. RTE.	SECTION	COUNTY	TOTAL SHEETS	SHEET NO.
693		TAZEWELL	82	42
STA. _____		TO STA. _____		
FED. ROAD DIST. NO. _____ ILLINOIS FED. AID PROJECT				

*13R-1(9)TS(12)BL.1-1

TEMPORARY TRAFFIC SIGNAL LEGEND

- TEMPORARY TRAFFIC SIGNAL SPAN WIRE AND CABLE
- ⊗ TEMPORARY WOOD POLE
- ⊕ TEMPORARY TRAFFIC SIGNAL HEAD WITH BACKPLATE
- ⊕ TEMPORARY 3 SEC. SIGNAL HEAD W/BACKPLATE
- ⊕ 5/C NO. 14 SIGNAL CABLE
- ⊕ TEMPORARY SERVICE INSTALLATION
- ⊕ EX. HANDHOLE
- ⊕ EX. CONTROLLER CABINET
- EX. CONDUIT

SCHEDULE OF QUANTITIES		
ITEM DESCRIPTION	UNIT	QUANTITY
TEMPORARY TRAFFIC SIGNAL INSTALLATION (LOCATION 1)	EACH	1.0
TEMPORARY TRAFFIC SIGNAL INSTALLATION (LOCATION 2)	EACH	1.0

THE CONTRACTOR SHALL COORDINATE THE PLACEMENT OF WOOD POLES, GUY WIRES, AND OTHER TEMPORARY TRAFFIC SIGNAL EQUIPMENT WITH THE ENGINEER TO PREVENT CONFLICTS WITH CONSTRUCTION STAGING AND OVERHEAD UTILITIES.

TEMPORARY TRAFFIC SIGNAL CONSTRUCTION NOTES

- T1. THE CONTRACTOR SHALL PROVIDE AND INSTALL EQUIPMENT WITH RESPECT TO THE TEMPORARY TRAFFIC SIGNAL INSTALLATION. THIS SHALL INCLUDE ALL CABLES, SIGNAL HEADS, CONDUIT, WOOD POLES, GUY WIRE ASSEMBLIES, ELECTRICAL SERVICE, AND ALL OTHER EQUIPMENT REQUIRED FOR THE INSTALLATION.
- T2. THE EXISTING CONTROLLERS ARE NEMA TS-2, FULL ACTUATED, MICROPROCESSOR BASED CONTROLLER THAT ARE CAPABLE OF SUPPLYING 225 SECONDS OF CYCLE LENGTH AND INDIVIDUAL PHASE LENGTH SETTINGS UP TO 99 SECONDS.
- T3. ALL TRAFFIC SIGNAL EQUIPMENT SCHEDULED FOR REMOVAL MAY BE USED FOR TEMPORARY TRAFFIC SIGNALS. ANY MAINTENANCE OF THIS EQUIPMENT WHEN USED FOR TEMPORARY TRAFFIC SIGNALS SHALL BE THE RESPONSIBILITY OF THE CONTRACTOR. ALL EQUIPMENT SHALL BE DELIVERED IN GOOD WORKING CONDITION UPON REMOVAL OF THE TEMPORARY TRAFFIC SIGNAL INSTALLATION.
- T4. NEW AERIAL TRAFFIC SIGNAL CABLE SHALL BE FURNISHED AND INSTALLED AS SHOWN ON THE PLAN SHEETS. ALL EXISTING TRAFFIC SIGNAL CABLE WILL BE REMOVED. EXISTING TRAFFIC SIGNAL HEADS MAY BE USED IN THE TEMPORARY INSTALLATION.
- T5. THE TEMPORARY TRAFFIC SIGNAL SPAN WIRES AND CABLES SHALL BE ATTACHED TO THE WOOD POLES IN A MANNER APPROVED BY THE ENGINEER. ALL CABLES SHALL MAINTAIN A 18 FT. MINIMUM CLEARANCE ABOVE THE HIGHEST POINT OF THE ROADWAY.
- T6. ALL TRAFFIC SIGNAL HEAD SECTIONS SHALL HAVE 12" LENSES.
- T7. THE TEMPORARY TRAFFIC SIGNAL HEADS SHALL BE PLACED AS INDICATED ON THE PLANS OR DIRECTED BY THE ENGINEER.
- T8. THE CONTRACTOR SHALL FURNISH ENOUGH SLACK CABLE TO RELOCATE THE HEADS TO ANY POSITION REQUIRED FOR CONSTRUCTION STAGING. THE TEMPORARY TRAFFIC SIGNALS SHALL REMAIN IN OPERATION DURING ALL SIGNAL HEAD RELOCATIONS.
- T9. THE CONTRACTOR SHALL PROVIDE ALL LABOR, EQUIPMENT, AND MATERIALS REQUIRED TO RELOCATE THE TEMPORARY TRAFFIC SIGNAL HEADS IN ACCORDANCE WITH THE PROPOSED CONSTRUCTION STAGING.
- T10. THE TRAFFIC SIGNAL INSTALLATION SHALL CONFORM TO ALL APPLICABLE MUTCD STANDARDS.
- T11. ALL LABOR, MATERIALS, AND EQUIPMENT REQUIRED TO COMPLY WITH THESE REQUIREMENTS SHALL BE INCLUDED IN THE BID PRICE FOR THE TEMPORARY TRAFFIC SIGNAL INSTALLATION.

REVISIONS	
NAME	DATE

ILLINOIS DEPARTMENT OF TRANSPORTATION
TEMPORARY TRAFFIC SIGNALS
 IL 29 & ANN ELIZA
 IL 29 & MARGARET
 SCALE: VERT. _____
 HORIZ. _____
 DATE _____ DRAWN BY _____
 CHECKED BY _____

TRAFFIC SIGNALS
 SHEET 2 OF 6

NOT TO SCALE

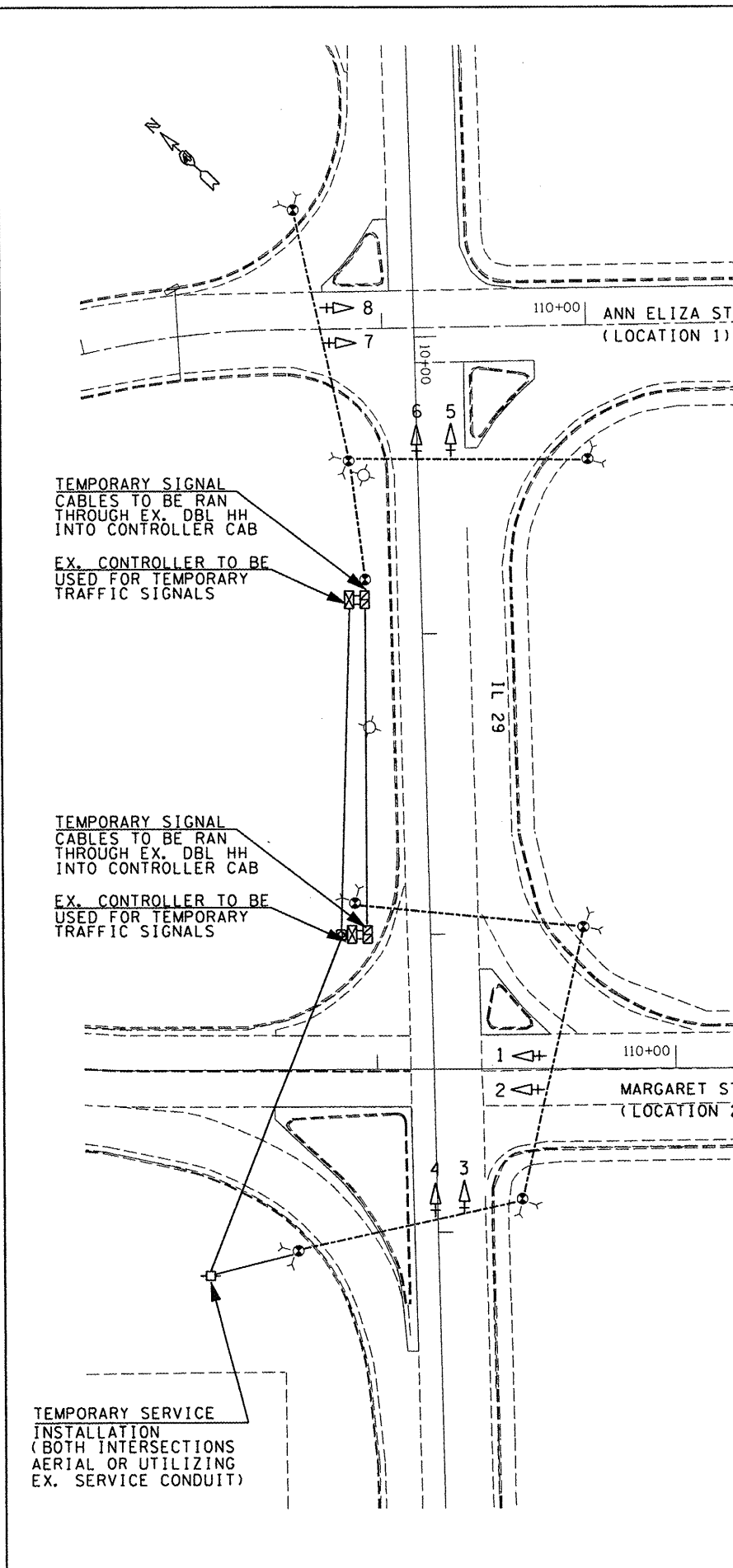
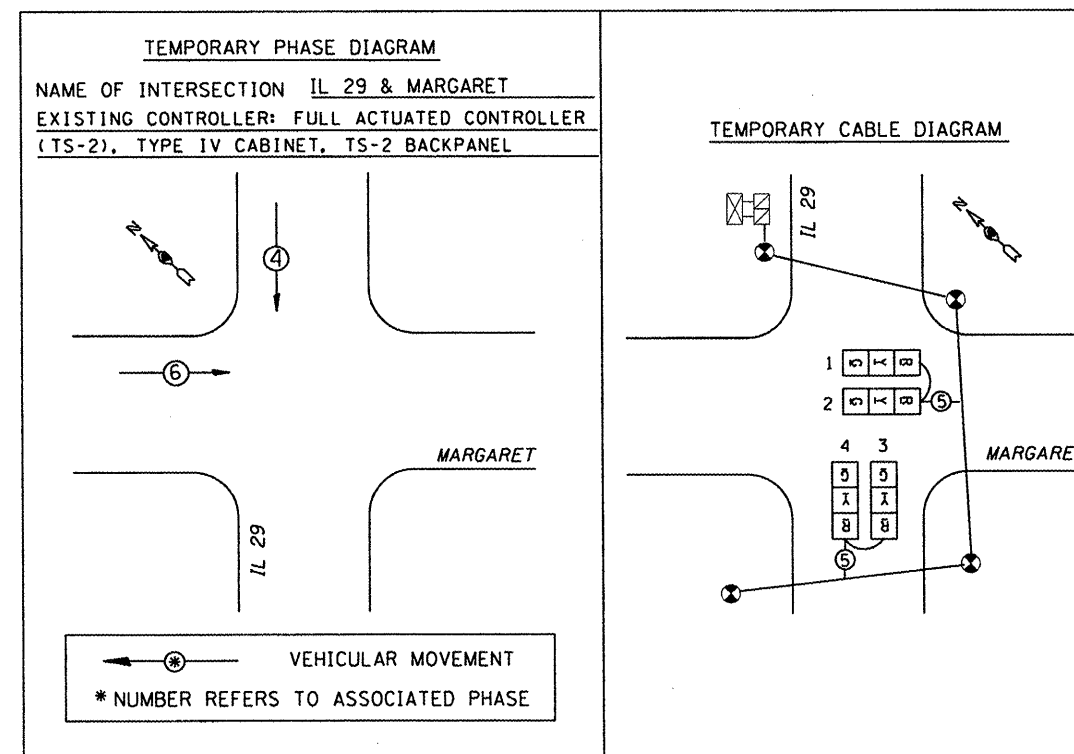
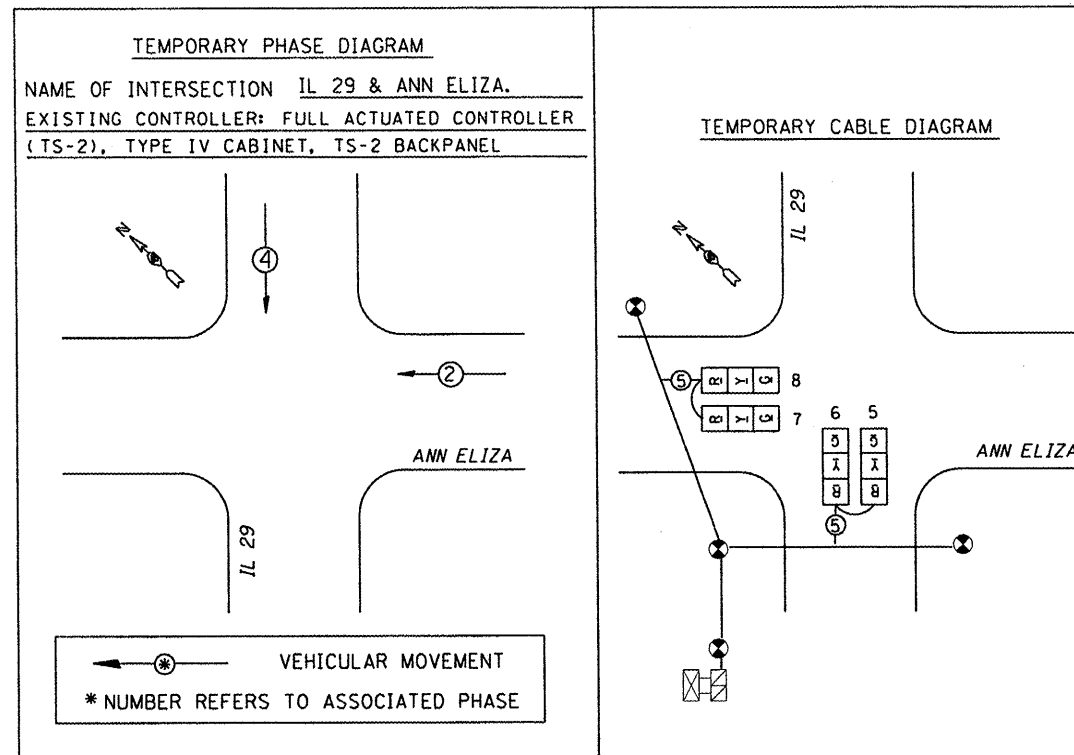

PLOT DATE = 3/28/2008
 FILE NAME = S:\GEN\ORF\TAS\TDBL\PLUS\SD\DR-NEW\Active\Contract\16868\IL 9 Pktn - plan\ldgn
 PLOT SCALE = 1/8"=1'-0"
 USER NAME = bvebsh