

F.A.P. RTE.	SECTION	COUNTY	TOTAL SHEETS	SHEET NO.
669	(10R)RS-6	PEORIA	34	34
STA. 73+50		TO STA. 68+50		
FED. ROAD DIST. NO.		ILLINOIS FED. AID PROJECT		

CONSTRUCTION NOTES

1. THE COST OF REMOVING THE EXISTING ELECTRIC CABLE IN CONDUIT AND DISPOSING OF IT SHALL BE INCLUDED IN THE BID PRICE FOR ELECTRIC CABLE IN CONDUIT, SIGNAL, NO. 14 5/C.
2. THE COST OF REMOVING THE EXISTING PEDESTRIAN PUSH-BUTTONS AND DISPOSING OF THEM SHALL BE INCLUDED IN THE BID PRICE FOR THE PROPOSED PEDESTRIAN PUSH-BUTTONS.

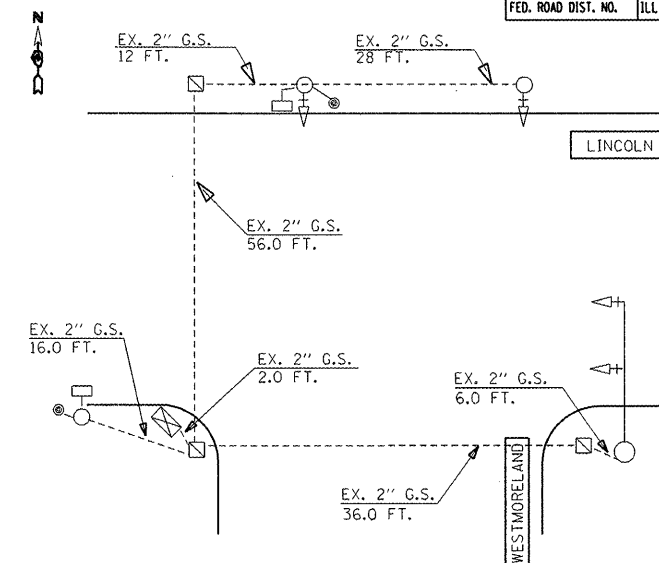

ITEM DESCRIPTION	UNIT	QUANTITY
ELECTRIC CABLE IN CONDUIT, GROUNDING, NO. 6 1C	FEET	193.5
GROUND EXISTING HANDHOLE	EACH	3.0

ITEM DESCRIPTION	UNIT	QUANTITY
RELOCATE EXISTING SIGNAL HEADS, SPECIAL	L SUM	1.0
GROUND EXISTING HANDHOLE	EACH	4.0

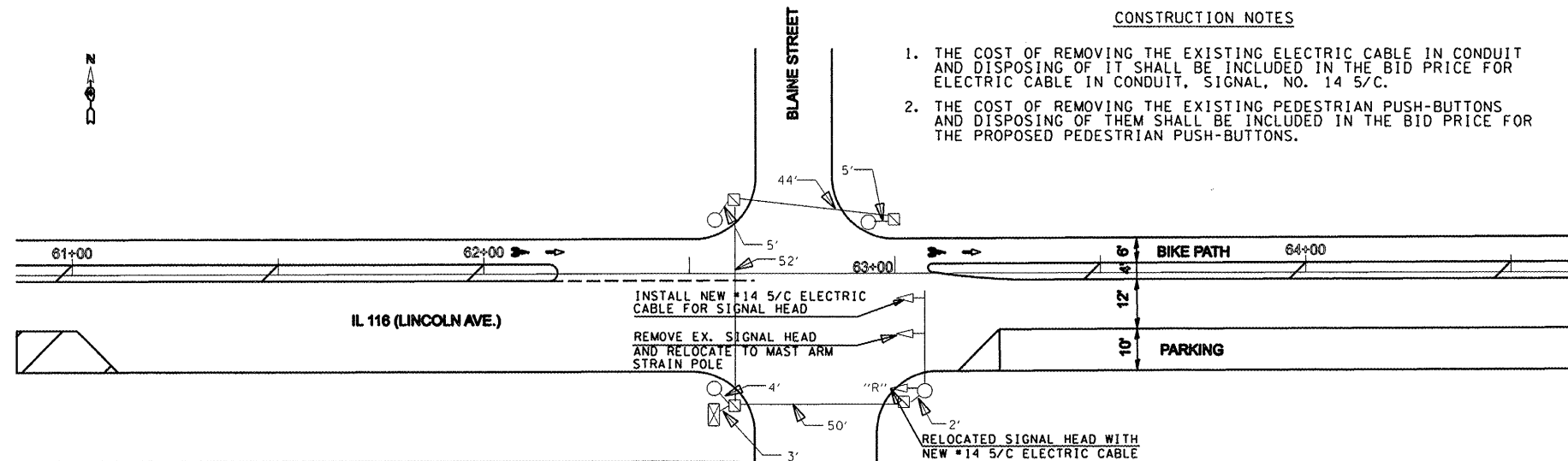

ITEM DESCRIPTION	UNIT	QUANTITY
ELECTRIC CABLE IN CONDUIT, SIGNAL, NO. 14 5C	FOOT	211.0
PEDESTRIAN PUSH-BUTTON	EACH	8.0
RELOCATE EXISTING SIGNAL HEAD	EACH	1.0
GROUND EXISTING HANDHOLE	EACH	4.0
ELECTRIC CABLE IN CONDUIT, GROUNDING, NO. 6 1C	FOOT	209.0

RELOCATE EXISTING SIGNAL HEAD - 1.0 EACH (INCLUDES ALL WORK LISTED BELOW)
 THE CONTRACTOR SHALL PERFORM THE FOLLOWING WORK FOR THIS PAY ITEM:

- RELOCATE THE EXISTING MAST ARM MOUNTED 3-SECTION HEAD (INSIDE HEAD) FOR LINCOLN TO THE MAST ARM STRAIN POLE AND COVER ALL UNUSED MOUNTING HOLES WITH GALVANIZED STEEL PLATES, SEALANT AND EPOXY. THE HOLES SHALL BE SEALED TO PREVENT WATER INTRUSION. THE MATERIAL AND FINISH FOR THE PATCH SHALL MATCH THE EXISTING MAST ARM ASSEMBLY.
- REMOVE THE BACKPLATE FROM THE SIGNAL HEAD AND DISPOSE OF IT FROM THE JOB SITE.
- VERIFY ALL MEASUREMENTS AND FIELD CONDITIONS PRIOR TO COMMENCING WORK.
- PROVIDE AND INSTALL ALL MOUNTING BRACKETS, HARDWARE AND ALL OTHER MATERIALS REQUIRED TO COMPLETE THE WORK AS DESCRIBED ABOVE.

ITEM DESCRIPTION	UNIT	QUANTITY
GROUND EXISTING HANDHOLE	EACH	4.0

ITEM DESCRIPTION	UNIT	QUANTITY
GROUND EXISTING HANDHOLE	EACH	4.0

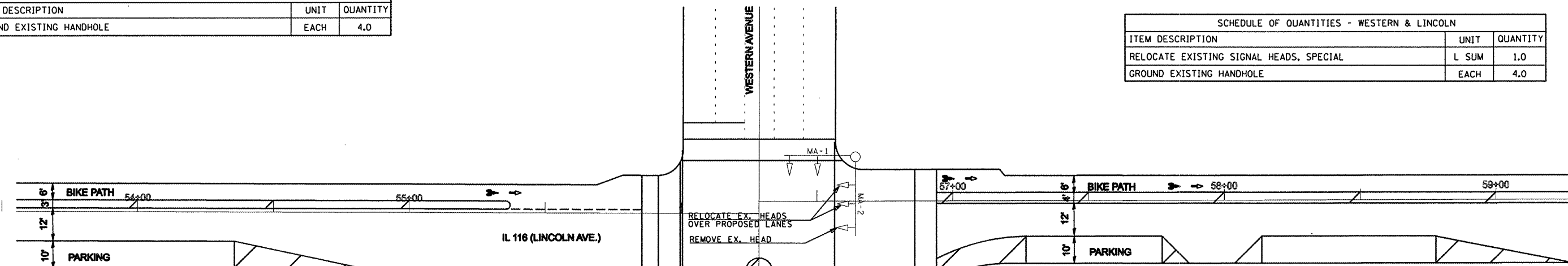

RELOCATE EXISTING SIGNAL HEADS, SPECIAL - 1.0 LSUM
 THE CONTRACTOR SHALL PERFORM THE FOLLOWING WORK FOR THIS PAY ITEM:

- REMOVE THE EXISTING MAST ARM MOUNTED 3-SECTION HEAD (OUTSIDE HEAD) AND DELIVER TO THE CITY OF PEORIA DRIES LANE FACILITY.
- RELOCATE THE TWO EXISTING 3-SECTION MAST ARM MOUNTED SIGNALS HEADS EASTBOUND IL 116 (LINCOLN AVE.) AND RELOCATE THEM OVER THE PROPOSED LANES (LEFT TURN/THRU LANE AND BICYCLE LANE). THE CONTRACTOR SHALL REUSE THE EXISTING BRACKETING AND PROVIDE ALL NEW HARDWARE AS REQUIRED TO FACILITATE INSTALLATION. IN THE EVENT THAT THE BRACKETING CAN NOT BE REUSED, THE CONTRACTOR SHALL PROVIDE NEW BRACKETS AT NO ADDITIONAL COST.
- INSTALL NEW 5/C #14 WIRE JUMPERS BETWEEN THE TWO INSIDE MAST ARM MOUNTED SIGNAL HEADS
- COVER ALL UNUSED MOUNTING HOLES IN THE MAST ARM UTILIZING A GALVANIZED STEEL PLATE, SEALANT AND EPOXY. THE HOLES SHALL BE SEALED TO PREVENT WATER INTRUSION. THE MATERIAL AND FINISH FOR THE PATCH SHALL MATCH THE EXISTING MAST ARM ASSEMBLY AND POLE.
- VERIFY ALL MEASUREMENTS AND FIELD CONDITIONS PRIOR TO COMMENCING WORK.
- PROVIDE AND INSTALL ALL MOUNTING BRACKETS, HARDWARE, AND ANY OTHER MATERIALS REQUIRED TO COMPLETE THE WORK AS DESCRIBED ABOVE.

TRAFFIC SIGNAL LEGEND

- EX. HANDHOLE
- EX. CONDUIT
- EX. CONTROLLER CABINET
- EX. SIGNAL HEAD
- EX. PEDESTRIAN SIGNAL HEAD
- EX. SIGNAL POST
- EX. STEEL MAST ARM
- PROP. SIGNAL HEAD

NAME	DATE

ILLINOIS DEPARTMENT OF TRANSPORTATION
 TRAFFIC SIGNAL DETAILS
 WESTERN & LINCOLN
 WESTERN & HOWETT
 LINCOLN & WESTMORELAND
 LINCOLN & BLAINE

SCALE: VERT. _____
 HORIZ. _____
 DATE _____

DRAWN BY _____
 CHECKED BY _____

PLOT DATE = 3/28/2008
 FILE NAME = c:\projects\68797\peoria\116 lincoln_howett\lincoln_howett.dgn
 PLOT SCALE = 48,0000 / 1"
 USER NAME = bnguyen