

PROJECT ENGINEER RICH DOTSON 309-671-3455

DESIGNER CHRISTOPHER MAUSHARD 309-671-3464

INDEX OF SHEETS

- 1 COVER SHEET
- 2 COMMITMENTS/GENERAL NOTES
- 3 SUMMARY OF QUANTITIES
- 4 TYPICAL SECTIONS
- 5 SCHEDULE OF QUANTITIES
- 6-10 PLAN SHEETS
- 11-13 PAVEMENT MARKING SHEETS
- 14-16 DISTRICT CADD STANDARDS
HIGHWAY STANDARDS

HIGHWAY STANDARDS

- 000001-05
- 701602-03
- 701701-05
- 701901
- 780001-01
- 781001-02
- 886001

DESIGN DESIGNATION

IL 40 (KNOXVILLE)

OTHER PRINCIPLE ARTERIAL
 ADT = 27,410 YEAR 2003
 PV = 25,957 (94.7 %)
 SU = 795 (2.9 %)
 MU = 658 (2.4 %)

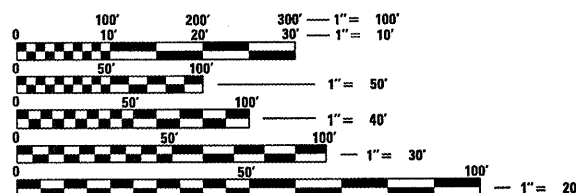

FULL SIZE PLANS HAVE BEEN PREPARED USING STANDARD ENGINEERING SCALES. REDUCED SIZED PLANS WILL NOT CONFORM TO STANDARD SCALES. IN MAKING MEASUREMENTS ON REDUCED PLANS, THE ABOVE SCALES MAY BE USED.

J.U.L.I.E.
 JOINT UTILITY LOCATION INFORMATION FOR EXCAVATION
 1-800-892-0123
 OR 811

CONTRACT NO. 68821
 CATALOG NO. 033824-00D

STATE OF ILLINOIS
 DEPARTMENT OF TRANSPORTATION
 DIVISION OF HIGHWAYS
**PROPOSED
 HIGHWAY PLANS**

ROUTE FAP 646 (IL 40)
 SECTION 126RS-7

PEORIA COUNTY
 C-94-079-08

R 7 E

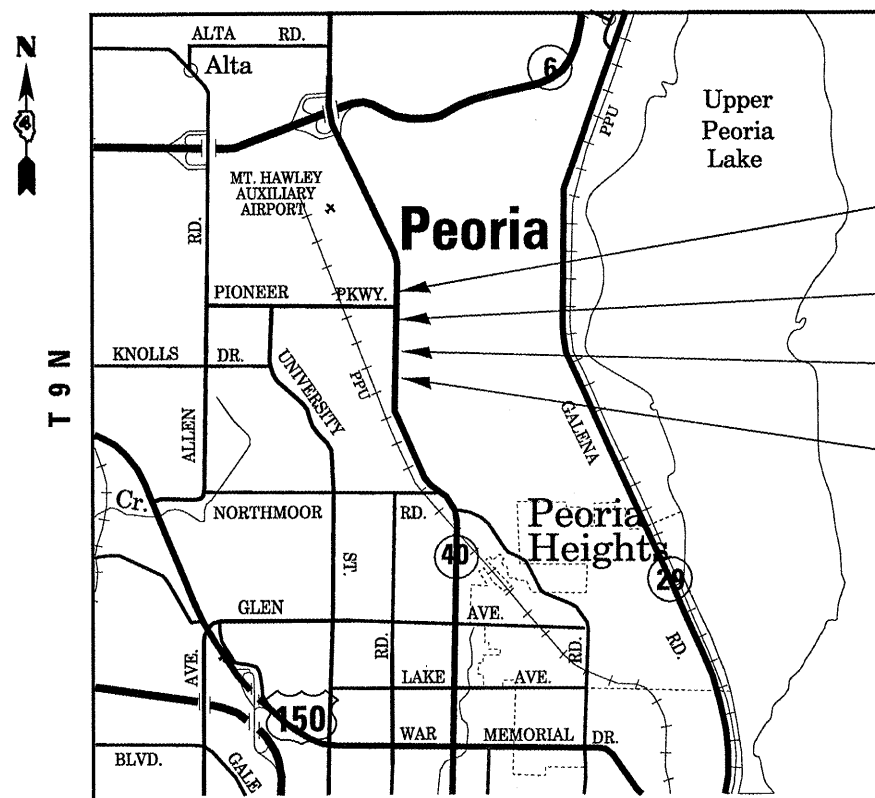

3rd P.M.

PROJECT BEGINS
 STA. 36+80
 IL 40 AT
 PIONEER PARKWAY

PROJECT BEGINS
 STA. 67+00
 IL 40 AT
 BETHANY WAY

PROJECT ENDS
 STA. 77+75

F.A.P. RTE.	SECTION	COUNTY	TOTAL SHEETS	SHEET NO.
646	126RS-7	PEORIA	16	1
FED. ROAD DIST. NO. 4	ILLINOIS	CONTRACT NO. 68821		

D-94-059-08

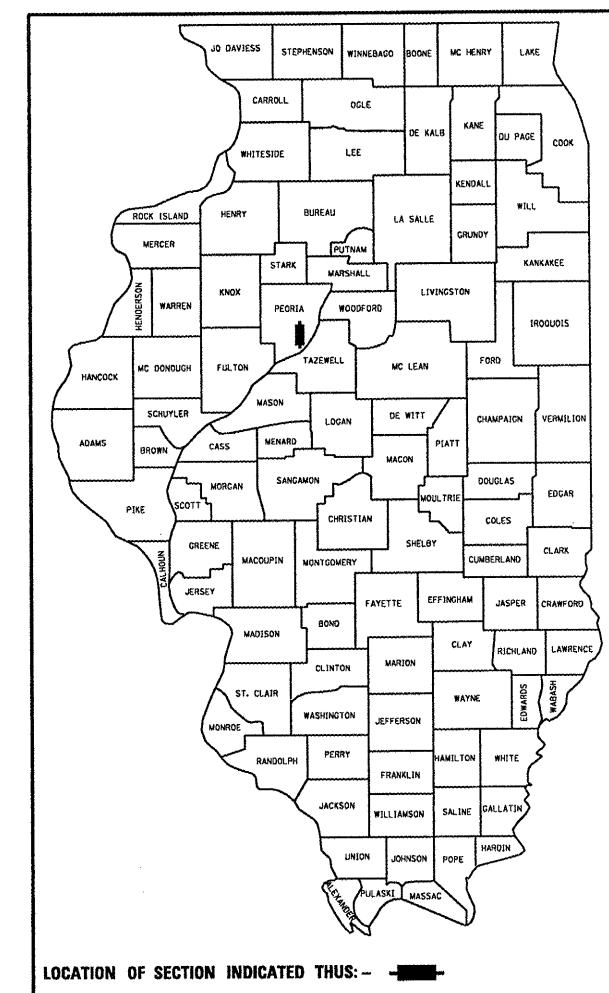

LOCATION OF SECTION INDICATED THUS: —

STATE OF ILLINOIS
 DEPARTMENT OF TRANSPORTATION
 DIVISION OF HIGHWAYS

SUBMITTED *May 9, 2008*

May 9, 2008
 DEPUTY DIRECTOR OF HIGHWAYS, REGION ENGINEER

Chris E. Hamm
 ENGINEER OF DESIGN AND ENVIRONMENT

May 9, 2008
Christine M. Reed
 DIRECTOR OF HIGHWAYS, CHIEF ENGINEER

PRINTED BY THE AUTHORITY
 OF THE STATE OF ILLINOIS

COMMITMENTS

Commitments are not to be altered without the written approval of all parties to which the commitment was made.

NO COMMITMENTS HAVE BEEN MADE FOR THIS PROJECT.

GENERAL NOTES

UTILITIES – LOCATIONS /INFORMATION ON PLANS

The locations of existing water mains, gas mains, sewers, electric power lines, telephone lines and other utilities as shown on the plans are based on careful field investigation and the best information available, but they are not guaranteed. Unless elevations are shown — all utility locations shown on the cross sections are based on the approximate depth supplied by the utility company. It shall be the Contractor's responsibility to ascertain their exact location from the utility companies and by field inspection.

PROPERTY OWNER ACCESS REQUIREMENTS

Access must be maintained to all existing properties during construction per Article 107.09 unless arrangements are made in writing by the Contractor with the property owners with a copy to the Engineer for short-term closures.

WINTER SHUTDOWN RESTRICTIONS ON COLD MILLED PROJECTS

Prior to winter shutdown the following steps shall be taken:

- * All cold milled surfaces shall be overlaid.
- * All lanes shall be reopened to traffic.
- * Manholes, where applicable, shall be adjusted to the elevation of the binder course/leveling binder to ease in plowing snow, and re-adjusted to finished grade in the Spring. The initial manhole adjustment will be paid for at the contract unit price and any re-adjustment, as directed by the Engineer, will be paid for in accordance with Article 109.04.
- * Temporary or permanent pavement marking shall be placed as applicable.

ENVIRONMENTAL REVIEWS

Prior to the use of any proposed borrow areas, use areas (temporary access roads, detours, run-arounds, etc.) and/or waste areas, the Contractor shall file the required environmental resource request surveys according to Section 107.22 of the Standard Specifications. These surveys are required in order for the Department to conduct cultural and biological resource surveys for the proposed site.

Prior to any waste materials being removed from the construction site the required environmental resource surveys will need to be obtained and filed by the Contractor. Excess waste products removed from the construction site shall be disposed of as required in Section 202.03 of the Standard Specifications.

Any protruding metal bars shall be removed prior to the disposal of broken concrete at approved disposal sites.

The required environmental resource documentation shall include the following:

- * BDE Form 2289 (Environmental Survey Request)
- * A location map showing the size limits and location of the use area
- * Signed property owner agreement form-D4 P10100
- * Color photographs depicting the use area
- * Borrow Area Entry Agreement form-D4 P10101

Please note that a minimum of two weeks shall be allowed for the District to obtain the required environmental clearances.

PAVEMENT STATIONING NUMBERS & PLACEMENT

The Contractor shall provide labor and materials required to imprint pavement station numbers in the finished surface of the pavement and/or overlay. The numbers shall be approximately 3/4 inch (20mm) wide, 5 inches (125 mm) high and 5/8 inch (15 mm) deep.

The pavement station numbers shall be installed as specified herein:

Interval – 200 feet (English stationing) or 100 meters (metric stationing)

Bottom of Numbers – 6 inches (150 mm) from the inside edge of the pavement marking

Location:

- * 2,3, & 5 Lane Pavements – right edge of pavement in direction of increasing stations
- * Multi-Lane Divided Roadways – outside edge of pavement in both directions
- * Ramps – along baseline edge of pavement

Position – stations shall be placed so they can be read from the adjacent shoulder

Format – English (Metric) pavement stations shall use this format "XXX (XX + X00)" where X represents the pavement station

This work will not be paid for separately, but will be considered included in the cost of the associated pavement and/or overlay pay items.

HOT-MIX ASPHALT MIXTURE REQUIREMENTS

Mixture Use(s):	HMA SURFACE COURSE	INCIDENTAL HMA SURFACE
AC/PC:	SBS OR SBR PG 76-22	PG 64-22
RAP % (Max)**:	10%	15%
Design Air Voids:	4.0% @ N=70	4.0% @ N=50
Mixture Composition: (Gradation Mixture)	IL 9.5 OR IL 12.5	IL 9.5 OR IL 12.5
Friction Aggregate	MIXTURE E	MIXTURE D

* Mixture Requirements for Cracks, Joints and Flangeways pay item will be required per Sections 406 and 1030 of the Standard Specifications

** If the RAP option is selected, the asphalt cement grade may need to be adjusted; this will be determined by the Engineer.

BUTT JOINT CUTTING TIME RESTRICTION

Butt joints shall not be milled more than three (3) days prior to placement of the bituminous surface course.

PAVING SURFACE COURSE

Continuous paving operations on the main roadway shall be maintained at all times during the construction of the hot-mix asphalt surface. No interruptions for side roads, entrances, turn lanes, etc. will be allowed.

TAPER REMOVAL @ FRAME & GRATES ADJUSTED BY OTHERS

At locations where frames and grates have previously been adjusted by others and they are surrounded by hot-mix asphalt tapers, the Contractor for this contract shall remove and dispose of the hot-mix asphalt taper material prior to the placement of the hot-mix asphalt surface course. This work will not be paid for separately, but will be considered as included in the cost of the HOT-MIX ASPHALT SURFACE COURSE pay item.

ENGINEERS FIELD OFFICE

Add the following sentence to the end of paragraph 670.02 (i) and 670.04 (e): All of the telephone lines provided shall have unpublished numbers.

TRAFFIC COUNTER LOOP DETECTOR INSTALLATION

The Resident Engineer and/or Contractor shall notify the Traffic Studies Technician in Program Development at least one week prior to the installation to determine exact location.

PROJECT SPECIFIC GENERAL NOTES

DETECTOR LOOPS

THE CONTRACTOR SHALL BE RESPONSIBLE FOR LOCATING EXISTING IDOT ELECTRICAL FACILITIES AT HIS/HER OWN EXPENSE IF REQUIRED PRIOR TO PERFORMING ANY WORK. THE CONTRACTOR SHALL ALSO BE LIABLE FOR ANY DAMAGE TO IDOT FACILITIES RESULTING FROM INACCURATE LOCATING.

MIXTURE FOR CRACKS, JOINTS AND FLANGEWAYS

MIXTURE FOR CRACKS, JOINTS AND FLANGEWAYS TO BE USED TO FILL IN SPALLED, BROKEN OR OPEN CRACK PCC PAVEMENT AFTER THE MILLING OPERATION AND PRIOR TO SURFACE COURSE APPLICATION

FILE NAME = c:\projects\1148\pioneer\1148\tpgs.dgn	USER NAME = maushardce	DESIGNED -	REVISED -	STATE OF ILLINOIS DEPARTMENT OF TRANSPORTATION	COMMITMENTS /GENERAL NOTES	F.A.P. RTE. 646	SECTION 126RS-7	COUNTY PEORIA	TOTAL SHEETS 16	SHEET NO. 2	
PLDT SCALE = 62.8417 ' / IN.	CHECKED -	REVISED -	SCALE:			SHEET NO. OF SHEETS	STA. TO STA.	CONTRACT NO. 68821			
PLDT DATE = 3/18/2008	DATE -	REVISED -									
FED. ROAD DIST. NO. 4 ILLINOIS FED. AID PROJECT											

URBAN 100% STATE

SUMMARY OF QUANTITIES

SUMMARY OF QUANTITIES

SUMMARY OF QUANTITIES			CONSTRUCTION TYPE CODE		SUMMARY OF QUANTITIES			CONSTRUCTION TYPE CODE	
CODE NO	ITEM	UNIT	TOTAL QUANTITIES	ROADWAY 1000	CODE NO	ITEM	UNIT	TOTAL QUANTITIES	
40600215	POLYMERIZED BITUMINOUS MATERIALS (PRIME COAT)	TON	9.2	9.2					
40600400	MIXTURE FOR CRACKS, JOINTS, AND FLANGEWAYS	TON	14	14					
40600990	TEMPORARY RAMP	SO YD	258	258					
40603565	POLYMERIZED <i>HOT-MIX ASPHALT</i> SURFACE COURSE, MIX "E", N70	TON	2542	2542					
40800030	AGGREGATE (PRIME COAT)	TON	46	46					
40800050	INCIDENTAL <i>HOT-MIX ASPHALT</i> SURFACING	TON	33	33					
44000157	<i>HOT-MIX ASPHALT</i> SURFACE REMOVAL, 2"	SO YD	22,985	22,985					
67000400	ENGINEER'S FIELD OFFICE, TYPE A	CAL MO	2	2					
67100100	MOBILIZATION	L SUM	1	1					
70102632	TRAFFIC CONTROL AND PROTECTION, <i>STANDARD</i> 701602	L SUM	1	1					
70102635	TRAFFIC CONTROL AND PROTECTION, <i>STANDARD</i> 701701	L SUM	1	1					
70300100	SHORT-TERM PAVEMENT MARKING	FOOT	1956	1956					
70300220	TEMPORARY PAVEMENT MARKING - LINE 4"	FOOT	14,181	14,181					
70300240	TEMPORARY PAVEMENT MARKING - LINE 6"	FOOT	1356	1356					
70300250	TEMPORARY PAVEMENT MARKING - LINE 8"	FOOT	1713	1713					
70300260	TEMPORARY PAVEMENT MARKING - LINE 12"	FOOT	913	913					
70300280	TEMPORARY PAVEMENT MARKING - LINE 24"	FOOT	162	162					
70300610	TEMPORARY PAINT PAVEMENT MARKING, <i>LETTERS AND SYMBOLS</i>	SO FT	167.2	167.2					
70301000	WORK ZONE PAVEMENT MARKING REMOVAL <i>LETTERS AND SYMBOLS</i>	SO FT	325	325					
* 78000100	THERMOPLASTIC PAVEMENT MARKING - <i>LETTERS AND SYMBOLS</i>	SO FT	167.2	167.2					
* 78000200	THERMOPLASTIC PAVEMENT MARKING - LINE 4"	FOOT	14,181	14,181					
* 78000500	THERMOPLASTIC PAVEMENT MARKING - LINE 8"	FOOT	1713	1713					
* 78000600	THERMOPLASTIC PAVEMENT MARKING - LINE 12"	FOOT	913	913					
* 78000650	THERMOPLASTIC PAVEMENT MARKING - LINE 24"	FOOT	162	162					
* 78003130	PREFORMED PLASTIC PAVEMENT MARKING, TYPE B - LINE 6"	FOOT	1356	1356					
* 78100100	RAISED REFLECTIVE PAVEMENT MARKER	EACH	215	215					
* 78200300	PRISMATIC CURB REFLECTOR	EACH	49	49					
78300200	RAISED REFLECTIVE PAVEMENT MARKER REMOVAL	EACH	170	170					
88600100	DETECTOR LOOP, TYPE I	FOOT	414	414					
X7015005	CHANGEABLE MESSAGE SIGN	CAL DA	90	90					

* SPECIALTY ITEM

FILE NAME = c:\projects\1148\pioneer\1148\typo.dgn	USER NAME = mausherdee	DESIGNED -	REVISED -	STATE OF ILLINOIS DEPARTMENT OF TRANSPORTATION	SUMMARY OF QUANTITIES	F.A.P. RTE.	SECTION	COUNTY	TOTAL SHEETS	SHEET NO.	
		DRAWN -	REVISED -			646	126RS-7	PEORIA	16	3	
		CHECKED -	REVISED -			CONTRACT NO. 68821					
		DATE -	REVISED -			FED. ROAD DIST. NO. 4 ILLINOIS FED. AID PROJECT					
				SCALE: SHEET NO. OF SHEETS STA. TO STA.							

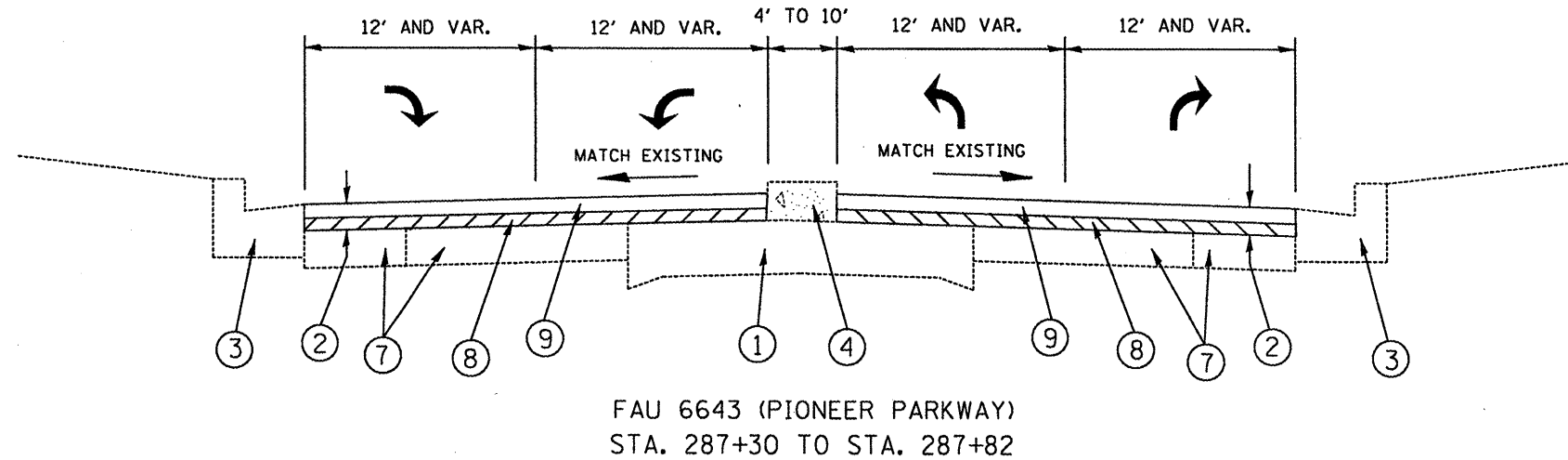
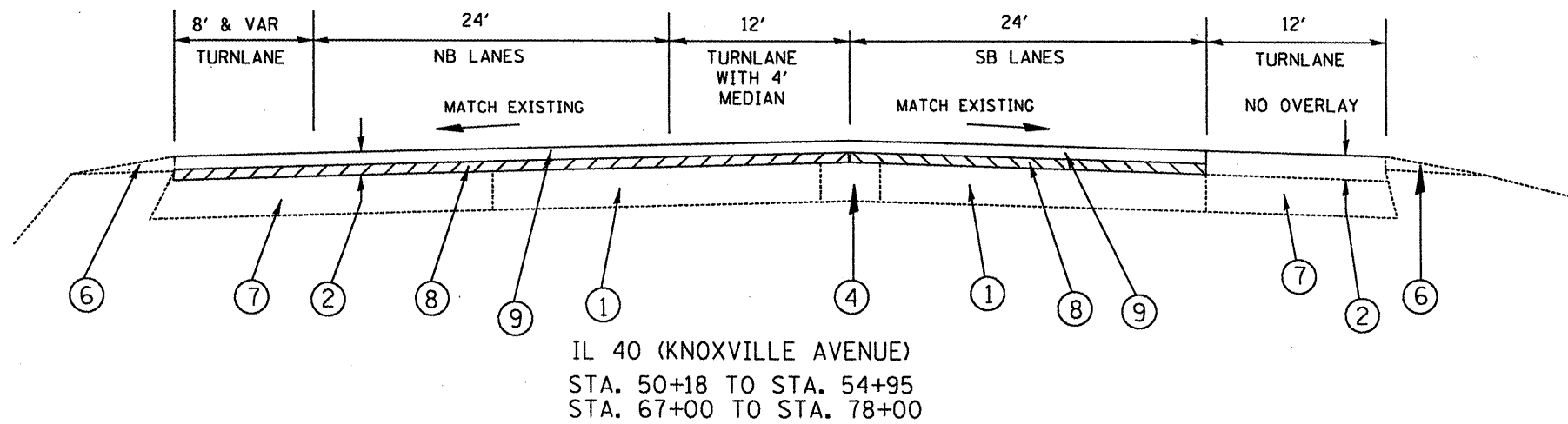
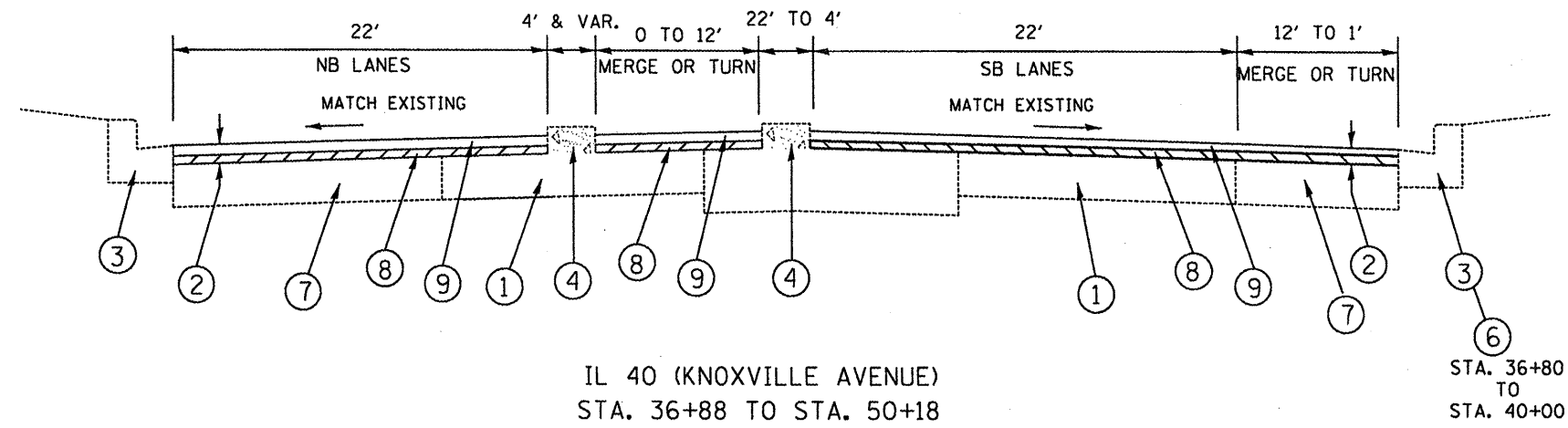

- LEGEND**
- ① EXIST. PCC PAVEMENT
 - ② EXIST. HMA OVERLAY 2"±
 - ③ EXIST. CCC & G
 - ④ EXIST. CONC MEDIAN
 - ⑤ EXIST. HMA SHOULDER
 - ⑥ EXIST. AGG SHOULDER
 - ⑦ EXIST. WIDENING

- ⑧ PROP. HMA SURFACE REMOVAL 2"
- ⑨ PROP. HMA SURFACE CSE 2 "

NOTE

HMA SURFACE REMOVAL SHALL EXTEND TO THE PCC BASE COURSE. NO EXISTING HMA MATERIAL SHALL REMAIN PRIOR TO HMA SURFACE COURSE APPLICATION.

SEE STRIPING PLAN FOR LANE MARKING AND TURNLANE CHANNELIZATION

FILE NAME = c:\projects\1148pioneer\1148typs.dgn	USER NAME = meuhardoc	DESIGNED -	REVISED -	STATE OF ILLINOIS DEPARTMENT OF TRANSPORTATION	IL ROUTE 40 /PIONEER PARKWAY TYPICAL SECTIONS	F.A.P. RTE.	SECTION	COUNTY	TOTAL SHEETS	SHEET NO.	
	PLT SCALE = 62,0417' / IN.	DRAWN -	REVISED -			646	126RS-7	PEORIA	16	4	
	PLT DATE = 3/8/2008	CHECKED -	REVISED -			CONTRACT NO. 68821					
		DATE -	REVISED -			FED. ROAD DIST. NO. 4 ILLINOIS FED. AID PROJECT					
					SCALE: NONE	SHEET NO. OF SHEETS		STA. TO STA.			

TABULATION OF RESURFACING QUANTITIES

LOCATION	TOTAL ROADWAY WIDTH	LENGTH	AREA	TEMP RAMP	HMA SURFACE REMOVAL	BIT MATL'S. PRIME COAT	AGGREGATE MATERIALS PRIME COAT	HMA SURF. CSE.	INCID. HMA SURF.
	FT	FT	SQ YD	SQ YD	SQ YD	TON	TON	2"	2"
IL 40 at Pioneer Parkway									
NB Lanes									
STA. 36+80 TO STA. 38+30	VAR.	150.00	661	21.4	661	0.26	1.3	74.0	
STA. 38+30 TO STA. 47+73	VAR.	943.00	2236		2236	0.89	4.5	250.4	
STA. 47+73 TO STA. 54+95	VAR.	722.00	3311	23.9	3311	1.32	6.6	370.8	
NB Turnlanes									
STA. 38+30 TO STA. 47+73	VAR.	943.00	1449		1449	0.58	2.9	162.3	
STA. 49+60 TO STA. 52+40	VAR.	280.00	170		170	0.07	0.3	19.0	
SB Lanes									
STA. 36+80 TO STA. 38+30	VAR.	150.00	434	13.3	434	0.17	0.9	48.6	
STA. 38+30 TO STA. 47+73	VAR.	943.00	2348		2348	0.94	4.7	263.0	
STA. 47+73 TO STA. 54+95	VAR.	722.00	1966	13.3	1966	0.79	3.9	220.2	
SB Turnlanes									
STA. 38+30 TO STA. 40+80	VAR.	250.00	279		279	0.11	0.6	31.2	
STA. 41+30 TO STA. 49+60	VAR.	830.00	1075		1075	0.43	2.2	120.4	
Pioneer Parkway									
			293	29.2	293	0.12	0.6	32.8	
Entrances									
STA. 42+40 RT (Mt. Hawley Ponte)			24		24	0.01	0.1	2.7	
STA. 47+25 RT (Mt. Hawley Court)			65		65	0.03	0.1	7.3	
STA. 50+25 RT (Methodist Services)			129		129	0.05	0.3	14.4	
STA. 50+25 LT (Mt. Hawley CC)			73		73	0.03	0.1	8.2	
IL 40 at Bethany Way									
NB Lanes									
STA. 67+00 TO STA. 70+40	VAR.	340.00	1097	20.0	1097	0.44	2.2	122.9	
STA. 70+40 TO STA. 73+30	VAR.	290.00	1293	35.9	1293	0.52	2.6	144.8	
STA. 73+30 TO STA. 77+75	VAR.	445.00	2397	20.9	2397	0.96	4.8	268.5	
SB Lanes									
STA. 67+00 TO STA. 70+40	VAR.	340.00	1126	13.2	1126	0.45	2.3	126.1	
STA. 70+40 TO STA. 73+30	VAR.	290.00	1196	53.8	1196	0.48	2.4	134.0	
STA. 73+30 TO STA. 77+75	VAR.	445.00	1363	13.2	1363	0.55	2.7	152.7	
SHEET-TOTAL									
			22,985	258	22,985	9.2	46.0	2,542	33

PRIME COAT CONVERSION FACTORS			BITUMINOUS & AGGREGATE CONVERSION FACTORS		
SURFACE TYPE	BIT. PR. COAT (GAL/SQ YD)	AGG. PR. COAT (LB/SQ YD)	SURFACE TYPE	BIT. SURF. COURSES (1/2 LB /SQ YD/IN)	ALL OTHER BIT. (1/2 LB /SQ YD/IN)
COLD MILLED SURFACES	0.1	4	BIT. SURF. COURSES	1/2 LB /SQ YD/IN	1/2 LB /SQ YD/IN
EXISTING PAVEMENT	0.05	4	AGGREGATE SHOULDERS	2.05 TONS/CYD	
NEW BITUMINOUS COURSES	0.03	2			

PREFORMED PLASTIC - TYPE B, THERMOPLASTIC AND TEMPORARY PAINT PAVEMENT MARKINGS										
LOCATION	LENGTH	PREF. PLASTIC	LINE - 4"	LINE - 4"	*LINE - 4"	LINE - 8"	LINE - 12"	LINE - 12"	LINE - 24"	LETTER & SYMBOLS
		TYPE B - LINE 6"	WHITE	YELLOW	YELLOW	WHITE	WHITE	YELLOW	WHITE	WHITE
PIONEER PARKWAY										
		SKIP DASH	DOUBLE							WHITE
		FOOT	FOOT	FOOT	FOOT	FOOT	FOOT	FOOT	FOOT	SQ.FT.
STA. 36+80 TO STA. 4+00	420	210	767	603	600	163	0	194	0	17.6
STA. 4+00 TO STA. 44+65	365	169	1142	575	102	432	122	15	22	17.6
STA. 44+65 TO STA. 48+50	385	187	1214	530	374	512	99	29	36	17.6
STA. 48+50 TO STA. 54+95	645	322	1053	0	1944	277	0	363	0	44
BETHANY WAY										
STA. 67+00 TO STA. 73+30	630	280	1363	332	1708	191	34	23	52	35.2
STA. 73+30 TO STA. 77+75	445	188	1074	188	612	138	34	0	52	35.2
TOTAL										
		1356	6,613	2,228	5,340	1,713	289	624	162	167.2

The quantity shown represents one application of the Preformed Plastic and Thermoplastic pavement markings.
 The same quantity is required if temporary paint pavement markings are required
 * Line 4" Double Yellow was calculated per the Method Of Measurement described in Article 780.11 (b) of the Standard Specifications

DETECTOR LOOP, TYPE I

LOCATION	FOOT
STA. 40+85 RT	66
STA. 44+80 RT	174
STA. 44+80 TO STA. 45+30 LT	174
TOTAL	414

ENGINEER'S FIELD OFFICE TYPE A

LOCATION	CAL. MD
JOBSITE	2
TOTAL	2

MOBILIZATION

LOCATION	L. SUM
JOBSITE	1
TOTAL	1

MIXTURE FOR CRACKS, JOINTS, AND FLANGEWAYS

LOCATION	TON
IL 40/ PIONEER PARKWAY INT.	14
TOTAL	14

CHANGEABLE MESSAGE SIGN

LOCATION	CAL. DAY
JOBSITE - 2 TOTAL	90
TOTAL	90

RAISED REFLECTIVE PAVEMENT MARKER REMOVAL

LOCATION	EACH
JOBSITE	170
TOTAL	170

PRISMATIC CURB REFLECTOR

LOCATION	EACH
PIONEER PARKWAY	
STA. 38+30 TO STA. 40+80	12
STA. 43+40 TO STA. 47+70	26
BETHANY WAY	
STA. 68+20 TO STA. 70+40	11
TOTAL	49

RAISED REFLECTIVE PAVEMENT MARKERS

LOCATION	1 WAY CRYSTAL	1 WAY AMBER	2 WAY AMBER
	PIONEER PARKWAY		
STA. 36+80 TO STA. 38+30	4	9	0
STA. 38+30 TO STA. 47+73	48	2	0
STA. 47+73 TO STA. 54+95	31	29	4
BETHANY WAY			
STA. 67+00 TO STA. 70+40	12	1	8
STA. 70+40 TO STA. 73+30	15	12	0
STA. 73+30 TO STA. 77+75	20	0	20
TOTAL	130	53	32
			215

SHORT TERM PAVEMENT MARKING

LOCATION - ASSUME 2 APPLICATIONS	FOOT
PIONEER PARKWAY	
STA. 36+80 TO STA. 54+95 NB/SB LANE SKIP DASHE	724
STA. 36+80 TO STA. 38+40 BI-DIRECTIONAL LANE	64
STA. 42+60 TO STA. 44+30 RT TURNLANE	40
STA. 44+75 TO STA. 47+00 RT MERGE LANE	48
STA. 47+75 TO STA. 54+95 BI-DIRECTIONAL LANE	288
BETHANY WAY	
STA. 67+00 TO STA. 77+75 NB/SB LANE SKIP DASHE	432
STA. 67+00 TO STA. 68+25 BI-DIRECTIONAL LANE	48
STA. 70+40 TO STA. 72+60 RT TURNLANE	96
STA. 71+50 TO STA. 72+60 RT TURNLANE	24
STA. 74+00 TO STA. 77+75 BI-DIRECTIONAL LANE	160
STA. 74+00 TO STA. 75+50 RT TURNLANE	32
TOTAL	1,956

WORK ZONE PAVEMENT MARKING REMOVAL

LOCATION	SQ. FT.
PIONEER PARKWAY	
STA. 36+80 TO STA. 54+95 NB/SB LANE SKIP DASHE	120
STA. 36+80 TO STA. 38+40 BI-DIRECTIONAL LANE	11
STA. 42+60 TO STA. 44+30 RT TURNLANE	7
STA. 44+75 TO STA. 47+00 RT MERGE LANE	8
STA. 47+75 TO STA. 54+95 BI-DIRECTIONAL LANE	48
BETHANY WAY	
STA. 67+00 TO STA. 77+75 NB/SB LANE SKIP DASHE	71
STA. 67+00 TO STA. 68+25 BI-DIRECTIONAL LANE	8
STA. 70+40 TO STA. 72+60 RT TURNLANE	16
STA. 71+50 TO STA. 72+60 RT TURNLANE	4
STA. 74+00 TO STA. 77+75 BI-DIRECTIONAL LANE	26
STA. 74+00 TO STA. 75+50 RT TURNLANE	6
TOTAL	325

TRAFFIC CONTROL & PROTECTION, STANDARD 701602

LOCATION	L. SUM
JOBSITE	1
TOTAL	1

TRAFFIC CONTROL & PROTECTION, STANDARD 70101

LOCATION	L. SUM
JOBSITE	1
TOTAL	1

FILE NAME = c:\projects\1140pioneer\1140tups.dgn	USER NAME = moushardce	DESIGNED -	REVISED -
PLDT SCALE = 62.8417' / IN.	PLDT DATE = 3/8/2008	DRAWN -	REVISED -
		CHECKED -	REVISED -
		DATE -	REVISED -

STATE OF ILLINOIS
DEPARTMENT OF TRANSPORTATION

SCHEDULE OF QUANTITIES

SCALE: SHEET NO. OF SHEETS STA. TO STA.

F.A.P. RTE. 646	SECTION 126RS-7	COUNTY PEORIA	TOTAL SHEETS 16	SHEET NO. 5
CONTRACT NO. 68821				
FED. ROAD DIST. NO. 4 ILLINOIS FED. AID PROJECT				

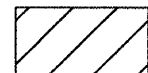
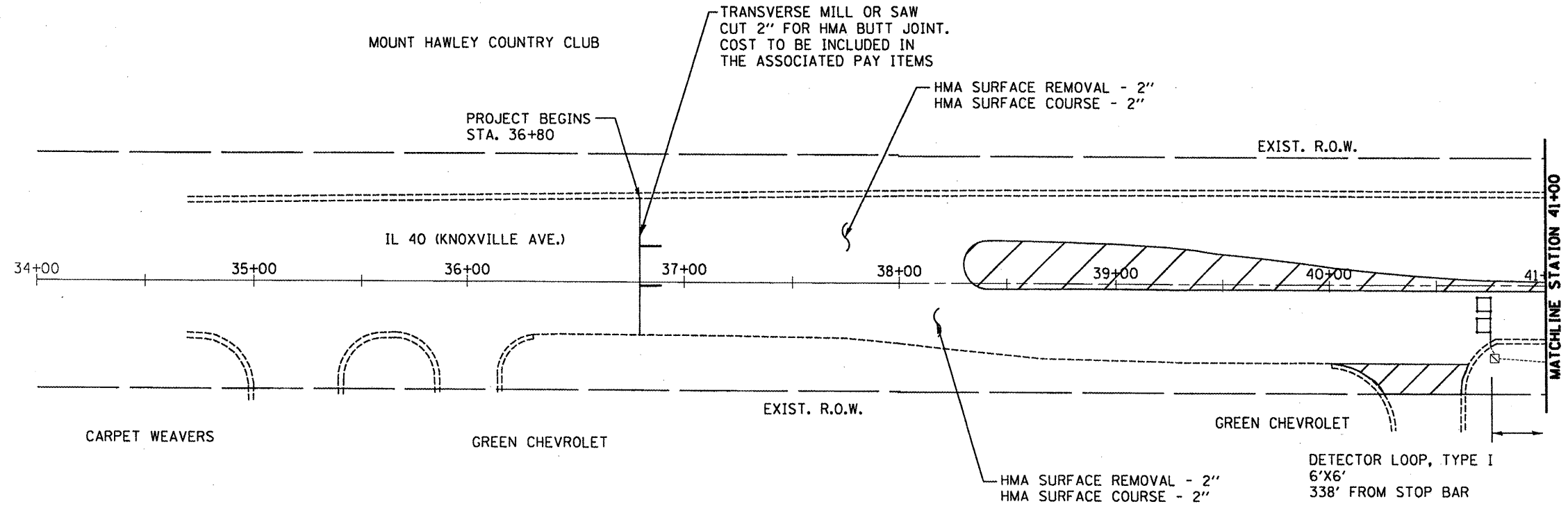

NO IMPROVEMENT

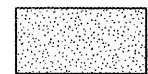

INCIDENTAL BITUMINOUS SURFACING - 2"

HMA SURFACE REMOVAL SHALL EXTEND TO THE PCC BASE COURSE. NO EXISTING HMA MATERIAL SHALL REMAIN PRIOR TO THE HMA SURFACE COURSE APPLICATION

FILE NAME =	USER NAME = meushardae	DESIGNED -	REVISED -
ci:\projects\148pioneer\468821-design.dgn		DRAWN -	REVISED -
PLOT SCALE = 62.0417' / IN.		CHECKED -	REVISED -
PLOT DATE = 3/18/2008		DATE -	REVISED -

**STATE OF ILLINOIS
DEPARTMENT OF TRANSPORTATION**

PLAN VIEW - IL 40/PIONEER PARKWAY

SCALE: NONE SHEET NO. OF SHEETS STA. TO STA.

F.A.P. RTE.	SECTION	COUNTY	TOTAL SHEETS	SHEET NO.
646	126RS-7	PEORIA	16	6
CONTRACT NO. 68821				
FED. ROAD DIST. NO. 4 ILLINOIS FED. AID PROJECT				

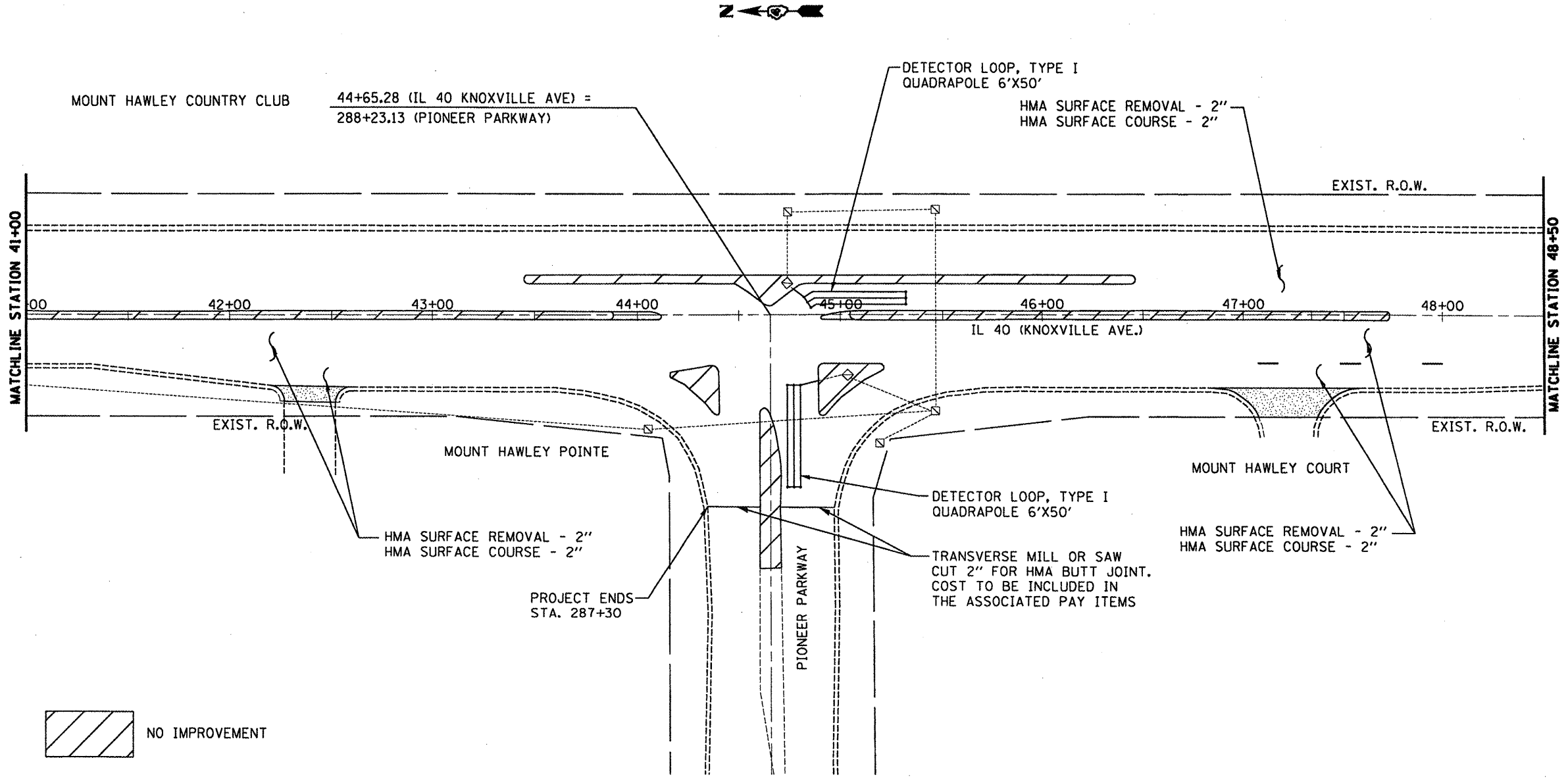

 NO IMPROVEMENT

 INCIDENTAL BITUMINOUS SURFACING - 2"

HMA SURFACE REMOVAL SHALL EXTEND TO THE PCC BASE COURSE. NO EXISTING HMA MATERIAL SHALL REMAIN PRIOR TO THE HMA SURFACE COURSE APPLICATION

FILE NAME =	USER NAME = mauahrdoc	DESIGNED -	REVISED -
c:\projects\1148pioneer\468821-design.dgn		DRAWN -	REVISED -
		CHECKED -	REVISED -
		DATE -	REVISED -

**STATE OF ILLINOIS
DEPARTMENT OF TRANSPORTATION**

PLAN VIEW - IL 40/PIONEER PARKWAY

SCALE: NONE SHEET NO. OF SHEETS STA. TO STA.

F.A.P. RTE.	SECTION	COUNTY	TOTAL SHEETS	SHEET NO.
646	126RS-7	PEORIA	16	7
FED. ROAD DIST. NO. 4 ILLINOIS FED. AID PROJECT			CONTRACT NO. 68821	

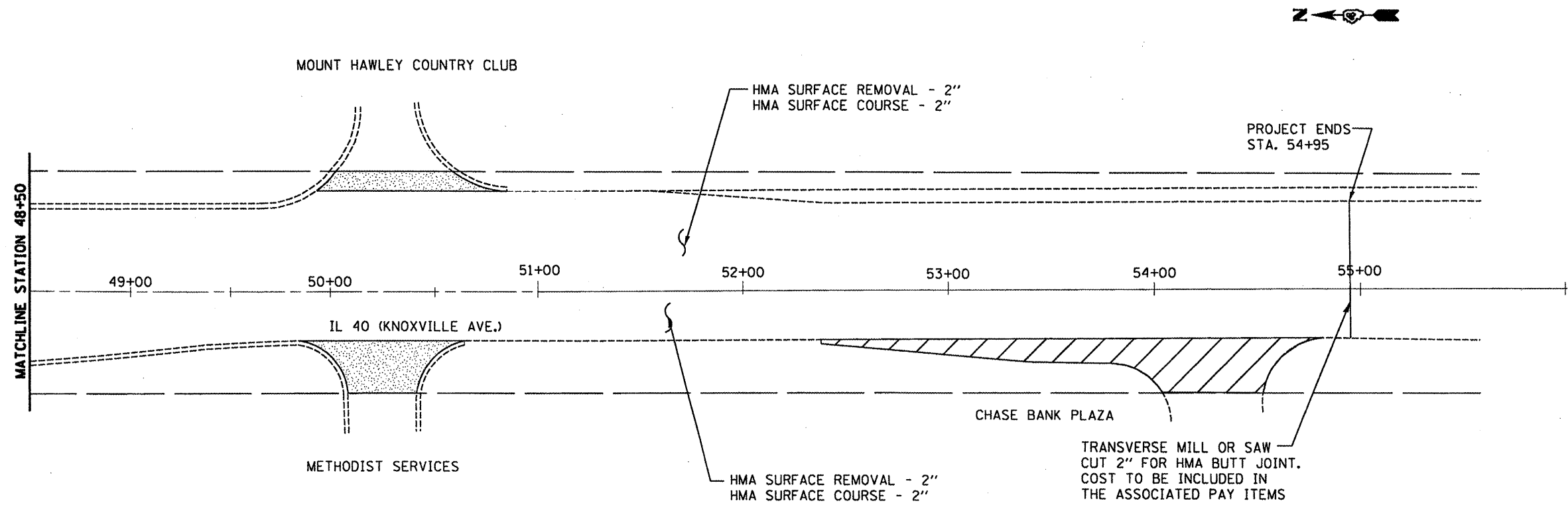

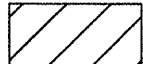
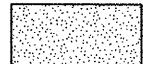
-  NO IMPROVEMENT
-  INCIDENTAL BITUMINOUS SURFACING - 2"

HMA SURFACE REMOVAL SHALL EXTEND TO THE PCC BASE COURSE. NO EXISTING HMA MATERIAL SHALL REMAIN PRIOR TO THE HMA SURFACE COURSE APPLICATION

FILE NAME :	USER NAME :	DESIGNED -	REVISED -
cr:\projects\148\pioneer\1416821-design\plan	meushardae	DRAWN -	REVISED -
		CHECKED -	REVISED -
		DATE -	REVISED -

**STATE OF ILLINOIS
DEPARTMENT OF TRANSPORTATION**

PLAN VIEW - IL 40/PIONEER PARKWAY

SCALE: NONE SHEET NO. OF SHEETS STA. TO STA.

F.A.P. RTE.	SECTION	COUNTY	TOTAL SHEETS	SHEET NO.
646	126RS-7	PEORIA	16	8
FED. ROAD DIST. NO. 4 [ILLINOIS] FED. AID PROJECT			CONTRACT NO. 68821	

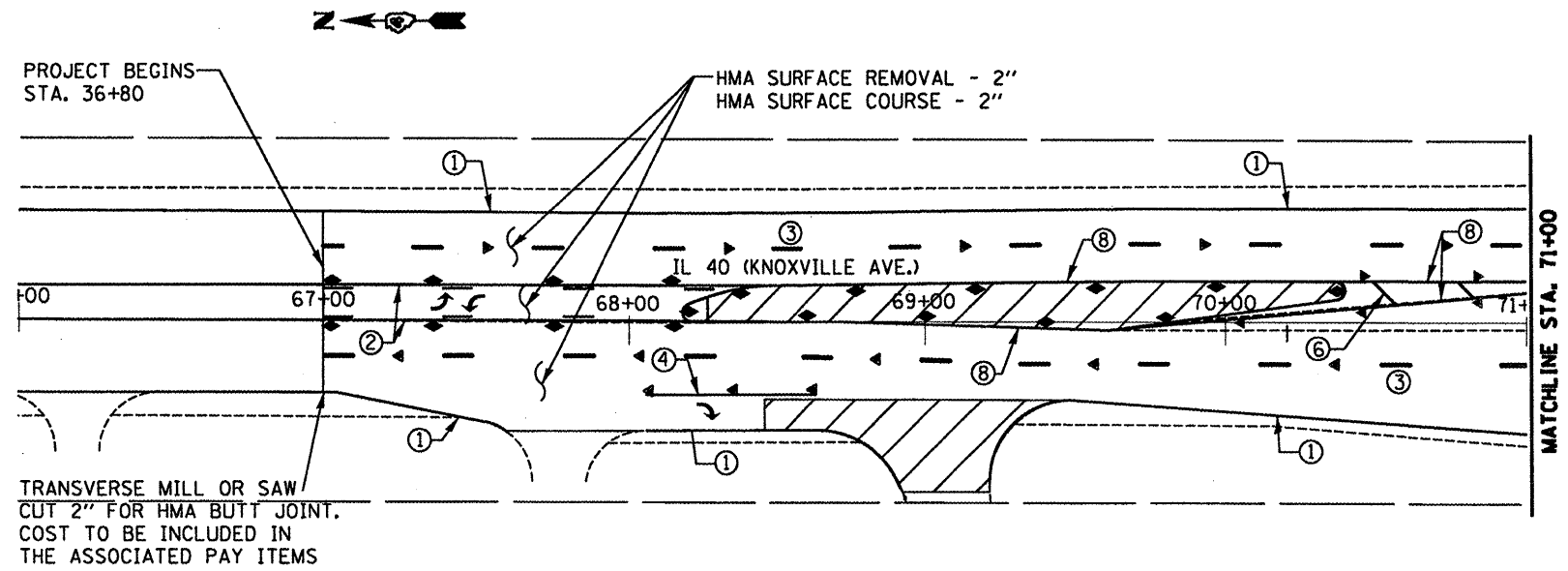

HMA SURFACE REMOVAL SHALL EXTEND TO THE PCC BASE COURSE. NO EXISTING HMA MATERIAL SHALL REMAIN PRIOR TO THE HMA SURFACE COURSE APPLICATION

PAVEMENT MARKING LEGEND

- ① 4" WHITE
- ② 4" YELLOW
- ③ 6" WHITE PREFORMED PLASTIC
- ④ 8" WHITE
- ⑤ 12" WHITE
- ⑥ 12" YELLOW
- ⑦ 24" WHITE
- ⑧ 4" DOUBLE YELLOW

NOTE
FIELD VERIFY PAVEMENT MARKING LOCATIONS PRIOR TO REMOVAL OF THE EXISTING HMA

FILE NAME =	USER NAME = mausherdce	DESIGNED -	REVISED -	STATE OF ILLINOIS DEPARTMENT OF TRANSPORTATION	PLAN VIEW - IL 40 / BETHANY WAY	F.A.P. RTE.	SECTION	COUNTY	TOTAL SHEETS	SHEET NO.	
ci:\projects\1148\pioneer\d468821-design.dgn	PLDT SCALE = 62.8417' / IN.	DRAWN -	REVISED -			646	12GRS-7	PEORIA	16	9	
	PLDT DATE = 3/17/2008	CHECKED -	REVISED -			CONTRACT NO. 68821					
		DATE -	REVISED -			FED. ROAD DIST. NO. 4 ILLINOIS FED. AID PROJECT					
				SCALE: NONE		SHEET NO. OF SHEETS STA. TO STA.					

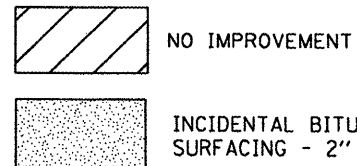
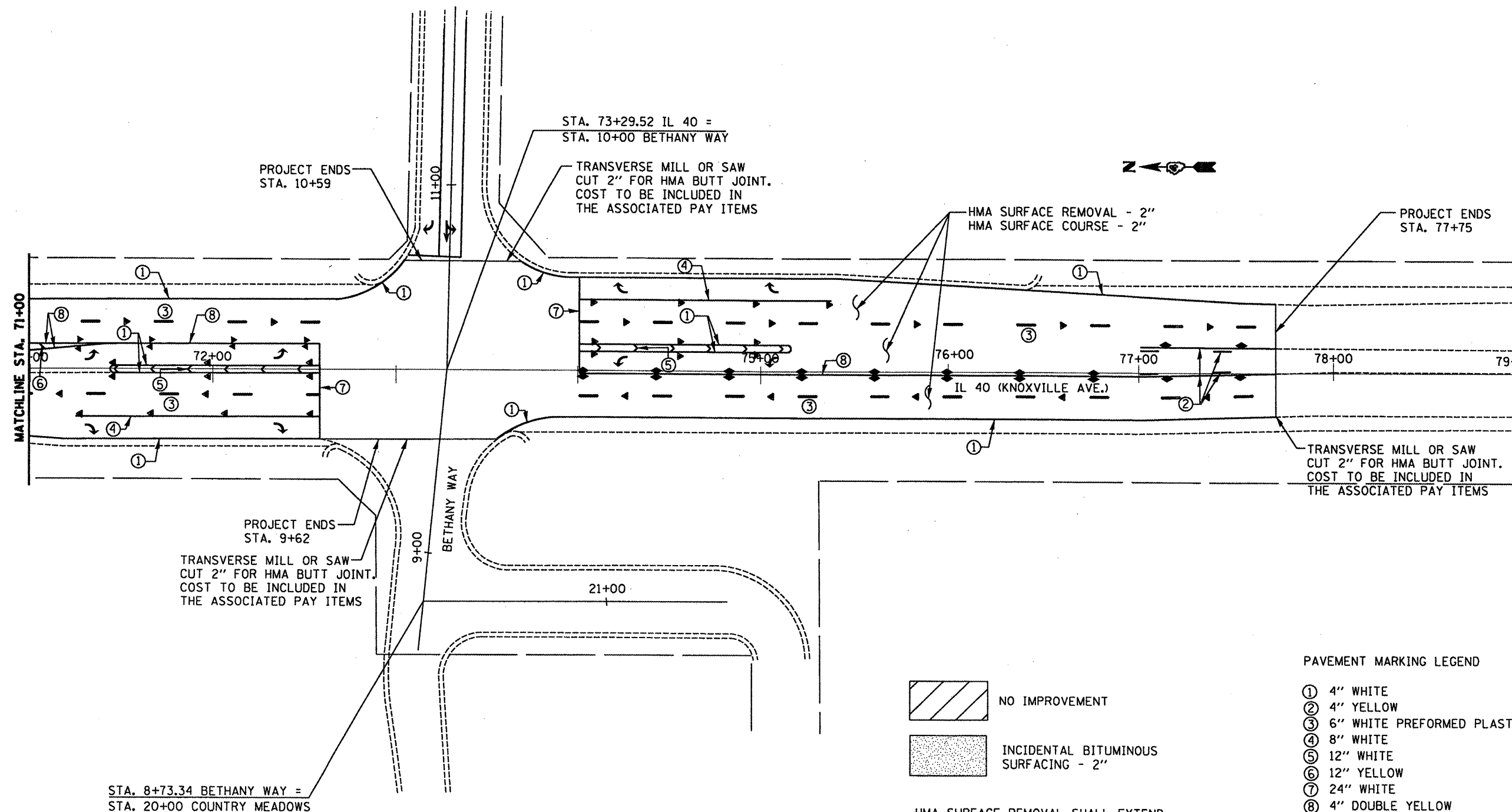

HMA SURFACE REMOVAL SHALL EXTEND TO THE PCC BASE COURSE. NO EXISTING HMA MATERIAL SHALL REMAIN PRIOR TO THE HMA SURFACE COURSE APPLICATION

PAVEMENT MARKING LEGEND

- ① 4" WHITE
- ② 4" YELLOW
- ③ 6" WHITE PREFORMED PLASTIC
- ④ 8" WHITE
- ⑤ 12" WHITE
- ⑥ 12" YELLOW
- ⑦ 24" WHITE
- ⑧ 4" DOUBLE YELLOW

NOTE
FIELD VERIFY PAVEMENT MARKING LOCATIONS PRIOR TO REMOVAL OF THE EXISTING HMA

FILE NAME =	USER NAME = mousherdce	DESIGNED -	REVISED -
c:\projects\148\pioneer\468821-design.dgn		DRAWN -	REVISED -
		CHECKED -	REVISED -
		DATE -	REVISED -

STATE OF ILLINOIS
DEPARTMENT OF TRANSPORTATION

PLAN VIEW - IL 40 / BETHANY WAY

SCALE: NONE SHEET NO. OF SHEETS STA. TO STA.

F.A.P. RTE.	SECTION	COUNTY	TOTAL SHEETS	SHEET NO.
646	126RS-7	PEORIA	16	10
CONTRACT NO. 68821				
FED. ROAD DIST. NO. 4 ILLINOIS FED. AID PROJECT				

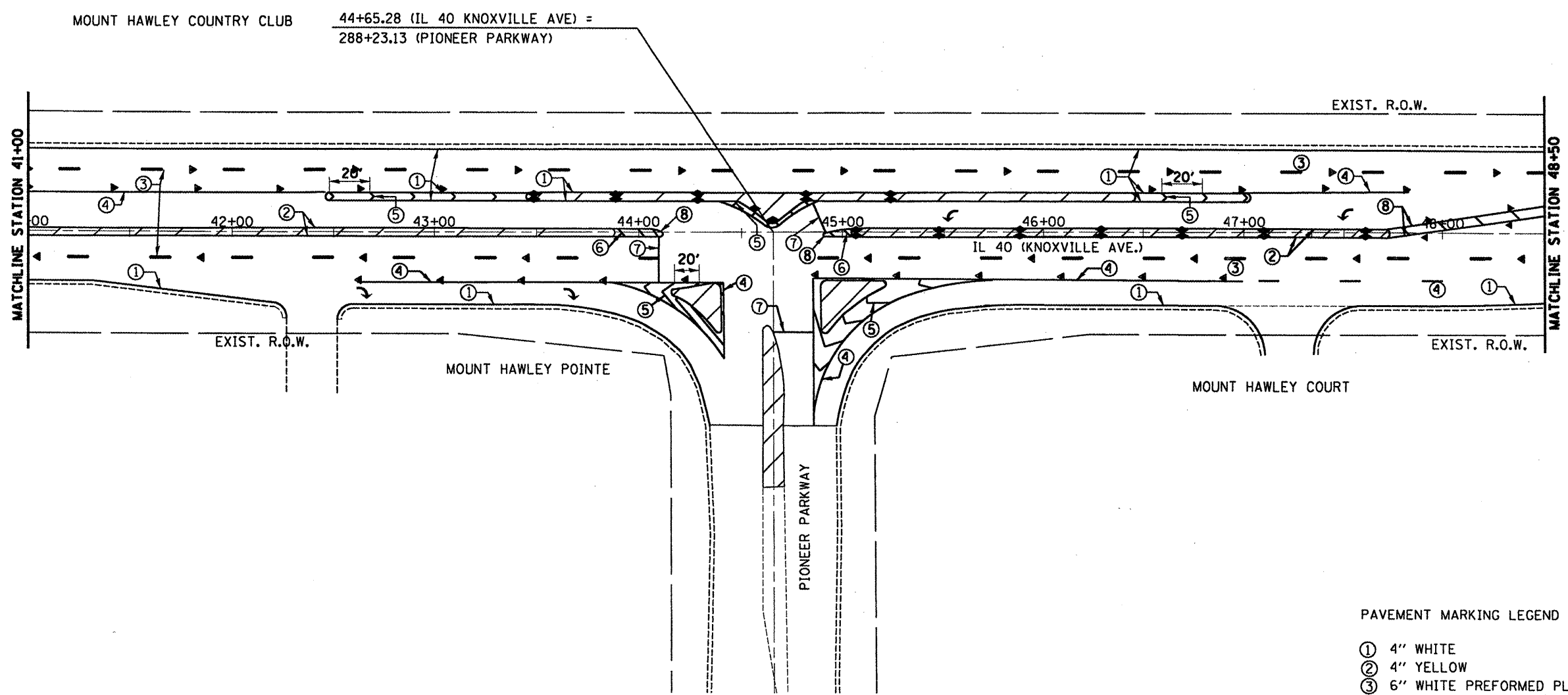

PAVEMENT MARKING LEGEND

- ① 4" WHITE
- ② 4" YELLOW
- ③ 6" WHITE PREFORMED PLASTIC
- ④ 8" WHITE
- ⑤ 12" WHITE
- ⑥ 12" YELLOW
- ⑦ 24" WHITE
- ⑧ 4" DOUBLE YELLOW

NOTE
FIELD VERIFY PAVEMENT MARKING LOCATIONS
PRIOR TO REMOVAL OF THE EXISTING HMA

FILE NAME =	USER NAME = moushardae	DESIGNED -	REVISED -
c:\projects\1140pioneer\468821-design.dgn		DRAWN -	REVISED -
		CHECKED -	REVISED -
		DATE -	REVISED -

STATE OF ILLINOIS
DEPARTMENT OF TRANSPORTATION

PAVEMENT MARKING PLAN - IL 40/PIONEER PARKWAY

SCALE: NONE SHEET NO. OF SHEETS STA. TO STA.

F.A.P. RTE.	SECTION	COUNTY	TOTAL SHEETS	SHEET NO.
646	126RS-7	PEORIA	16	12
FED. ROAD DIST. NO. 4 ILLINOIS FED. AID PROJECT			CONTRACT NO. 68821	

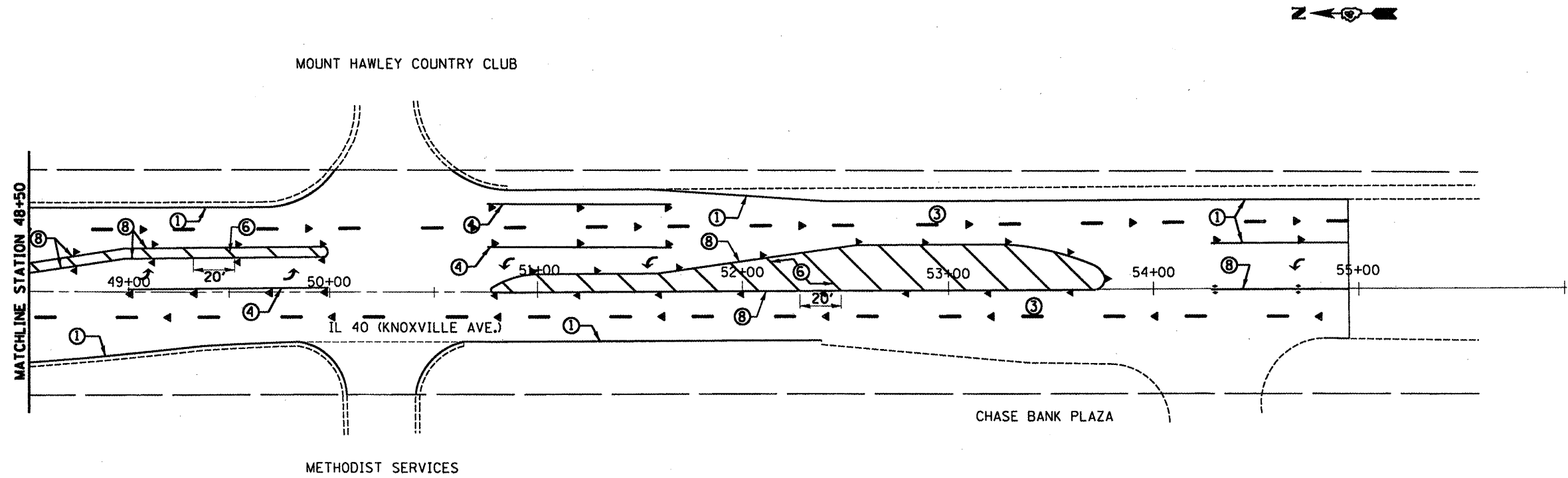

PAVEMENT MARKING LEGEND

- ① 4" WHITE
- ② 4" YELLOW
- ③ 6" WHITE PREFORMED PLASTIC
- ④ 8" WHITE
- ⑤ 12" WHITE
- ⑥ 12" YELLOW
- ⑦ 24" WHITE
- ⑧ 4" DOUBLE YELLOW

NOTE
 FIELD VERIFY PAVEMENT MARKING LOCATIONS
 PRIOR TO REMOVAL OF THE EXISTING HMA

FILE NAME *	USER NAME * meuhardis	DESIGNED -	REVISED -
en\projects\1148pioneer\468821-design\p		DRAWN -	REVISED -
		CHECKED -	REVISED -
		DATE -	REVISED -

**STATE OF ILLINOIS
 DEPARTMENT OF TRANSPORTATION**

PAVEMENT MARKING PLAN - IL 40/PIONEER PARKWAY			
SCALE: NONE	SHEET NO. OF	SHEETS	STA. TO STA.

F.A.P. RTE.	SECTION	COUNTY	TOTAL SHEETS	SHEET NO.
646	126RS-7	PEORIA	16	13
FED. ROAD DIST. NO. 4 (ILLINOIS) FED. AID PROJECT				CONTRACT NO. 68821

F.A.P. RTE.	SECTION	COUNTY	TOTAL SHEETS	SHEET NO.
646	126RS-7	PEORIA	16	14
STA.		TO STA.		
FED. ROAD DIST. NO.		ILLINOIS FED. AID PROJECT		

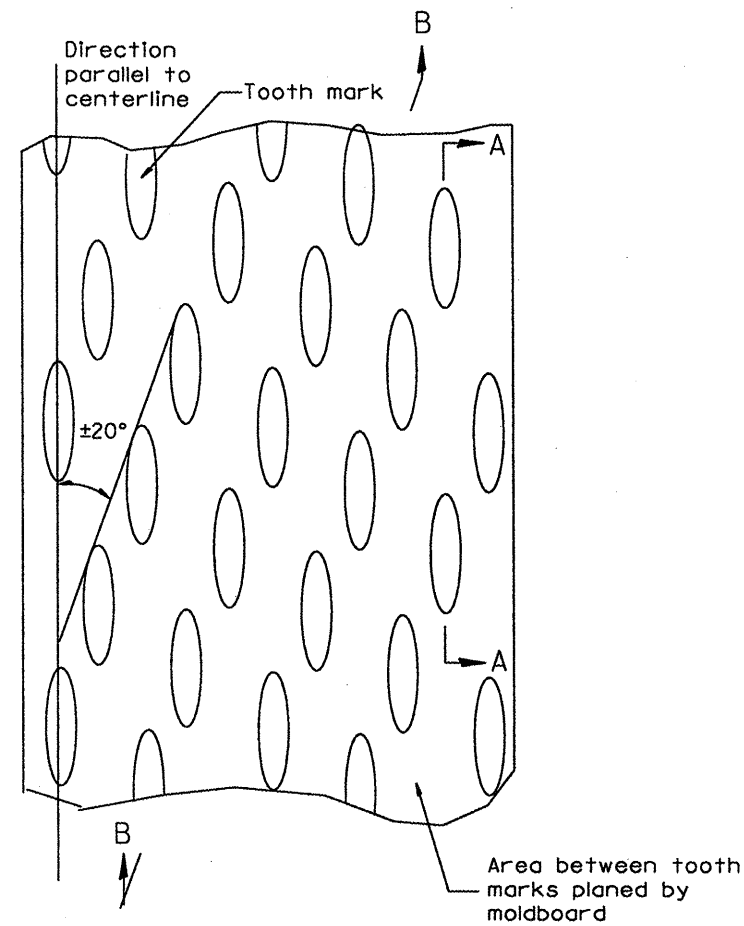

PLAN

General notes:

1. Coldmilling shall consist of two processes: Cutting with carbide teeth mounted on a rotating drum, and planing with a moldboard mounted immediately behind the cutting drum.
2. Other similar patterns will be acceptable if they consist of a smooth, flat, planed surface interspersed with a pattern of discontinuous longitudinal striations.

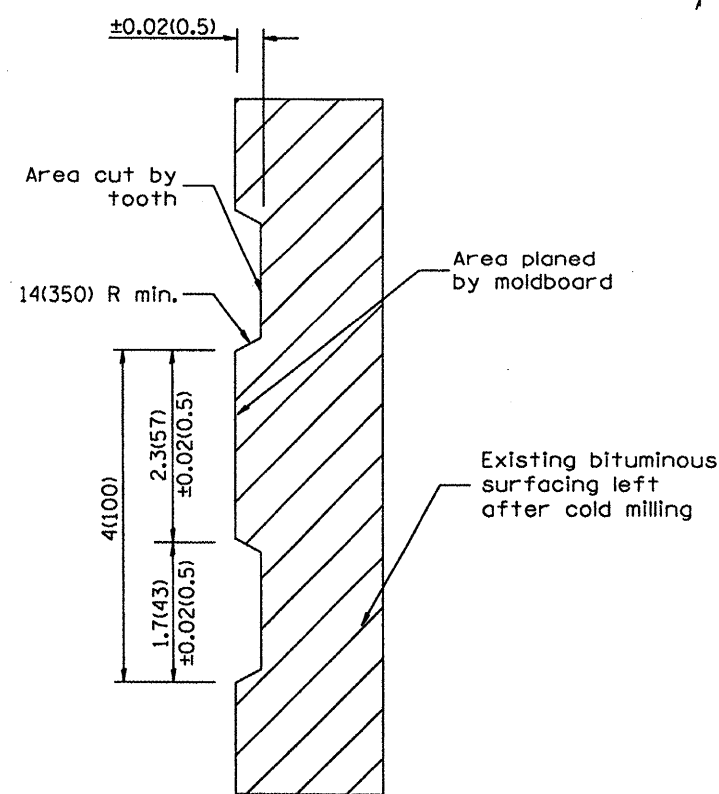

SECTION A-A

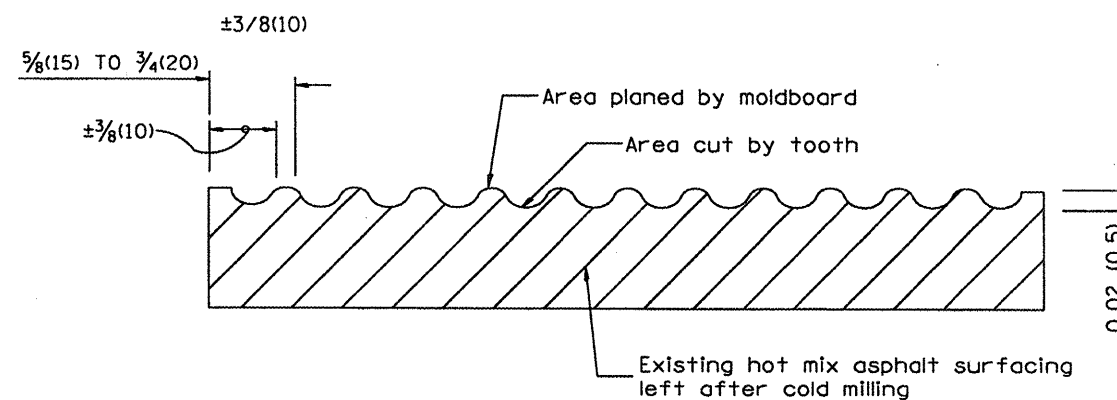

SECTION B-B PROJECTED
PERPENDICULAR TO CENTERLINE

All dimensions are in inches (millimeters) unless otherwise noted.

DATE	REVISIONS	BY
1-1-97	RENUM. C-104.01. NEW REVISION BOX	T. P.
4-20-98	REMOVED MILLING DETAIL FROM STD.	J. A.
9-08-98	CORRECT NOTE LEADER PLACEMENT	R. W.
10-16-06	REVISED TO 2007 SPEC.	M.A.

ILLINOIS DEPARTMENT OF TRANSPORTATION	
DISTRICT CADD STANDARD	
HOT MIX ASPHALT SURFACE REMOVAL (COLD MILLING)	
CADD STD NO. 440001-D4	
SCALE: NOT DRAWN TO SCALE	DRAWN BY CADD
DATE	CHECKED BY

F.A.P. RTE.	SECTION	COUNTY	TOTAL SHEETS	SHEET NO.
646	126RS-7	PEORIA	16	15
STA.		TO STA.		
FED. ROAD DIST. NO.		ILLINOIS FED. AID PROJECT		

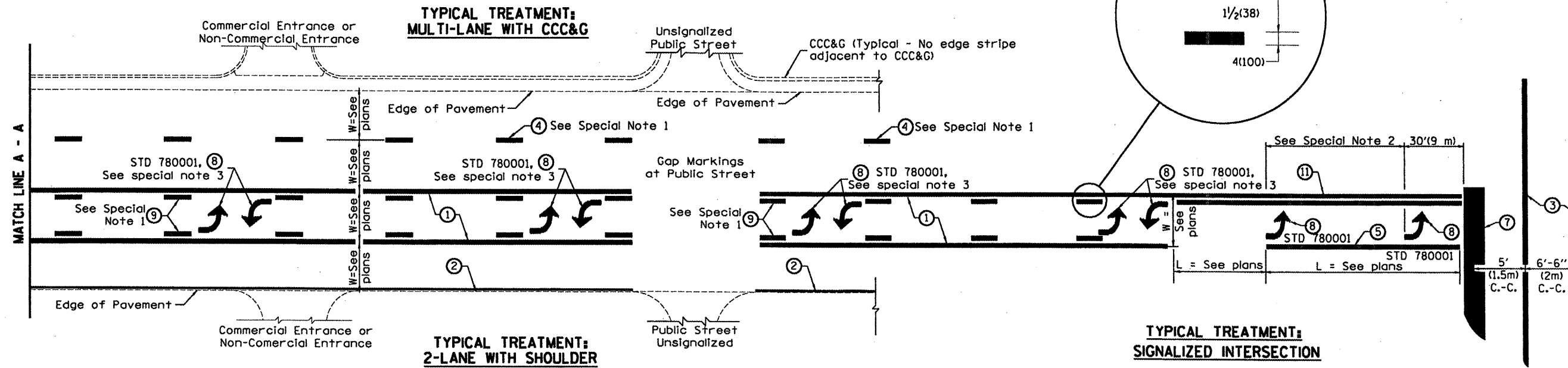

FLUSH PAVED MEDIAN; TWO-WAY LEFT TURN LANE WITH ONE-WAY LEFT TURN LANE AT SIGNALIZED INTERSECTION

TYPICAL PAVEMENT MARKING LEGEND

(Note: This is a District Standard Legend. Some elements may not apply to specific project.)

- ① 4(100) Solid (Yellow)
- ② 4(100) Solid (White)
- ③ 2-6(150) Crosswalk @ 6'-6" (2m)min C.-C. (White)
2-8(200) Crosswalk @ 6'-6" (2m)min C.-C. (White) (When traffic signals are present.)
- ④ 6(150) Skip-Dash (White) (See Special Note 1)
- ⑤ 8(200) Solid (White)
- ⑥ 12(300) Diagonal (White) (Item ⑥ is shown on Std. 780001)
- ⑦ 24(600) Stop Bar (White)
- ⑧ Letters & Arrows (See Std. 780001 and Special Notes 2 & 3)
- ⑨ 4(100) Skip-Dash (Yellow) (See Special Note 1)
- ⑩ 12(300) Diagonal (Yellow) (See Table A)
- ⑪ 4(100) Double Solid (Yellow) (See Table A)

SPECIAL NOTES

1. Skip-Dash markings will be centered between both ends of city blocks and shall be placed in alignment transversely across the pavement.
2. The following shall apply to arrows located in one-way left turn lanes:
 - A. A minimum of two (2) arrows is required.
 - B. The maximum spacing between arrows is 80' (24 m).
 - C. Arrows shall be evenly spaced if three (3) or more are required.
3. The following shall apply to arrow pairs located in two-way left turn lanes:
 - A. A minimum of two (2) arrow pairs is required.
 - B. The maximum spacing between arrow pairs is 200' (61 m).
 - C. Arrow pairs shall be evenly spaced if three (3) or more are required.
 - D. The spacing between BI Directional Left Turn Arrows is 33' (10 m).

GENERAL NOTES

1. Refer to State Standard 780001 for additional Pavement Markings including letters & arrows.
2. See Plans for Pavement Markings adjacent to curbed islands and medians, and through lane reductions.

All dimensions are in inches (millimeters) unless otherwise noted.

ILLINOIS DEPARTMENT OF TRANSPORTATION	
DISTRICT CADD STANDARD	
TYPICAL PAVEMENT MARKINGS	
CADD STANDARD 780001-D4	SHEET 1 OF 2
SCALE: NOT DRAWN TO SCALE	DRAWN BY CADD CHECKED BY

DATE	REVISIONS	BY
1-1-97	RENUM. F-8.03, NEW REVISION BOX	T.P.
2-7-97	ADD BI DIRECTIONAL DIMENSION	J.A.
10-97	CORRECT BI DIRECTIONAL DIMENSION	J.A.
8-02	ADD CROSSWALK DMNS. WITH T.S.	M.A.
10-16-06	REVISED TO 2007 SPEC.	M.A.

F.A.P. RTE.	SECTION	COUNTY	TOTAL SHEETS	SHEET NO.
646	126RS-7	PEORIA	16	16
STA.		TO STA.		
FED. ROAD DIST. NO.	ILLINOIS	FED. AID PROJECT		

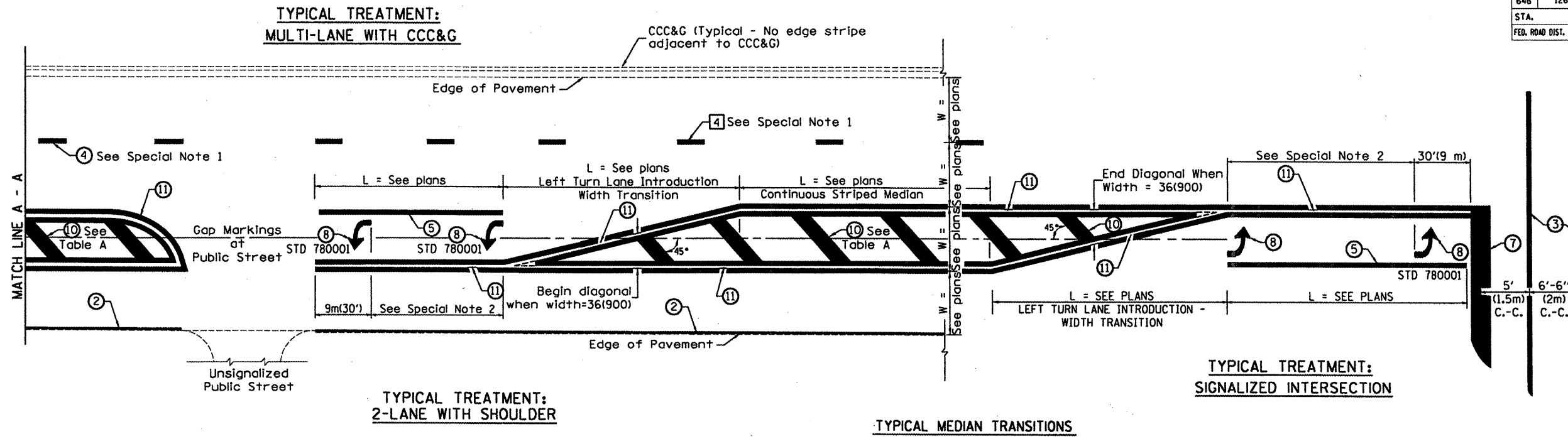

FLUSH PAVED MEDIAN: RESTRICTED LEFT TURN LANE

TABLE A

RECOMMENDED SPACING BETWEEN DIAGONAL LINES

SPEED LIMIT RANGE	CONTINUOUS	INTERSECTION CHANNELIZATION (Includes Width Transitions for Median and Left Turn Lane Introductions)
Less Than 30 mph (50 km/h)	50' (15m)	15' (5m)
30 - 45 mph (50 - 70 km/h)	75' (23m)	20' (6m)
Over 45 mph (70 km/h)	150' (46m)	30' (9m)

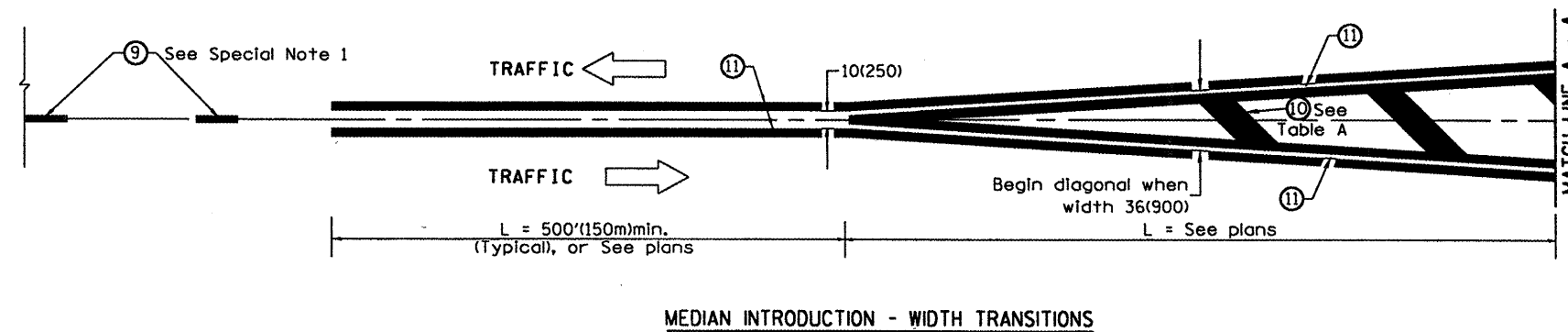

MEDIAN INTRODUCTION - WIDTH TRANSITIONS

All dimensions are in inches (millimeters) unless otherwise noted.

ILLINOIS DEPARTMENT OF TRANSPORTATION	
DISTRICT CADD STANDARD	
TYPICAL PAVEMENT MARKINGS	
CADD STANDARD 780001-D4	SHEET 2 OF 2
SCALE: NOT DRAWN TO SCALE	DRAWN BY CADD CHECKED BY

DATE

DGN-ONLY