

STATE OF ILLINOIS
DEPARTMENT OF TRANSPORTATION

ROUTE NO.	SECTION	COUNTY	TOTAL SHEETS	SHEET NO.	SHEET NO. 6
F.A.S. 502	(86BR)BR	CHAMPAIGN	30	16	8 SHEETS
FED. ROAD DIST. NO. 7	ILLINOIS	FED. AID PROJECT-			

Contract # 70426

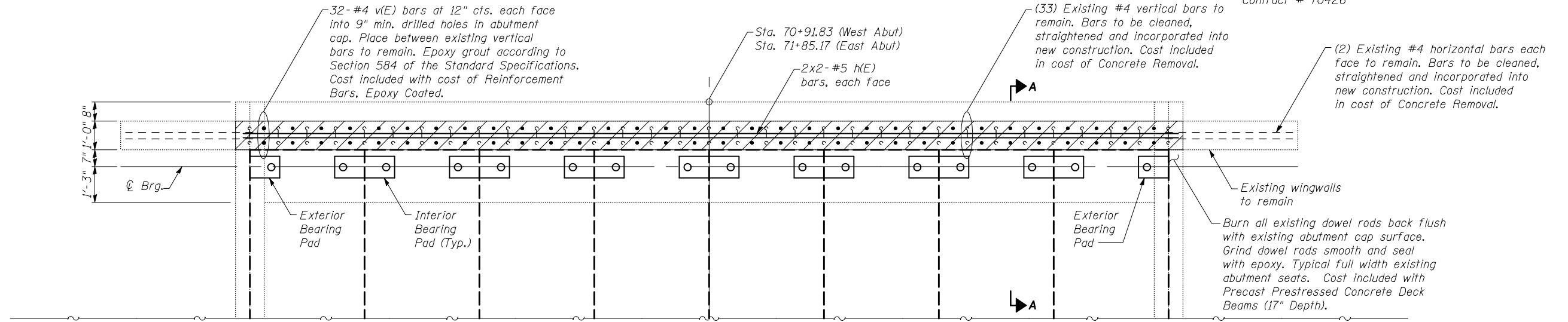

PLAN AT ABUTMENT
(Wearing surface not shown)

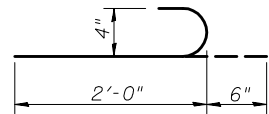

BAR v(E)

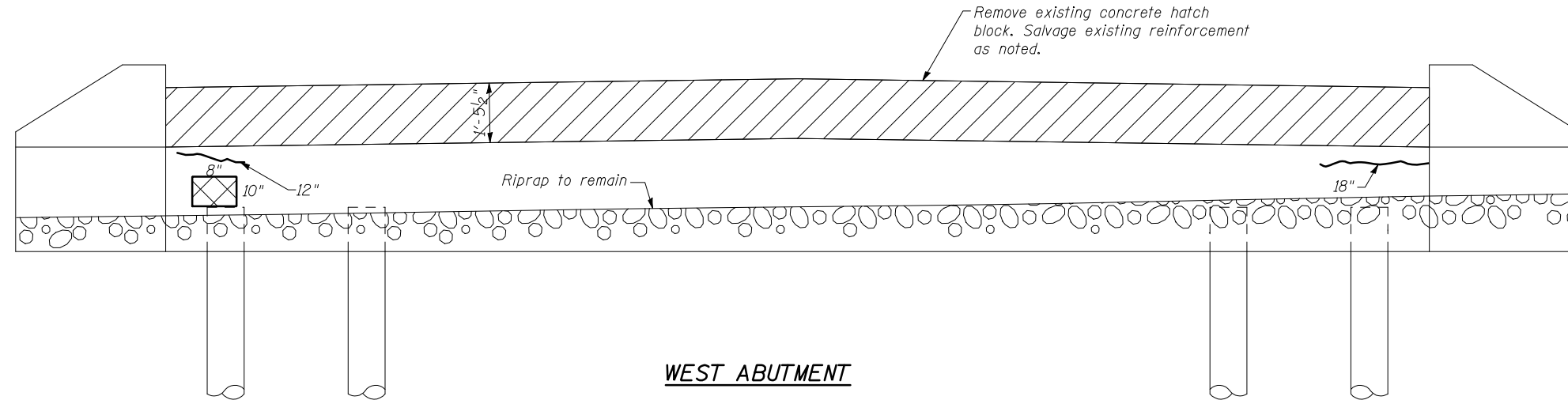

WEST ABUTMENT

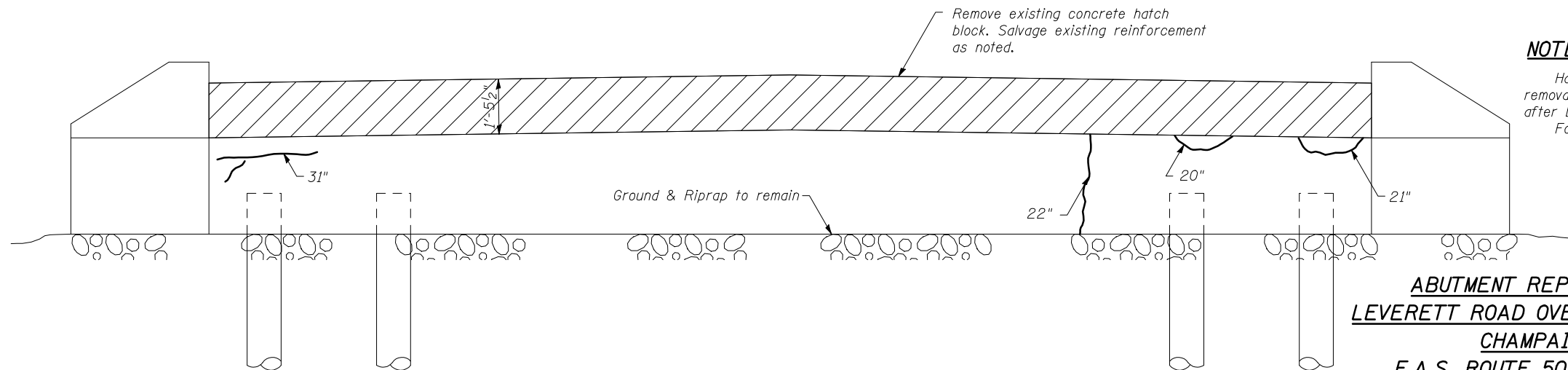

EAST ABUTMENT

BILL OF MATERIAL

Bar	No.	Size	Length	Shape
h(E)	16	#5	17'- 8"	—
v(E)	128	#4	2'- 6"	⌋
Concrete Removal			CU YD	4
Concrete Structures			CU YD	4
Reinforcement Bars, Epoxy Coated			POUND	510
Epoxy Crack Injection			FOOT	12
Structural Repair of Concrete (Depth Less Than or Equal to 5")			SQ FT	1

LEGEND

- Crack - Epoxy Crack Injection
- Portion of Existing Structure To Be Removed
- Structural Repair of Concrete (Depth Less than or Equal to 5")

NOTES:

Hatched areas indicate concrete removal. These areas to be poured after beams are in place.
For section "A-A", see sheet 2 of 8.

DESIGNED	FGE
CHECKED	JAR
DRAWN	KAS
CHECKED	AJS

ABUTMENT REPAIR AND DETAILS
LEVERETT ROAD OVER THE SALINE BRANCH
CHAMPAIGN COUNTY
F.A.S. ROUTE 502 - SEC. (86BR) BR
STATION 71+38.50
S.N. 010-0237

STRAND ASSOCIATES, INC.