

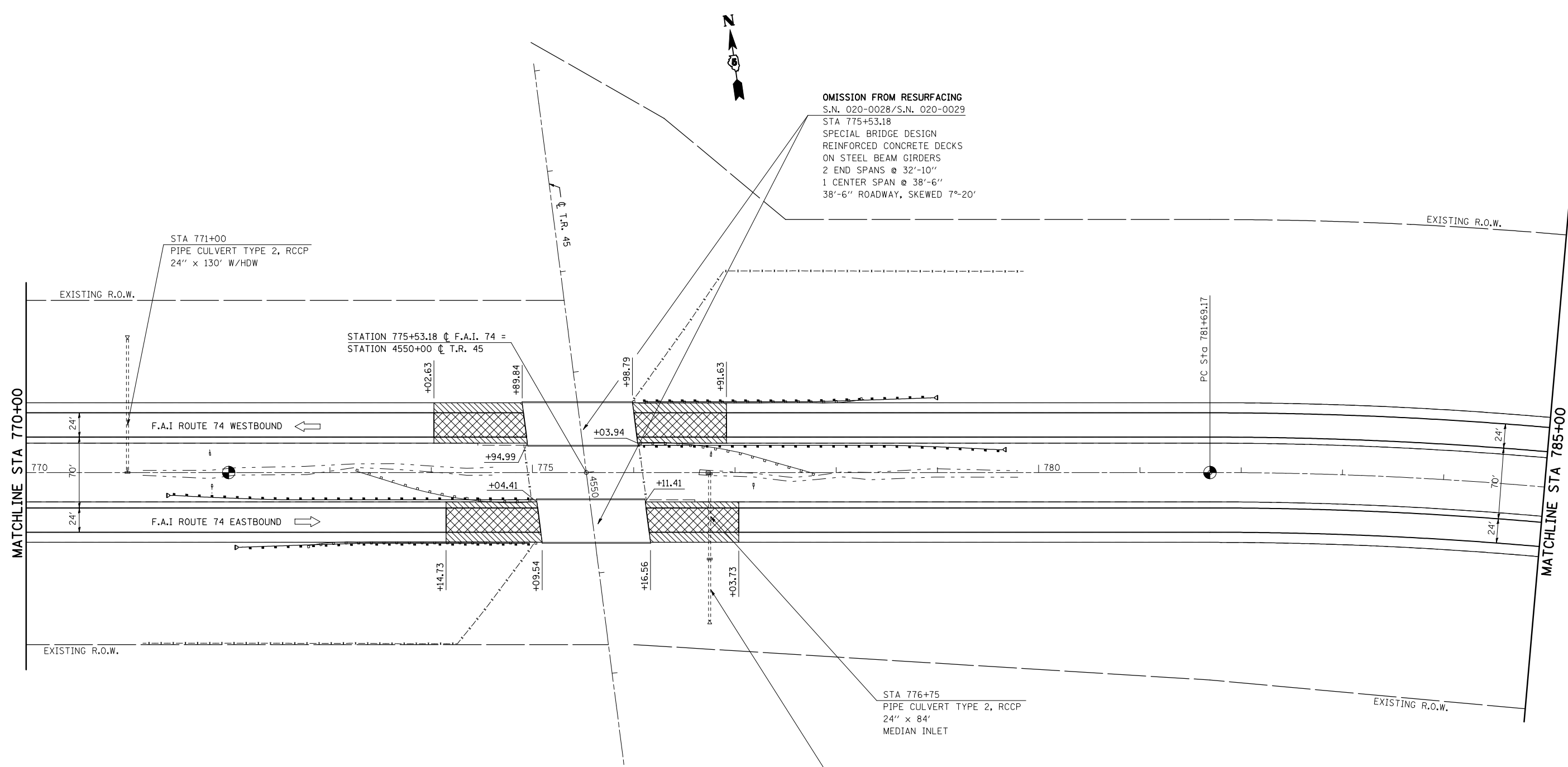

F.A.I. RTE.	SECTION	COUNTY	TOTAL SHEETS	SHEET NO.
74	(20-1)RS-2	DEWITT	97	39
STA. 770+00		TO STA. 785+00		
FED. ROAD DIST. NO.	ILLINOIS	FED. AID PROJECT		

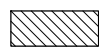

OMISSION FROM RESURFACING
 S.N. 020-0028/S.N. 020-0029
 STA 775+53.18
 SPECIAL BRIDGE DESIGN
 REINFORCED CONCRETE DECKS
 ON STEEL BEAM GIRDERS
 2 END SPANS @ 32'-10"
 1 CENTER SPAN @ 38'-6"
 38'-6" ROADWAY, SKEWED 7°-20'



 HOT-MIX ASPHALT SURFACE
REMOVAL-BUTT JOINT

 MILLING TRANSITION AREA
2 1/4" - 1 1/2"

SEE DETAIL FOR MILLING TRANSITION
AT MAINLINE STRUCTURES
SHEET 58 OF 97

SEE DETAIL FOR GUARDRAIL
LOCATIONS
SHEET 66 OF 97

SEE DETAIL FOR HMA
SURFACE REMOVAL-BUTT JOINT
AT MAINLINE STRUCTURES
SHEET 58 OF 97

STA 776+75
PIPE CULVERT TYPE 2, RCCP
24" x 84'
MEDIAN INLET

STA 776+75
PIPE DRAIN CORRUGATED STEEL
24" x 62' W/HDW

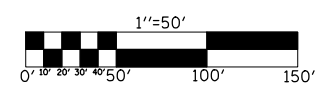

REVISIONS	
NAME	DATE

ILLINOIS DEPARTMENT OF TRANSPORTATION

PLAN VIEW

F.A.I. ROUTE 74
SECTION (20-1)RS-2
DEWITT COUNTY

SCALE: VERT. 1"=50'
HORIZ. 1"=50'
DATE: 06/24/05

DRAWN BY: JRP
CHECKED BY:

PLOT DATE = 3/28/2008
 FILE NAME = c:\projects\70475\reference\70475.dgn
 PLOT SCALE = 1/8"=1'-0" / IN.
 USER NAME = collierb