

INCIDENTAL HMA SURF			AVE. THICK= 1.50 "		
STA	O/S	DESC.	SQFT	SQYD	TON
1386+32.78	LT	JEFFERSON AVE.	3,088.0	343.1	28.82
1386+32.78	RT	JEFFERSON AVE.	1,266.0	140.7	11.82

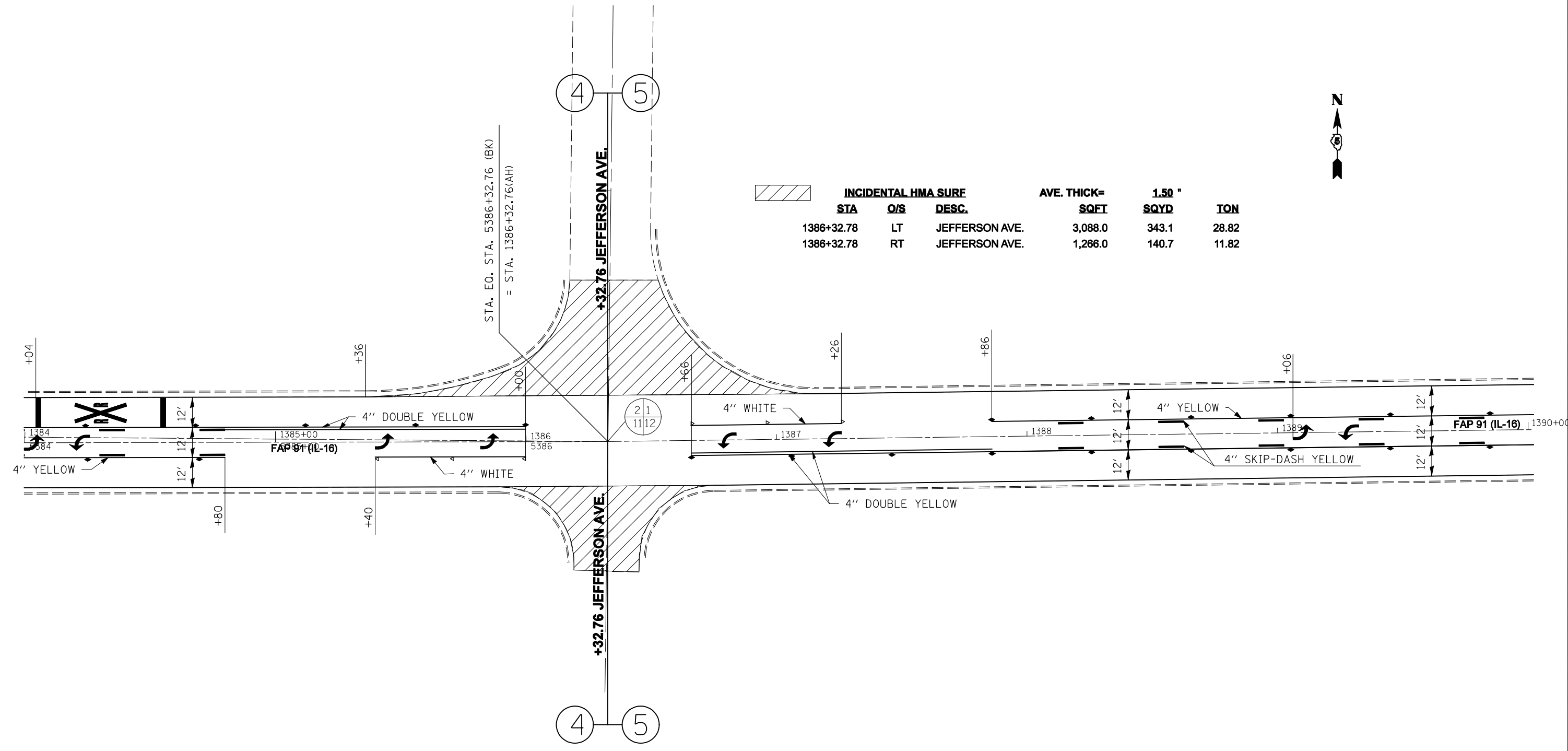

FILE NAME =	USER NAME = sheehyom	DESIGNED -	REVISED -
ct:\projects\d500807 (v8)\70638tr\pimg.dgn		DRAWN -	REVISED -
	PLOT SCALE = 40.0000 ' / IN.	CHECKED -	REVISED -
	PLOT DATE = 3/26/2008	DATE -	REVISED -

STATE OF ILLINOIS
DEPARTMENT OF TRANSPORTATION

PLAN SHEET PAVING COLD MILLING IL-133 TO LOWER-T IN PARIS

SCALE: SHEET NO. OF SHEETS STA. TO STA.

F.A.P. RTE.	SECTION	COUNTY	TOTAL SHEETS	SHEET NO.
91	• 1 RS-4 & 101 RS-6	EDGAR	35	20
FED. ROAD DIST. NO. ILLINOIS FED. AID PROJECT			CONTRACT NO. 70638	