

F.A.I. RTE.	SECTION	COUNTY	TOTAL SHEETS	SHEET NO.
74	.	CHAMPAIGN	93	22
STA.		TO STA.		
FED. ROAD DIST. NO.		ILLINOIS FED. AID PROJECT		
		• (10,92-8 HB-1)BR		
		CONTRACT NO. 70695		
SHEET B				

TRAFFIC CONTROL AND PROTECTION (DETOUR 1)  
SHEET 2 OF 4

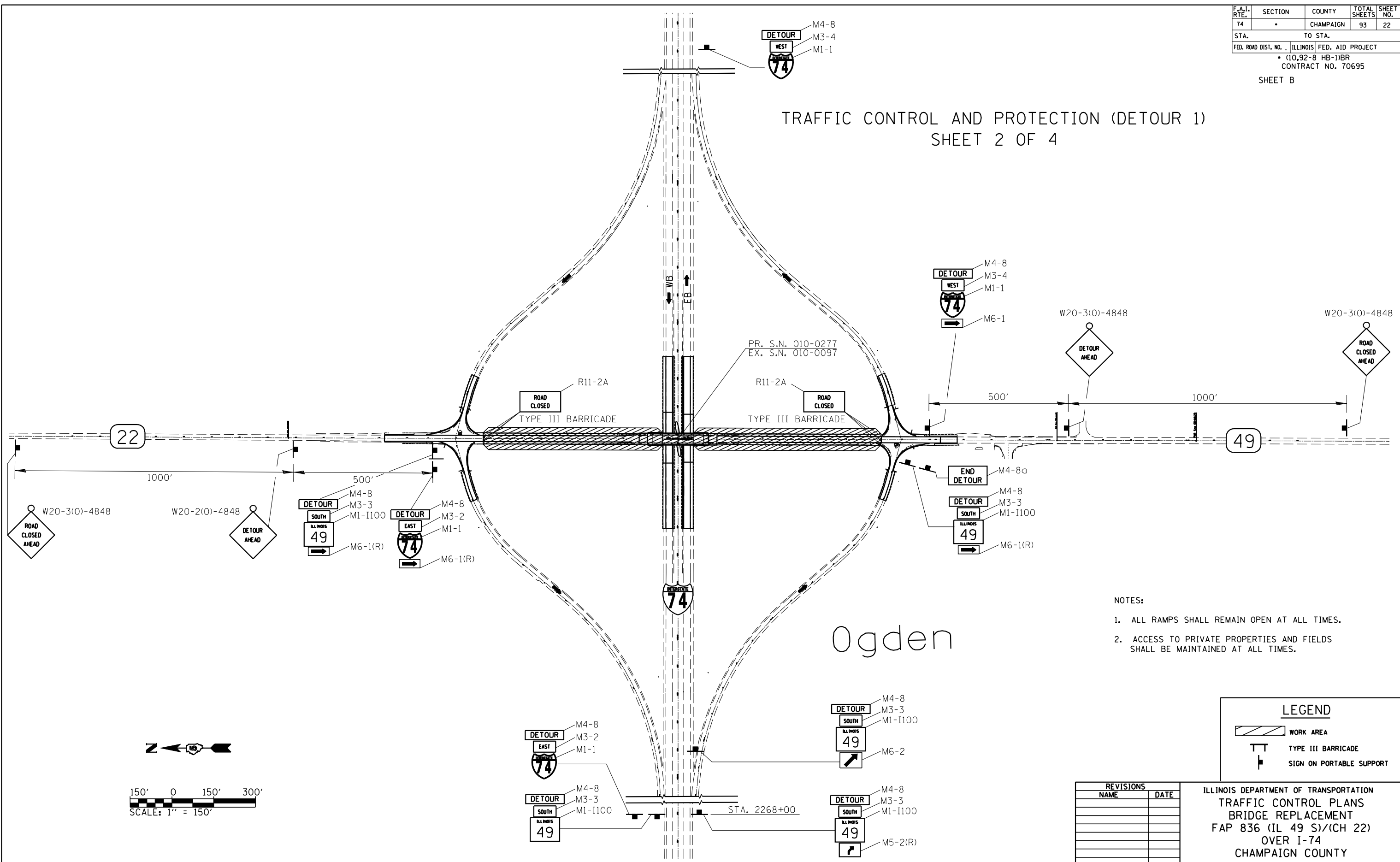

- NOTES:
1. ALL RAMPS SHALL REMAIN OPEN AT ALL TIMES.
  2. ACCESS TO PRIVATE PROPERTIES AND FIELDS SHALL BE MAINTAINED AT ALL TIMES.

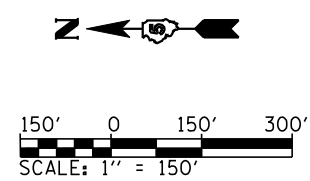

LEGEND	
	WORK AREA
	TYPE III BARRICADE
	SIGN ON PORTABLE SUPPORT

REVISIONS	
NAME	DATE

ILLINOIS DEPARTMENT OF TRANSPORTATION  
 TRAFFIC CONTROL PLANS  
 BRIDGE REPLACEMENT  
 FAP 836 (IL 49 S)/(CH 22)  
 OVER I-74  
 CHAMPAIGN COUNTY  
 SCALE: 1" = 150'  
 DATE: 06/2003  
 DRAWN BY: WJX  
 CHECKED BY: JH