

SEC 8, TWP. 19 N, R 14W, 2 P.M.

SEC 9, TWP. 19 N, R 14W, 2 P.M.

F.A.I. RTE.	SECTION	COUNTY	TOTAL SHEETS	SHEET NO.
74	*	CHAMPAIGN	93	33
STA.		TO STA.		
FED. ROAD DIST. NO. ILLINOIS FED. AID PROJECT				
*(10,92-8 HB-1)BR				
CONTRACT NO. 70695				

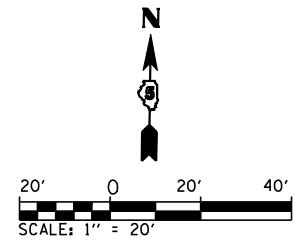

EXIST. CURVE 36
 PI STA. = 500+13.18
 $\Delta = 35^\circ 28' 03''$ (RT)
 $D = 10^\circ 22' 31''$
 $R = 552.23'$
 $T = 176.60'$
 $L = 341.85'$
 $E = 27.55'$
 P.C. STA. = 498+36.58
 P.T. STA. = 501+78.43

NOTE:
 SEE SHEET 36 OF 93
 FOR INTERSECTION DETAIL

EXIST. CURVE 21
 PI STA. = 101+64.07
 $\Delta = 34^\circ 02' 41''$ (RT)
 $D = 10^\circ 20' 21''$
 $R = 554.16'$
 $T = 169.66'$
 $L = 329.28'$
 $E = 25.39'$
 P.C. STA. = 99+94.41
 P.T. STA. = 103+23.69

PLAN	DATE
SURVEYED	
PLOTTED	
CHECKED	
NO. OF WAY CHECKED	
CADD FILE NAME	

PROFILE	DATE
SURVEYED	
PLOTTED	
CHECKED	
BY, NOTED	
STRUCTURE NOTATIONS CHKD	

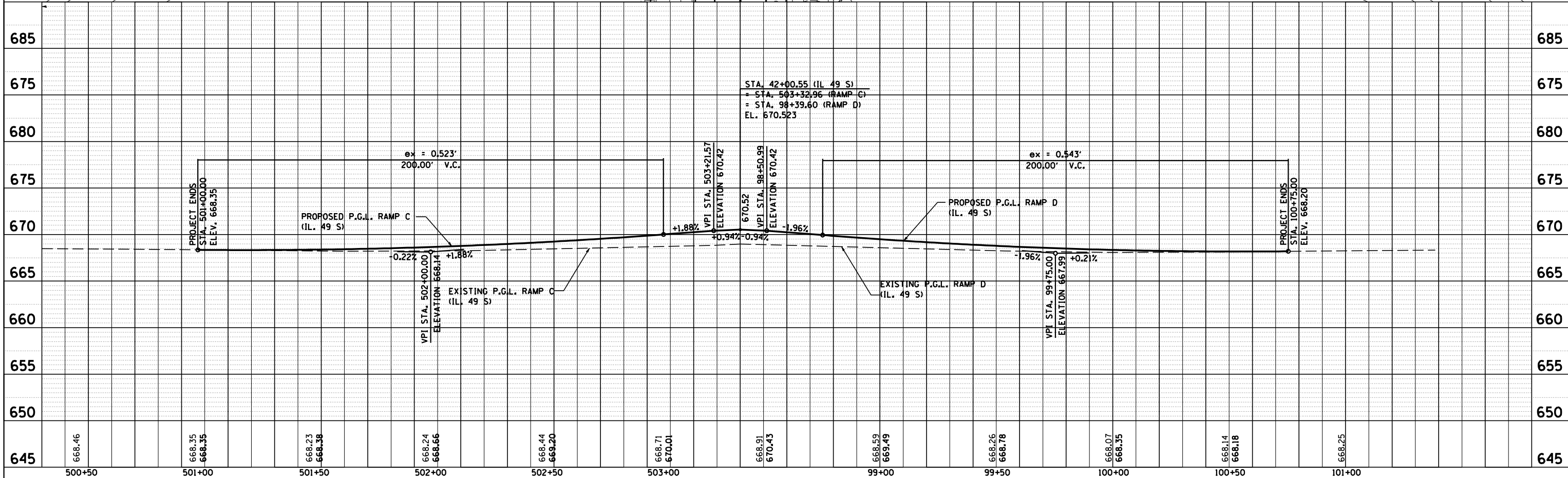
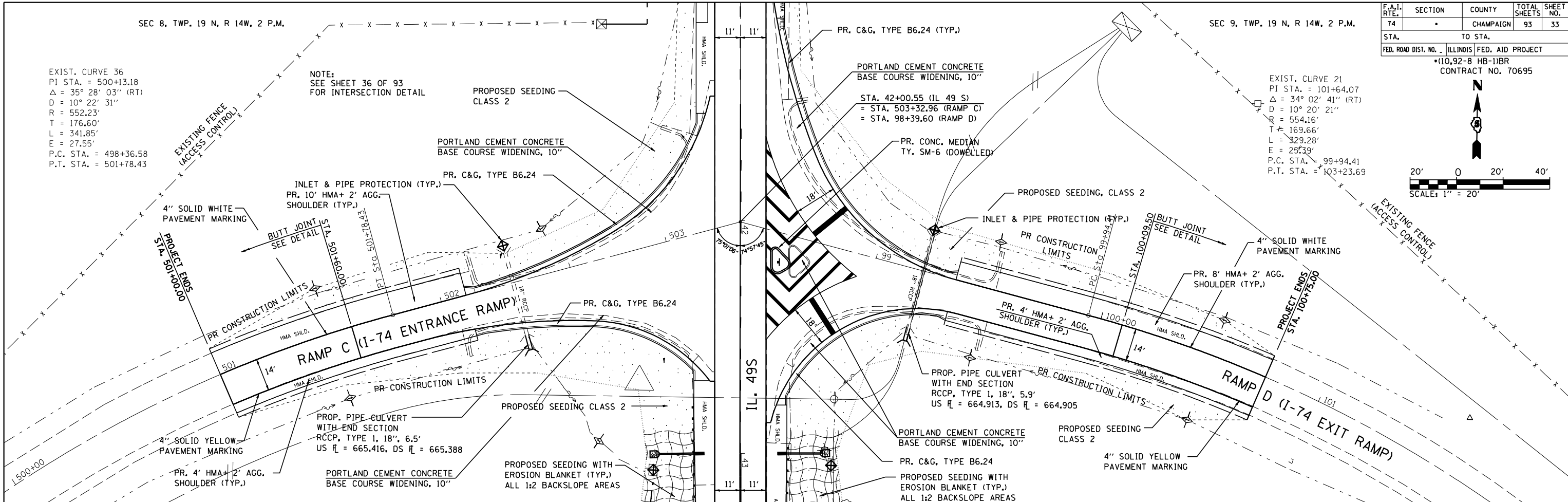

IL 49S RAMPS C & D