

STATE OF ILLINOIS
 DEPARTMENT OF TRANSPORTATION
 DIVISION OF HIGHWAYS

**PROPOSED
 HIGHWAY PLANS**

F.A.U. ROUTE 7123 (IL 10)
 F.A.S. ROUTE 1514 (IL 10)
 SECTION 09PPP
 CHAMPAIGN COUNTY

C-95-009-08
 MICROSURFACING
 ILL 47 TO STALEY ROAD

F.A. RTE.	SECTION	COUNTY	TOTAL SHEETS	SHEET NO.
•	OSPPP	CHAMPAIGN	13	1
FED. ROAD DIST. NO.	ILLINOIS	CONTRACT NO. 70722		

• FAU 7123 (IL 10)
 FAS 1514 (IL 10)

D-95-009-08

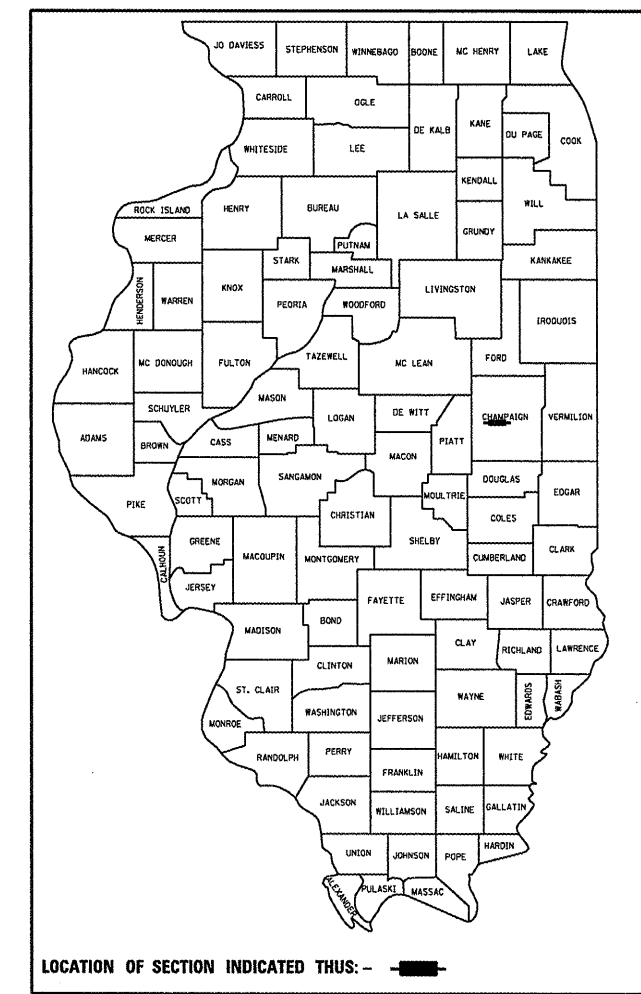

LOCATION OF SECTION INDICATED THUS: - [shaded box] -

FOR INDEX OF SHEETS, SEE SHEET NO. 2
 FOR SUMMARY OF QUANTITIES, SEE SHEET NO. 3

END F.A.U. 7123 STATION 300+19.00
 BEGIN F.A.S. 1514 STATION 300+19.00
 END PROJECT (F.A.S. 1514)
 STATION 381+99.11

OMISSION S.N. 010-0248
 STATION 169+49.17 TO
 STATION 170+50.83
 BEGIN PROJECT (F.A.U. 7123)
 STATION 143+33.80

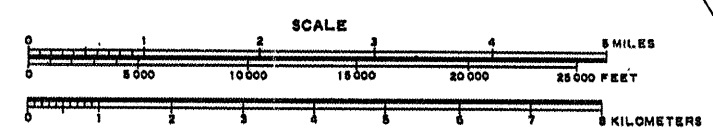
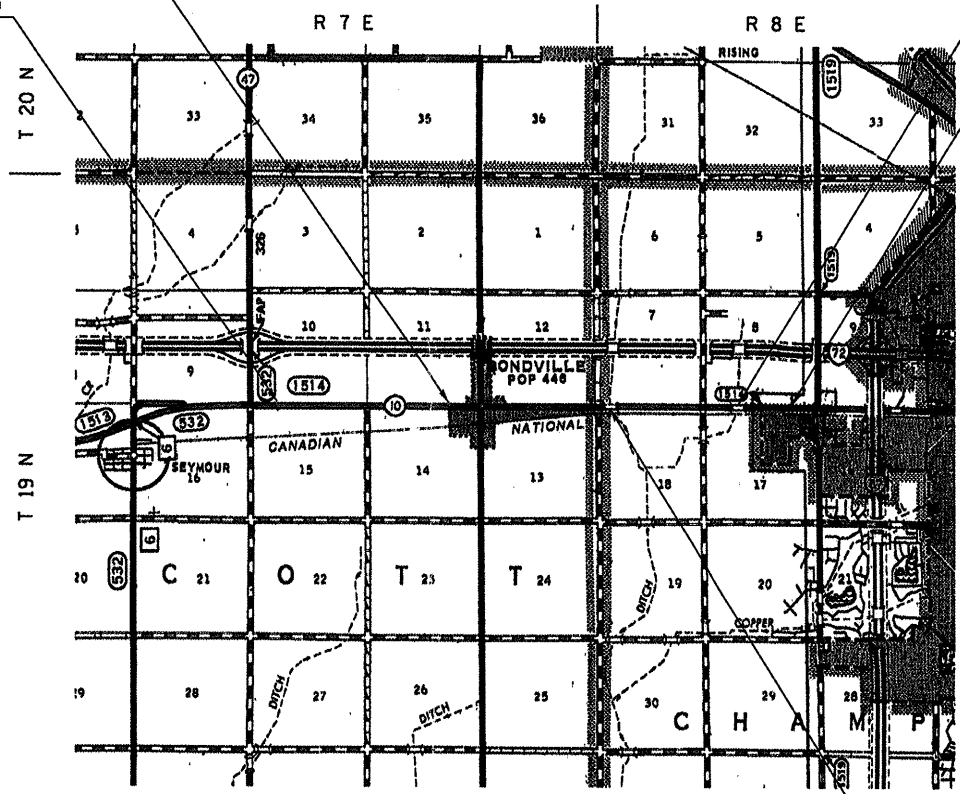

TOTAL LENGTH OF SECTION & PROJECT = 23,865.31 FEET = 4.520 MILES
 NET LENGTH OF SECTION & PROJECT = 23,638.65 FEET = 4.477 MILES

CURRENT ADT
 3000

DESIGN DESIGNATION
 FAU 7123 - URBAN MINOR COLLECTOR
 FAS 1514 - MAJOR COLLECTOR

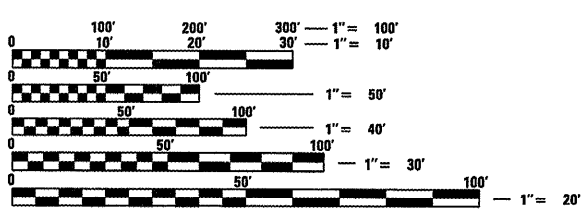

FULL SIZE PLANS HAVE BEEN PREPARED USING STANDARD ENGINEERING SCALES. REDUCED SIZED PLANS WILL NOT CONFORM TO STANDARD SCALES. IN MAKING MEASUREMENTS ON REDUCED PLANS, THE ABOVE SCALES MAY BE USED.

J.U.L.I.E.
 JOINT UTILITY LOCATION INFORMATION FOR EXCAVATION
 1-800-892-0123
 OR 811

PROJECT ENGINEER: KEVIN TRAPP (217)465-4181
 SENIOR SQUAD LEADER: CHRISTOPHER GREESON (217)465-4181

CONTRACT NO. 70722

STATE OF ILLINOIS
 DEPARTMENT OF TRANSPORTATION
 DIVISION OF HIGHWAYS
 SUBMITTED MARCH 24 2008
Joseph E. Lewis
 DEPUTY DIRECTOR OF HIGHWAYS, REGION ENGINEER
May 9 2008
Erud E. Hamm
 INTERIM ENGINEER OF DESIGN AND ENVIRONMENT
May 9 2008
Christine M. Reed
 DIRECTOR OF HIGHWAYS, CHIEF ENGINEER

**PRINTED BY THE AUTHORITY
 OF THE STATE OF ILLINOIS**

INDEX OF SHEETS

<u>SHEET NO.</u>	<u>ITEM</u>
1	COVER SHEET
2	INDEX OF SHEETS
2	LIST OF HIGHWAY STANDARDS
3	GENERAL NOTES
4	SUMMARY OF QUANTITIES
5 - 6	EXISTING TYPICAL CROSS SECTIONS
7 - 8	PROPOSED TYPICAL CROSS SECTIONS
9	SCHEDULE OF QUANTITIES
10 - 13	TYPICAL APPLICATION OF PAVEMENT MARKINGS AND MARKERS DETAIL

LIST OF STANDARDS

<u>STANDARD NO.</u>	<u>DESCRIPTION</u>
000001-05	STANDARD SYMBOLS, ABBREVIATIONS, AND PATTERNS
701301-02	LANE CLOSURE, 2L, 2W, SHORT TIME OPERATIONS
701306-01	LANE CLOSURE, 2L, 2W, SLOW MOVING OPERATIONS DAY ONLY, FOR SPEEDS >= 45 mph
701311-02	LANE CLOSURE, 2L, 2W, MOVING OPERATIONS - DAY ONLY
701901	TRAFFIC CONTROL DEVICES
780001-01	TYPICAL PAVEMENT MARKINGS
781001-02	TYPICAL APPLICATIONS RAISED REFLECTIVE PAVEMENT MARKERS

• FAU 7123 (IL 10)
FAS 1514 (IL 10)

FILE NAME = c:\projects\d570722\70722plan.dgn	USER NAME = ppersonbr PLOT SCALE = 40.0000 / / IN. PLOT DATE = 3/25/2008	DESIGNED - CRG DRAWN - BBP CHECKED - DATE - 03/18/08	REVISED - REVISED - REVISED - REVISED -	STATE OF ILLINOIS DEPARTMENT OF TRANSPORTATION	INDEX OF SHEETS & LIST OF STANDARDS	<table border="1" style="width: 100%; border-collapse: collapse;"> <tr> <td style="font-size: small;">F.A. RTE.</td> <td style="font-size: small;">SECTION</td> <td style="font-size: small;">COUNTY</td> <td style="font-size: small;">TOTAL SHEETS</td> <td style="font-size: small;">SHEET NO.</td> </tr> <tr> <td style="text-align: center;">*</td> <td style="text-align: center;">09PPP</td> <td style="text-align: center;">CHAMPAIGN</td> <td style="text-align: center;">13</td> <td style="text-align: center;">2</td> </tr> <tr> <td colspan="5" style="text-align: center; font-weight: bold;">CONTRACT NO. 70722</td> </tr> </table>	F.A. RTE.	SECTION	COUNTY	TOTAL SHEETS	SHEET NO.	*	09PPP	CHAMPAIGN	13	2	CONTRACT NO. 70722				
F.A. RTE.	SECTION	COUNTY	TOTAL SHEETS	SHEET NO.																	
*	09PPP	CHAMPAIGN	13	2																	
CONTRACT NO. 70722																					
				SCALE: NONE	SHEET NO. OF SHEETS	STA. TO STA.	FED. ROAD DIST. NO. ILLINOIS FED. AID PROJECT														

GENERAL NOTES

G. N. -100
 ENGLISH UNITS OF MEASUREMENT SHALL GOVERN OVER AND SUPERSEDE ANY METRIC UNITS SHOWN IN THIS CONTRACT. WHERE INCLUDED, METRIC UNITS ARE FOR INFORMATION ONLY.

G. N. -451 (SPECIAL)
 CRACK FILLING CONSISTS OF BOTH LONGITUDINAL AND TRANSVERSE CRACKS. AN APPLICATION RATE OF 0.40 LBS. / FOOT WAS USED TO DETERMINE THE FIBER ASPHALT QUANTITY

G. N. -703A
 SHORT TERM PAVEMENT MARKING SHALL BE APPLIED TO THE PAVEMENT AFTER ANY OF THE FOLLOWING: COLD MILLING AND/OR PLACING BITUMINOUS MATERIALS (PRIME COAT), LEVELING BINDER (MACHINE METHOD), BINDER AND SURFACE COURSES AND MICRO-SURFACING. SHORT TERM PAVEMENT MARKING PLACED ON THE SURFACE, SHALL COINCIDE WITH THE FINAL PAVEMENT STRIPING. SHORT TERM PAVEMENT MARKING PLACED PRIOR TO THE SURFACE SHALL COINCIDE WITH THE EXISTING PAVEMENT MARKINGS. USE 4 FEET PER 40 FEET (OR 10% PER STATION).

G. N. -781
 RAISED REFLECTIVE PAVEMENT MARKERS SHALL BE PLACED IN ACCORDANCE WITH STANDARD 781001, AND THE DETAILS SHOWN IN THE PLANS. IF THERE IS ANY DISCREPANCY BETWEEN THE STANDARD AND THE DETAILS IN THE PLANS, THE DETAILS IN THE PLANS SHALL GOVERN. THE FINAL PAVEMENT MARKINGS SHALL BE IN PLACE PRIOR TO PLACING THE RAISED REFLECTIVE PAVEMENT MARKERS AND THE RAISED REFLECTIVE PAVEMENT MARKERS SHALL BE PLACED MIDWAY IN THE 30 FOOT (9 m) SPACE BETWEEN THE DASHED CENTERLINE STRIPES (WHEN APPLICABLE).

G. N. -1004.01
 COARSE AGGREGATE GRADATION CA-10 MAY BE USED WHENEVER COARSE AGGREGATE CA-6 IS SPECIFIED IN THE STANDARD SPECIFICATIONS.

G. N. (SPECIAL)
 THE CONTRACTOR SHALL DEVISE AND SUBMIT A JOINT PLAN THAT MEETS THE APPROVAL OF THE ENGINEER.

COMMITMENTS:
 THERE ARE NO COMMITMENTS FOR THIS PROJECT.

• FAU 7123 (IL 10)
 FAS 1514 (IL 10)

FILE NAME : c:\projects\4570722\70722plan.dgn	USER NAME : piersonbr	DESIGNED - CRG DRAWN - BBP CHECKED - DATE - 03/18/08	REVISED - REVISED - REVISED - REVISED -	STATE OF ILLINOIS DEPARTMENT OF TRANSPORTATION	GENERAL NOTES	F.A. RTE. •	SECTION 09PPP	COUNTY CHAMPAIGN	TOTAL SHEETS 13	SHEET NO. 3	CONTRACT NO. 70722
				SCALE: NONE	SHEET NO. OF SHEETS STA. TO STA.	FED. ROAD DIST. NO. ILLINOIS FED. AID PROJECT					

SUMMARY OF QUANTITIES

LOCATION OF WORK:

F. A. U. 7123 (IL 10) CHAMPAIGN URBAN STA. 143+33.80 STA. 300+19.00 100% STATE F000	F. A. S. 1514 (IL 10) CHAMPAIGN RURAL STA. 300+19.00 STA. 381+99.11 100% STATE F000
---	---

CONSTRUCTION TYPE CODE:

<u>CODE NO</u>	<u>ITEM</u>	<u>UNIT</u>	<u>TOTAL QUANTITY</u>	<u>QUANTITY</u>	<u>QUANTITY</u>
40600100	BITUMINOUS MATERIALS (PRIME COAT)	GALLON	6,300.0	4,120.0	2,180.0
40600300	AGGREGATE (PRIME COAT)	TON	125.0	80.0	45.0
48101200	AGGREGATE SHOULDERS, TYPE B	TON	790.0	515.0	275.0
67100100	MOBILIZATION	L SUM	1.0	0.6	0.4
70100460	TRAFFIC CONTROL AND PROTECTION, STANDARD 701306	L SUM	1.0	0.6	0.4
70300100	SHORT-TERM PAVEMENT MARKING	FOOT	4,730.0	3,095.0	1,635.0
70301000	WORK ZONE PAVEMENT MARKING REMOVAL	SQ FT	1,575.0	1,030.0	545.0
* 78001110	PAINT PAVEMENT MARKING - LINE 4"	FOOT	55,155.0	36,065.0	19,090.0
* 78100100	RAISED REFLECTIVE PAVEMENT MARKER	EACH	296.0	193.0	103.0
78300200	RAISED REFLECTIVE PAVEMENT MARKER REMOVAL	EACH	296.0	193.0	103.0
X0325223	FIBER ASPHALT	POUND	28,795.0	18,830.0	9,965.0
X4480205	MICRO-SURFACING, 2 PASSES, TYPE 2	SQ YD	63,040.0	41,225.0	21,815.0
* SPECIALTY ITEMS					

* FAU 7123 (IL 10)
FAS 1514 (IL 10)

FILE NAME = c:\projects\0570722\70722plan.dgn	USER NAME = ppersonbr	DESIGNED - CRG	REVISED -	STATE OF ILLINOIS DEPARTMENT OF TRANSPORTATION	SCALE:	SHEET NO. OF SHEETS STA. TO STA.	F.A. RTE. SECTION COUNTY TOTAL SHEETS SHEET NO. * 09PPP CHAMPAIGN 13 4 CONTRACT NO. 70722
	PLOT SCALE = 40.0000' / IN.	DRAWN - BBP	REVISED -				FED. ROAD DIST. NO. ILLINOIS FED. AID PROJECT
	PLOT DATE = 3/25/2008	CHECKED -	REVISED -				
		DATE - 03/18/08	REVISED -				

EXISTING TYPICAL CROSS SECTION (FAU 7123)

STATION 144+33.80 TO STATION 155+04.77
 STATION 182+93.42 TO STATION 300+19.00

BRIDGE OMISSION
 STATION 226+65.50 TO STATION 227+90.50

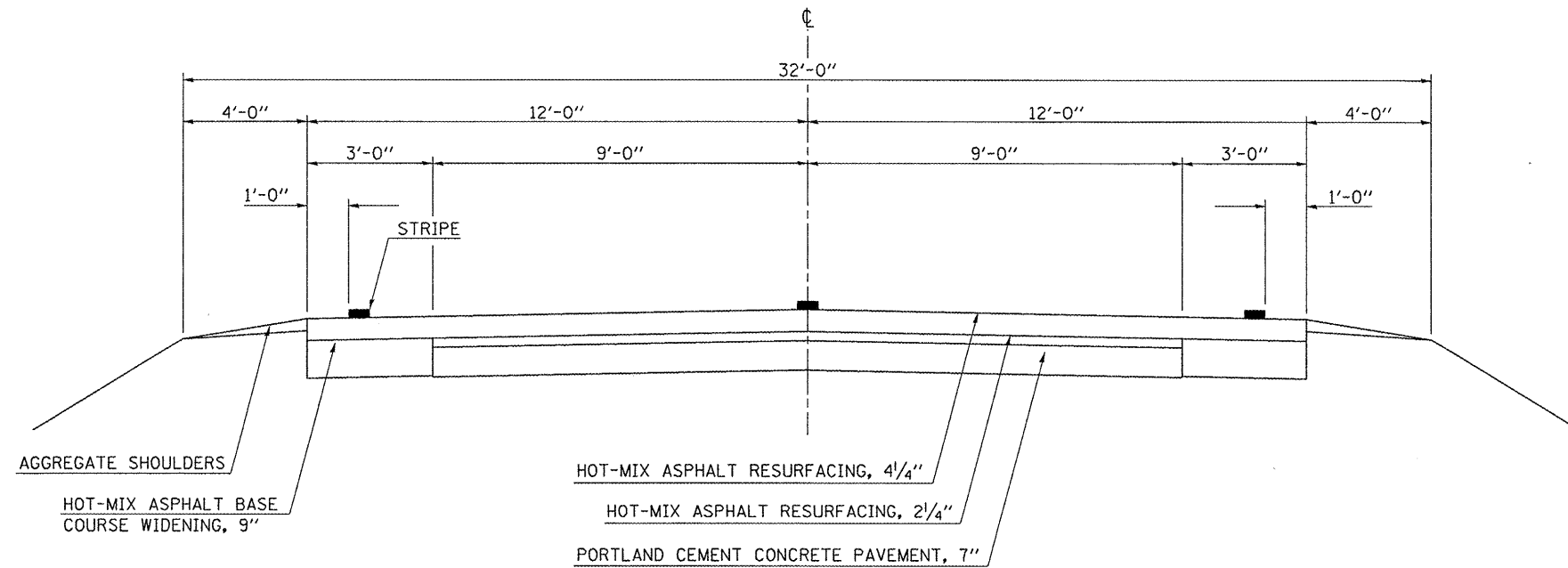

EXISTING TYPICAL CROSS SECTION (FAU 7123)

STATION 155+04.77 TO STATION 182+93.42

BRIDGE OMISSION
 STATION 169+49.17 TO STATION 170+50.83

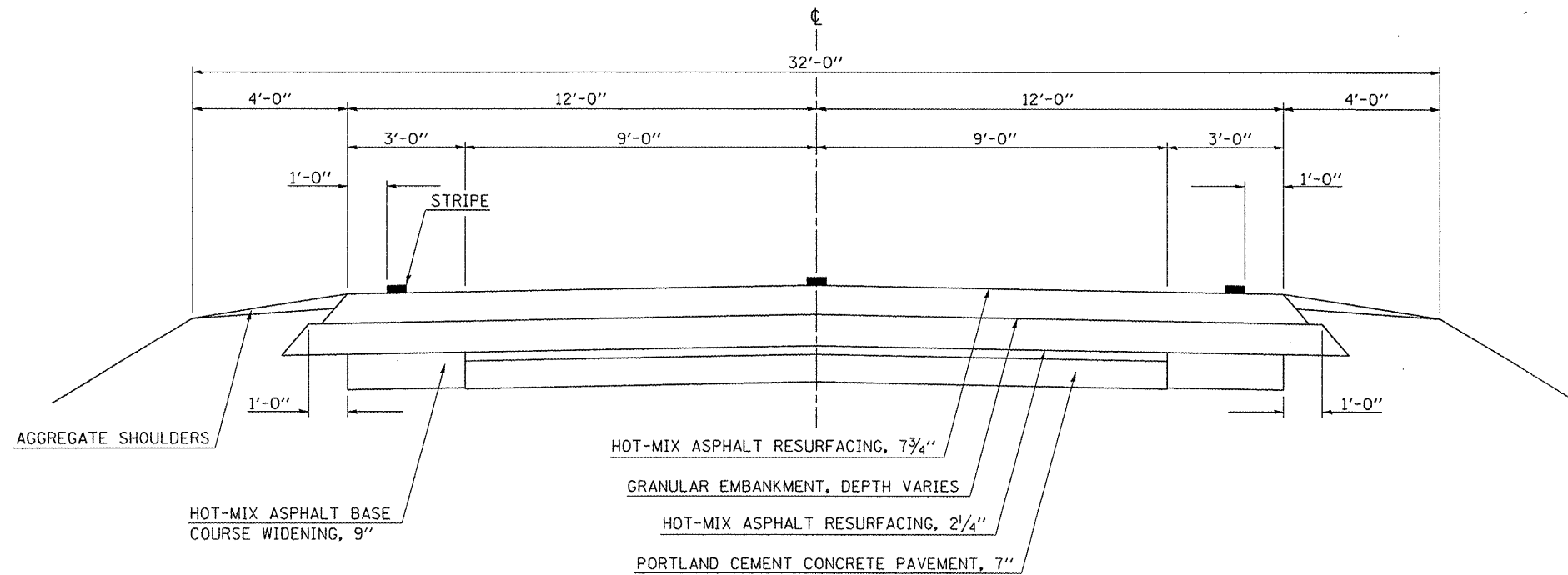

• FAU 7123 (IL 10)
 FAS 1514 (IL 10)

FILE NAME = c:\projects\d570722\70722pln.dgn	USER NAME = piersonbr	DESIGNED - CRG	REVISED -
		DRAWN - BBP	REVISED -
		CHECKED -	REVISED -
		DATE - 03/18/08	REVISED -

STATE OF ILLINOIS
 DEPARTMENT OF TRANSPORTATION

EXISTING TYPICAL CROSS SECTIONS

SCALE: NONE SHEET NO. 1 OF 2 SHEETS STA. TO STA.

F.A. RTE.	SECTION	COUNTY	TOTAL SHEETS	SHEET NO.
•	09PPP	CHAMPAIGN	13	5
CONTRACT NO. 70722				
FED. ROAD DIST. NO. ILLINOIS FED. AID PROJECT				

EXISTING TYPICAL CROSS SECTION (FAS 1514)

STATION 300+19.00 TO STATION 381+99.11

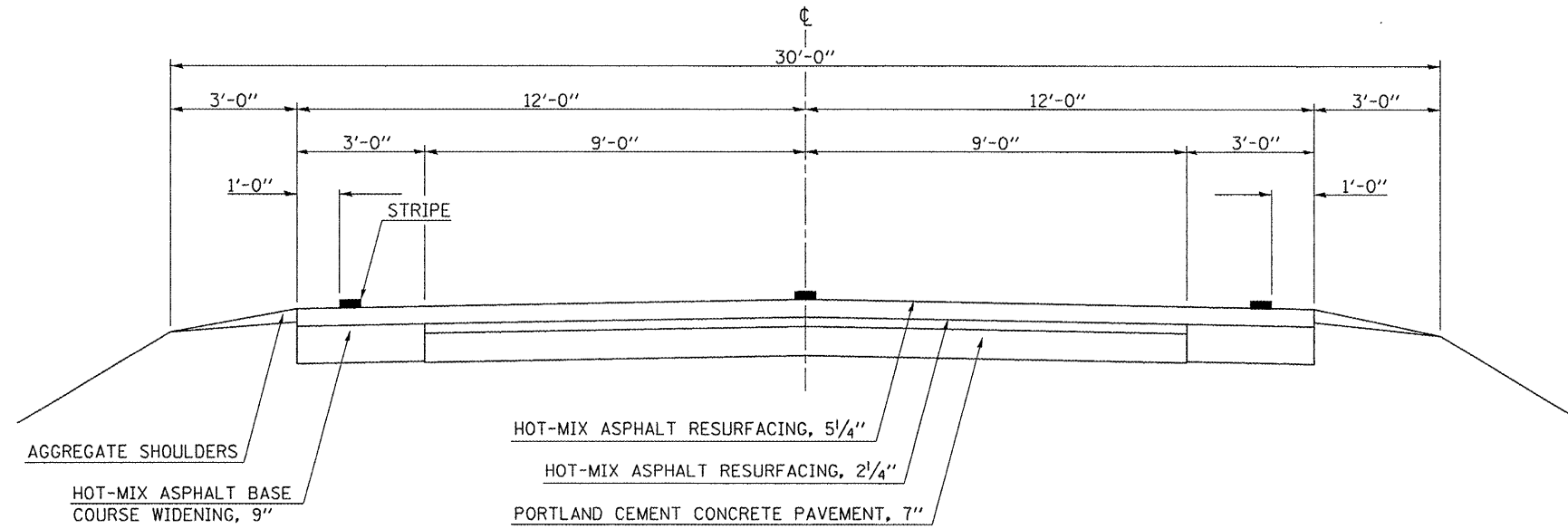

• FAU 7123 (IL 10)
FAS 1514 (IL 10)

FILE NAME = c:\projects\0570722\70722plan.dgn	USER NAME = p1ersonbr	DESIGNED - CRG	REVISED -
		DRAWN - BBP	REVISED -
		CHECKED -	REVISED -
		DATE - 03/18/08	REVISED -

STATE OF ILLINOIS
DEPARTMENT OF TRANSPORTATION

EXISTING TYPICAL CROSS SECTIONS	
SCALE: NONE	SHEET NO. 2 OF 2 SHEETS
STA.	TO STA.

F.A. RTE.	SECTION	COUNTY	TOTAL SHEETS	SHEET NO.
•	09PPP	CHAMPAIGN	13	6
FED. ROAD DIST. NO.			ILLINOIS FED. AID PROJECT	
CONTRACT NO. 70722				

① PROPOSED TYPICAL CROSS SECTION (FAU 7123)

STATION 144+33.80 TO STATION 155+04.77 ②
 ② STATION 182+93.42 TO STATION 300+19.00 ③

BRIDGE OMISSION
 STATION 226+65.50 TO STATION 227+90.50

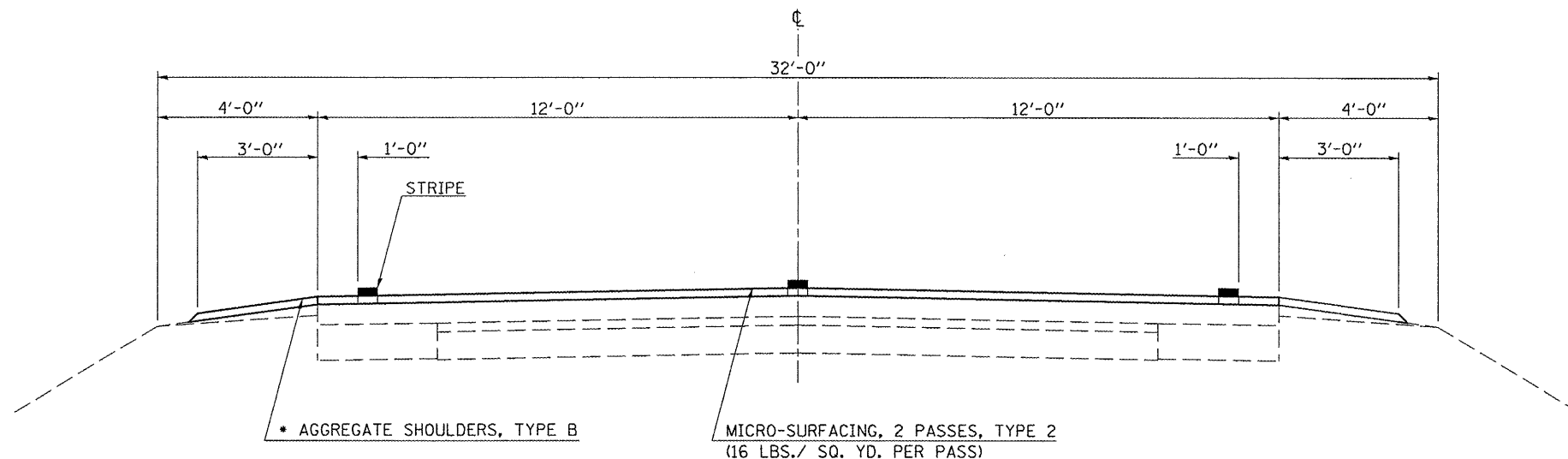

• SHOULDER QUANTITIES WERE FIGURED
 AT 3 FT. WIDE AND 1IN. DEEP

② PROPOSED TYPICAL CROSS SECTION (FAU 7123)

① STATION 155+04.77 TO STATION 182+93.42 ①

BRIDGE OMISSION
 STATION 169+49.17 TO STATION 170+50.83

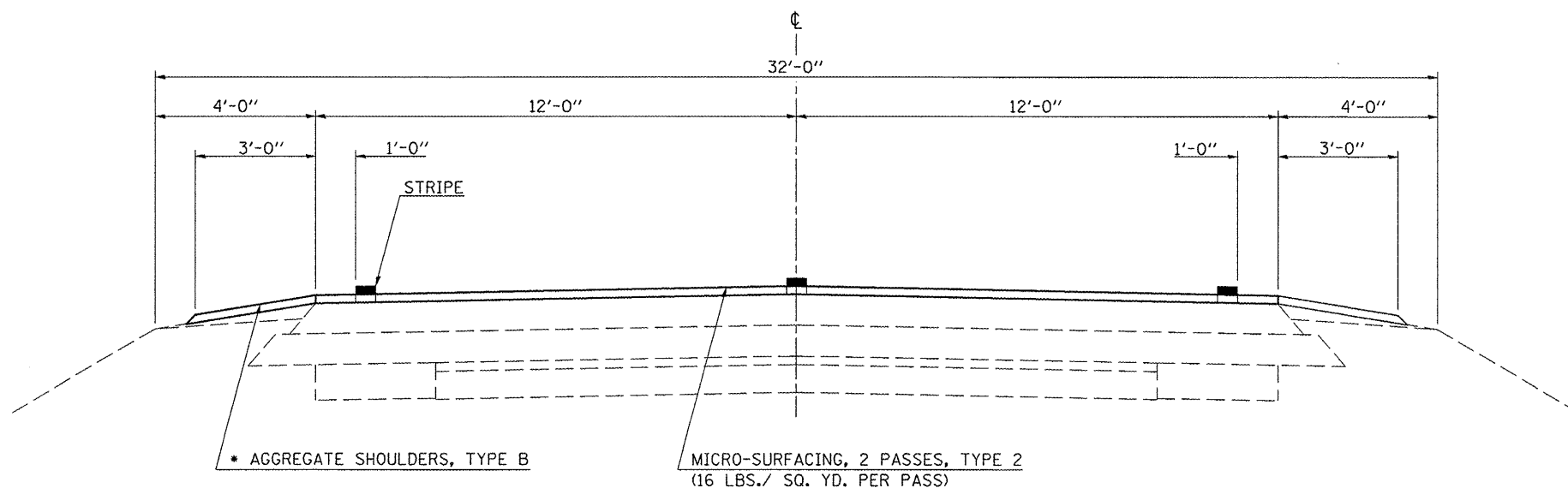

• SHOULDER QUANTITIES WERE FIGURED
 AT 3 FT. WIDE AND 1 IN. DEEP

• FAU 7123 (IL 10)
 FAS 1514 (IL 10)

FILE NAME = c:\projects\0570722\70722plan.dgn	USER NAME = p1ersonbr	DESIGNED - CRG	REVISED -
		DRAWN - BBP	REVISED -
		CHECKED -	REVISED -
		DATE - 03/18/08	REVISED -

**STATE OF ILLINOIS
 DEPARTMENT OF TRANSPORTATION**

PROPOSED TYPICAL CROSS SECTIONS			
SCALE: NONE	SHEET NO. 1 OF 2 SHEETS	STA.	TO STA.

F.A. RTE.	SECTION	COUNTY	TOTAL SHEETS	SHEET NO.
•	09PPP	CHAMPAIGN	13	7
FED. ROAD DIST. NO. [ILLINOIS] FED. AID PROJECT			CONTRACT NO. 70722	

③ PROPOSED TYPICAL CROSS SECTION (FAS 1514)

① STATION 300+19.00 TO STATION 381+99.11

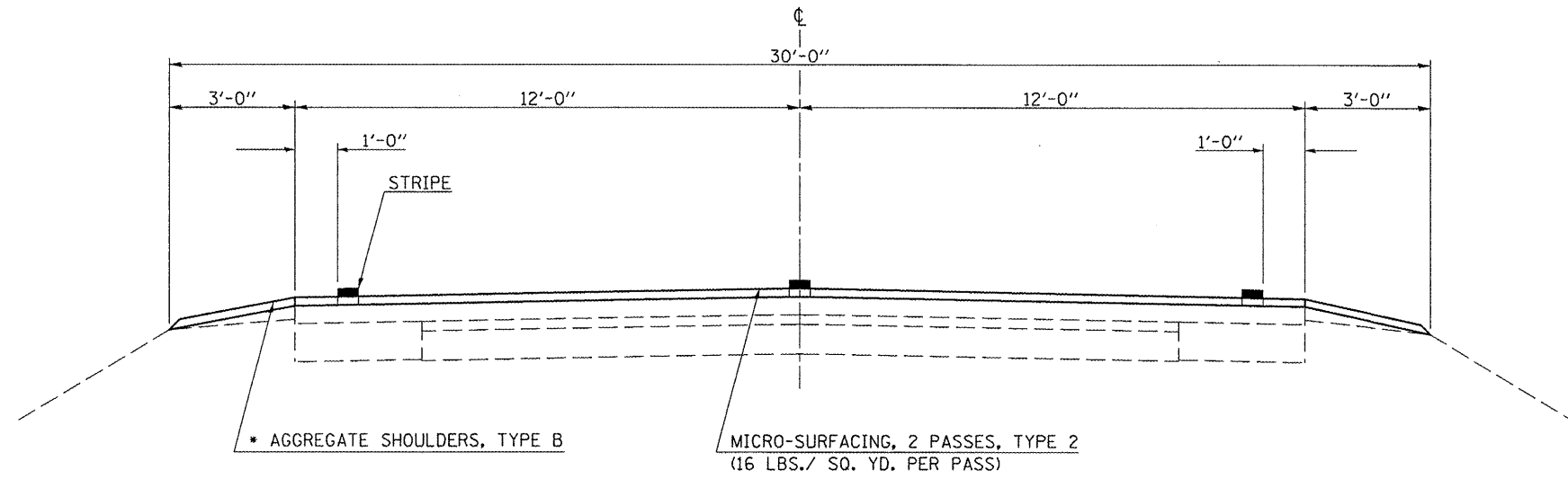

* SHOULDER QUANTITIES WERE FIGURED
AT 3 FT. WIDE AND 1 IN. DEEP

* FAU 7123 (IL 10)
FAS 1514 (IL 10)

FILE NAME - c:\projects\0570722\70722plan.dgn	USER NAME = p1ersonbr	DESIGNED - CRG	REVISED -	STATE OF ILLINOIS DEPARTMENT OF TRANSPORTATION	PROPOSED TYPICAL CROSS SECTIONS			F.A. RTE.	SECTION	COUNTY	TOTAL SHEETS	SHEET NO.
	PLOT SCALE = 40.0000' / IN.	DRAWN - BBP	REVISED -					*	09PPP	CHAMPAIGN	13	8
	PLOT DATE = 3/25/2008	CHECKED -	REVISED -		CONTRACT NO. 70722				FED. ROAD DIST. NO.	ILLINOIS FED. AID PROJECT		
	DATE - 03/18/08	REVISED -	SCALE: NONE		SHEET NO. 2 OF 2 SHEETS	STA.	TO STA.					

SCHEDULE OF QUANTITIES

PAINT PAVEMENT MARKING - LINE 4"

STATION	TO	STATION	SKIP DASH YELLOW (FOOT)	EDGE LINE WHITE (FOOT)
143+33.33		300+19.00	5,150.0	30,915.0
300+19.00		381+99.11	2,730.0	16,360.0
SUB-TOTALS			7,880.0	47,275.0
TOTAL YELLOW			7,880.0	
TOTAL WHITE			47,275.0	
TOTAL QUANTITY			55,155.0	

* FAU 7123 (IL 10)
FAS 1514 (IL 10)

FILE NAME : c:\projects\0570722\70722plan.dgn	USER NAME : ppersonbr	DESIGNED - CRG	REVISED -	STATE OF ILLINOIS DEPARTMENT OF TRANSPORTATION	SCHEDULE OF QUANTITIES	F.A. RTE.	SECTION	COUNTY	TOTAL SHEETS	SHEET NO.		
		DRAWN - BBP	REVISED -			*	09PPP	CHAMPAIGN	13	9		
		PLOT SCALE = 40.0000' / IN.	CHECKED -			CONTRACT NO. 70722						
		PLOT DATE = 3/25/2008	DATE - 03/18/08			REVISED -	SCALE:	SHEET NO.	OF	SHEETS	STA.	TO STA.

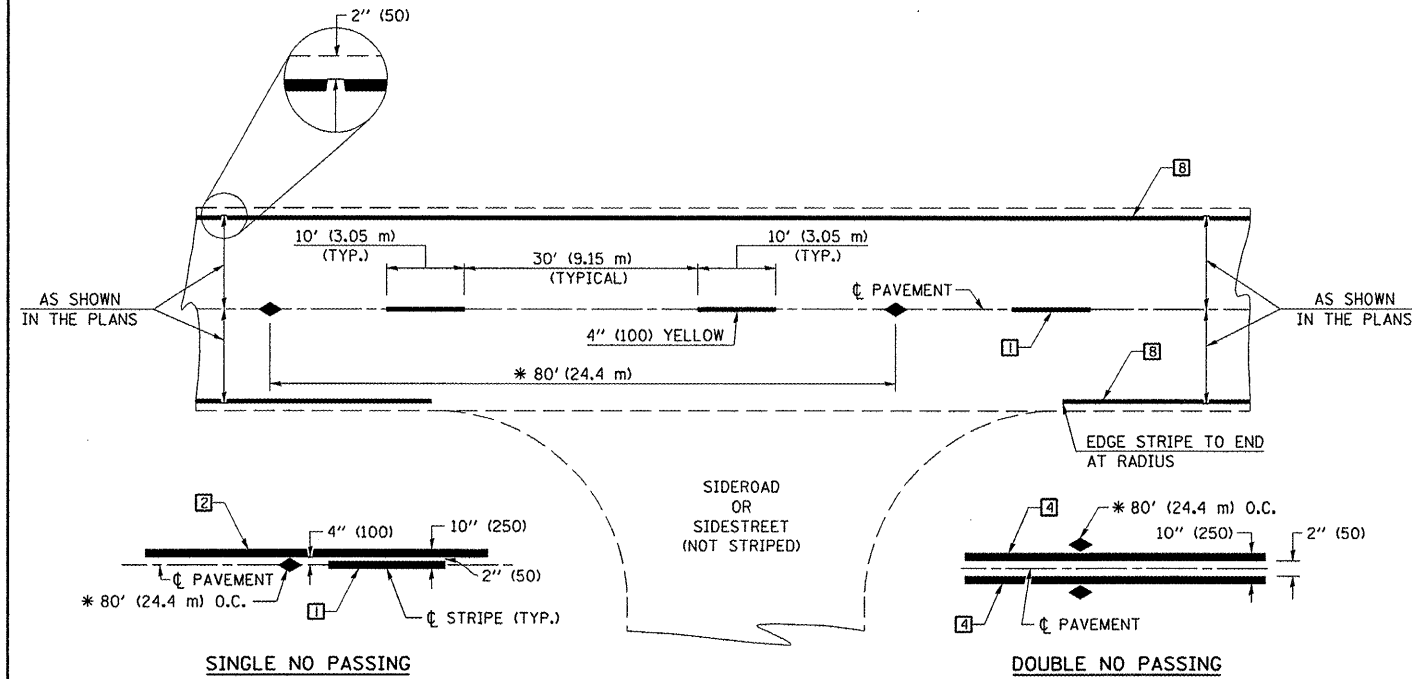

* REDUCE TO 40' (12.2 m) O.C. ON CURVES WITH POSTED OR ADVISORY SPEEDS OF 45 mph (70 km/h) OR LESS.

TWO LANE/TWO WAY

TYPICAL PAVEMENT MARKING LEGEND

- 1 4" (100) SKIP-DASH (YELLOW)
 - 2 4" (100) SOLID (YELLOW)
 - 3 12" (300) DIAGONAL (YELLOW)
 - 4 4" (100) DOUBLE YELLOW (NARROW)
 - 5 RESERVED
 - 6 RESERVED
 - 7 4" (100) SKIP-DASH (WHITE)
 - 8 4" (100) SOLID (WHITE)
 - 9 12" (300) DIAGONAL (WHITE)
 - 10 6" (150) SOLID (WHITE)
 - 11 24" (600) STOP BAR (WHITE)
 - 12 8" (200) SOLID (WHITE)
 - 13 4" (100) LANE LINE EXTENSIONS (WHITE)
 - 14 4" (100) PARKING WHITE
-

TYPICAL PAVEMENT MARKERS LEGEND

- ◆ TWO-WAY AMBER MARKER
- ▶ ONE-WAY AMBER MARKER
- ▷ ONE-WAY CRYSTAL MARKER

RURAL LEFT TURN

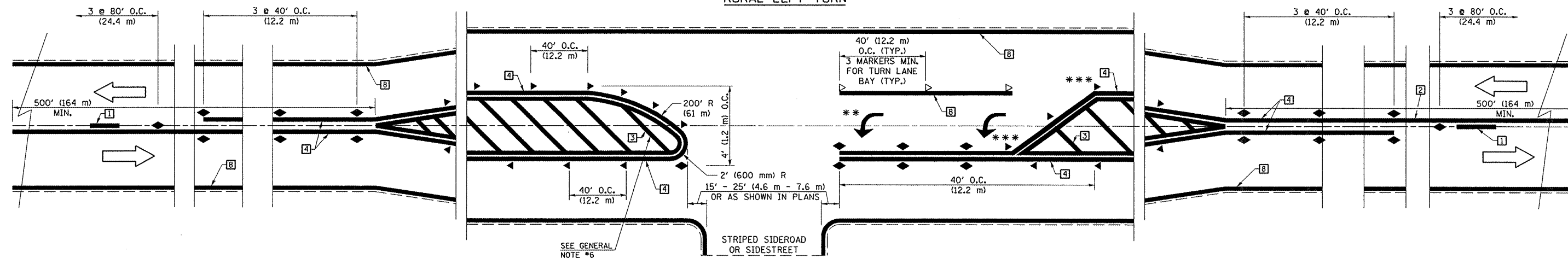

*** REDUCE SPACING IF NECESSARY TO ASSURE MARKERS AT CORNER POINTS.

** TURN ARROWS SHALL BE PLACED AS SHOWN ON SHEET #2.

Note: All dimensions are in INCHES (millimeters) unless otherwise shown.

• FAU 7123 (IL 10)
FAS 1514 (IL 10)

FILE NAME = c:\projects\4570722\70722plan.dgn	USER NAME = piersonbr	DESIGNED - DRAWN - CHECKED - DATE -	REVISED - REVISED - REVISED - REVISED -	11/06
--	--------------------------	--	--	-------

**STATE OF ILLINOIS
DEPARTMENT OF TRANSPORTATION**

**PAVEMENT MARKING AND MARKERS
(RURAL & URBAN APPLICATIONS)**

SCALE: SHEET NO. 1 OF 4 SHEETS STA. TO STA.

DISTRICT 5 DETAIL NO. 7800AAAA

F.A. RTE.	SECTION	COUNTY	TOTAL SHEETS	SHEET NO.
•	O9PPP	CHAMPAIGN	13	10
CONTRACT NO. 70722				
FED. ROAD DIST. NO.	ILLINOIS FED. AID PROJECT			

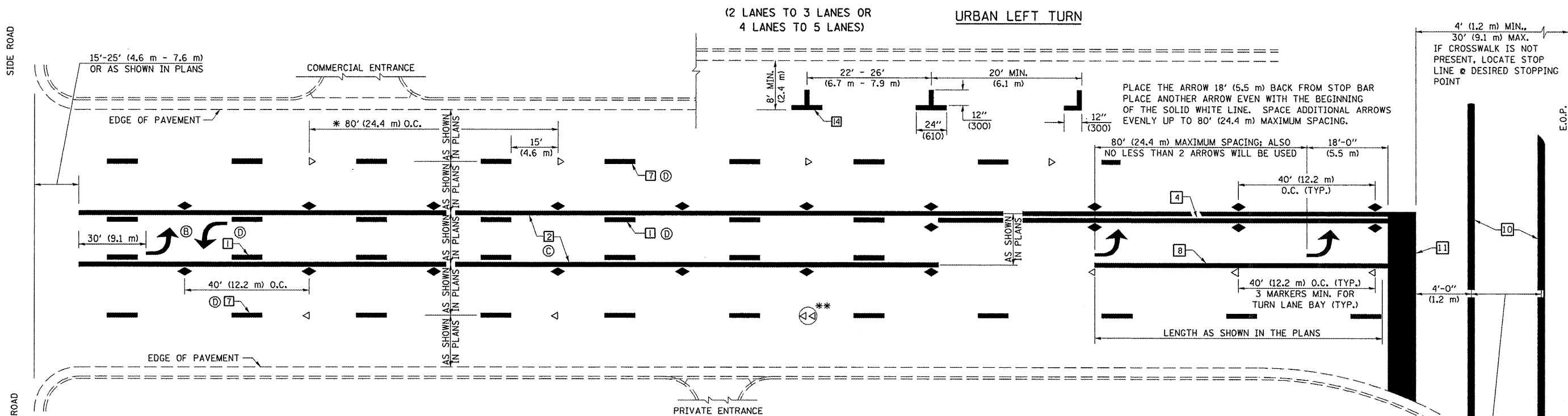

* REDUCE TO 40 FEET (12.2 METERS) ON CURVES WHERE ADVISORY SPEEDS ARE 10 MPH (15 km/h) LOWER THAN POSTED SPEEDS.

** DOUBLE LANE LINE MARKERS SHALL BE SPECIFIED AND SPACED AS SHOWN IN HIGHWAY STANDARD 781001 FOR MULTI-LANE DIVIDED AND UNDIVIDED HIGHWAYS.

- GENERAL NOTES:**
- (B) TURN ARROW PAIRS SHALL BE PLACED AT 250' (75 m) INTERVALS AND SHALL BE EVENLY SPACED BETWEEN BOTH ENDS OF THE BIDIRECTIONAL LEFT TURN LANE.
 - (C) THE SOLID YELLOW PAVEMENT MARKINGS (2) SHOULD GENERALLY START OR END NEAR THE RADIUS POINT OF EACH STREET RETURN EXCEPT WHERE ONE OR BOTH ENDS WOULD INCLUDE STOP BARS.
 - (D) THE SKIP-DASH PAVEMENT MARKINGS (1) OR (7) SHOULD BE CENTERED BETWEEN BOTH ENDS OF EACH CITY BLOCK AND SHALL BE PLACED SO THEY LINE UP ACROSS FROM EACH OTHER. SEE EXAMPLE ON SHEET 2 OF 3.
 - (E) USE LARGE ARROW SIZE FOR BOTH RURAL AND URBAN LOCATIONS. (SEE LAST PAGE OF SECTION 780x FOR SYMBOLS TABLE)

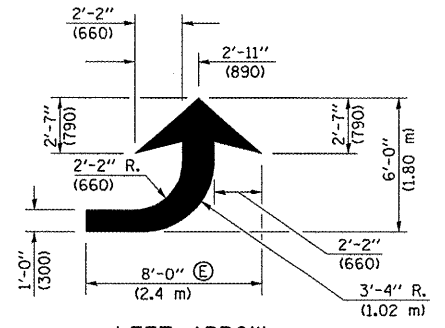

LEFT ARROW
 REVERSE FOR RIGHT ARROW
 AREA = 15.6 SQ. FT. (1.47 m²)
 (WHITE)

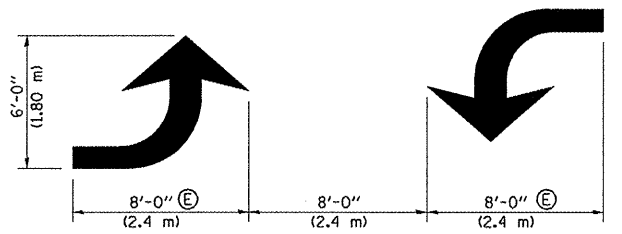

TYPICAL DOUBLE TURN ARROWS (WHITE)

BLOOMINGTON-NORMAL CITY LIMITS ONLY

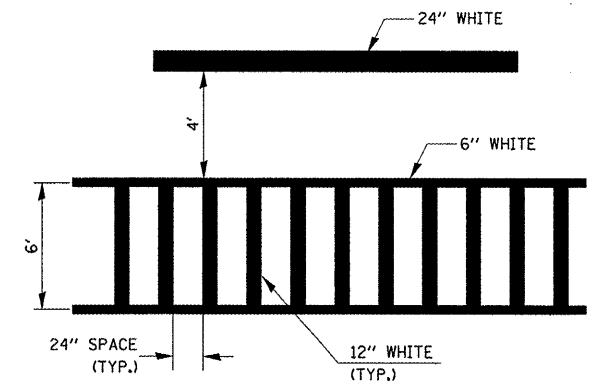

TYPICAL SPACING FOR CROSSWALKS & STOP BARS

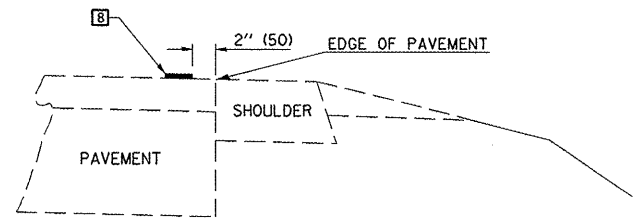

RELATIONSHIP OF EDGE LINE TO EDGE OF PAVEMENT
 (SAFETY SHOULDER OR PAVED SURFACE)
 SEE ARTICLE 780.04

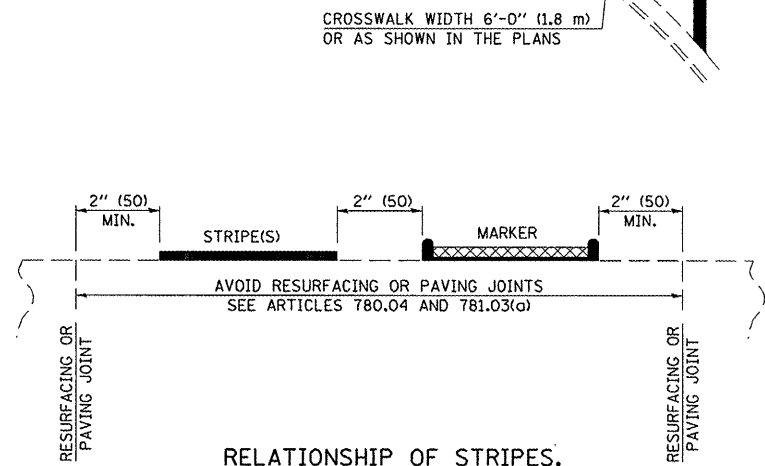

RELATIONSHIP OF STRIPES, MARKERS AND JOINTS

Note: All dimensions are in INCHES (millimeters) unless otherwise shown.

• FAU 7123 (IL 10)
 FAS 1514 (IL 10)

DISTRICT 5 DETAIL NO. 7800AAAA

FILE NAME : c:\projects\780722\78722plan.dgn	USER NAME : p1ersonbr	DESIGNED -	REVISED - 11/06
		DRAWN -	REVISED -
		CHECKED -	REVISED -
		DATE -	REVISED -

**STATE OF ILLINOIS
 DEPARTMENT OF TRANSPORTATION**

**PAVEMENT MARKING AND MARKERS
 (RURAL & URBAN APPLICATIONS)**

SCALE: SHEET NO. 2 OF 4 SHEETS STA. TO STA.

F.A. RTE.	SECTION	COUNTY	TOTAL SHEETS	SHEET NO.
*	09PPP	CHAMPAIGN	13	11
FED. ROAD DIST. NO. ILLINOIS FED. AID PROJECT			CONTRACT NO. 70722	

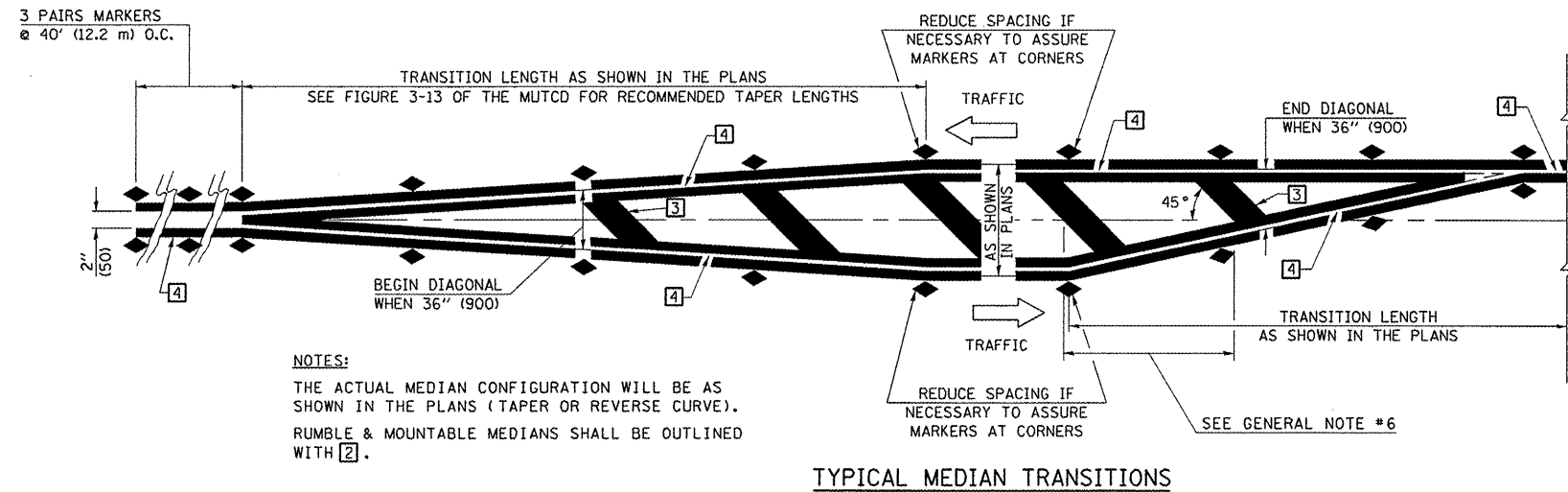

NOTES:
 THE ACTUAL MEDIAN CONFIGURATION WILL BE AS SHOWN IN THE PLANS (TAPER OR REVERSE CURVE).
 RUMBLE & MOUNTABLE MEDIANS SHALL BE OUTLINED WITH [2].

TYPICAL MEDIAN TRANSITIONS

GENERAL NOTES

1. WHEN MEDIANS ARE PRESENT, PAVEMENT MARKINGS ARE TO BE PLACED ADJACENT TO MEDIANS.
2. SOME OF THE INFORMATION INCLUDED WITH THIS DETAIL MAY NOT BE APPLICABLE TO THIS IMPROVEMENT.
3. PAVEMENT MARKINGS ARE TO BE EXTENDED THROUGH OMISSIONS WHEN APPLICABLE.
4. A STRIPING KEY IS AVAILABLE ELSEWHERE AND SHALL BE SHOWN WHERE THE QUANTITIES ARE LISTED.
5. FINAL PAVEMENT MARKINGS SHALL BE IN PLACE PRIOR TO PLACING ANY RAISED REFLECTIVE PAVEMENT MARKERS.
6. THE FOLLOWING CRITERIA SHALL BE USED FOR SELECTING THE DIAGONAL PAVEMENT MARKING SPACING,
 < 30 MPH USE 15' (< 50 km/h USE 4.5 m)
 30-45 MPH USE 20' (50-75 km/h USE 6.0 m)
 > 45 MPH USE 30' (> 75 km/h USE 9.0 m)

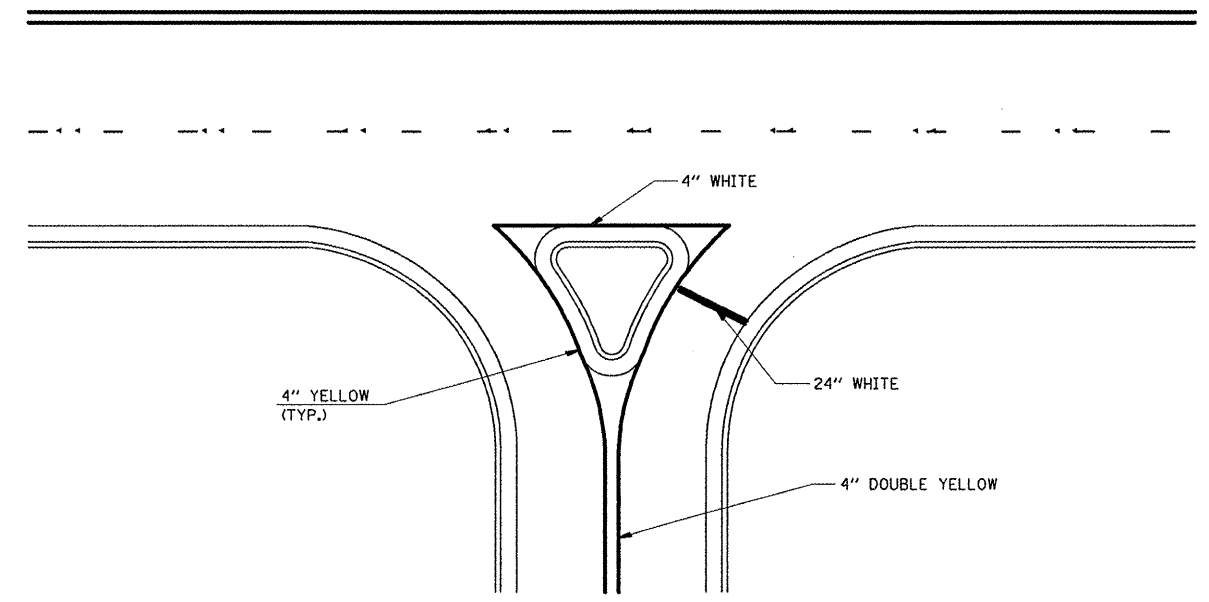

RIGHT IN - RIGHT OUT ACCESS

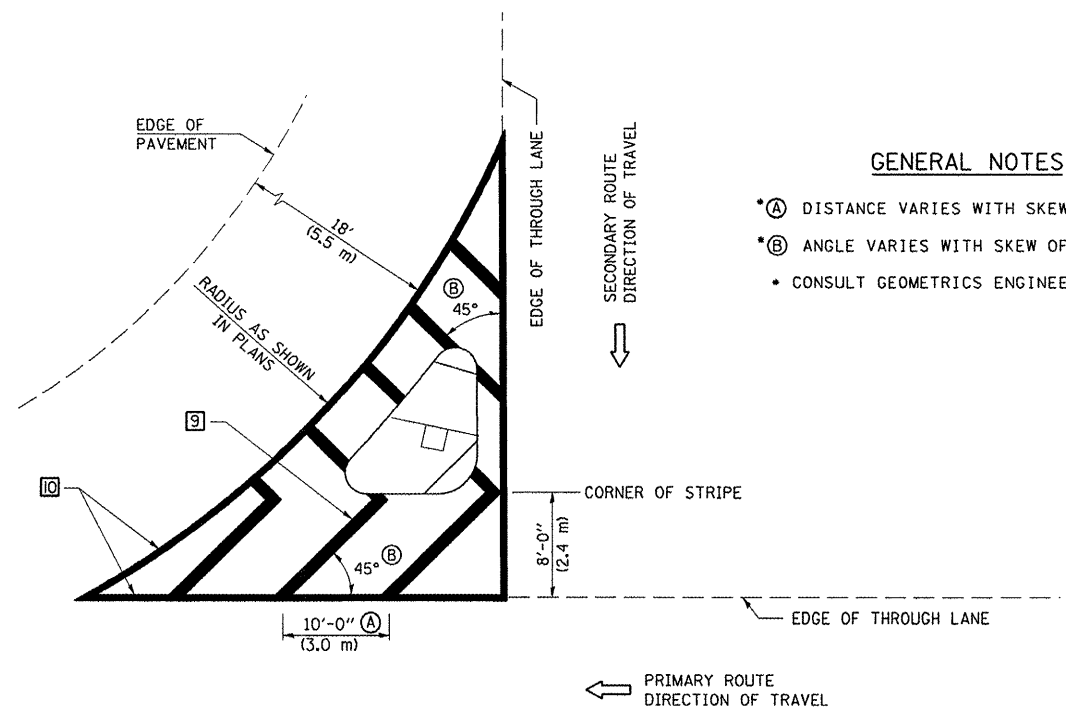

GENERAL NOTES

- (A) DISTANCE VARIES WITH SKEW OF INTERSECTION.
- (B) ANGLE VARIES WITH SKEW OF INTERSECTION.
- CONSULT GEOMETRICS ENGINEER

ISLAND

Note: All dimensions are in INCHES (millimeters) unless otherwise shown.

• FAU 7123 (IL 10)
 FAS 1514 (IL 10)

DISTRICT 5 DETAIL NO. 7800AAAA

FILE NAME = c:\projects\d570722\70722plan.dgn	USER NAME = piersonbr	DESIGNED -	REVISED - 11/06
		DRAWN -	REVISED -
	PLOT SCALE = 40,0000' / IN.	CHECKED -	REVISED -
	PLOT DATE = 3/25/2008	DATE -	REVISED -

**STATE OF ILLINOIS
 DEPARTMENT OF TRANSPORTATION**

**PAVEMENT MARKING AND MARKERS
 (RURAL & URBAN APPLICATIONS)**

SCALE: SHEET NO. 3 OF 4 SHEETS STA. TO STA.

F.A. RTE.	SECTION	COUNTY	TOTAL SHEETS	SHEET NO.
•	09PPP	CHAMPAIGN	13	12
CONTRACT NO. 70722				
FED. ROAD DIST. NO. ILLINOIS FED. AID PROJECT				

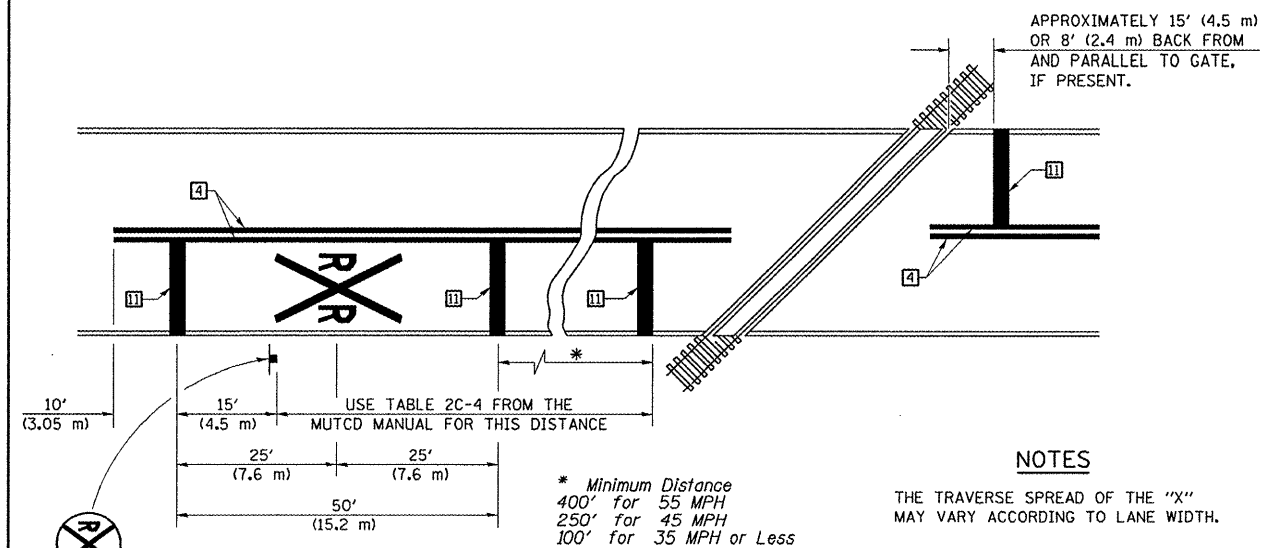

PAVEMENT MARKINGS AT RAILROAD-HIGHWAY GRADE CROSSING

NOTES

THE TRAVERSE SPREAD OF THE "X" MAY VARY ACCORDING TO LANE WIDTH.

ON MULTI-LANE ROADS, THE STOP LINES SHALL EXTEND ACROSS ALL APPROACH LANES AND SEPARATE RXR SYMBOLS SHALL BE PLACED ADJACENT TO EACH OTHER IN EACH LANE.

WHEN THE PAVEMENT MARKING SYMBOL IS USED, A PORTION OF THE SYMBOL SHOULD BE LOCATED DIRECTLY ADJACENT TO THE ADVANCE WARNING SIGN (W10-1) AS PLACED BY TABLE II-1, CONDITION B OF THE MUTCD.

RAILROAD CROSSING WITH INTERCONNECT ONLY

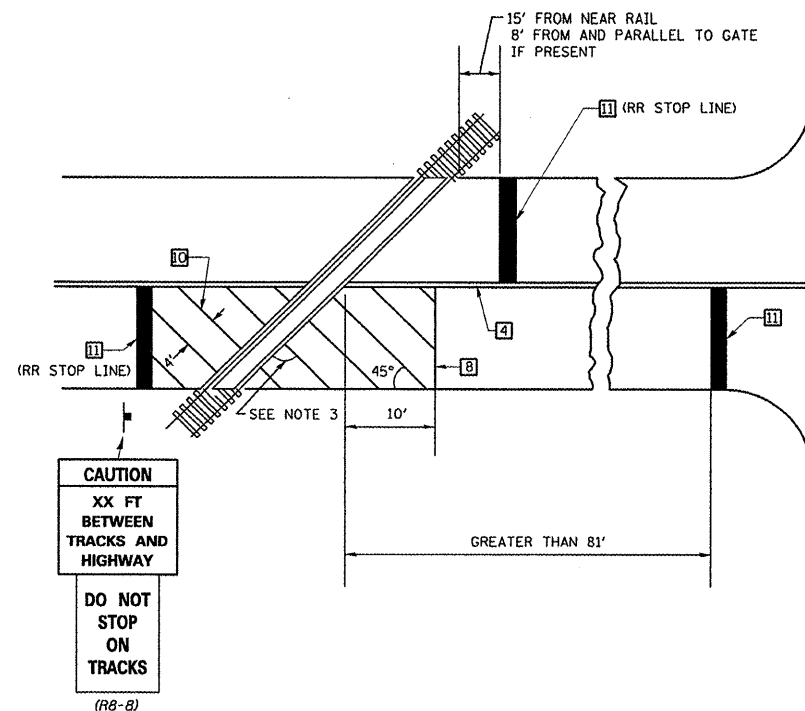

RAILROAD CROSSING WITH INTERCONNECT AND PRE-SIGNALS

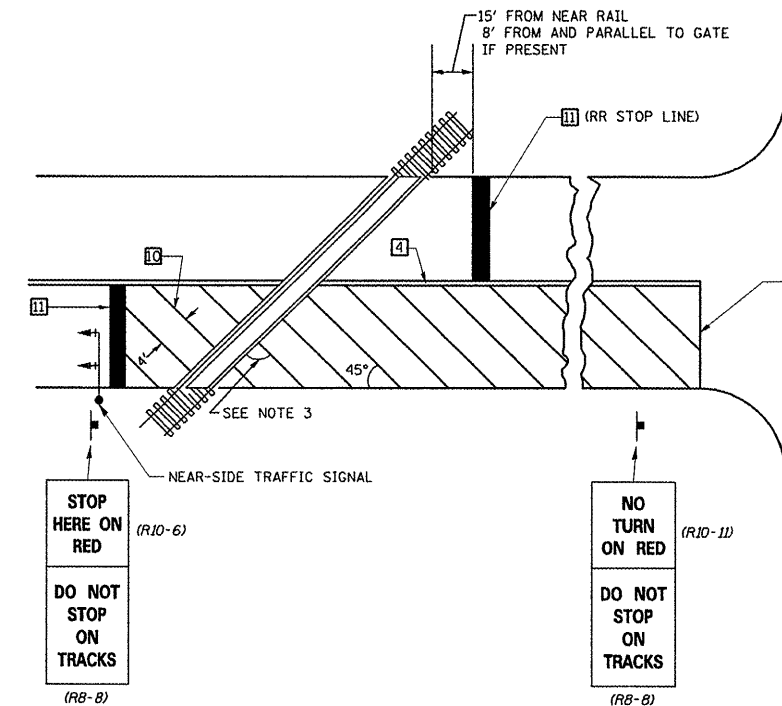

SUPPLEMENTAL PAVEMENT MARKING TREATMENT FOR RAILROAD-HIGHWAY GRADE CROSSING

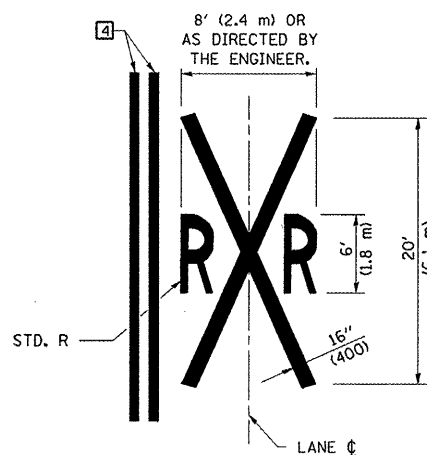

GENERAL NOTES

- SUPPLEMENTAL PAVEMENT MARKINGS TO BE INSTALLED ONLY ON APPROACHES TO INTERSECTIONS CONTROLLED BY TRAFFIC SIGNALS WHICH ARE INTERCONNECTED WITH THE RAILROAD WARNING SIGNALS.
- EXTEND PAVEMENT MARKINGS TO THE INTERSECTION ONLY WHERE NEAR-SIDE TRAFFIC SIGNALS ARE USED.
- WHERE THE ANGLE BETWEEN THE DIAGONAL PAVEMENT MARKINGS AND THE TRACK WOULD BE LESS THAN 20°, THE PAVEMENT MARKINGS SHOULD BE PLACED IN THE OPPOSITE DIRECTION FROM THAT SHOWN.

Note: All dimensions are in INCHES (millimeters) unless otherwise shown.

• FAU 7123 (IL 10)
FAS 1514 (IL 10)

DISTRICT 5 DETAIL NO. 7800AAA

FILE NAME : c:\projects\4570722\70722plan.dgn	USER NAME : piersonbr	DESIGNED -	REVISED - 11/06
		DRAWN -	REVISED -
		CHECKED -	REVISED -
		DATE -	REVISED -

STATE OF ILLINOIS DEPARTMENT OF TRANSPORTATION

PAVEMENT MARKING AND MARKERS (RURAL & URBAN APPLICATIONS)

SCALE: SHEET NO. 4 OF 4 SHEETS STA. TO STA.

F.A. RTE.	SECTION	COUNTY	TOTAL SHEETS	SHEET NO.
	09PPP	CHAMPAIGN	13	13
CONTRACT NO. 70722				
FED. ROAD DIST. NO. ILLINOIS FED. AID PROJECT				