

F.A.I. RTE.	SECTION	COUNTY	TOTAL SHEETS	SHEET NO.
72	(84-9)RS-6; (G)Z	SANGAMON	425	32
STA.		TO STA.		
FED. ROAD DIST. NO.	ILLINOIS	FED. AID PROJECT		

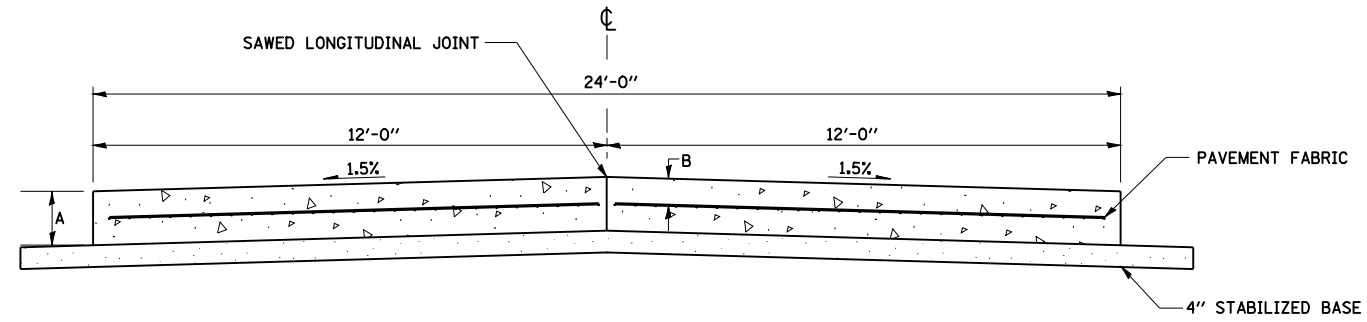

**CROSS-SECTION OF EXISTING PCC PAVEMENT**

LOCATION	A	B
WB I-72 STA 553+65.00 TO 569+00.00	7"	2 1/4"
WB I-72 STA 569+00.00 TO 581+00.00	7"	3 1/2"
WB I-72 STA 581+00.00 TO 607+13.44	7"	2 1/4"
EB I-72 STA 553+65.00 TO 569+00.00	8"	4"
EB I-72 STA 569+00.00 TO 581+00.00	8"	2 1/4"
EB I-72 STA 581+00.00 TO 606+65.59	8"	4"

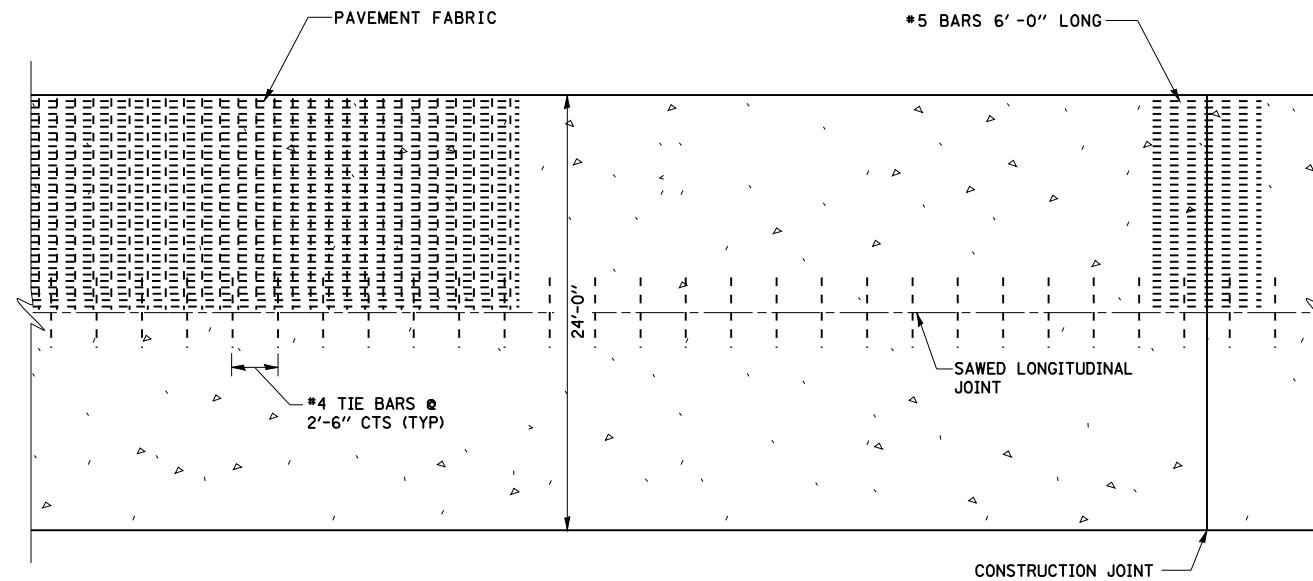

**PLAN OF EXISTING PCC PAVEMENT**

REVISIONS	
NAME	DATE

ILLINOIS DEPARTMENT OF TRANSPORTATION  
 EXISTING PAVEMENT REINFORCEMENT  
 FAI 72  
 SECTION (84-9)RS-6; (G)Z  
 SANGAMON COUNTY

SCALE: VERT. \_\_\_\_\_  
 HORIZ. \_\_\_\_\_  
 DATE \_\_\_\_\_ DRAWN BY \_\_\_\_\_  
 CHECKED BY \_\_\_\_\_

PLOT DATE = Mar-19-2008 11:27:36AM  
 FILE NAME = C:\Projects\4855582\4855582.dgn  
 PLOT SCALE = 1/8" = 1'-0" / IN.  
 USER NAME = laughlin-1