

FAU ROUTE	SECTION	COUNTY	TOTAL SHEETS	SHEET NO.
8071	*	SANGAMON	425	162
STA. 8071		TO STA. 8072		
FED. ROAD DIST. NO.		ILLINOIS FED. AID PROJECT		
(84-9) RS-6; IGIZ *				

THE PRIOR GRADING & STRUCTURES CONTRACT INCLUDED ALL CULVERT REMOVALS, FILLING OF EXISTING CULVERTS, PLACEMENT OF RIPRAP AND PIPE CULVERTS UNLESS NOTED OTHERWISE.

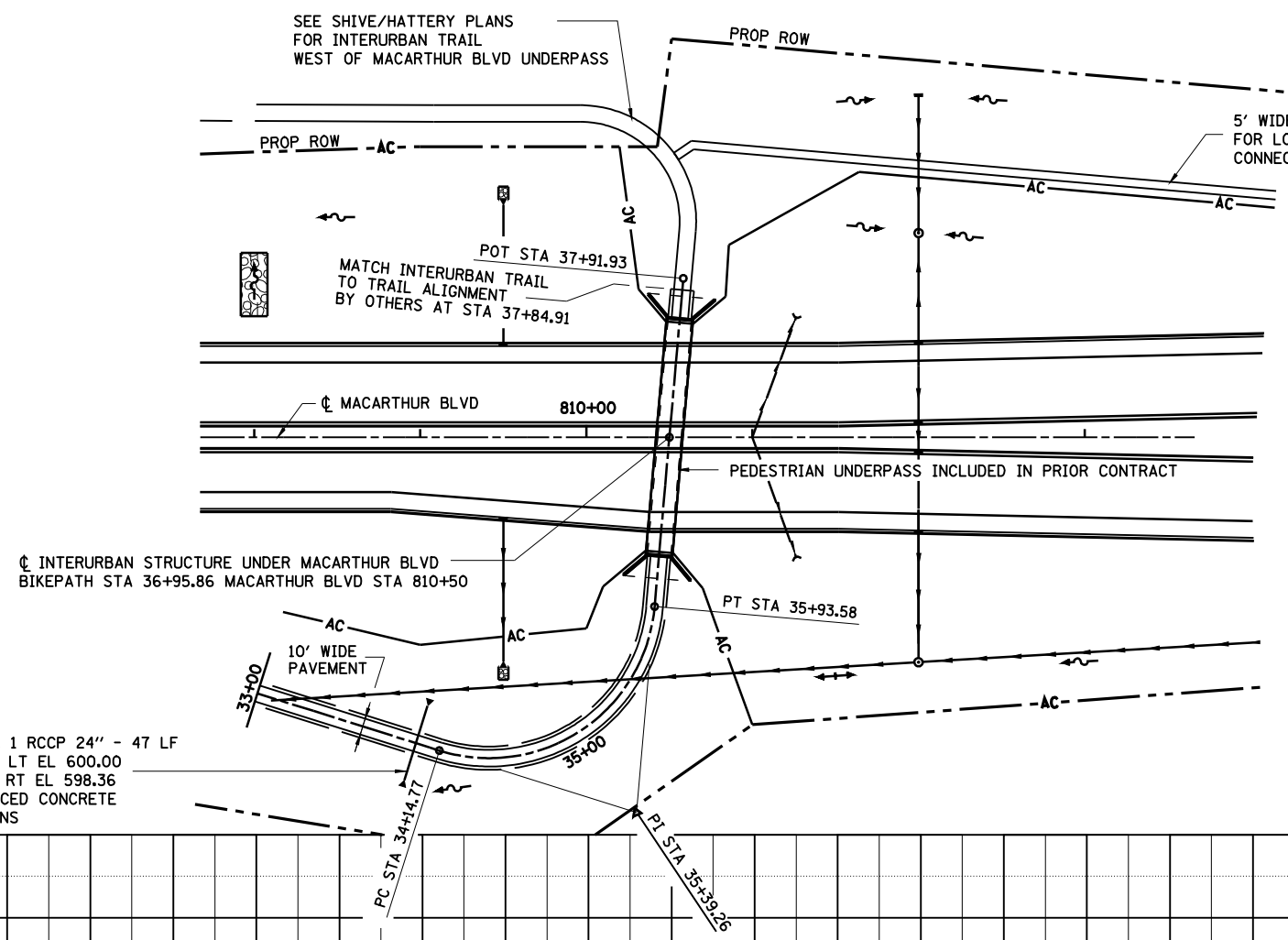

PROP. CURVE IUT-5
 PI STA. = 35+39.26
 $\Delta = 102^\circ 27' 00''$ (LT)
 D = 57' 17" 45"
 R = 100.00'
 T = 124.49'
 L = 178.81'
 E = 59.68'
 $\theta =$ -----
 T.R. = -----
 S.E. RUN = -----
 P.C. STA. = 34+14.77
 P.T. STA. = 35+93.58

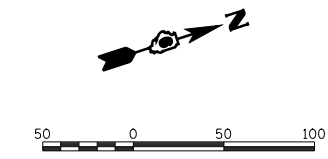

PIPE CULVERT TYPE 1 RCCP 24" - 47 LF
 USFL 34+00.00, 28' LT EL 600.00
 DSFL 34+00.00, 31' RT EL 598.36
 2 PRECAST REINFORCED CONCRETE FLARED END SECTIONS

NOTE: EMBANKMENT/SUBGRADE CONSTRUCTED IN THE PRIOR GRADING & STRUCTURES CONTRACT TO APPROXIMATELY 6" BELOW PROPOSED PROFILE.

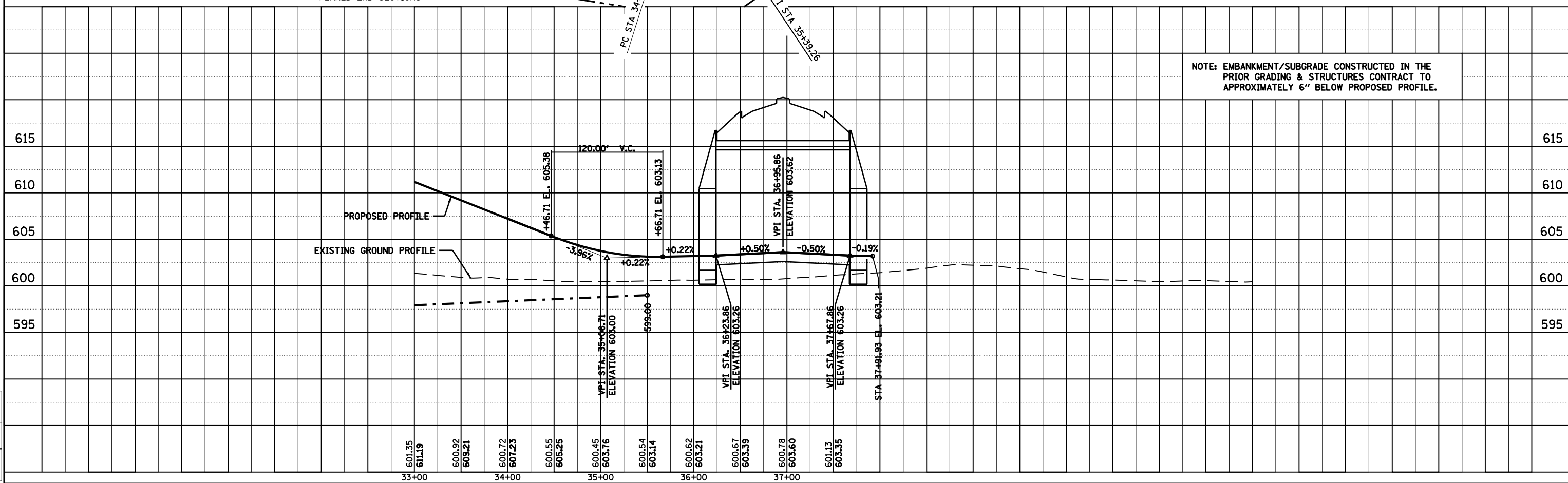

PLAN	DATE
BY	
CHECKED	
DATE	



PROFILE	DATE
BY	
CHECKED	
DATE	

LAYOUT	DATE
BY	
CHECKED	
DATE	