

FAU ROUTE	SECTION	COUNTY	TOTAL SHEETS	SHEET NO.
8071	*	SANGAMON	425	167
STA.		TO STA.		
FED. ROAD DIST. NO.		ILLINOIS	FED. AID PROJECT	
(84-9) RS-6; (G)Z *				

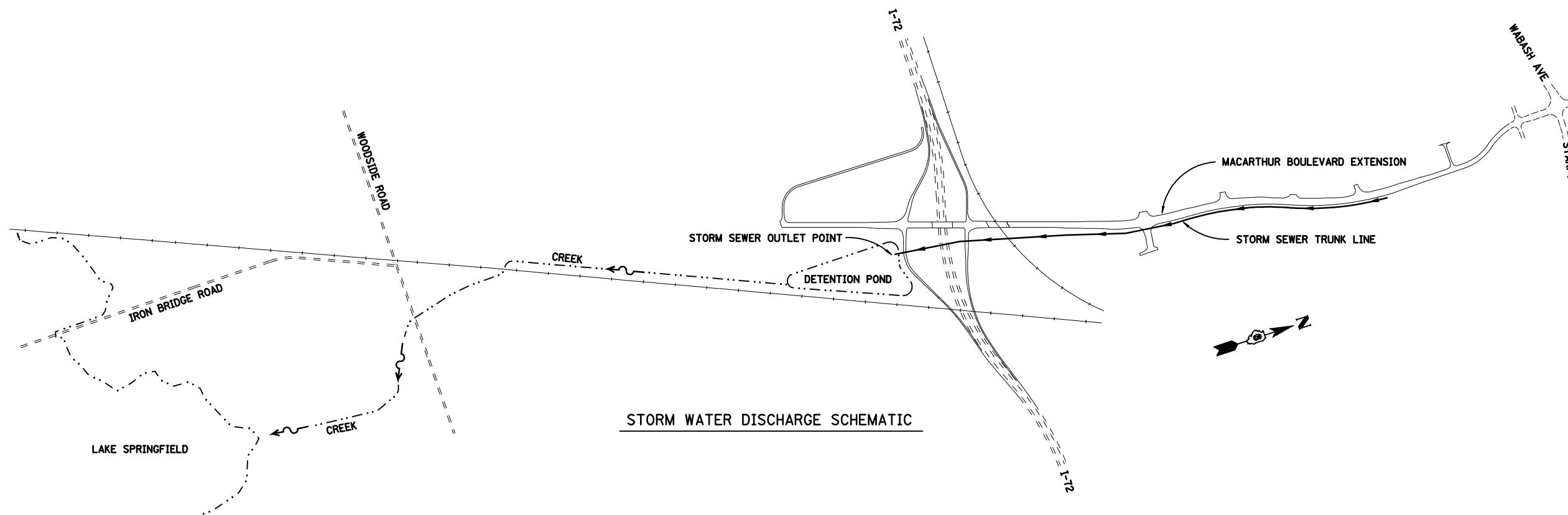

STORM WATER DISCHARGE SCHEMATIC

TEMPORARY EROSION CONTROL NOTES

GENERAL

1. THE EROSION CONTROL PLANS ARE INCLUDED TO DIRECT THE CONTRACTOR IN THE PLACEMENT OF THE TEMPORARY EROSION CONTROL SYSTEMS.
2. PLACEMENT AND MAINTENANCE OF TEMPORARY EROSION CONTROL SYSTEMS WILL BE UTILIZED THROUGHOUT THE CONSTRUCTION WORK ZONE AS SOON AS POSSIBLE TO STABILIZE EXPOSED SOILS AND PREVENT ON-SITE DAMAGE. THIS WORK MAY BE CONSTRUCTED OF HAY OR STRAW BALES, SILT FILTER FENCE, SEEDING, OR OTHER APPROPRIATE METHODS AND MATERIALS, SEPARATELY OR IN COMBINATION AS APPROVED BY THE RESIDENT ENGINEER.
3. EROSION CONTROL DEVICES SHALL BE IN PLACE AND APPROVED BY THE RESIDENT ENGINEER AS TO PROPER PLACEMENT AND INSTALLATION PRIOR TO BEGINNING OTHER WORK.
4. THE CONTRACTOR SHALL PLACE PERMANENT SEEDING WITHIN A REASONABLE AMOUNT OF TIME.
5. THE RESIDENT ENGINEER WILL DETERMINE WHEN TEMPORARY EROSION CONTROL SYSTEMS SHOWN ON THE PLAN MAY BE MOVED TO A DIFFERENT LOCATION OR DELETED.
6. THE WORK SHALL BE COMPLETED IN ACCORDANCE WITH SECTION 280-TEMPORARY EROSION CONTROL OF THE STANDARD SPECIFICATIONS FOR ROAD AND BRIDGE CONSTRUCTION.
7. THE CONTRACTOR SHALL PERFORM ALL WORK AS DIRECTED BY THE RESIDENT ENGINEER AND AS SHOWN IN STANDARD 280001.

8. TEMPORARY EROSION CONTROL SYSTEMS ARE NOTED ON THE EROSION CONTROL PLAN SHEETS. THE PLAN MAY INCLUDE THE FOLLOWING:

- TEMPORARY DITCH CHECKS
- PERIMETER EROSION BARRIER
- INLET AND PIPE PROTECTION
- TEMPORARY EROSION CONTROL SEEDING
- HEAVY DUTY EXCELSIOR BLANKET

9. THE EROSION CONTROL PLANS INCLUDE WEEKLY INSPECTIONS TO BE COMPLETED BY THE CONTRACTOR AND RESIDENT ENGINEER.

PRIOR TO CONSTRUCTION

10. PRIOR TO PERFORMING CONSTRUCTION ACTIVITIES RESULTING IN LAND DISTURBANCE, THE CONTRACTOR SHALL INSTALL ITEMS (IF SPECIFIED ON THE PLANS OR AS DIRECTED BY THE RESIDENT ENGINEER) INTENDED TO PREVENT SEDIMENT FROM LEAVING THE CONSTRUCTION SITE. THE ITEMS MAY INCLUDE THE FOLLOWING TEMPORARY EROSION CONTROL SYSTEMS:

- TEMPORARY DITCH CHECKS
- INLET AND PIPE PROTECTION
- PERIMETER EROSION BARRIER

11. ALL SIDE SLOPES ARE 4:1 UNLESS OTHERWISE NOTED.

DURING CONSTRUCTION

1. DURING CONSTRUCTION, THE CONTRACTOR SHALL:

- CLEAN UP AND GRADE THE WORK AREA TO ELIMINATE CONCENTRATION OF RUNOFF.
 - INSTALL TEMPORARY DITCH CHECKS AT LOCATIONS SPECIFIED IN THE PLANS OR AS DIRECTED BY THE RESIDENT ENGINEER.
 - INSTALL INLET AND PIPE PROTECTION AT LOCATIONS SPECIFIED IN THE PLANS OR AS DIRECTED BY THE RESIDENT ENGINEER FOR CULVERTS AND INLETS AS THEY ARE INSTALLED AND AS WORK PROCEEDS.
 - INSTALL PERIMETER EROSION BARRIER AT LOCATIONS SPECIFIED ON THE PLANS OR AS DIRECTED BY THE RESIDENT ENGINEER.
 - COVER THE OPEN ENDS OF PIPES IN TRENCHES AT THE CLOSE OF EACH WORKING DAY.
 - PERFORM TEMPORARY EROSION CONTROL SEEDING AS SPECIFIED IN ARTICLE 280.04(f) OF THE STANDARD SPECIFICATIONS FOR ROAD AND BRIDGE CONSTRUCTION OR AS DIRECTED BY THE RESIDENT ENGINEER.
2. THE CONTRACTOR SHALL MAINTAIN OR REPLACE (IF SPECIFIED BY THE RESIDENT ENGINEER) SEDIMENT CONTROL ITEMS.
- THE TEMPORARY EROSION CONTROL SYSTEMS INSTALLED BY THE CONTRACTOR SHALL BE PROPERLY MAINTAINED AS DIRECTED BY THE RESIDENT ENGINEER TO CONTROL SILTATION AT ALL TIMES DURING THE LIFE OF THE CONTRACT. THIS WORK SHALL INCLUDE REPAIR OF THE VARIOUS SYSTEMS, REMOVAL OF TRAPPED SEDIMENT AND CLEANING OF ANY SILT FILTER FABRIC AND HAY OR STRAW BALES.

-IF THE CONTRACTOR FAILS TO MAINTAIN THE TEMPORARY EROSION CONTROL SYSTEMS AS DIRECTED BY THE RESIDENT ENGINEER, THE RESIDENT ENGINEER MAY AT THE EXPIRATION OF A PERIOD OF 48 HOURS, AFTER HAVING GIVEN THE CONTRACTOR WRITTEN NOTICE, PROCEED TO MAINTAIN THE SYSTEMS AS DEEMED NECESSARY, AND THE COST THEREOF WILL BE DEDUCTED FROM ANY COMPENSATION DUE, OR WHICH MAY BECOME DUE TO THE CONTRACTOR UNDER THIS CONTRACT.

PRIOR TO LANDSCAPING/RESTORATION

1. IMMEDIATELY PRIOR TO LANDSCAPING/RESTORATION WORK, THE CONTRACTOR SHALL:

- REMOVE AND DISPOSE OF SILT RETAINED BY THE TEMPORARY DITCH CHECKS, REINSTALL THE TEMPORARY DITCH CHECKS AFTER CLEANING, AND REMOVE AND REPLACE PLUGGED OR DAMAGED HAY OR STRAW BALES.
- REMOVE AND DISPOSE OF SILT RETAINED BY THE PERIMETER EROSION BARRIER, REINSTALL THE PERIMETER EROSION BARRIER AFTER CLEANING, AND REMOVE AND REPLACE PLUGGED OR DAMAGED SILT FILTER FENCE.

FOLLOWING LANDSCAPING/RESTORATION

1. AFTER LANDSCAPING/RESTORATION WORK, THE CONTRACTOR SHALL MAINTAIN OR REPLACE (IF SPECIFIED BY THE RESIDENT ENGINEER) SEDIMENT CONTROL ITEMS.

VEGETATION ESTABLISHED

1. AFTER THE VEGETATION IS ESTABLISHED IN THE DISTURBED AREA, THE CONTRACTOR SHALL:

- REMOVE THE REMAINING SEDIMENT CONTROL ITEMS AS DIRECTED BY THE RESIDENT ENGINEER.
- RESTORE THE AREAS DISTURBED BY THE SEDIMENT CONTROL ITEMS BY PERMANENT SEEDING AND MULCHING.

REVISIONS	
NAME	DATE

ILLINOIS DEPARTMENT OF TRANSPORTATION
 EROSION CONTROL NOTES AND
 DISCHARGE SCHEMATIC
 SECTION
 (84-9) RS-6; (G)Z
 SANGAMON COUNTY, ILLINOIS

SCALE: VERT. _____
 HORIZ. _____
 DATE: Mar-20-2008 08:37:27AM
 DRAWN BY: CLG
 CHECKED BY: JWM



LAYOUT	CLG	09/17/07
DRAWN	CLG	09/17/07
REVIEWED	JWM	09/17/07