

FAU ROUTE	SECTION	COUNTY	TOTAL SHEETS	SHEET NO.
8071	*	SANGAMON	425	185
STA.		TO STA.		
FED. ROAD DIST. NO.	ILLINOIS	FED. AID PROJECT		
(84-9) RS-6; (G)Z *				

LINDBERGH BLVD AT MACARTHUR BLVD						
STATION	OFFSET	CL OR #	NORTHING	EASTING	ELEVATION	
AA	841+15.60	-45.00	MAC	1124616.894	2436739.684	609.23
AB	841+37.93	-46.09	MAC	1124638.392	2436746.697	609.14
AC	841+60.41	-49.41	MAC	1124660.812	2436751.807	609.01
AD	841+82.45	-54.93	MAC	1124683.607	2436754.835	608.83
AE	600+63.09	-89.23	LIND	1124706.201	2436755.758	608.57
AF	842+10.52	-45.00	MAC	1124706.284	2436774.606	608.95
AG	600+76.73	-67.15	LIND	1124731.747	2436751.153	608.05
AH	600+84.82	-59.33	LIND	1124741.985	2436746.490	607.82
AI	601+05.00	-47.33	LIND	1124760.542	2436732.100	607.10
AJ	842+50.06	-49.00	MAC	1124744.449	2436785.707	608.75
AK	842+60.51	-62.10	MAC	1124758.994	2436777.447	608.46
AL	600+82.05	-22.00	LIND	1124775.708	2436762.726	607.96
AM	601+05.00	-18.00	LIND	1124787.831	2436742.838	607.59
AN	600+82.05	-18.00	LIND	1124779.430	2436764.191	608.04
AO	600+82.05	-6.00	LIND	1124790.596	2436768.584	608.12
AP	601+05.00	-6.00	LIND	1124798.998	2436747.232	607.75
AQ	842+50.06	-45.00	MAC	1124742.951	2436789.416	608.83
AR	842+74.97	-45.00	MAC	1124765.877	2436798.634	608.76
AS	842+87.11	-45.00	MAC	1124777.031	2436803.061	608.72
BA	601+05.00	6.00	LIND	1124810.165	2436751.625	607.86
BB	601+05.00	11.85	LIND	1124815.612	2436753.769	607.80
BC	601+05.00	26.00	LIND	1124828.776	2436758.948	607.59
BD	601+05.00	39.01	LIND	1124840.881	2436763.711	607.26
BE	600+84.57	6.00	LIND	1124802.684	2436770.638	608.14
BF	600+84.29	9.98	LIND	1124806.284	2436772.359	608.14
BG	600+84.29	26.00	LIND	1124821.191	2436778.224	607.94
BH	601+02.83	39.85	LIND	1124840.866	2436766.037	607.30
BI	600+65.59	28.00	LIND	1124816.207	2436796.345	608.21
BJ	600+90.27	46.31	LIND	1124842.282	2436780.088	607.48
BK	600+65.59	32.00	LIND	1124819.929	2436797.818	608.11
BL	600+79.27	55.16	LIND	1124846.490	2436793.568	607.68
BN	843+05.32	-45.00	MAC	1124793.786	2436809.639	608.66
BO	600+58.08	40.79	LIND	1124825.359	2436808.029	608.26
BP	600+69.02	67.97	LIND	1124854.654	2436807.793	607.97
BQ	843+49.60	-49.00	MAC	1124836.078	2436821.578	608.43
BR	843+81.16	-59.92	MAC	1124869.059	2436822.221	608.14
BS	844+01.64	-57.00	MAC	1124887.011	2436831.887	608.14
BT	842+99.25	-45.00	MAC	1124788.197	2436807.455	608.68
BU	843+21.50	-45.00	MAC	1124808.709	2436815.423	608.62
BV	843+49.60	-45.00	MAC	1124834.666	2436825.320	608.53
BW	843+76.70	-45.00	MAC	1124859.771	2436834.695	608.45
BX	844+01.64	-45.00	MAC	1124882.922	2436843.169	608.38
CA	842+35.88	-9.00	MAC	1124716.316	2436817.484	609.59
CB	842+35.88	-3.00	MAC	1124714.069	2436823.047	609.77
CC	843+54.79	-9.00	MAC	1124826.802	2436860.828	609.24
CD	843+52.69	0.54	MAC	1124821.484	2436869.019	609.37
CE	843+91.17	9.00	MAC	1124854.667	2436890.350	609.13
CF	842+61.65	-9.00	MAC	1124740.199	2426827.128	609.52
CG	842+61.65	0.00	MAC	1124736.842	2436835.477	609.65
CH	842+61.65	9.00	MAC	1124733.484	2436843.828	609.52

OFFSET (-00.00) = LEFT & (00.00) = RIGHT
 MAC = MACARTHUR BLVD
 LIND = LINDBERGH BLVD

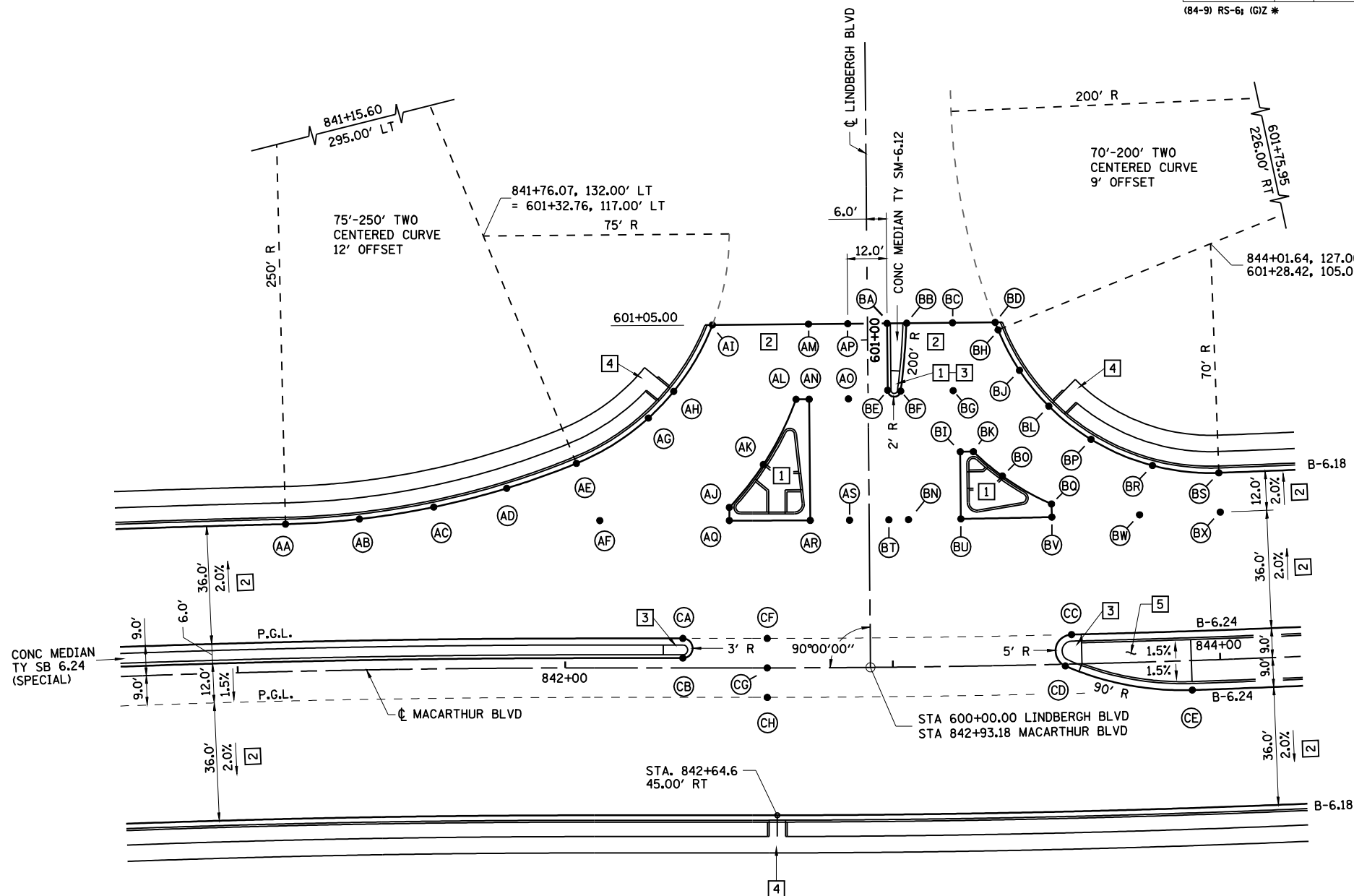
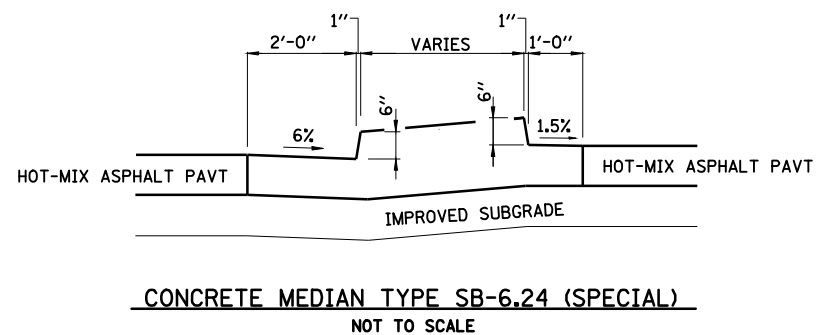

- 1 SEE ISLAND DETAILS SHEET
- 2 HOT-MIX ASPHALT (FULL DEPTH) 13" ON LIME MODIFIED SOIL 12"
- 3 RAMP MEDIAN NOSES IN ACCORDANCE WITH STD 606301
- 4 5' WIDE PCC SIDEWALK 4"
- 5 CONCRETE MEDIAN SURFACE 4" ON SUBBASE GRANULAR MATERIAL, TYPE C, 4"

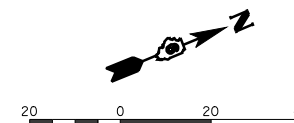

REVISIONS	
NAME	DATE

ILLINOIS DEPARTMENT OF TRANSPORTATION
INTERSECTION DETAIL
LINDBERGH BLVD / MACARTHUR BLVD
SECTION
 (84-9) RS-6; (G)Z
 SANGAMON COUNTY, ILLINOIS
 SCALE: VERT. _____
 HORIZ. _____
 DATE: Mar-20-2008 09:34:52AM
 DRAWN BY: CLG
 CHECKED BY: JAD

LAYOUT: CLG 09/17/07
 DRAWN: CLG 09/17/07
 REVIEWED: JMM 03/12/08
 Mar-20-2008 09:34:52AM
 \$FILES\$