

FAU ROUTE	SECTION	COUNTY	TOTAL SHEETS	SHEET NO.
8071	*	SANGAMON	425	201
STA.		TO STA.		
FED. ROAD DIST. NO.	ILLINOIS	FED. AID PROJECT		
(84-9) RS-6; (G)Z *				

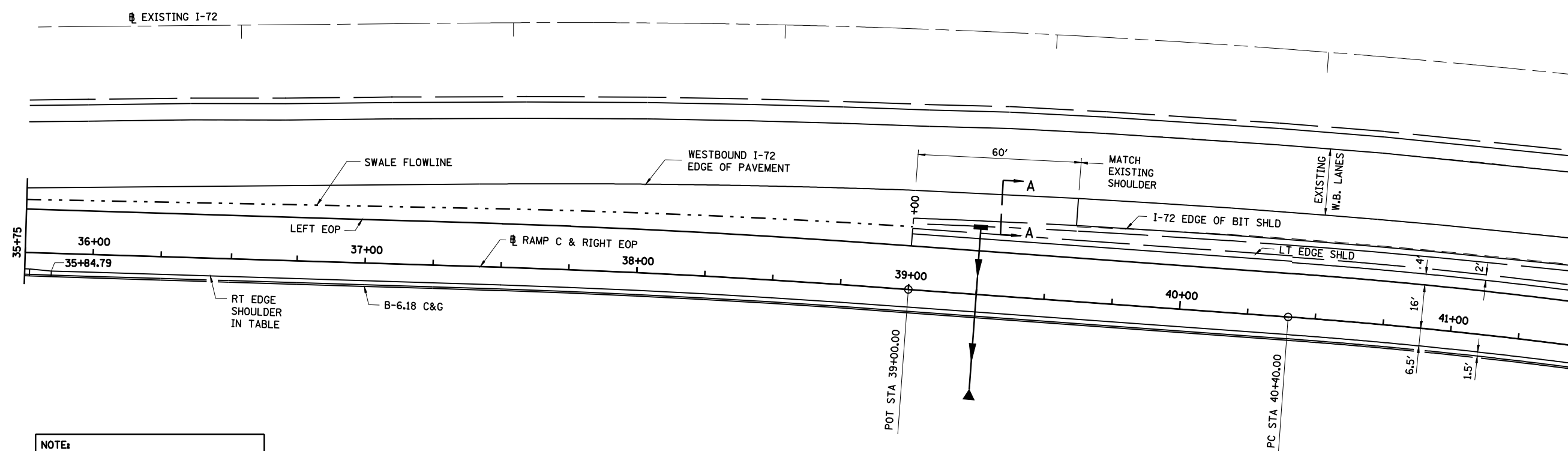

NOTE:
I-72 EXISTING EDGE OF PAVEMENT SHOWN IN THE TABLE IS SET TO MATCH THE ELEVATION OF THE PROPOSED OVERLAY OF I-72 BY OTHERS.

STATION	NORTHING	EASTING	ELEVATION AT RAMP BASELINE	I-72 EXISTING EDGE OF PAVEMENT		I-72 EDGE OF BIT SHOULDER		SWALE FLOWLINE			RAMP LT EDGE SHOULDER		RAMP LT EDGE OF PAVEMENT		RAMP RT EDGE SHOULDER	
				OFFSET LT	ELEV	OFFSET LT	ELEV	OFFSET LT	ELEV	WIDTH	OFFSET LT	ELEV	OFFSET LT	ELEV	OFFSET RT	ELEV
36+00.00	1,120,197.986	2,437,848.199	619.55	24.48	619.79			19.80	619.72			16.00	619.79	6.50	619.29	
36+25.00	1,120,189.914	2,437,824.539	620.17	25.46	620.41			20.08	620.32			16.00	620.41	6.50	619.91	
36+50.00	1,120,181.841	2,437,800.878	620.70	26.44	620.94			20.35	620.85			16.00	620.94	6.50	620.44	
36+75.00	1,120,173.768	2,437,777.217	621.23	27.42	621.47			20.62	621.37			16.00	621.47	6.50	620.97	
37+00.00	1,120,165.695	2,437,753.557	621.72	28.40	621.99			20.90	621.88			16.00	621.99	6.50	621.46	
37+25.00	1,120,157.622	2,437,729.896	622.16	29.38	622.52			21.17	622.39			16.00	622.52	6.50	621.90	
37+50.00	1,120,149.557	2,437,706.233	622.59	30.36	623.04			21.45	622.91			16.00	623.04	6.50	622.33	
37+75.00	1,120,141.620	2,437,682.526	623.02	31.34	623.56			21.72	623.42			16.00	623.56	6.50	622.76	
38+00.00	1,120,133.851	2,437,658.764	623.46	32.33	624.09			22.00	623.93			16.00	624.09	6.50	623.20	
38+25.00	1,120,126.252	2,437,634.947	623.89	33.31	624.61			22.28	624.44			16.00	624.61	6.50	623.60	
38+50.00	1,120,118.823	2,437,611.077	624.35	34.29	625.07			22.55	624.89			16.00	625.07	6.50	624.06	
38+75.00	1,120,111.565	2,437,587.154	624.80	35.27	625.52			22.83	625.34			16.00	625.52	6.50	624.51	
39+00.00	1,120,104.477	2,437,563.180	625.25	36.25	625.97			23.10	625.78			16.00	625.97	6.50	624.96	
39+25.00	1,120,097.389	2,437,539.202	625.69	37.05	626.43	27.05	626.15	24.73	625.76	0.00	22.00	626.22	16.00	626.42	6.50	625.39
39+50.00	1,120,090.301	2,437,515.227	626.12	37.67	626.84	27.67	626.44	25.51	626.08	0.00	22.00	626.67	16.00	626.87	6.50	625.82
39+75.00	1,120,083.213	2,437,491.253	626.53	38.11	627.26	28.11	626.81	25.95	626.45	0.00	22.00	627.10	16.00	627.29	6.50	626.22
40+00.00	1,120,076.126	2,437,467.279	626.92	38.37	627.67	28.37	627.22	26.05	626.83	0.00	22.00	627.51	16.00	627.70	6.50	626.60
40+25.00	1,120,069.038	2,437,443.305	627.29	38.46	628.08	28.46	627.63	26.05	627.23	0.00	22.00	627.90	16.00	628.08	6.50	626.97
40+50.00	1,120,061.976	2,437,419.323	627.65	38.39	628.44	28.39	627.99	26.05	627.60	0.00	22.00	628.27	16.00	628.45	6.50	627.32
40+75.00	1,120,055.174	2,437,395.266	627.99	38.36	628.79	28.36	628.34	26.10	627.96	0.00	22.00	628.63	16.00	628.81	6.50	627.66
41+00.00	1,120,048.691	2,437,371.121	628.31	38.53	629.13	28.53	628.68	26.15	628.29	0.00	22.00	628.97	16.00	629.14	6.50	627.97
41+10.00	1,120,046.188	2,437,361.440	628.43	38.64	629.27	28.64	628.82	26.16	628.41	0.00	22.00	629.10	16.00	629.27	6.50	628.09
41+25.00	1,120,042.528	2,437,346.893	628.61	38.85	629.48	28.85	629.03	26.20	628.59	0.00	22.00	629.28	16.00	629.45	6.50	628.27
41+50.00	1,120,036.687	2,437,322.585	628.91	39.33	629.83	29.33	629.38	26.25	628.86	0.00	22.00	629.58	16.00	629.75	6.50	628.57

ESTIMATED EXISTING OFFSET/ELEVATION. MATCH EXISTING

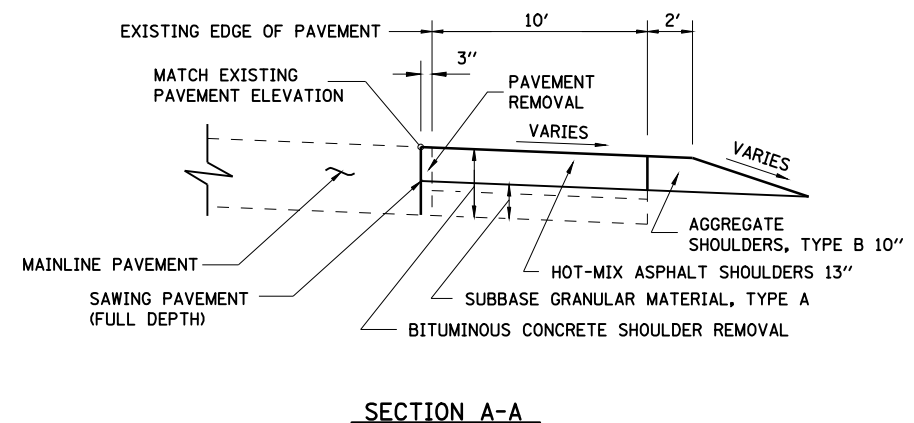

REVISIONS	
NAME	DATE

ILLINOIS DEPARTMENT OF TRANSPORTATION
RAMP C TERMINAL DETAIL-2
FAI-72, MACARTHUR BLVD
SECTION
(84-9) RS-6; (G)Z
SANGAMON COUNTY, ILLINOIS
SCALE: VERT. DRAWN BY CLG
 HORIZ. CHECKED BY JAD
DATE Mar-20-2008 09:36:18AM

LAYOUT CLG 09/17/07
 DRAWN CLG 09/17/07
 REVIEWED JMM 03/12/08
 Mar-20-2008 09:36:18AM
 #FILES*