

FAU ROUTE	SECTION	COUNTY	TOTAL SHEETS	SHEET NO.
8071	*		425	267
STA.		TO STA.		
FED. ROAD DIST. NO.	ILLINOIS	FED. AID PROJECT		
(84-9) RS-6; IGIZ *				

TRAFFIC SIGNAL QUANTITIES

LOCATION: MACARTHUR BLVD & LINCOLNSHIRE

QUANTITY	UNIT	ITEM
64.0	SO FT	SIGN PANEL - TYPE II
1	EACH	SERVICE INSTALLATION, TYPE A
1	EACH	LIGHT POLE, WOOD, 25 FOOT, CLASS 4
154.0	FOOT	CONDUIT IN TRENCH, 1 1/2" DIA., PVC
37.0	FOOT	CONDUIT IN TRENCH, 3" DIA., PVC
3.0	FOOT	CONDUIT IN TRENCH, 3 1/2" DIA., PVC
25.0	FOOT	CONDUIT IN TRENCH, 4" DIA., PVC
55.0	FOOT	CONDUIT, AUGERED, 2" DIA., PVC
97.0	FOOT	CONDUIT, AUGERED, 3" DIA., PVC
224.0	FOOT	CONDUIT, AUGERED, 3 1/2" DIA., PVC

6.0	FOOT	CONCRETE FOUNDATION, TYPE A
3.5	FOOT	CONCRETE FOUNDATION, TYPE D
56.0	FOOT	CONCRETE FOUNDATION, TYPE E, 36" DIA.
12	EACH	SIGNAL HEAD, POLYCARBONATE, L. E. D., 1-FACE, 3-SECTION, MAST ARM MOUNTED
1	EACH	SIGNAL HEAD, POLYCARBONATE, L. E. D., 1-FACE, 5-SECTION, BRACKET MOUNTED
2	EACH	SIGNAL HEAD, POLYCARBONATE, L. E. D., 1-FACE, 5-SECTION, MAST ARM MOUNTED
2	EACH	SIGNAL HEAD, POLYCARBONATE, L. E. D., 3-FACE, 1-3 SECTION, 2-5 SECTION, BRACKET MOUNTED
2	EACH	SIGNAL HEAD, POLYCARBONATE, L. E. D., 3-FACE, 5-SECTION, BRACKET MOUNTED
1	EACH	PEDESTRIAN SIGNAL HEAD, POLYCARBONATE, L. E. D., 1-FACE, BRACKET MOUNTED
3	EACH	PEDESTRIAN SIGNAL HEAD, POLYCARBONATE, L. E. D., 2-FACE, BRACKET MOUNTED
1	EACH	PEDESTRIAN SIGNAL HEAD, POLYCARBONATE, L. E. D., 3-FACE, BRACKET MOUNTED
19	EACH	TRAFFIC SIGNAL BACKPLATE
9	EACH	PEDESTRIAN PUSHBUTTON
1	EACH	VIDEO VEHICLE DETECTION SYSTEM
590.5	FOOT	ELECTRIC CABLE IN CONDUIT, GROUND, #6 1/C (GREEN)

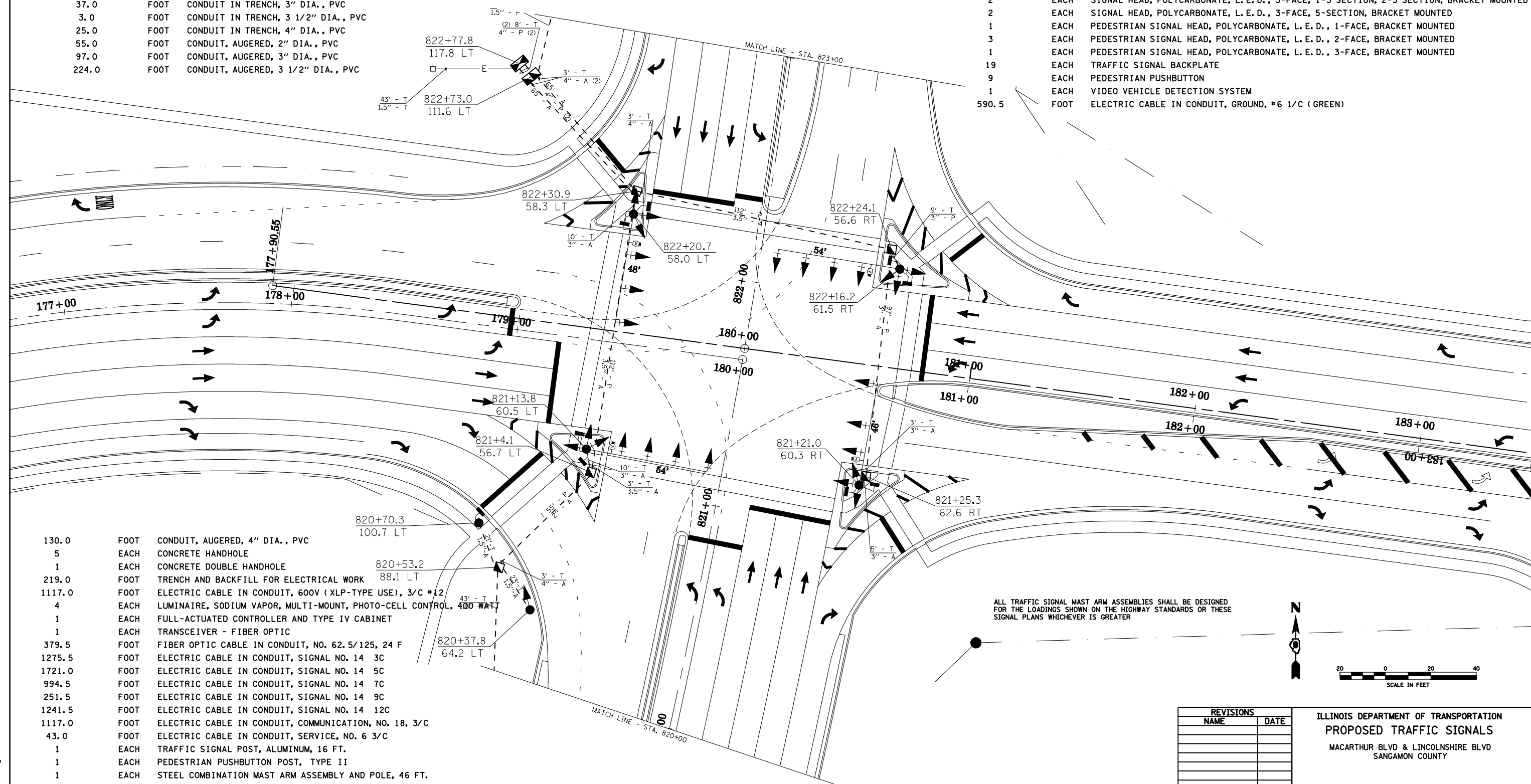

130.0	FOOT	CONDUIT, AUGERED, 4" DIA., PVC
5	EACH	CONCRETE HANDHOLE
1	EACH	CONCRETE DOUBLE HANDHOLE
219.0	FOOT	TRENCH AND BACKFILL FOR ELECTRICAL WORK
1117.0	FOOT	ELECTRIC CABLE IN CONDUIT, 600V (XLP-TYPE USE), 3/C *12
4	EACH	LUMINAIRE, SODIUM VAPOR, MULTI-MOUNT, PHOTO-CELL CONTROL, 400 WATT
1	EACH	FULL-ACTUATED CONTROLLER AND TYPE IV CABINET
1	EACH	TRANSCIVER - FIBER OPTIC
379.5	FOOT	FIBER OPTIC CABLE IN CONDUIT, NO. 62.5/125, 24 F
1275.5	FOOT	ELECTRIC CABLE IN CONDUIT, SIGNAL NO. 14 3C
1721.0	FOOT	ELECTRIC CABLE IN CONDUIT, SIGNAL NO. 14 5C
994.5	FOOT	ELECTRIC CABLE IN CONDUIT, SIGNAL NO. 14 7C
251.5	FOOT	ELECTRIC CABLE IN CONDUIT, SIGNAL NO. 14 9C
1241.5	FOOT	ELECTRIC CABLE IN CONDUIT, SIGNAL NO. 14 12C
1117.0	FOOT	ELECTRIC CABLE IN CONDUIT, COMMUNICATION, NO. 18, 3/C
43.0	FOOT	ELECTRIC CABLE IN CONDUIT, SERVICE, NO. 6 3/C
1	EACH	TRAFFIC SIGNAL POST, ALUMINUM, 16 FT.
1	EACH	PEDESTRIAN PUSHBUTTON POST, TYPE II
1	EACH	STEEL COMBINATION MAST ARM ASSEMBLY AND POLE, 46 FT.
1	EACH	STEEL COMBINATION MAST ARM ASSEMBLY AND POLE, 48 FT.
2	EACH	STEEL COMBINATION MAST ARM ASSEMBLY AND POLE, 54 FT.

ALL TRAFFIC SIGNAL MAST ARM ASSEMBLIES SHALL BE DESIGNED FOR THE LOADINGS SHOWN ON THE HIGHWAY STANDARDS OR THESE SIGNAL PLANS WHICHEVER IS GREATER



REVISIONS	
NAME	DATE

ILLINOIS DEPARTMENT OF TRANSPORTATION
 PROPOSED TRAFFIC SIGNALS
 MACARTHUR BLVD & LINCOLNSHIRE BLVD
 SANGAMON COUNTY

SCALE: VERT. / HORIZ.
 DATE: / /
 DRAWN BY: IDOT
 CHECKED BY: IDOT

PLOT DATE = 09-11-2008 09:44:37 AM
 FILE NAME = C:\Projeva\855882\hanson.fma\plot.plt
 PLOT SCALE = 42.3525' / IN.
 USER NAME = laughlinr1