

F.A.I. RTE.	SECTION	COUNTY	TOTAL SHEETS	SHEET NO.
*	**	***	9	6
STA.		TO STA.		
FED. ROAD DIST. NO.		ILLINOIS FED. AID PROJECT		

* - 72, 155
 ** - D6 MEDIAN PROTECTION 2008
 *** - LOGAN, MORGAN, PIKE & SCOTT COUNTIES

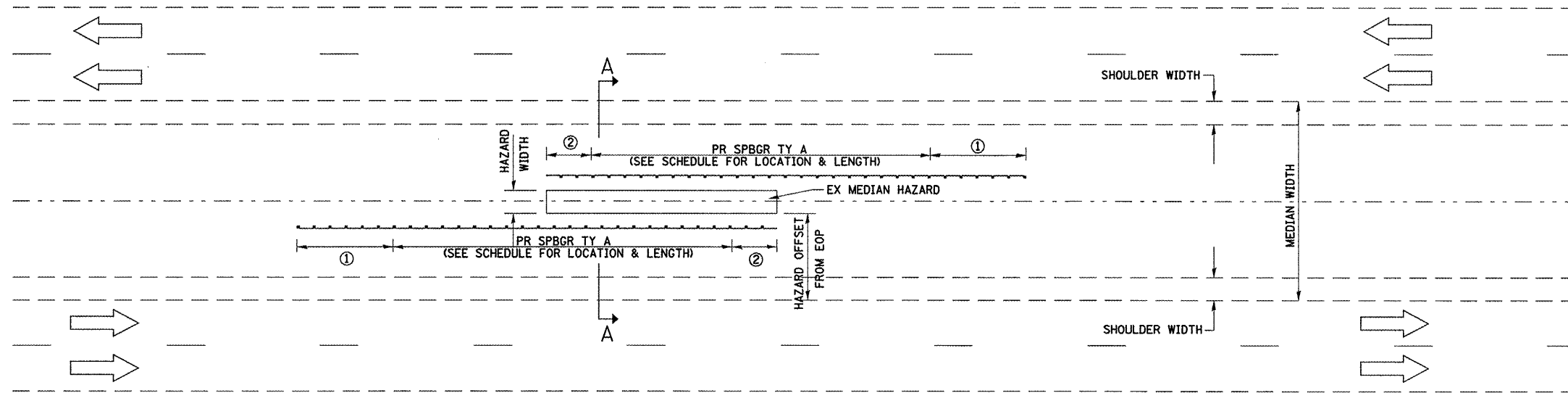

DETAIL "A"

(PROPOSED PROTECTION OF MEDIAN HAZARD WITH PROPOSED GUARDRAIL)

- ① PR TRAFFIC BARRIER TERMINAL, TYPE 1, SPECIAL (TANGENT)
 - ② PR TRAFFIC BARRIER TERMINAL, TYPE 2
- NOTE: TYPE 2 TERMINATES AT END OF HAZARD

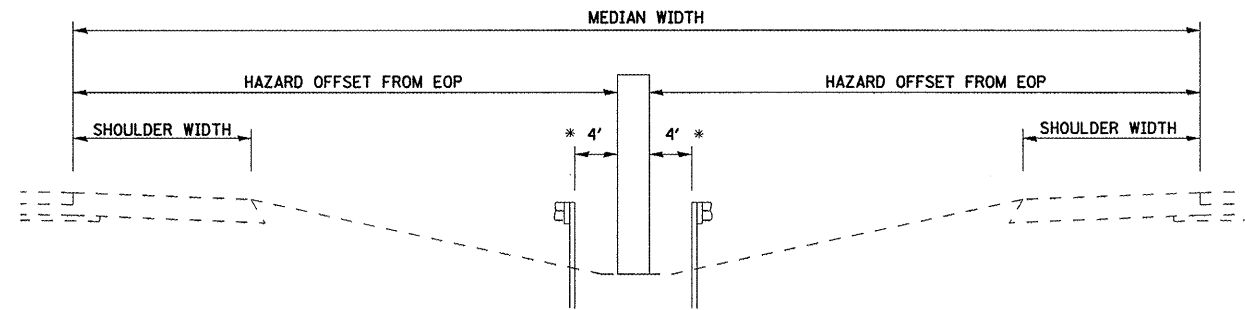

* AT SELECT LOCATIONS IDENTIFIED IN THE SCHEDULE OF QUANTITIES AS A *, THE GUARDRAIL SHALL BE OFFSET 5' FROM THE PIER IN ORDER TO MISS CONFLICTING SPREAD FOOTINGS.

SECTION A-A
(TYPICAL CROSS SECTION)

REVISIONS	
NAME	DATE

ILLINOIS DEPARTMENT OF TRANSPORTATION

DETAIL "A"
 FAI 72 & FAI 155
 SECTION D6 MEDIAN PROTECTION 2008
 LOGAN, MORGAN, PIKE & SCOTT COUNTIES

PLOT DATE = Nov-14-2008 10:07:29 AM
 FILE NAME = C:\Projects\72893\872893.dwg
 PLOT SCALE = 1/8" = 1'-0"
 USER NAME = jmaguire