

F.A.P. RTE.	SECTION	COUNTY	TOTAL SHEETS	SHEET NO.
304	5BR-2	CALHOUN	68	13
STA. 458+00.00		TO STA. 464+00.00		
FED. ROAD DIST. NO. - ILLINOIS FED. AID PROJECT				

PRE-STAGE 1 CONSTRUCTION:

- PRE-STAGE 1 CONSTRUCTION SHALL CONSIST OF THE RELOCATION OF THE EXISTING GUARD RAIL, CONSTRUCTION OF THE 4 1/2' PAVEMENT WIDENING ON THE NORTHEAST AND NORTHWEST CORNERS OF THE STRUCTURE, AND PLACEMENT OF THE W33X118 STEEL BEAM UNDER BEAM 3 OF THE EXISTING STRUCTURE AS SHOWN ON PAGE 24A OF THE PLANS. TRAFFIC CONTROL SHALL BE IN ACCORDANCE WITH TRAFFIC CONTROL AND PROTECTION, STANDARD 701325.

STAGE I CONSTRUCTION:

- STAGE I CONSTRUCTION SHALL CONSIST OF STAGE I REMOVAL OF THE EXISTING STRUCTURE, AND STAGE I CONSTRUCTION OF THE REPLACEMENT STRUCTURE, PAVEMENT REMOVAL, GRADING, RESURFACING THE RIGHT SIDE PAVEMENT NORTH AND SOUTH OF THE STRUCTURE, GUARDRAIL, RIPRAP, ETC. STAGE I CONSTRUCTION SHALL BE DONE ACCORDING TO STAGE CONSTRUCTION AS DETAILED IN THE BRIDGE PLANS. TRAFFIC CONTROL SHALL BE IN ACCORDANCE WITH THE APPLICABLE PORTIONS OF STANDARD 701321 AND AS DETAILED IN THE STAGE CONSTRUCTION PLANS. THIS TRAFFIC CONTROL SHALL BE PAID FOR AS TRAFFIC CONTROL AND PROTECTION 701321 (SPECIAL).

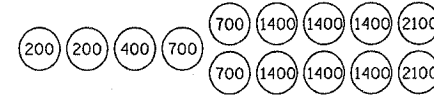

SAND MODULE IMPACT ATTENUATOR LAYOUT (IF OPTION USED)

NOTES:

- THE CONTRACTOR SHALL MAINTAIN ACCESS TO PRIVATE AND FIELD ENTRANCES LOCATED WITHIN THE LIMITS OF THE PROJECT.
- TRAFFIC CONTROL & PROTECTION, STANDARD 701321 (SPECIAL) INCLUDES BOTH STAGE I & II AND ANY ADDITIONAL SIGNING OR TRAFFIC CONTROL DEVICES SHOWN ON THE STAGE CONSTRUCTION PLANS.
- ALL ADDITIONAL TRAFFIC SIGNAL HEADS, LOOP DETECTORS AND ASSOCIATED EQUIPMENT REQUIRED TO MAINTAIN ACCESS AT THE FIELD AND DRIVEWAY ENTRANCES SHALL BE INCLUDED IN THE COST OF "TEMPORARY BRIDGE TRAFFIC SIGNALS"
- THE COST OF "BARRICADES, TYPE III" SHALL BE INCLUDED IN THE COST OF "TRAFFIC CONTROL AND PROTECTION, STANDARD 701321 (SPECIAL)".
- ALL SIDEROADS AND ENTRANCES WITHIN TRAFFIC CONTROL SHALL HAVE "NO RIGHT TURN ON RED" AND "STOP HERE ON RED" SIGNS. THE COST SHALL BE INCLUDED IN THE COST OF "TRAFFIC CONTROL AND PROTECTION, STANDARD 701321 (SPECIAL)".

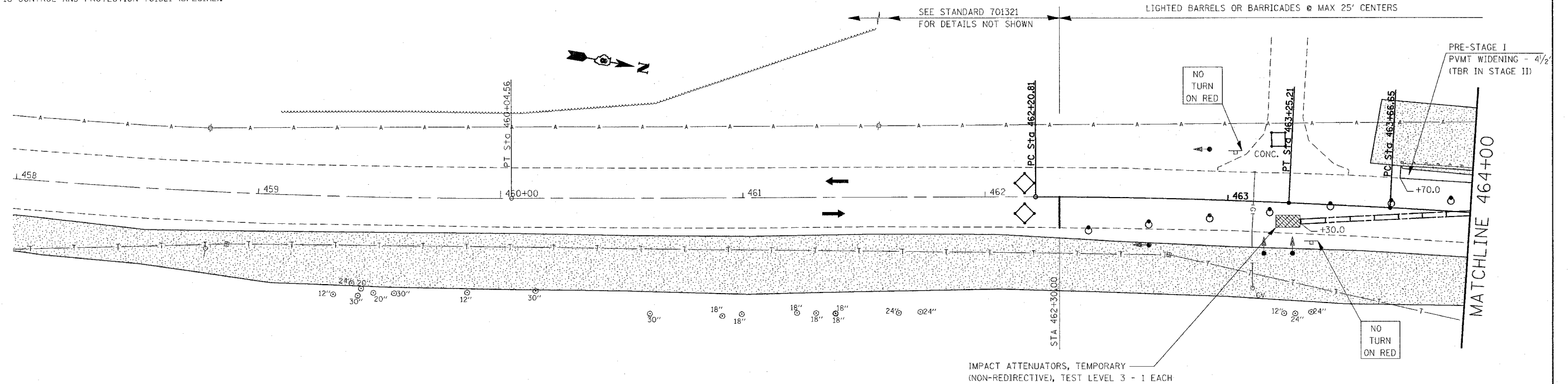

IMPACT ATTENUATORS, TEMPORARY (NON-REDIRECTIVE), TEST LEVEL 3 - 1 EACH

LEGEND:

- STRUCTURE REMOVAL
- PAVEMENT REMOVAL
- TEMPORARY CONCRETE BARRIER
- IMPACT ATTENUATOR
- INDUCTION LOOP DETECTOR
- DRUM WITH STEADY BURNING LIGHT
- SIGNALIZED TWO-WAY TRAFFIC LANE
- TEMPORARY BRIDGE TRAFFIC SIGNAL
- TYPE III BARRICADE

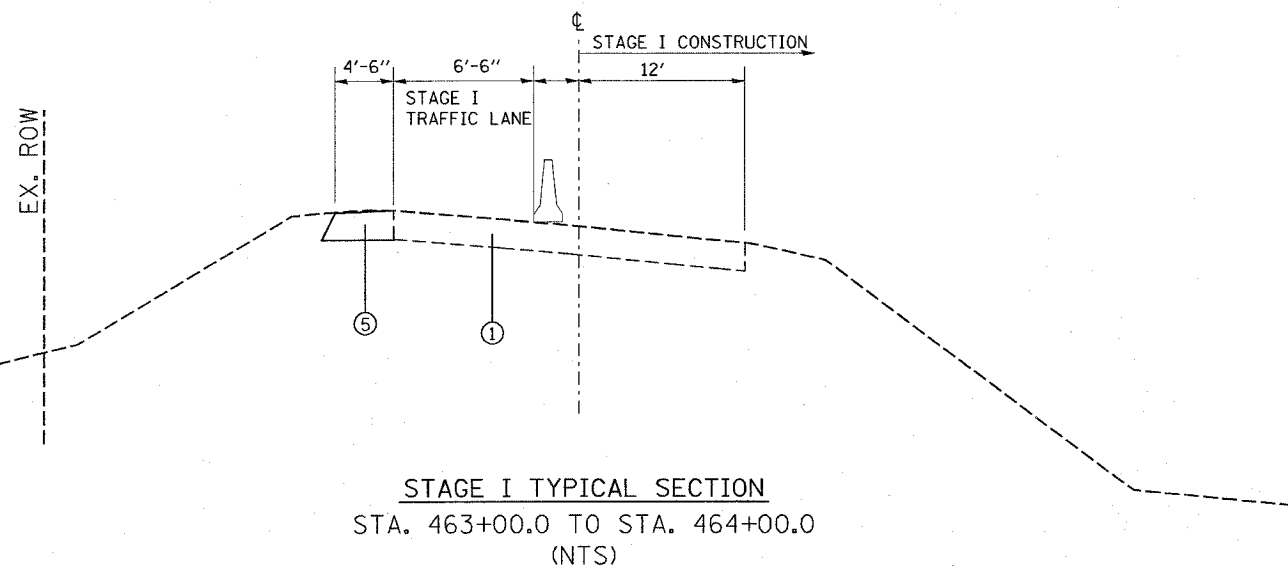

STAGE I TYPICAL SECTION  
STA. 463+00.0 TO STA. 464+00.0  
(NTS)

LEGEND

- ① EXISTING PAVEMENT
- ⑤ PROPOSED HOT-MIX ASPHALT BASE COURSE WIDENING 9"



REVISIONS	
NAME	DATE

ILLINOIS DEPARTMENT OF TRANSPORTATION  
**SUGGESTED STAGE I CONSTRUCTION**  
FAP ROUTE 304  
SECTION 5BR-2  
CALHOUN COUNTY  
SCALE: VERT. DATE      HORIZ. DRAWN BY  
CHECKED BY

PLOT DATE = 5/2/2008  
FILE NAME = c:\projects\edp\1805\plan\stage1\805.dgn  
PLOT SCALE = 20.0000 / IN.  
REFERENCE = SHEET