

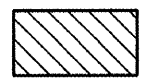

-  PROPOSED CONCRETE CURB AND/OR GUTTER REMOVAL AND REPLACEMENT, DRIVEWAY PAVEMENT REMOVAL, OR SIDEWALK REMOVAL
-  PROPOSED PAVEMENT PATCHING, 12"
-  PROPERTY STREET NUMBER - APPROXIMATE LOCATION

EXIST. CURVE OLDUS40-5
 P1 STA. = 450+02.15
 $\Delta = 43^\circ 28' 00''$ (LT)
 D = 64° 57' 14"
 R = 88.21'
 T = 35.16'
 L = 66.92'
 E = 6.75'
 e = -----
 T.R. = -----
 S.E. RUN = -----
 P.C. STA. = 449+66.99
 P.T. STA. = 450+33.91

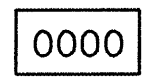
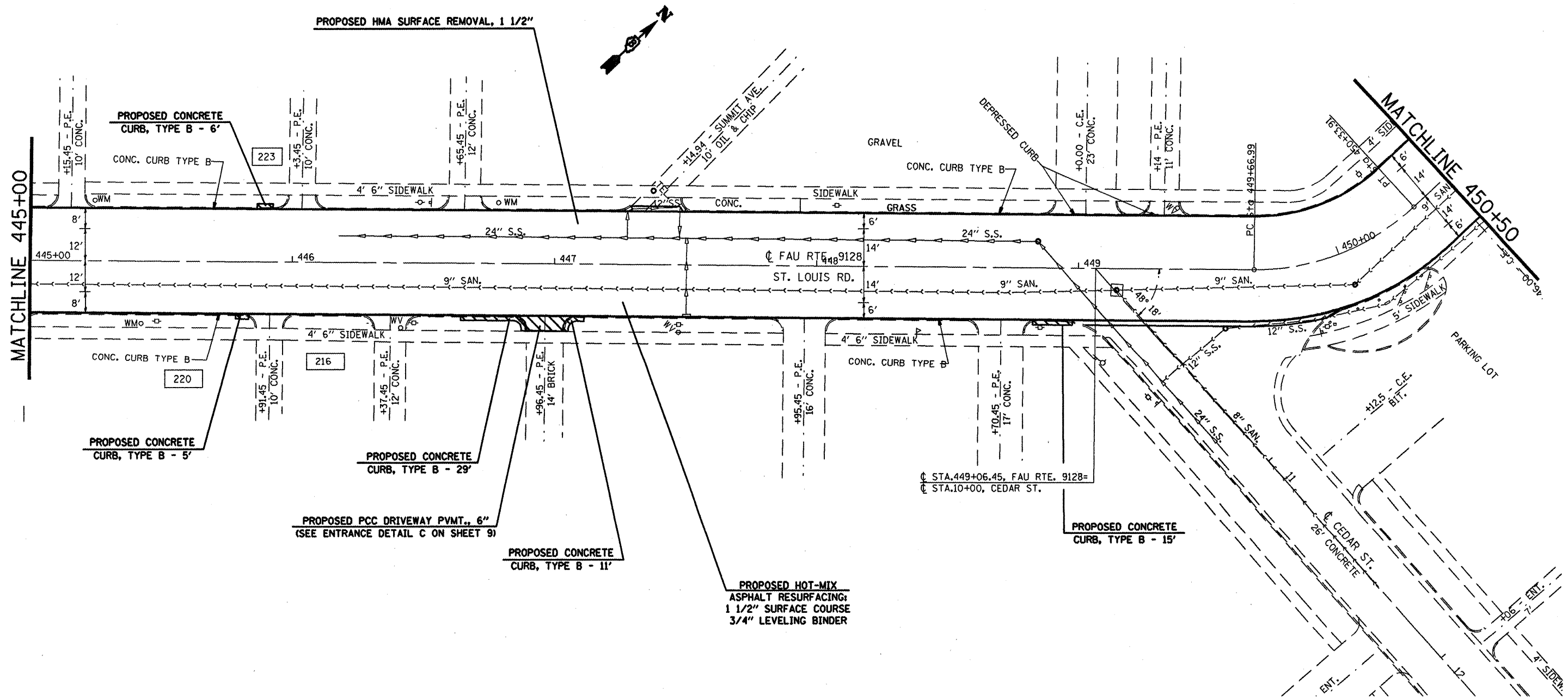

FILE NAME =	USER NAME = #USER#	DESIGNED -	REVISED -
#FILE#		DRAWN -	REVISED -
	PLOT SCALE = #SCALE#	CHECKED -	REVISED -
	PLOT DATE = #DATE#	DATE -	REVISED -

STATE OF ILLINOIS
DEPARTMENT OF TRANSPORTATION

PLAN VIEW

SCALE: SHEET NO. OF SHEETS STA. 445+00 TO STA. 450+50

F.A.I. RTE.	SECTION	COUNTY	TOTAL SHEETS	NO.
9128	38-IRS-3	MADISON	33	19
FED. ROAD DIST. NO. ILLINOIS FED. AID PROJECT			CONTRACT NO. 78A85	