

EXIST. CURVE OLDUS40-5
 P.I. STA. = 450+02.15
 $\Delta = 43^\circ 28' 00''$ (L.T)
 $D = 64^\circ 57' 14''$
 $R = 88.21'$
 $T = 35.16'$
 $L = 66.92'$
 $E = 6.75'$
 $\theta = \dots$
 $T.R. = \dots$
 $S.E. RUN = \dots$
 $P.C. STA. = 449+66.99$
 $P.T. STA. = 450+33.91$

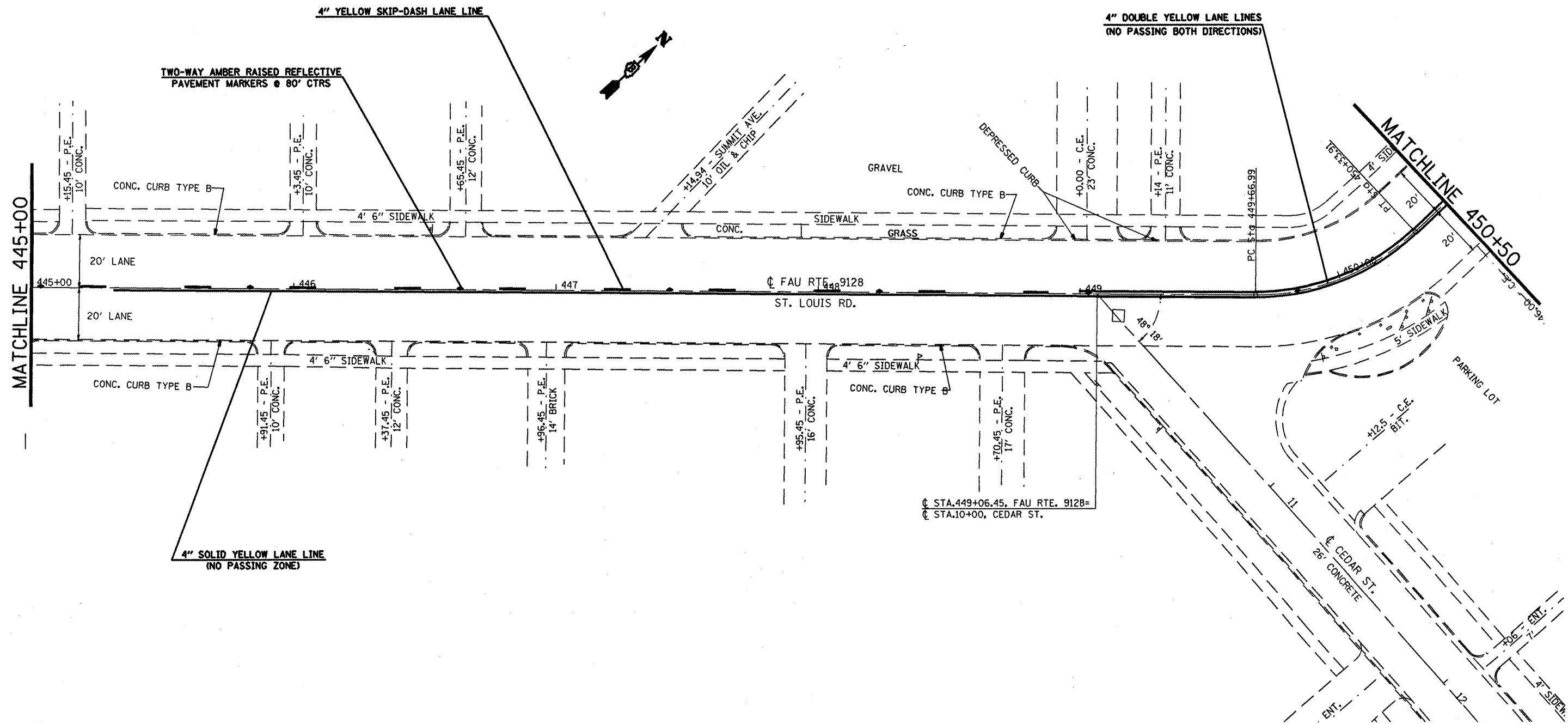

FILE NAME =	USER NAME = #USER#	DESIGNED -	REVISED -	STATE OF ILLINOIS DEPARTMENT OF TRANSPORTATION	PAVEMENT MARKING PLAN	F.A.U. RTE. 9128	SECTION 38-IRS-3	COUNTY MADISON	TOTAL SHEETS 33	SHEET NO. 32	
#FILE#	PLOT SCALE = #SCALE#	DRAWN -	REVISED -			SCALE: _____	SHEET NO. ___ OF ___ SHEETS	CONTRACT NO. 76A85			
	PLOT DATE = #DATE#	CHECKED -	REVISED -			STA. 445+00 TO STA. 450+50		ILLINOIS FED. AID PROJECT			
		DATE -	REVISED -								