

F.A.I. RTE.	SECTION	COUNTY	TOTAL SHEETS	SHEET NO.
-	22	1

- FAS 1909 & FAP 322
- D9 PAVEMENT PRESERVATION FY08
- JACKSON AND UNION COUNTIES

STATE OF ILLINOIS
DEPARTMENT OF TRANSPORTATION
DIVISION OF HIGHWAYS

PROPOSED HIGHWAY PLANS

FAS ROUTE 1909 & FAP ROUTE 322
SECTION D9 PAVEMENT PRESERVATION FY08

FOR INDEX OF SHEETS, SEE SHEET NO. 3

ADT:
US 51 - 4050 (2005)
MU = 125
SU = 200
TRUCKS = 8%

IL 127 - 4200 (2005)
MU = 40
SU = 100
TRUCKS = 3%

EQUATION STATIONS: US 51
EQ. STA. 1047+55.55 (BK.) = STA. 52+01.25 (AH.)
EQ. STA. 103+30.75 (BK.) = STA. 103+86.85 (AH.)
EQ. STA. 118+04.60 (BK.) = STA. 2018+04.60 (AH.)
EQ. STA. 2081+73.95 (BK.) = STA. 187+61.39 (AH.)
EQ. STA. 240+04.17 (BK.) = STA. 3040+04.17 (AH.)
EQ. STA. 3101+03.20 (BK.) = STA. 304+62.66 (AH.)

EQUATION STATIONS: IL 127
EQ. STA. 344+07.40 (BK.) = STA. 6+06.70 (AH.)
EQ. STA. 79+77.70 (BK.) = STA. 80+07.70 (AH.)
EQ. STA. 138+96.20 (BK.) = STA. 139+83.10 (AH.)

OMISSION STATIONS:
STA. 3073+50 TO STA. 3075+71 (S.N. 091-0071)

PROJECT AT FAS 1909 LOCATION 3:
STA. 335+53 TO STA. 227+32
LENGTH = 22,862.8' = 4.33 MILES

TOWNSHIPS: POMONA, ANNA, BALCOM

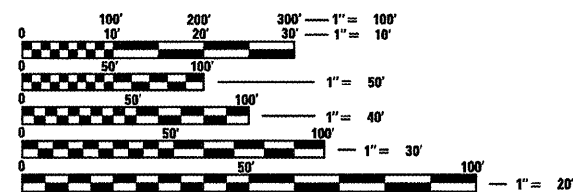

FULL SIZE PLANS HAVE BEEN PREPARED USING STANDARD ENGINEERING SCALES. REDUCED SIZED PLANS WILL NOT CONFORM TO STANDARD SCALES. IN MAKING MEASUREMENTS ON REDUCED PLANS, THE ABOVE SCALES MAY BE USED.

J.U.L.E.
JOINT UTILITY LOCATION INFORMATION FOR EXCAVATION
1-800-892-0123

CONTRACT NO. 78017

JACKSON & UNION COUNTIES

C-99-042-07

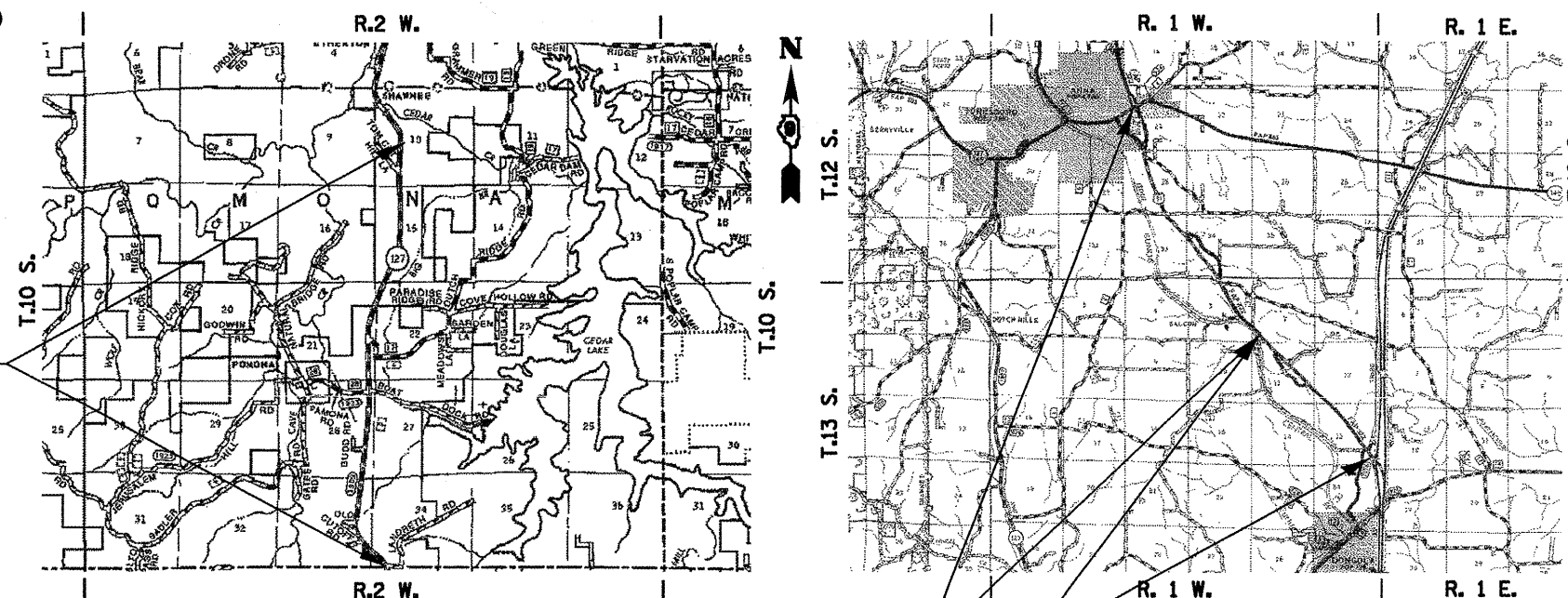

PROJECT AT US 51 LOCTION 1:
STA. 1000+33 TO STA. 238+50
LENGTH = 22,727.76' = 4.31 MILES

PROJECT AT US 51 LOCTION 2:
STA. 238+50 TO STA. 378+65
LENGTH = 13,434.54' = 2.54 MILES

GROSS PROJECT LENGTH = 59,246.1 = 11.22 MILES
NET PROJECT LENGTH: 59,025.1' = 11.18 MILES

D-99-040-07

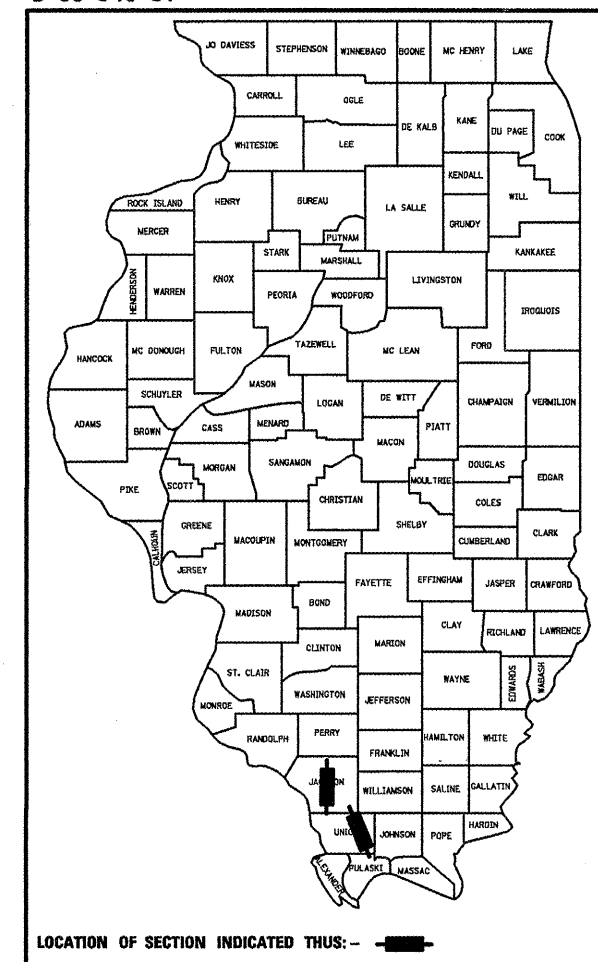

LOCATION OF SECTION INDICATED THUS: - [thick black bar]

STATE OF ILLINOIS
DEPARTMENT OF TRANSPORTATION
DIVISION OF HIGHWAYS

SUBMITTED Jan 23 20 08

Mary C. Damic
DEPUTY DIRECTOR OF HIGHWAYS, REGION ENGINEER

March 21 20 08
Eric E. Harnick
INTERIM ENGINEER OF DESIGN AND ENVIRONMENT

March 21 20 08
Christie M. Reed
DIRECTOR OF HIGHWAYS, CHIEF ENGINEER

**PRINTED BY THE AUTHORITY
OF THE STATE OF ILLINOIS**

F.A.I. RTE.	SECTION	COUNTY	TOTAL SHEETS	SHEET NO.
2	**	***	22	2
STA. _____		TO STA. _____		
FED. ROAD DIST. NO. _____		ILLINOIS	FED. AID PROJECT	

- FAS 1909 & FAP 322
- D9 PAVEMENT PRESERVATION FY08
- JACKSON AND UNION COUNTIES

Prepared By: Joe Zdaniewicz
DISTRICT STUDIES & PLANS ENGINEER

Examined By: James E. Eng
DISTRICT LAND ACQUISITION ENGINEER

Examined By: Carrie Nelson
DISTRICT PROGRAM DEVELOPMENT ENGINEER

Examined By: Kevin Hammes
DISTRICT OPERATIONS ENGINEER

Examined By: Joseph Legier
DISTRICT CONSTRUCTION ENGINEER

Examined By: Bruce W. Pinsky
DISTRICT MATERIALS ENGINEER

Examined By: Jim Swisher
DISTRICT PROJECT IMPLEMENTATION ENGINEER

Examined By: D. Clayton
ASSISTANT REGIONAL ENGINEER

Approved By: Mike Crami
DEPUTY DIRECTOR OF HIGHWAYS, REGION ENGINEER

DATE Jun 22 20 08

SIGNATURE SHEET

PLOT DATE = 10/27/08
 FILE NAME = c:\pwork\78017\78017.dgn
 PLOT SCALE = 1/8"=1'-0"
 USER NAME = mcrand

F.A.T. RTE.	SECTION	COUNTY	TOTAL SHEETS	SHEET NO.
*	**	***	22	3
STA. _____		TO STA. _____		
FED. ROAD DIST. NO. _____		ILLINOIS FED. AID PROJECT		

- * FAS 1909 & FAP 322
- ** D9 PAVEMENT PRESERVATION FY08
- *** JACKSON AND UNION COUNTIES

INDEX OF SHEETS

SHEET NO.	DESCRIPTION
1	COVER SHEET
2	SIGNATURE BLOCK
3	INDEX OF SHEETS; HIGHWAY STANDARDS; STRUCTURE RATINGS; GENERAL NOTES
4	SUMMARY OF QUANTITIES
5 - 7	TYPICAL SECTIONS FOR FAP 322 (US 51) LOCATION 1
8	TYPICAL SECTIONS FOR FAP 322 (US 51) LOCATION 2
9	TYPICAL SECTION FOR FAS 1909 (IL 127)
10	RESURFACING SCHEDULE
11 - 12	PAVEMENT MARKING SCHEDULE - LOCATION 1 AND 2
13	PAVEMENT MARKING SCHEDULE - LOCATION 3
14	RAISED REFLECTIVE PAVEMENT MARKERS SCHEDULES
15	LOCATION MAP - FAP 322 (US 51) LOCATION 1 & 2 FROM INTERSECTION OF IL. 146 SOUTH TO I-57 CONNECTOR
16	LOCATION MAP - FAS 1909 (IL. 127) FROM TOMCAT LANE SOUTH TO THE UNION/JACKSON COUNTY LINE.
17 - 20	DETAIL - PAVEMENT MARKING ON FAP 322 (US 51) LOCATION 1 FROM STA. 1000+33 TO STA. 1047+55.55.
21 - 22	DETAIL - PAVEMENT MARKING ON FAP 322 (US 51) LOCATION 2 FROM STA. 365+98 TO STA. 378+65.

GENERAL NOTES

FACTORS USED FOR ESTIMATING PLAN QUANTITIES ARE AS FOLLOWS AND SHALL NOT BE USED FOR THE BASIS OF FINAL QUANTITIES EXCEPT FOR QC/QA OF BITUMINOUS MIXTURES:

ALL BITUMINOUS CONCRETE.....2.016 TONS/CU.YD.
 ALL AGGREGATE.....2.05 TONS/CU.YD.

BITUMINOUS MATERIALS (PRIME COAT)
 ON PAVEMENT.....0.09 GAL/SQ YD

AGGREGATE (PRIME COAT).....0.0015 TONS/SQ. YD.

THE QUANTITY OF SHORT TERM PAVEMENT MARKING SHOWN IN THE PLANS WAS BASED ON ONE APPLICATION EACH FOR 1 LAYER FOR THE PRIME COAT AND 2 LAYERS OF SURFACE TREATMENT.

PRIOR TO PLACEMENT OF THE FINAL PAVEMENT MARKINGS THE RESIDENT ENGINEER SHOULD CONTACT THE BUREAU OF OPERATIONS AND ARRANGE FOR INSPECTION AND APPROVAL OF THE PAVEMENT MARKING LAYOUT.

THE CONTRACTOR SHALL PRESERVE EXISTING STAMPED STATIONING.

THE AGGREGATE TO BE USED IN THE MICRO-SURFACING SHALL BE TYPE II APPLIED AT 16 LB/SQ YD PER PASS.

BITUMINOUS MATERIAL (PRIME COAT) SHALL BE APPLIED PRIOR TO PLACING THE FIRST PASS OF MICRO-SURFACING AT A RATE OF 0.05 - 0.10 GAL/SQ. YD.

FIBER ASPHALT-CRACK FILLING SHALL ONLY BE PERFORMED ON CRACKS 3/8" WIDE AND GREATER. ALL CRACKS SHALL BE DRY AND FREE OF DIRT, VEGETATION, DEBRIS OR LOOSE FILLER BEFORE FILLING WITH THE FIBER ASPHALT.

HIGHWAY STANDARDS

701301-02	701901
701306-01	780001-01
701311-02	781001-02

STRUCTURE RATINGS

STRUCTURE NO.	INV. RATING	OPER. RATING	SUFF. RATING
FAP 322 (US 51) STA. 3074+60			
091-0071	27.7	44.5	93.8

PLOT DATE = 1/2/2008
 PLOT NAME = I:\2008\180LZ\180LZ.dgn
 PLOT SCALE = 1/8"=1'-0"
 USER NAME = masondb

F.A.I. RTE.	SECTION	COUNTY	TOTAL SHEETS	SHEET NO.
*	**	***	22	4

STA. _____ TO STA. _____
 FED. ROAD DIST. NO. - ILLINOIS FED. AID PROJECT

- FAS 1909 & FAP 322
- ** D9 PAVEMENT PRESERVATION FY08
- *** JACKSON AND UNION COUNTIES

SUMMARY OF QUANTITIES

CODE NUMBER	ITEM DESCRIPTION	UNIT	TOTAL QUANTITY	FAP 322 (US 51) IL 146 TO BODY BARN RD.	FAP 322 (US 51) BODY BARN RD. TO I-57 CONNECTOR	FAS 1909 (IL 127) TOMCAT LN. TO UNION/JACKSON CO. LINE
				LOC. 1 RURAL	LOC. 2 RURAL	LOC. 3 RURAL
				100% STATE	100% STATE	100% STATE
				MICROSURFACING	MICROSURFACING	MICROSURFACING
				UNION	UNION	JACKSON
				1000	1000	1000
				QUANTITY	QUANTITY	QUANTITY
X0325223	FIBER ASPHALT	POUND	69,330	33386	19613	16331
X4480205	MICRO-SURFACING, 2 PASSES, TYPE 2	SQ YD	198,426	84126	50792	63508
Z0040315	PILOT CAR	DAY	8	2	2	4
40600100	BITUMINOUS MATERIALS (PRIME COAT)	GALLON	17,858.2	7571.3	4571.2	5715.7
67100100	MOBILIZATION	L SUM	1	0.3	0.3	0.4
70100460	TRAFFIC CONTROL AND PROTECTION, STANDARD 701306	L SUM	1	0.3	0.3	0.4
70300100	SHORT- TERM PAVEMENT MARKING	FOOT	19,300	7841	4600	6859
70300210	TEMPORARY PAVEMENT MARKING, LETTERS ^{AND} SYMBOLS	SQ FT	254.8	182.0	72.8	
70300220	TEMPORARY PAVEMENT MARKING-LINE 4"	FOOT	210,451	79383	41841	89227
70300260	TEMPORARY PAVEMENT MARKING-LINE 12"	FOOT	1,133	694	439	
70300280	TEMPORARY PAVEMENT MARKING-LINE 24"	FOOT	66	66		
70301000	WORK ZONE PAVEMENT MARKING REMOVAL	SQ FT	75,818	28784	15326	31708
* 78000100	THERMOPLASTIC PAVEMENT MARKING- LETTERS ^{AND} SYMBOLS	SQ FT	254.8	182.0	72.8	
* 78001110	PAINT PAVEMENT MARKING - LINE 4"	FOOT	210,451	79383	41841	89227
* 78001150	PAINT PAVEMENT MARKING - LINE 12"	FOOT	1,133	694	439	
* 78001180	PAINT PAVEMENT MARKING - LINE 24"	FOOT	66	66		
* 78100100	RAISED REFLECTIVE PAVEMENT MARKER	EACH	1,012	493	229	290
78300200	RAISED REFLECTIVE PAVEMENT MARKER REMOVAL	EACH	1,012	493	229	290

* SPECIALTY ITEMS

F.A.I. RTE.	SECTION	COUNTY	TOTAL SHEETS	SHEET NO.
*	**	***	22	5
STA. _____		TO STA. _____		
FED. ROAD DIST. NO. ILLINOIS FED. AID PROJECT				

- FAS 1909 & FAP 322
- D9 PAVEMENT PRESERVATION FY08
- JACKSON AND UNION COUNTIES

FAP 322 (US 51)
LOCATION 1 TYPICALS

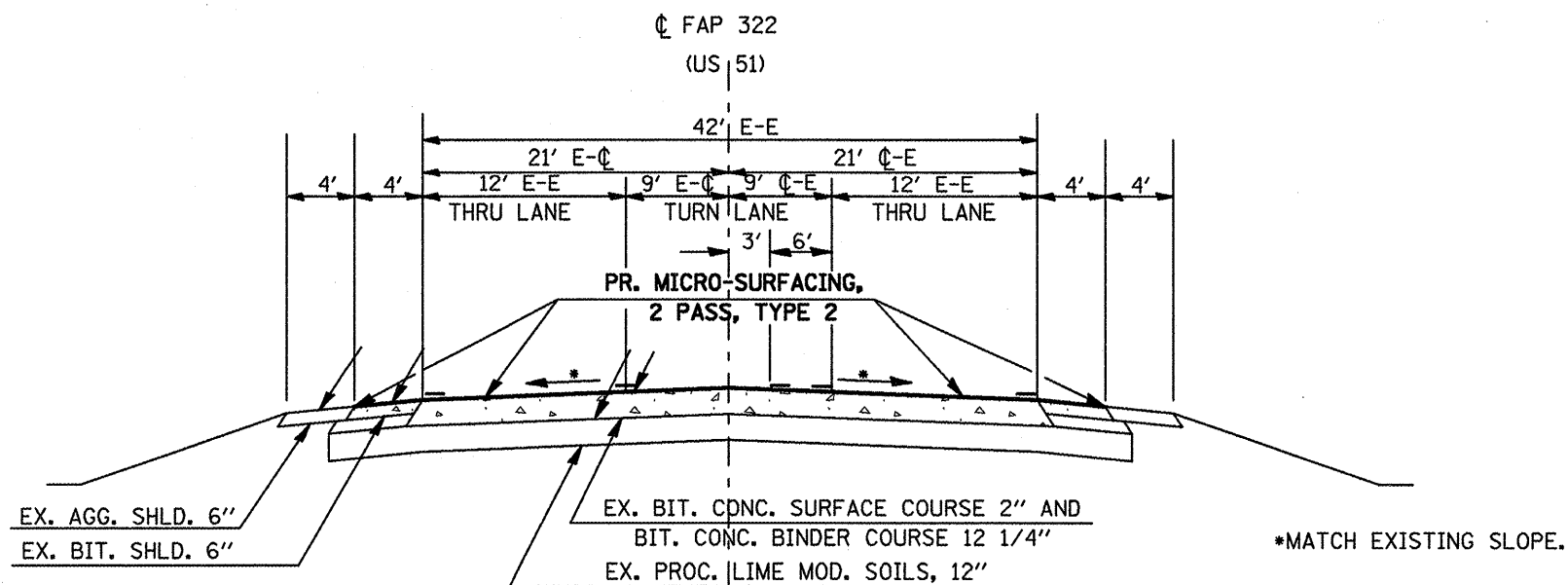

TO BE USED:
STA. 1000+33 TO STA. 1005+83 (550.0')

EQUATION STATIONS:
 EQ. STA. 1047+55.55 (BK.) = STA. 52+01.25 (AH.)
 EQ. STA. 103+30.75 (BK.) = STA. 103+86.85 (AH.)
 EQ. STA. 118+04.60 (BK.) = STA. 2018+04.60 (AH.)
 EQ. STA. 2081+73.95 (BK.) = STA. 187+61.39 (AH.)

LOCATION 1 TOTAL LENGTH = 22,727.76' = 4.31 MILES

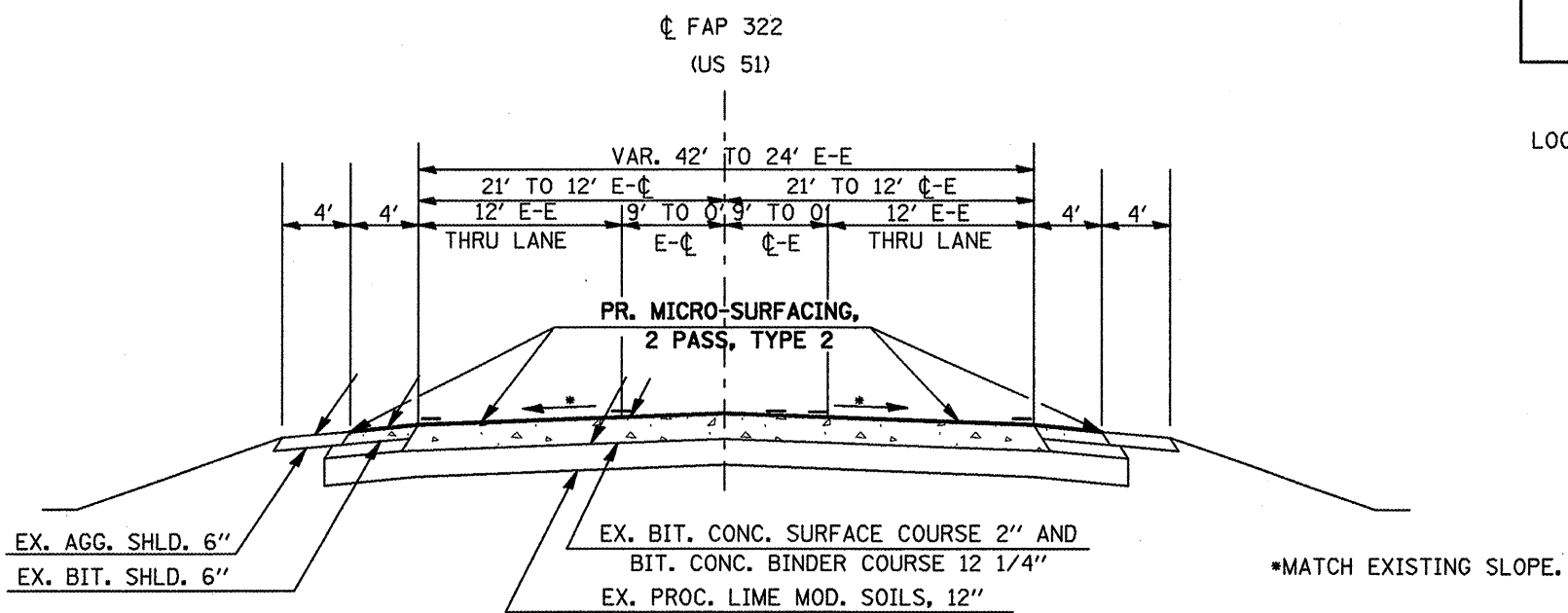

TO BE USED:
STA. 1005+83 TO STA. 1010+23 (440')

PLOT DATE = 12/27/2007
 FILE NAME = c:\nrc\pav\csp\4807\main.dgn
 PLOT SCALE = 1/8" = 1'-0"
 USER NAME = mcooper

F.A. RTE.	SECTION	COUNTY	TOTAL SHEETS	SHEET NO.
*	**	***	22	6
STA. _____ TO STA. _____		FED. ROAD DIST. NO. _____ ILLINOIS FED. AID PROJECT		

- FAS 1909 & FAP 322
- ** D9 PAVEMENT PRESERVATION FY08
- *** JACKSON AND UNION COUNTIES

FAP 322 (US 51)
LOCATION 1 TYPICALS

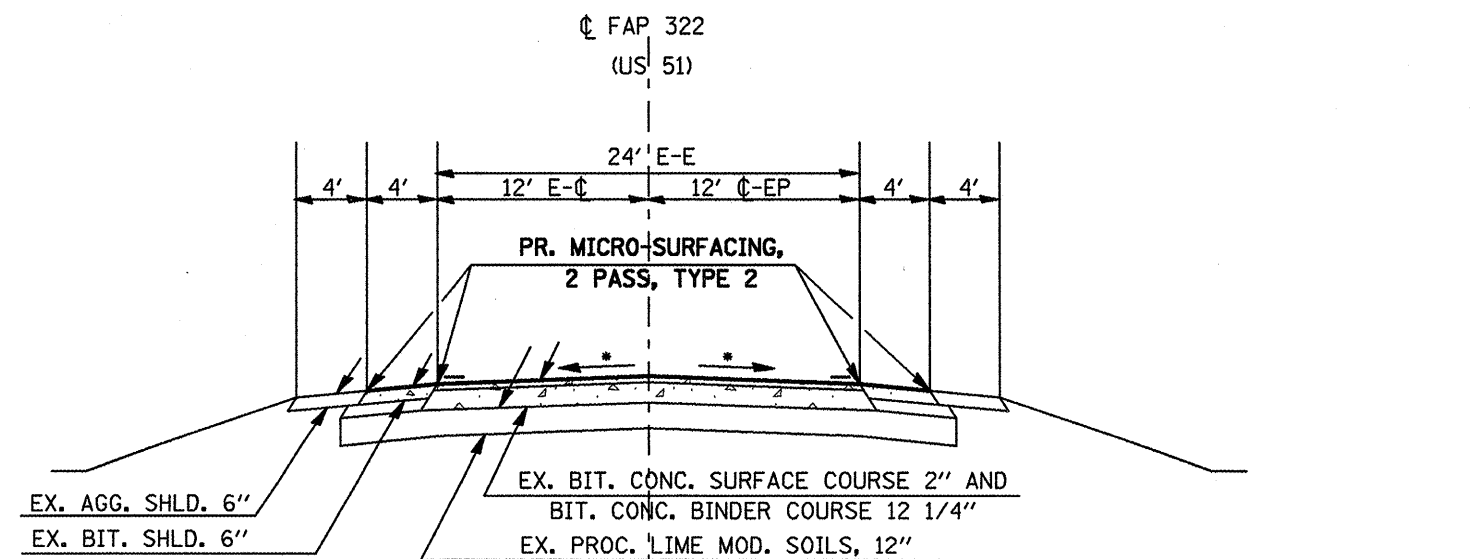

TO BE USED:

- STA. 1010+23 TO STA. 1028+79 (1856.0')
- STA. 1044+78 TO STA. 1047+55.55 (277.55')
- STA. 52+01.25 TO STA. 103+30.75 (5129.5')
- STA. 103+86.85 TO STA. 118+04.60 (1417.75')
- STA. 2018+04.60 TO STA. 2081+73.95 (6369.35')
- STA. 187+61.39 TO STA. 238+50 (5088.61')

*MATCH EXISTING SLOPE.

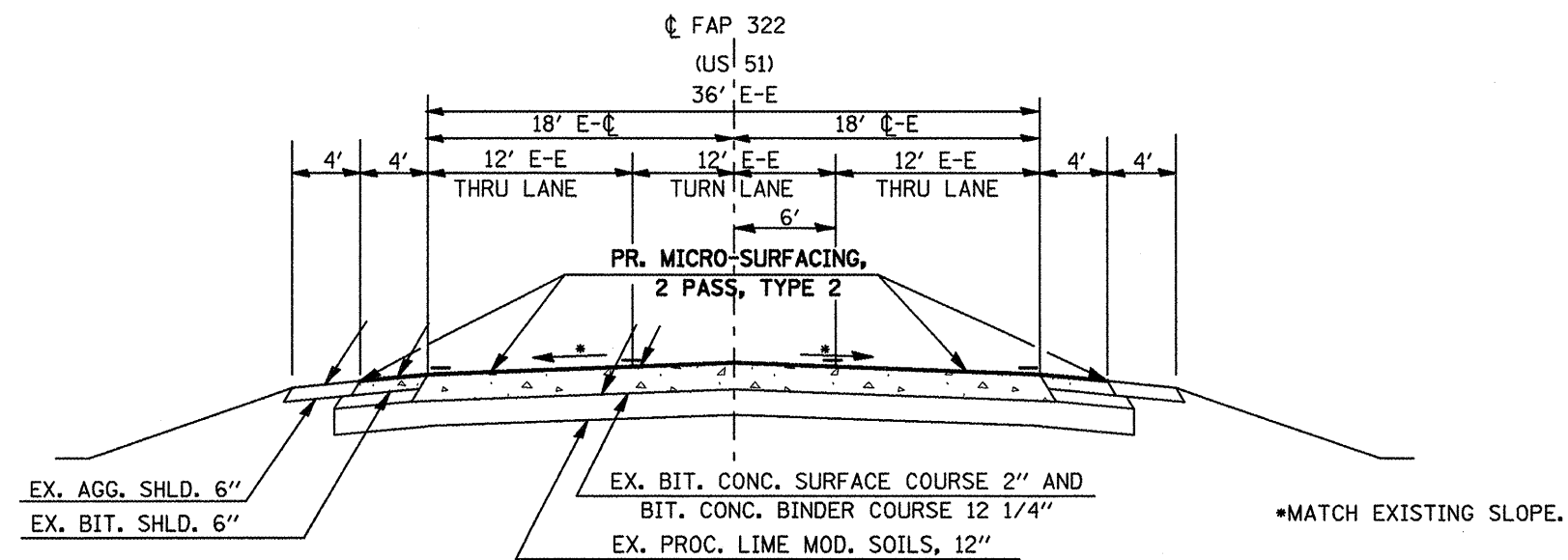

TO BE USED:

- STA. 1031+10.21 TO STA. 1041+73 (1062.79')

*MATCH EXISTING SLOPE.

PLOT DATE = 12/27/2007
 FILE NAME = \\s01487\macedo
 PLOT SCALE = 1/8" = 1'-0"
 USER NAME = macedo

F.A.I. RTE.	SECTION	COUNTY	TOTAL SHEETS	SHEET NO.
*	**	***	22	7
STA. _____ TO STA. _____		FED. ROAD DIST. NO. ILLINOIS FED. AID PROJECT		

- * FAS 1909 & FAP 322
- ** D9 PAVEMENT PRESERVATION FY08
- *** JACKSON AND UNION COUNTIES

FAP 322 (US 51)
LOCATION 1 TYPICALS

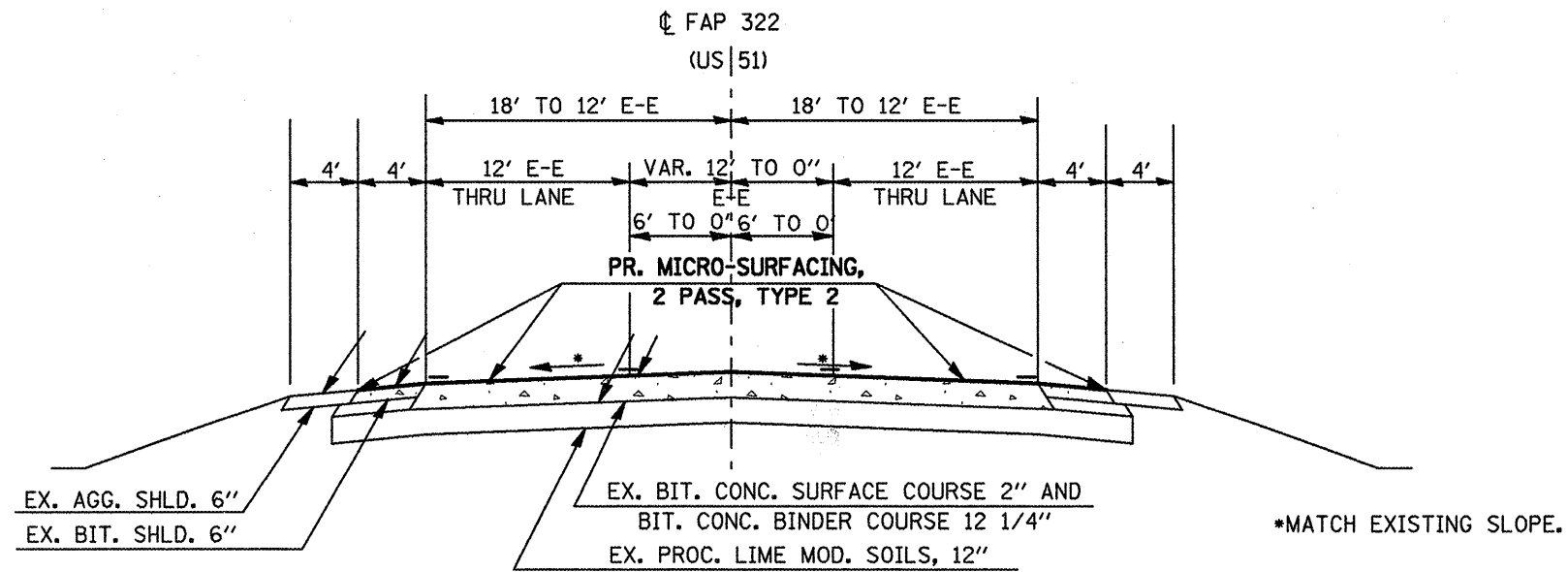

TO BE USED:
STA. 1041+73 TO STA. 1044+78 (305')

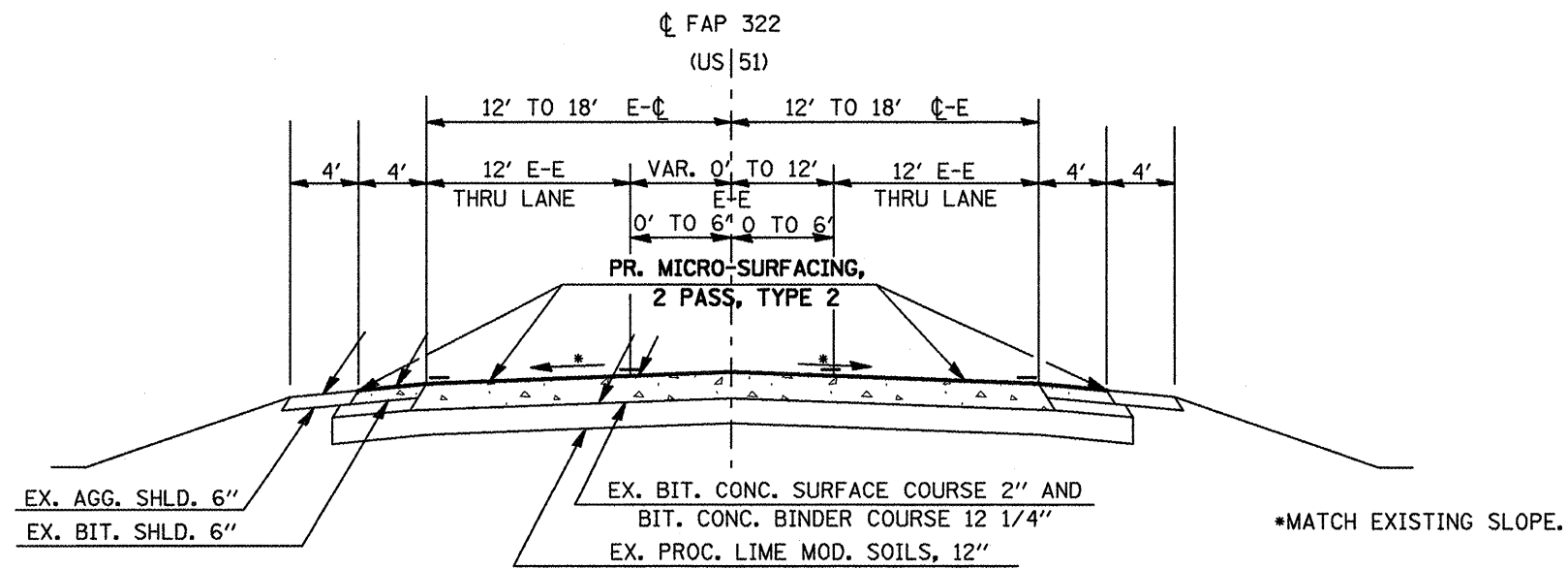

TO BE USED:
STA. 1028+79 TO STA. 1031+10.21 (231.21')

F.A.I. RTE.	SECTION	COUNTY	TOTAL SHEETS	SHEET NO.
*	**	***	22	8
STA. _____		TO STA. _____		
FED. ROAD DIST. NO. _____		ILLINOIS FED. AID PROJECT _____		

- FAS 1909 & FAP 322
- D9 PAVEMENT PRESERVATION FY08
- JACKSON AND UNION COUNTIES

FAP 322 (US 51)
LOCATION 2 TYPICALS

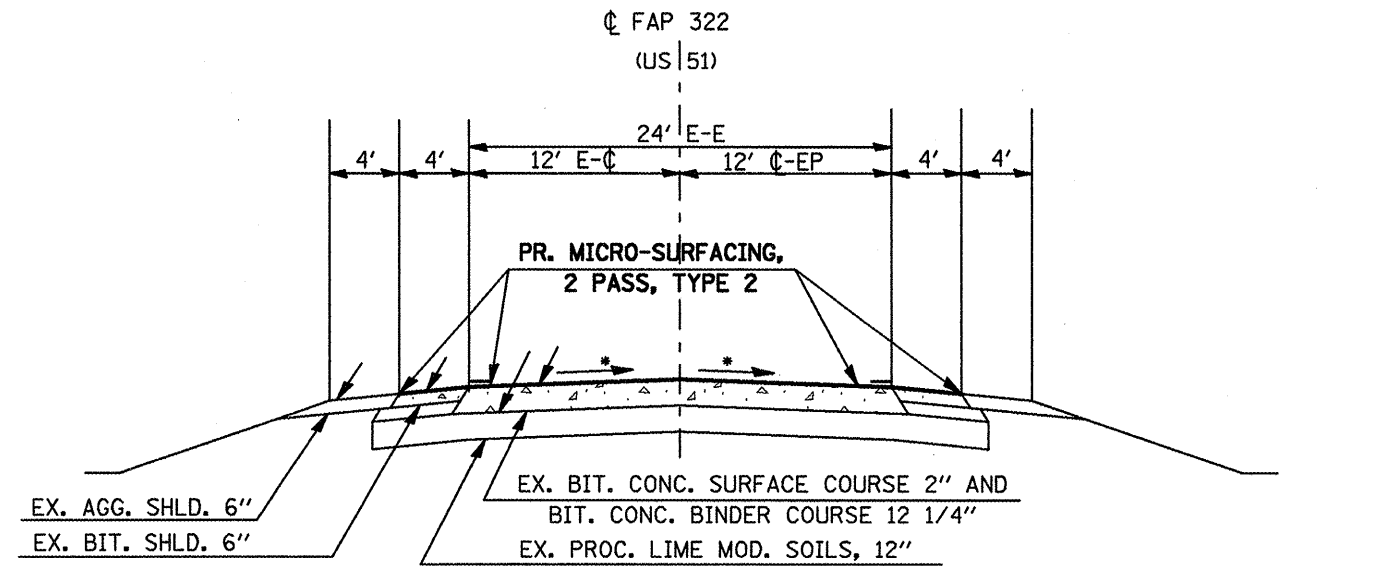

*MATCH EXISTING SLOPE.

TO BE USED:

- STA. 238+50 TO STA. 240+04.17 (154.17')
- STA. 3040+04.17 TO STA. 3073+50 (3345.83')
- STA. 3075+71 TO STA. 3101+03.20 (2532.2')
- STA. 304+62.66 TO STA. 365+98 (6135.34')

EQUATION STATIONS:

EQ. STA. 240+04.17 (BK.) = STA. 3040+04.17 (AH.)
 EQ. STA. 3101+03.20 (BK.) = STA. 304+62.66 (AH.)

OMISSION STATIONS:

STA. 3073+50 TO STA. 3075+71 (S.N. 091-0071)

LOCATION 2 TOTAL LENGTH = 13,434.54' = 2.54 MILES

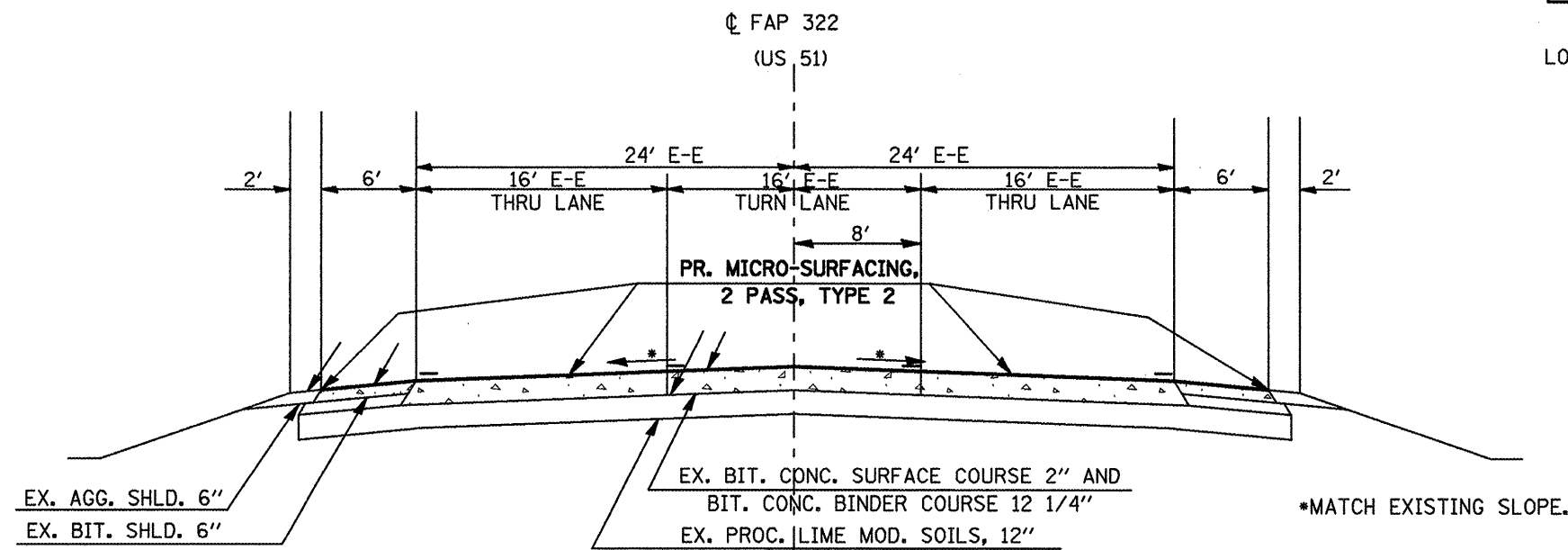

*MATCH EXISTING SLOPE.

TO BE USED:

- STA. 365+98 TO STA. 378+65 (1267.0')

PLOT DATE = 12/27/2007
 FILE NAME = c:\pavement\us51loc2\us51loc2.dgn
 USER NAME = mrcorcor

F.A.I. RTE.	SECTION	COUNTY	TOTAL SHEETS	SHEET NO.
*	**	***	22	9
STA. _____		TO STA. _____		
FED. ROAD DIST. NO. _____		ILLINOIS FED. AID PROJECT _____		

- * FAS 1909 & FAP 322
- ** D9 PAVEMENT PRESERVATION FY08
- *** JACKSON AND UNION COUNTIES

FAS 1909 (IL 127)
TYPICAL
LOCATION 3

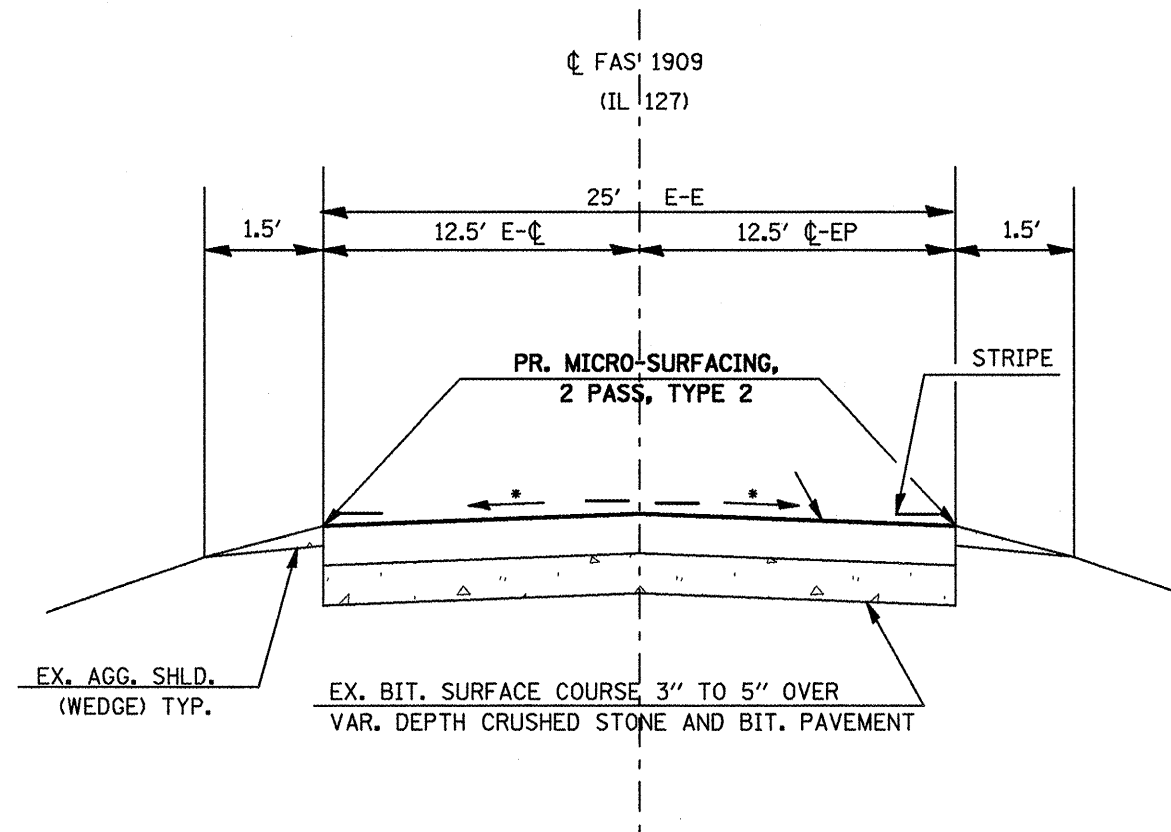

EX. AGG. SHLD.
(WEDGE) TYP.

EX. BIT. SURFACE COURSE 3" TO 5" OVER
VAR. DEPTH CRUSHED STONE AND BIT. PAVEMENT

TO BE USED:

- STA. 335+53 TO STA. 344+07.40 (854.4')
- STA. 6+06.70 TO STA. 79+77.70 (7371.0')
- STA. 80+07.70 TO STA. 138+96.20 (5888.5')
- STA. 139+83.10 TO STA. 227+32 (8748.9')

*MATCH EXISTING SLOPE.

EQUATION STATIONS:

- EQ. STA. 344+07.40 (BK.) = STA. 6+06.70 (AH.)
- EQ. STA. 79+77.70 (BK.) = STA. 80+07.70 (AH.)
- EQ. STA. 138+96.20 (BK.) = STA. 139+83.10 (AH.)

ILL. 127 TOTAL LENGTH = 22,862.8' = 4.33 MILES

F.A.I. RTE.	SECTION	COUNTY	TOTAL SHEETS	SHEET NO.
*	**	***	22	10

STA. _____ TO STA. _____
 FED. ROAD DIST. NO. - ILLINOIS FED. AID PROJECT

- * FAS 1909 & FAP 322
- ** D9 PAVEMENT PRESERVATION FY08
- *** JACKSON AND UNION COUNTIES

RESURFACING SCHEDULE

LOCATION - STATION TO STATION		LENGTH (FT)	ROADWAY WIDTH (FT)	ROADWAY AREA (SQ YD)	SHOULDER WIDTH (FT)	MICRO-SURF., 2 PASS. TY. 2 SHOULDER AREA	MICRO-SURF., 2 PASS. TY. 2 PAVEMENT AREA	BIT. MATLS. (PR. CT.) (SEE NOTE 2)	FIBER- ASPHALT (SEE NOTE 1)	NOTES
						(SQ YD)	(SQ YD)			
FAS 1090 (IL 127) LOCATION 3										
335+53	TO	344+07	854.4	25.0	2373		2373	213.6	610	AGG. SHLDS.
6+07	TO	79+78	7371.0	25.0	20,475		20475	1842.8	5,265	AGG. SHLDS.
80+08	TO	138+96	5888.5	25.0	16,357		16357	1472.1	4,206	AGG. SHLDS.
139+83	TO	227+32	8748.9	25.0	24,303		24,303	2187.2	6,250	AGG. SHLDS.
						0.0	63,508	5715.7	16,331	
FAP 322 (US 51) LOCATION 1										
1000+33	TO	1005+83	550.0	42.0	2567	4.0	489	2,567	786	
1000+33	TO	1010+00	967.0						345	LT. TURN LN. & MEDIAN ONLY
1005+83	TO	1010+23	440.0	33.0	1613	4.0	391	1,613	629	
1010+23	TO	1028+79	1856.0	24.0	4949	4.0	1650	4,949	2,651	
1028+79	TO	1031+10	231.0	30.0	770	4.0	205	770	330	
1028+79	TO	1044+78	1599.0						571	LT. TURN LN. & MEDIAN ONLY
1031+10	TO	1041+73	1063.0	36.0	4252	4.0	945	4,252	1,519	
1041+73	TO	1044+78	305.0	30.0	1017	4.0	271	1,017	436	
1044+78	TO	1047+56	278.0	24.0	741	4.0	247	741	397	
52+01.25	TO	103+30.75	5129.5	24.0	13,679	4.0	4560	13,679	7,328	BIT. SHLDS.
103+86.85	TO	118+04.60	1417.8	24.0	3780.7	4.0	1260	3,781	2,025	BIT. SHLDS.
2018+04.60	TO	2081+73.95	6369.4	24.0	16,985	4.0	5662	16,985	9,099	BIT. SHLDS.
187+61.39	TO	238+50.00	5088.6	24.0	13,570	4.0	4523	13,570	7,270	BIT. SHLDS.
						20,203	63,923	7571.3	33,386	
FAP 322 (US 51) LOCATION 2										
238+50	TO	240+04.17	154.2	24	411	4.0	137	411	49.3	BIT. SHLDS.
3040+04.17	TO	3073+50	3345.8	24.0	8922	4.0	2974	8922	4,780	BIT. SHLDS.
3075+71	TO	3101+03.20	2532.2	24	6753	4.0	2251	6753	3617	BIT. SHLDS.
304+62.66	TO	365+98	6135.3	24	16,361			16,361	4454	
365+98	TO	378+65	1267	32	4505			4505	834	
365+98	TO	371+98	600	8	533			533	179	TURN LANES
371+98	TO	378+65	667	16	1186			1186	238	TURN LANES
304+63	TO	374+78	7015			4.0	6236	561.2	5011	4' BIT. SHLDS.
374+73	TO	378+65	392			6.0	523	47.1	280	6' BIT. SHLDS.
						12,121	38,671	4571.2	19,613	
						50,792	17,858	69,330		
						198,426	17,858	69,330		

Note 1: Fiber-Asphalt is calculated using 1 lb. of material per 2.8 lineal foot. Then 2 strips on IL 127 locations and 4 strips on US 51 locations through the length of the project, unless otherwise noted on plans.

Note 2: Bituminous Materials (Prime Coat) quantity includes shoulder and pavement area.

PLOT DATE = 1/26/2008
 PLOT SCALE = 1/8" = 100'-0"
 USER NAME = mcorcor

FAP 322 (US 51) PAVEMENT MARKING SCHEDULE
LOCATION 1

F.A.I. RTE.	SECTION	COUNTY	TOTAL SHEETS	SHEET NO.
*	**	***	22	11
STA. _____ TO STA. _____				
FED. ROAD DIST. NO. _____ ILLINOIS FED. AID PROJECT				
* FAS 1909 & FAP 322				
** D9 PAVEMENT PRESERVATION FY08				
*** JACKSON AND UNION COUNTIES				

STATION TO STATION	PAINT PAVEMENT MARKING					THPL PAV'T MARKING	TEMPORARY			NOTES	
	4 INCH WHITE	4 INCH YELLOW	4 INCH SKIP-DASH YELLOW	12 INCH WHITE	24 INCH WHITE	LETTERS & SYMBOLS	4 INCH	12 INCH	24 INCH		LETTERS & SYMBOLS
	FOOT	FOOT	FOOT	FOOT	FOOT	SQ FT	FOOT	FOOT	FOOT	SQ FT	
US 51- STA. 1000+33 TO STA. 238+50											
RT 1000+41.0 TO 1000+56.0	82						82.0				ISLAND STRIPING
RT 1000+50.0 TO 1010+23.0				482.0				482.0			MEDIAN
RT 1000+56.0 TO 1001+09.0	3036				20.0		3,036		20.0		STOP BAR
RT 1001+09.0 TO 1031+44.5			407				407				EDGE LINE
RT 1011+64.0 TO 1027+93.0				84.0				84.0			MEDIAN
RT 1028+79.0 TO 1032+07.0	488						488				EDGE LINE
RT 1033+07.5 TO 1037+95.0	842						842				EDGE LINE
RT 1039+14.0 TO 1047+55.6				128.0				128.0			MEDIAN
RT 1039+93.0 TO 1044+78.0											
EQ STA 1047+55.55 (BK) = STA 52+01.25 (AH)											
RT 52+01.3 TO 103+30.8	5130						5130				EDGE LINE
RT 64+21.6 TO 71+91.0			192				192				
RT 72+47.0 TO 81+81.0			234				234				
EQ STA 103+30.75 (BK) = STA 103+86.85 (AH)											
RT 103+86.9 TO 118+04.6	1418						1418				EDGE LINE
RT 116+31.0 TO 118+04.6			43				43				
EQ STA 118+04.60 (BK) = STA 2018+04.60 (AH)											
RT 2018+04.6 TO 2081+74.0	6369		1592				7,962				EDGE LINE
EQ STA 2081+73.95 (BK) = STA 187+61.39 (AH)											
RT 187+61.4 TO 238+50.0	5,089						5,089				EDGE LINE
RT 187+61.4 TO 188+59.0			25				25				
RT 227+16.0 TO 238+50.0			284				284				
LT 1000+49.0 TO 1000+34.0					12.0				12.0		STOP BAR
LT 1000+34.0 TO 1000+46.0	78						78				ISLAND STRIPING
LT 1000+36.0 TO 1000+44.0					18.0				18.0		STOP BAR
LT 1000+44.0 TO 1000+94.0					16.0				16.0		STOP BAR
LT 1000+94.0 TO 1038+00.0	3,706						3,706				EDGE LINE
LT 1039+12.0 TO 1047+55.6	844						844				EDGE LINE
LT 52+01.3 TO 103+30.8	5130						5,130				EDGE LINE
LT 103+86.9 TO 118+04.6	1418						1,418				EDGE LINE
LT 2018+04.6 TO 2081+74.0	6369						6,369				EDGE LINE
LT 187+61.4 TO 238+50.0	5089						5,089				EDGE LINE
LT 1000+50.0 TO 1010+23.0		3,892					3,892				NO PASSING ZONE
LT 1010+23.0 TO 1011+64.0		282					282				NO PASSING ZONE
LT 1027+93.0 TO 1028+79.0		172					172				NO PASSING ZONE
LT 1028+79.0 TO 1032+07.0		1312					1,312				NO PASSING ZONE
LT 1032+50.0 TO 1038+20.0		1140					1,140				NO PASSING ZONE
LT 1038+93.0 TO 1039+93.0		200					200				NO PASSING ZONE
LT 1039+93.0 TO 1044+78.0		1940					1,940				NO PASSING ZONE
LT 1044+78.0 TO 1047+55.6		278					278				NO PASSING ZONE
LT 52+01.3 TO 72+47.0		2046					2,046				NO PASSING ZONE
LT 81+81.0 TO 103+30.8		2150					2,150				NO PASSING ZONE
LT 103+86.9 TO 118+04.6		1418					1,418				NO PASSING ZONE
LT 2018+04.6 TO 2020+16.0		211					211				NO PASSING ZONE
LT 188+59.0 TO 238+19.0		4960					4,960				NO PASSING ZONE
RT 1044+78.0 TO 1047+55.6		278					278				NO PASSING ZONE
RT 52+01.3 TO 64+21.6		1220					1,220				NO PASSING ZONE
RT 71+91.0 TO 103+30.8		3140					3,140				NO PASSING ZONE
RT 103+86.9 TO 116+31.0		1244					1,244				NO PASSING ZONE
RT 2071+57.0 TO 2081+74.0		1017					1,017				NO PASSING ZONE
RT 187+61.4 TO 227+16.0		3955					3,955				NO PASSING ZONE
LT 1000+50.0 TO 1003+13.0	263.0						263.0				TURN LANE
LT 1032+50.0 TO 1034+50.0	200.0						200.0				TURN LANE
RT 1037+20.0 TO 1038+20.0	100.0						100.0				TURN LANE
LT 1038+93.0 TO 1039+93.0	100.0						100.0				TURN LANE
LT 1001+17.0 TO 1001+45.0						15.6				15.6	LT TURN ARROW
LT 1002+67.0 TO 1002+95.0						20.8				20.8	"ONLY"
LT 1034+06.0 TO 1034+34.0						15.6				15.6	LT TURN ARROW
RT 1037+30.0 TO 1037+58.0						20.8				20.8	"ONLY"
LT 1039+47.0 TO 1039+75.0						15.6				15.6	LT TURN ARROW
						20.8				20.8	"ONLY"
SUB-TOTALS	45,751	30,855	2,777	694.0	66.0	182.0	79,383	694.0	66.0	182.0	
TOTALS AT US 51 LOCATION 1		79,383		694	66	182.0	79,383	694	66	182.0	

DATE = 10/27/2007
FILE NAME = c:\pavmark\mca_090407\mca09p
PLOT SCALE = 1/8"=1'-0"
USER = mcoorndr

F.A.I. RTE.	SECTION	COUNTY	TOTAL SHEETS	SHEET NO.
*	**	***	22	12
STA. _____		TO STA. _____		
FED. ROAD DIST. NO. _____ ILLINOIS FED. AID PROJECT				

FAP 322 (US 51) PAVEMENT MARKING SCHEDULE
LOCATION 2

- FAS 1909 & FAP 322
- D9 PAVEMENT PRESERVATION FY08
- JACKSON AND UNION COUNTIES

STATION TO STATION	PAINT PAVEMENT MARKING					THPL PAV'T MARKING	TEMPORARY				NOTES	
	4 INCH WHITE	4 INCH YELLOW	4 INCH SKIP-DASH YELLOW	12 INCH WHITE	24 INCH WHITE	LETTERS & SYMBOLS	4 INCH	12 INCH	24 INCH	LETTERS & SYMBOLS		
	FOOT	FOOT	FOOT	FOOT	FOOT	SQ FT	FOOT	FOOT	FOOT	SQ FT		
US 51- STA. 238+50 TO STA. 378+65												
LT & RT	238+50.0				240+04.2							EDGE LINE
EQ STA 240+04.17 (BK.) = STA. 3040+04.17 (AH.)												
LT & RT	3040+04.2				3051+50.0							
	3040+04.2				3073+50.0							EDGE LINE
	3058+28.0				3073+50.0							
OMIT SN 091-0071 STA. 3073+50 TO STA. 3075+71												
LT & RT	3075+71.0				3097+65.0							
	3075+71.0				3101+03.2							EDGE LINE
	3098+84.0				3101+03.2							
EQ STA 3101+03.20 (BK.) = STA. 304+62.66 (AH.)												
LT	304+62.7				331+78.0							
RT	304+62.7				374+80.0							EDGE LINE
	304+62.7				374+13.0							
	344+67.0				367+07.0							
LT	375+63.0				378+65.0							
RT	376+44.3				378+65.0							EDGE LINE
LT	3051+50.0				3069+31.0							NO PASSING ZONE
LT	3097+65.0				313+29.0							NO PASSING ZONE
LT	331+78.0				344+85.0							NO PASSING ZONE
LT	365+98.0				366+98.0							NO PASSING ZONE
LT	366+98.0				373+78.0							NO PASSING ZONE
LT	373+78.0				374+78.0							NO PASSING ZONE
LT	375+73.0				376+73.0							LEFT TURN LANE
RT	3041+83.0				3058+28.0							NO PASSING ZONE
RT	3087+30.0				3098+84.0							NO PASSING ZONE
RT	321+09.0				334+67.0							NO PASSING ZONE
RT	365+98.0				366+98.0							
RT	366+98.0				373+78.0							
RT	366+98.0				373+78.0							NO PASSING ZONE
RT	373+78.0				374+78.0							LEFT TURN LANE
RT	375+73.0				376+73.0							NO PASSING ZONE
RT	376+73.0				378+65.0							NO PASSING ZONE
RT	373+88.0											"ONLY"
RT	374+16.0											LT TURN ARROW
LT	376+27.0											LT TURN ARROW
LT	376+55.0											"ONLY"
SUB-TOTALS												
TOTALS AT US 51 LOCATION 2												

FAP 322 (US 51) PAVEMENT MARKING SCHEDULE
TOTALS FOR LOCATION 1 AND LOCATION 2

TOTALS AT US 51 LOCATIONS 1 & 2	PAINT PVT MRK - LINE 4"	PAINT PVT MRK - LINE 12"	PAINT PVT MRK - LINE 24"	THPL PVT MRK - LTR & SYM	TEMP PVT MRK - LINE 4"	TEMP PVT MRK - LINE 12"	TEMP PVT MRK - LINE 24"	TEMP PVT MRK - LTR & SYM
	FOOT	FOOT	FOOT	SQ FT	FOOT	FOOT	FOOT	SQ FT
	121, 224.0	1, 133.0	66.0	254.8	121, 224.0	1, 133.0	66.0	254.8

PLOT DATE = 10/27/2007
 FILE NAME = I:\PROJECTS\18017\18017.dgn
 PLOT SCALE = 1/8"=1'-0"
 USER NAME = masonr

F.A.I. RTE.	SECTION	COUNTY	TOTAL SHEETS	SHEET NO.
*	**	***	22	13
STA. _____		TO STA. _____		
FED. ROAD DIST. NO. _____		ILLINOIS FED. AID PROJECT		

- FAS 1909 & FAP 322
- D9 PAVEMENT PRESERVATION FY08
- JACKSON AND UNION COUNTIES

FAS 1909 (IL 127) PAVEMENT MARKING SCHEDULE
LOCATION 3

STATION TO STATION	PAINT PAVEMENT MARKING			TEMPORARY	NOTES
	4 INCH WHITE	4 INCH YELLOW	4 INCH SKIP-DASH YELLOW	4 INCH	
	FOOT	FOOT	FOOT	FOOT	
IL 127 - STA. 335+53 TO STA. 227+32					
LT & RT 335+53.0 TO 344+07.4	1,709			1,709	Edge Line
EQ STA 344+07.4 (BK.) = STA. 6+06.7 (AH.)					
LT & RT 6+06.7 TO 79+77.7	14,742			14,742	Edge Line
EQ STA 79+77.7 (BK.) = STA. 80+07.7 (AH.)					
LT & RT 80+07.7 TO 138+96.2	11,777			11,777	Edge Line
EQ STA 138+96.2 (BK.) = STA. 139+83.1 (AH.)					
LT & RT 139+83.1 TO 227+32.0	17,498			17,498	Edge Line
LT 335+53.0 TO 22+71.2		2,519		2,519	No Passing Zone
LT 31+76.9 TO 131+96.1		9,989		9,989	No Passing Zone
LT 142+64.7 TO 186+77.4		4,413		4,413	No Passing Zone
LT 195+93.5 TO 227+32.0		3,139		3,139	No Passing Zone
RT 335+53.0 TO 12+72.7		1,520		1,520	No Passing Zone
RT 23+05.5 TO 118+55.0		9,520		9,520	No Passing Zone
RT 128+73.6 TO 176+59.3		4,699		4,699	No Passing Zone
RT 185+92.2 TO 227+32.0		4,140		4,140	No Passing Zone
			476	476	
			255	255	
			982	982	
			933	933	
			916	916	
SUB-TOTALS	45,726	39,939	3,562	89,227	
TOTALS		89,227		89,227	

PLOT DATE = 12/27/07
 FILE NAME = C:\p1909\1801Z\1801Z.dgn
 PLOT SCALE = 1/8" = 1'-0"
 USER NAME = moore-dt

F.A. IN RTE.	SECTION	COUNTY	TOTAL SHEETS	SHEET NO.
*	**	***	22	14
STA.		TO STA.		
FED. ROAD DIST. NO. ILLINOIS FED. AID PROJECT				
* FAS 1909 & FAP 322 ** D9 PAVEMENT PRESERVATION FY08 *** JACKSON AND UNION COUNTIES				

US 51 LOCATIONS 1 & 2
RAISED REFLECTIVE PAVEMENT MARKERS

IL 127 LOCATION 3
RAISED REFLECTIVE PAVEMENT MARKERS

STATION TO STATION					RAISED REF PAVT MARKERS			NOTES
					CLEAR - ONE WAY	AMBER - ONE WAY	AMBER - TWO WAY	
					EACH	EACH	EACH	
US 51 LOCATION 1- STA. 1000+33 TO STA. 238+50								
	1000+34.0	TO		1000+46.0	3			PAINTED ISLAND
LT	1000+44.0	TO	LT	1003+13.0	8			LANE LINE
RT	1000+41.0	TO	RT	1000+56.0	3			PAINTED ISLAND
	1000+50.0	TO		1010+23.0		53		MEDIAN
	1010+23.0	TO		1011+64.0			8	CENTERLINE
	1011+64.0	TO		1027+93.0			21	CENTERLINE
	1027+93.0	TO		1028+79.0			6	CENTERLINE
	1028+79.0	TO		1032+07.0		20		MEDIAN
RT	1032+50.0	TO	LT	1038+20.0			32	MEDIAN
LT	1032+50.0	TO	LT	1034+50.0	4			LANE LINE
RT	1037+20.0	TO	RT	1038+20.0	6			LANE LINE
LT	1038+93.0	TO	LT	1039+93.0	4			LANE LINE
RT	1038+93.0	TO	RT	1039+93.0			8	
RT	1039+93.0	TO		1044+78.0		22		MEDIAN
	1044+78.0	TO		1047+55.6			16	
EQ STA 1047+55.55 (BK) = STA 52+01.25 (AH)								
	52+01.3	TO		64+21.6			63	CENTERLINE
	64+21.6	TO		81+81.0			23	CENTERLINE
	81+81.0	TO		103+30.8			28	CENTERLINE
EQ STA 103+30.75 (BK) = STA. 103+86.85 (AH)								
	103+86.9	TO		116+31.0			17	
	116+31.0	TO		118+04.6			3	CENTERLINE
EQ STA 118+04.60 (BK.) = STA. 2018+04.60 (AH.)								
	2018+04.6	TO		2081+74.0			81	CENTERLINE
EQ STA 2081+73.95 (BK) = STA 187+61.39 (AH)								
	187+61.4	TO		238+50.0			65	CENTERLINE
SUBTOTAL LOCATION 1					28	95	370	
TOTAL LOCATION 1							493	
US 51 LOCATION 2 - STA. 238+50 TO STA. 378+65								
	238+50.0	TO		240+04.2			3	CENTERLINE
EQ STA 3040+04.17 (BK) = STA 3073+50 (S.N. 091-0071)								
	3040+04.2	TO		3073+50.0			43	CENTERLINE
OMIT S.N. 091-0071 STA. 3073+50 TO STA. 3075+71								
	3075+71.0	TO		3101+03.2			33	CENTERLINE
EQ STA 3101+03.02 (BK) = STA. 304+62.66 (AH)								
	304+62.7	TO		365+98.0			78	CENTERLINE
	365+98.0	TO	LT	366+98.0			10	CENTERLINE
	366+98.0	TO	LT	374+78.0		36		MEDIAN
RT	373+78.0	TO	RT	374+78.0	4			LANE LINE
LT	375+73.0	TO	LT	376+73.0	4			
RT	375+73.0	TO		378+65.0		18		MEDIAN
SUBTOTAL LOCATION 2					8	54	167	
TOTAL LOCATION 2							229	
TOTALS AT US 51 LOCATION 2						722		

STATION TO STATION	RAISED REF PAVT MARKS		NOTES		
	AMBER - TWO WAY FOOT				
	IL 127 - STA. 335+53 TO STA. 227+32				
	335+53.0	TO	344+07.4	12	Centerline
EQ STA 344+07.4 (BK.) = STA. 6+06.7 (AH.)					
	6+06.7	TO	79+77.7	93	Centerline
EQ STA 79+77.7 (BK.) = STA. 80+07.7 (AH.)					
	80+07.7	TO	138+96.2	75	Centerline
EQ STA 138+96.2 (BK.) = STA. 139+83.1 (AH.)					
	139+83.1	TO	227+32.0	110	Centerline
TOTAL			290		

PLOT DATE = 1/24/2008
 PLOT SCALE = 1/8"=1'-0"
 USER NAME = mcorcor

F.A.I. RTE.	SECTION	COUNTY	TOTAL SHEETS	SHEET NO.
*	**	***	22	15
STA. _____		TO STA. _____		
FED. ROAD DIST. NO. _____		ILLINOIS FED. AID PROJECT _____		

- FAS 1909 & FAP 322
- D9 PAVEMENT PRESERVATION FY08
- JACKSON AND UNION COUNTIES

FAP 322 (US 51) LOCATION 1 & 2 MAP
FROM INTERSECTION OF IL 146 SOUTH
TO THE CONNECTOR FOR FAI 57

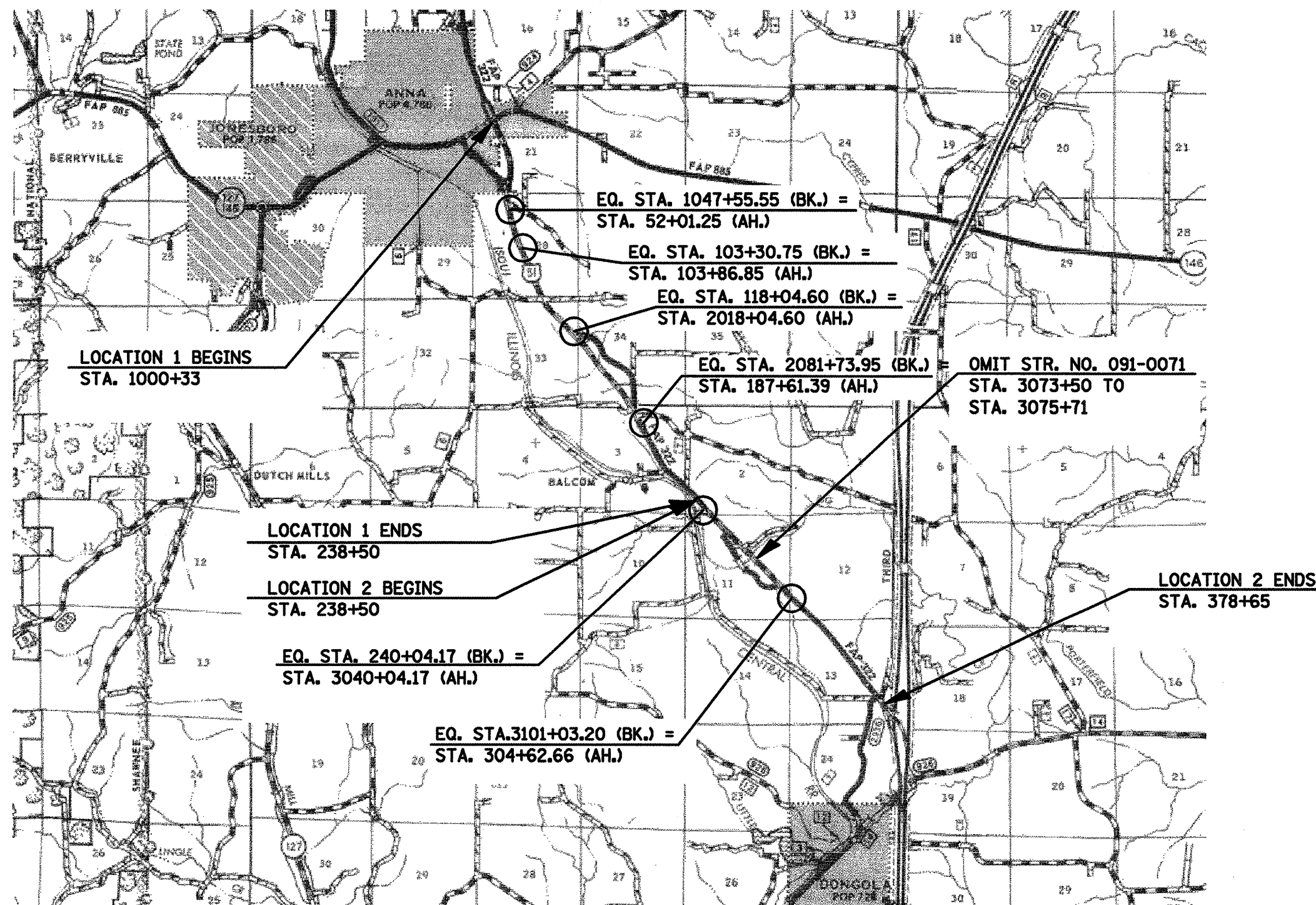

DATE = 10/07/08
 FILE NAME = C:\Users\mva\Documents\FAP322\mva.dgn
 PLOT SCALE = 1/8" = 100'
 USER = mva

F.A.I. RTE.	SECTION	COUNTY	TOTAL SHEETS	SHEET NO.
*	**	***	22	16
STA. _____ TO STA. _____				
FED. ROAD DIST. NO. _____ ILLINOIS		FED. AID PROJECT		

FAS 1909 (IL 127) LOCATION MAP
FROM TOMCAT HILL LN. TO JACKSON/UNION CO. LINE

- FAS 1909 & FAP 322
- ** D9 PAVEMENT PRESERVATION FY08
- *** JACKSON AND UNION COUNTIES

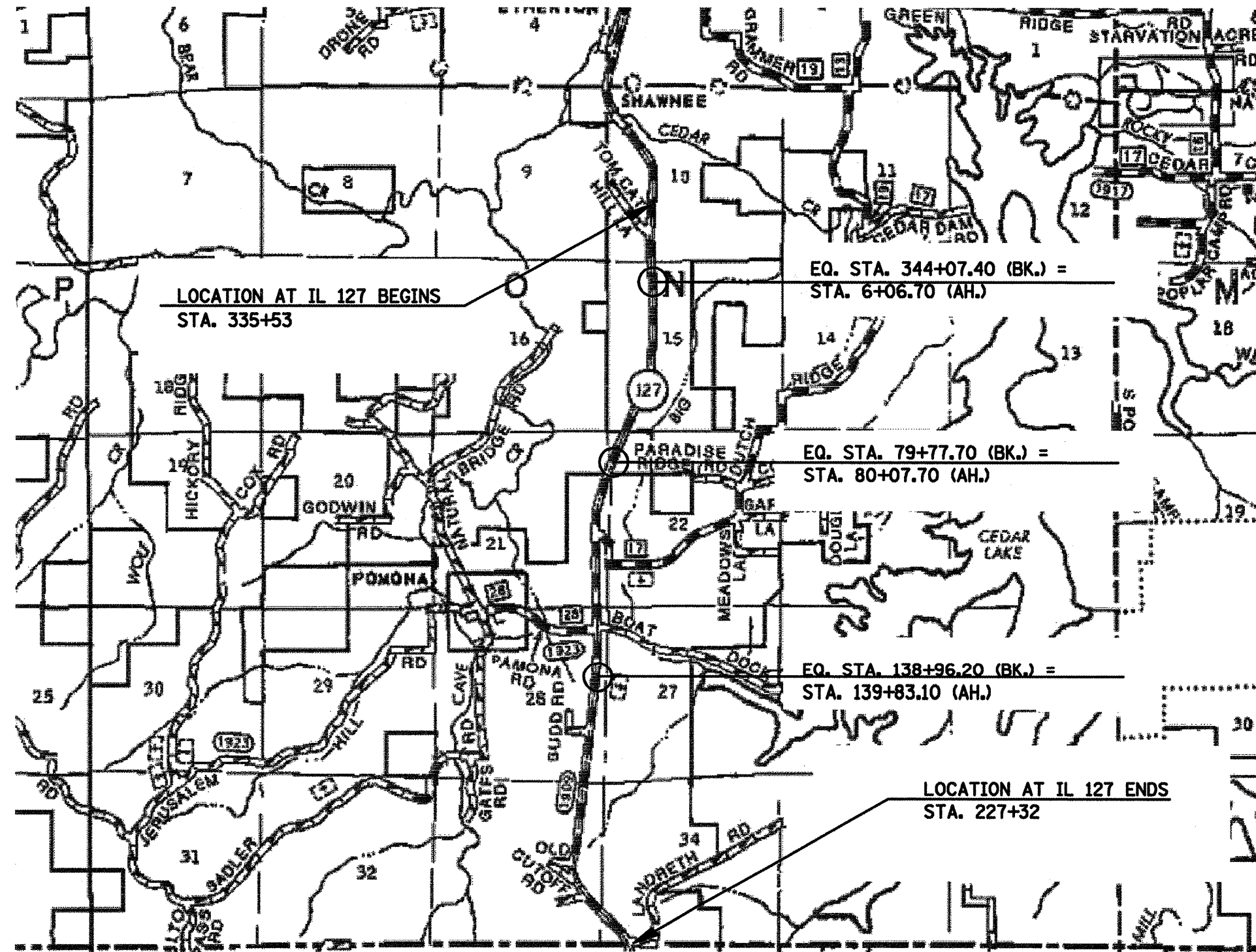

DATE: 12/27/2007
 USER: j...
 PLOT SCALE: 1/8" = 100'
 USER NAME: j...

F.A.I. RTE.	SECTION	COUNTY	TOTAL SHEETS	SHEET NO.
2	22	JACKSON AND UNION	22	17
STA. 1000+00 TO STA. 1010+44		ILLINOIS FED. AID PROJECT		

- FAS 1909 & FAP 322
- D9 PAVEMENT PRESERVATION FY08
- JACKSON AND UNION COUNTIES

DETAIL OF LANE WIDTHS

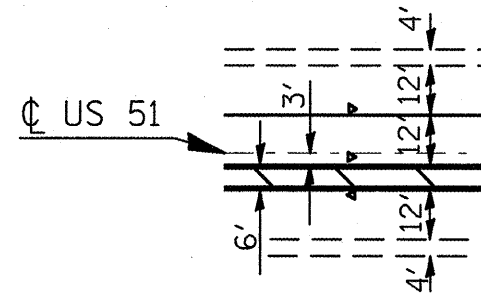

PAVEMENT MARKING DETAIL
FAP 322 (US 51) LOCATION 1
STA. 1000+33 TO STA. 1010+44

PAINTED ISLAND DETAIL
SOUTHEAST QUAD

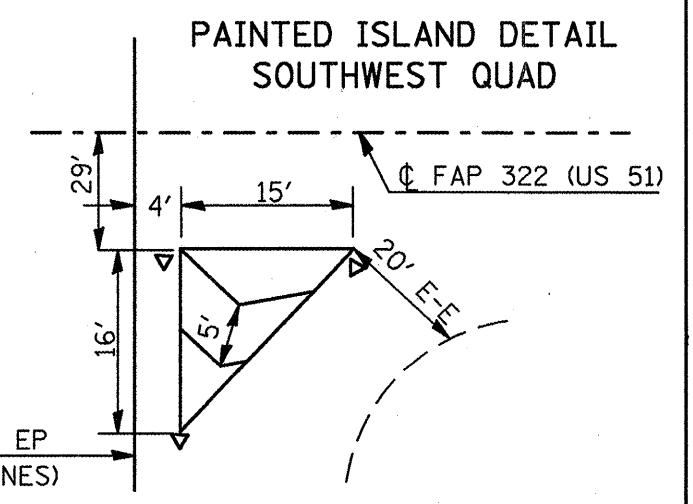
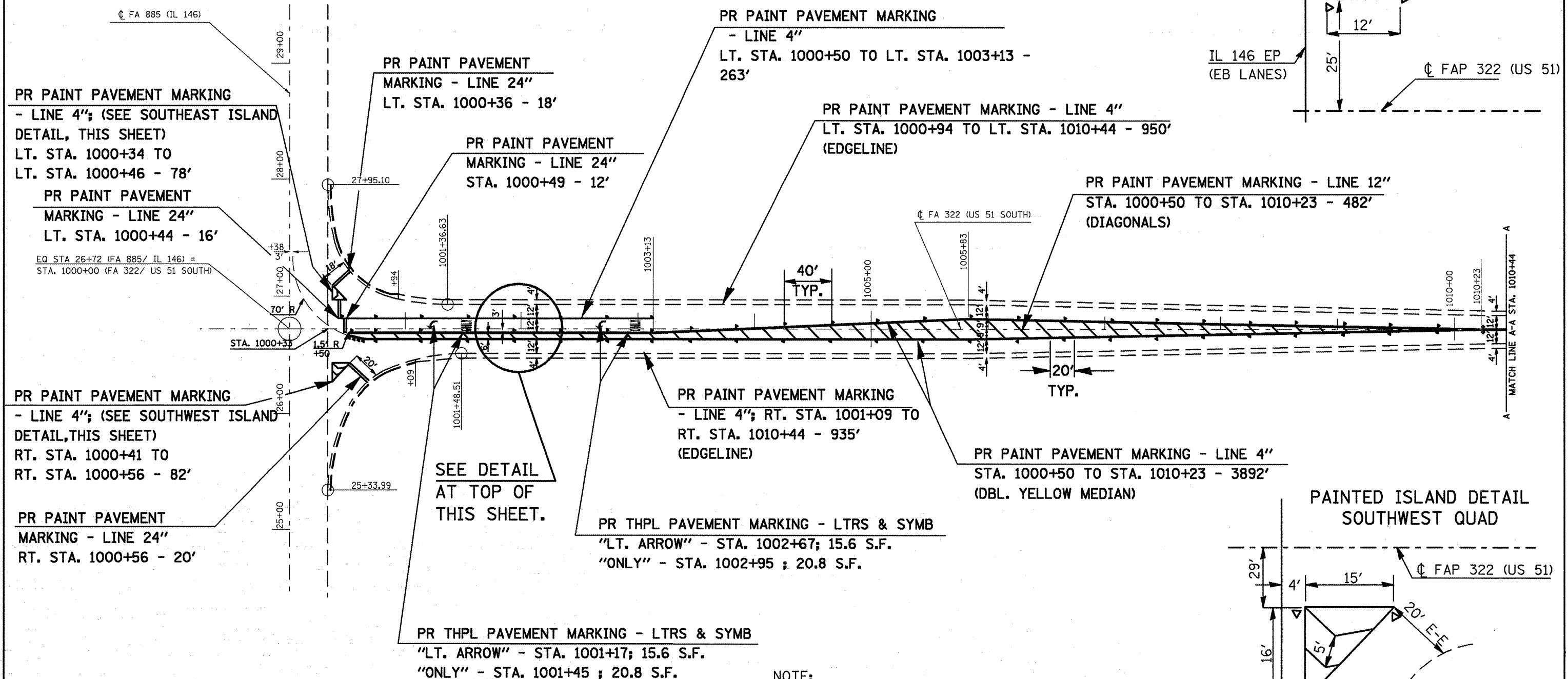
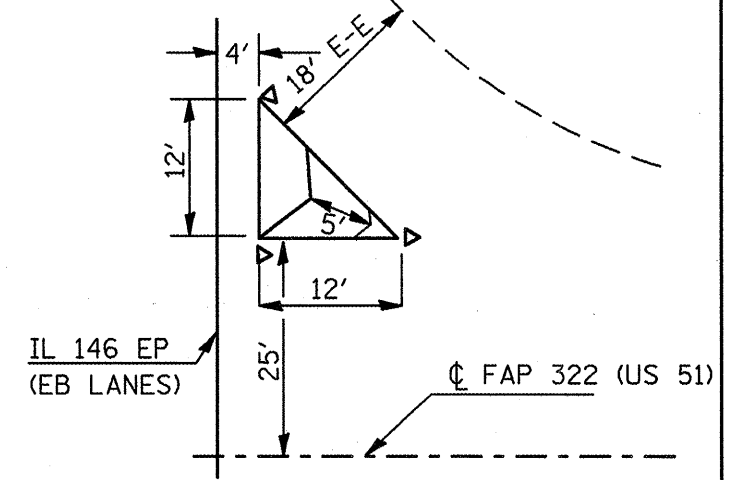

DATE = 1/24/2008
SCALE = 1" = 40'
USER NAME = m...
PLOT SCALE = 1" = 40'
PLOT USER = m...

F.A.L. RTE.	SECTION	COUNTY	TOTAL SHEETS	SHEET NO.
2	02	003	22	18
STA. _____		TO STA. _____		
FED. ROAD DIST. NO. - ILLINOIS FED. AID PROJECT				

PAVEMENT MARKING DETAIL
 FAP 322 (US 51) LOCATION 1
 STA. 1010+44 TO STA. 1022+39

- FAS 1909 & FAP 322
- D9 PAVEMENT PRESERVATION FY08
- JACKSON AND UNION COUNTIES

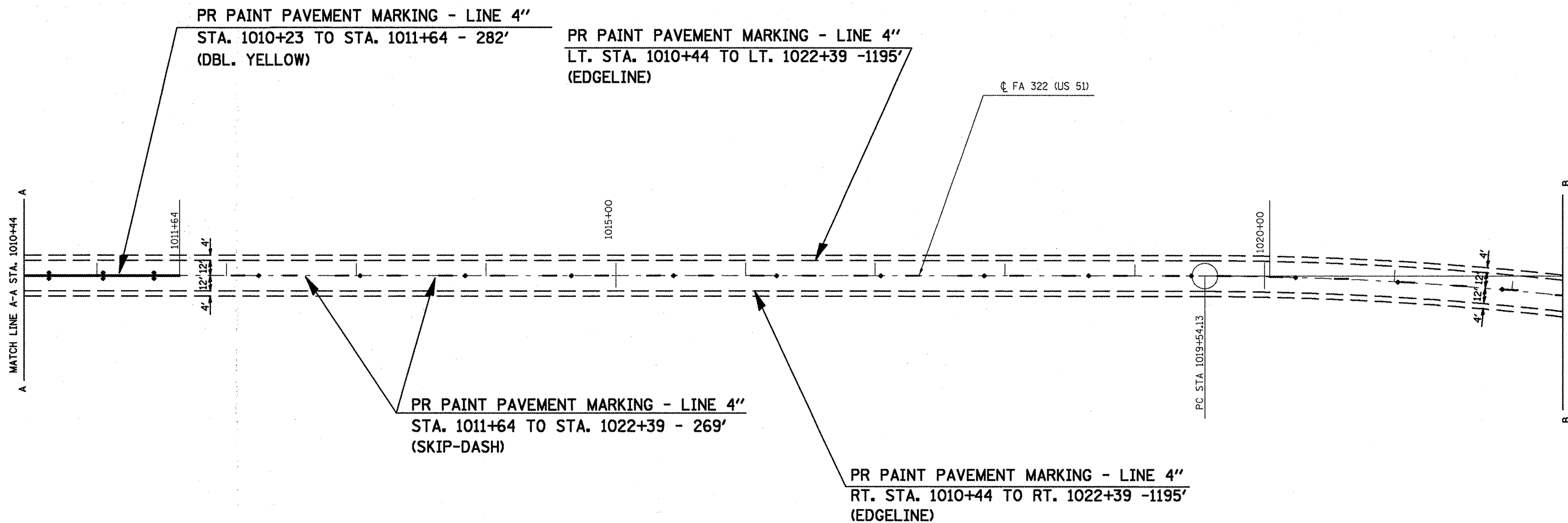

NOTE:
 FOR RAISED REFLECTIVE PAVEMENT MARKERS,
 SEE SCHEDULE ON SHEET 14.

PLOT DATE = 1/24/2008
 PLOT SCALE = 1/4" = 100'
 USER NAME = mrcvdr

F.A.I. RTE.	SECTION	COUNTY	TOTAL SHEETS	SHEET NO.
*	**	***	22	19
STA. _____ TO STA. _____				
FED. ROAD DIST. NO. - ILLINOIS FED. AID PROJECT				

- FAS 1909 & FAP 322
- D9 PAVEMENT PRESERVATION FY08
- JACKSON AND UNION COUNTIES

PAVEMENT MARKING DETAIL
 FAP 322 (US 51) LOCATION 1
 STA. 1022+39 TO STA. 1036+00

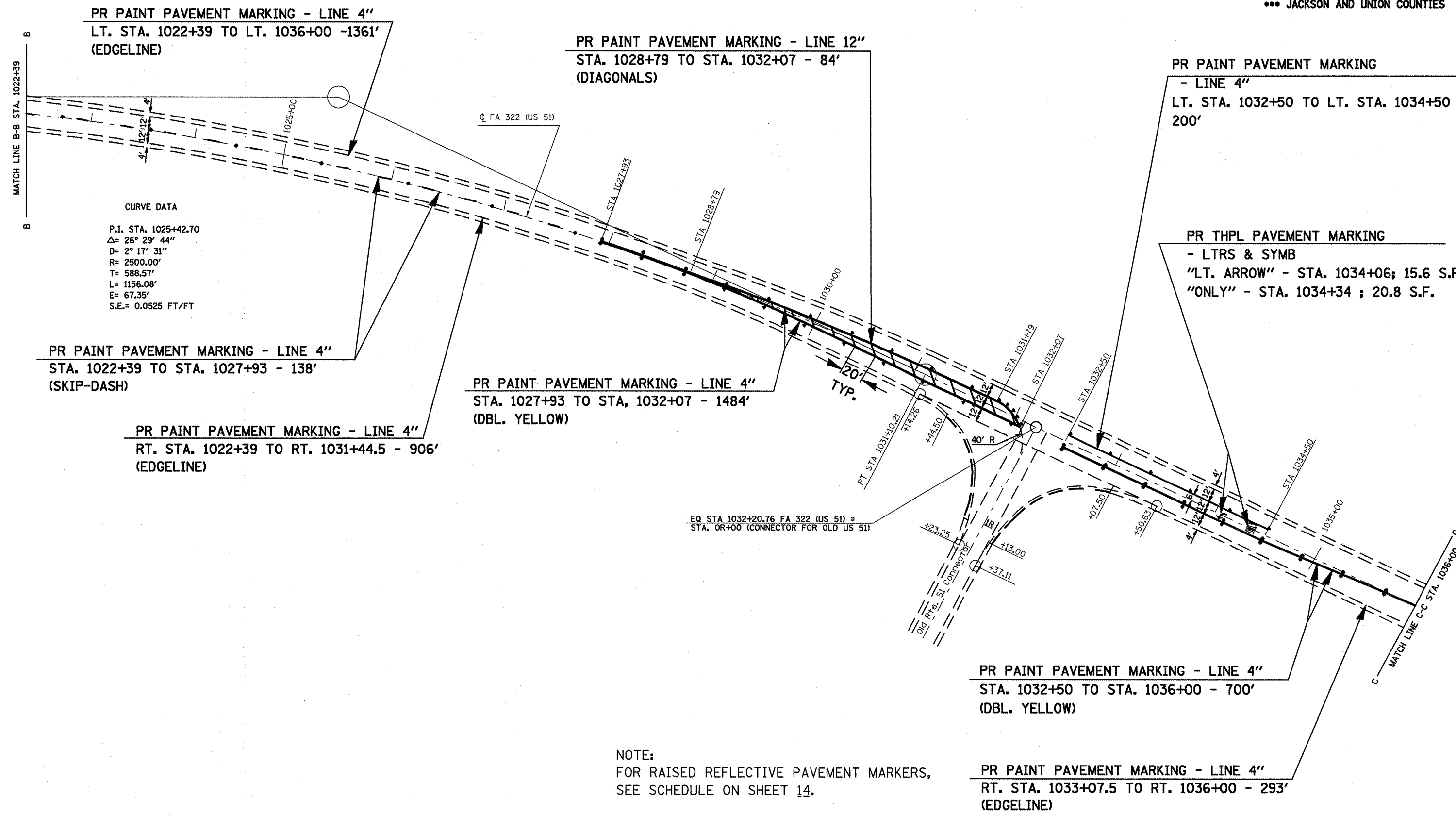

DATE = 1/24/2008
 FILE NAME = \\sawyer\proj\687\mso.dgn
 PLOT SCALE = 8.7283 / IN.
 USER NAME = msoanddr

F.A.I. RTE.	SECTION	COUNTY	TOTAL SHEETS	SHEET NO.
*	**	***	22	20
STA. _____		TO STA. _____		
FED. ROAD DIST. NO. - ILLINOIS FED. AID PROJECT				

- FAS 1909 & FAP 322
- D9 PAVEMENT PRESERVATION FY08
- JACKSON AND UNION COUNTIES

PAVEMENT MARKING DETAIL
 FAP 322 (US 51) LOCATION 1
 STA. 1036+00 TO STA. 1047+55.55

PR PAINT PAVEMENT MARKING - LINE 4"
 STA. 1036+00 TO STA. 1038+20 - 440'
 (DBL. YELLOW)

PR PAINT PAVEMENT MARKING - LINE 4"
 LT. STA. 1036+00 TO LT. STA. 1038+00 - 200'
 (EDGE LINE)

PR THPL PAVEMENT MARKING
 - LTRS & SYMB
 "ONLY" - STA. 1037+30 ; 20.8 S.F.
 "LT. ARROW" - STA. 1037+58; 15.6 S.F.

CURVE DATA
 P.I. STA. 1043+13.91
 $\Delta = 20^\circ 27' 49''$
 $D = 2^\circ 17' 31''$
 $R = 2500.00'$
 $T = 451.26'$
 $L = 892.90'$
 $E = 40.40'$
 $S.E. = 0.0525 \text{ FT/FT}$

PR PAINT PAVEMENT MARKING
 - LINE 4"
 LT. STA. 1038+93 TO LT. STA. 1039+93 - 100'

PR PAINT PAVEMENT MARKING - LINE 4"
 LT. STA. 1039+12 TO LT. STA. 1047+55.55 - 844'
 (EDGE LINE)

PR PAINT PAVEMENT MARKING - LINE 4"
 STA. 1038+93 TO STA. 1047+55.55 - 2418'
 (DBL. YELLOW MEDIAN)

PR PAINT PAVEMENT MARKING - LINE 4"
 RT. STA. 1037+20 TO RT. STA. 1038+20 - 100'

PR PAINT PAVEMENT MARKING - LINE 4"
 RT. STA. 1036+00 TO RT. STA. 1037+95 - 195'
 (EDGE LINE)

PR THPL PAVEMENT MARKING
 - LTRS & SYMB
 "LT. ARROW" - STA. 1039+47; 15.6 S.F.
 "ONLY" - STA. 1039+75 ; 20.8 S.F.

PR PAINT PAVEMENT MARKING - LINE 12"
 STA. 1039+93 TO STA. 1044+78 - 128'
 (DIAGONALS)

PR PAINT PAVEMENT MARKING - LINE 4"
 RT. STA. 1039+14 TO RT. STA. 1047+55.55 - 842'
 (EDGE LINE)

NOTES:
 FOR RAISED REFLECTIVE PAVEMENT MARKERS,
 SEE SCHEDULE ON SHEET 14.
 FOR PAVEMENT MARKING BEYOND
 STATION 52+01.25,
 SEE SCHEDULE ON SHT. 12.

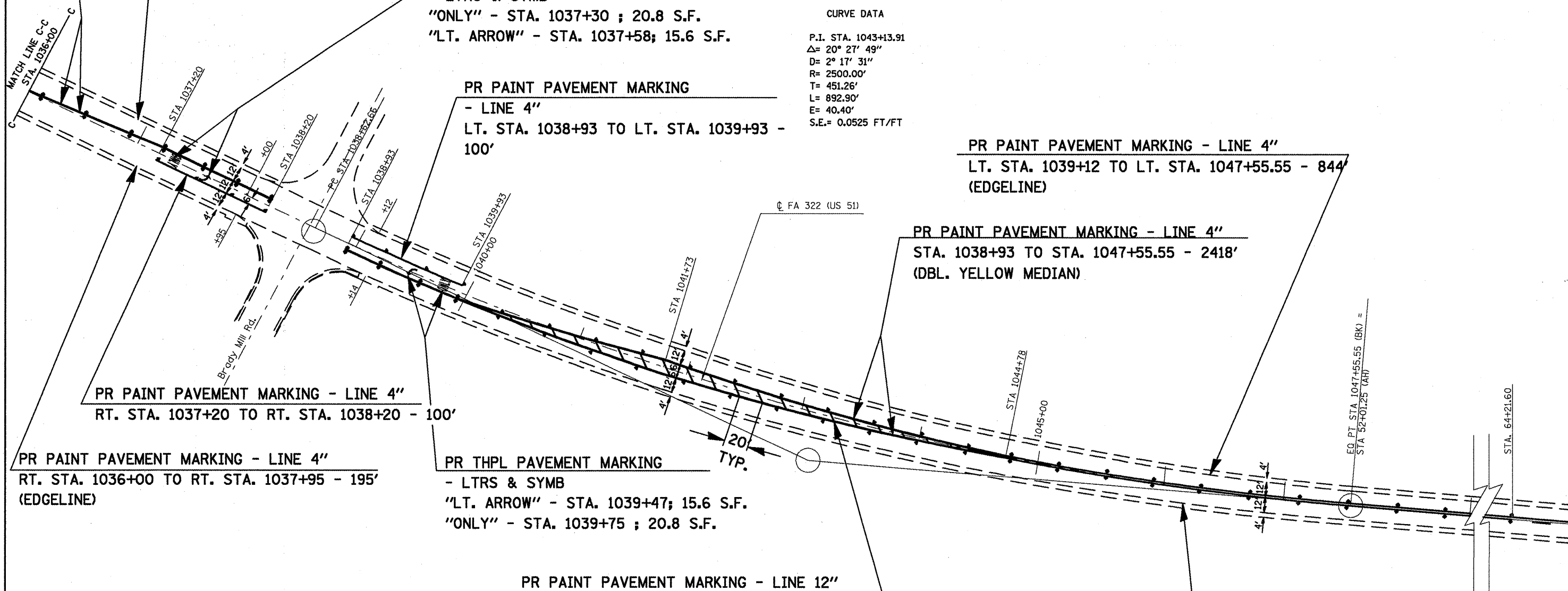

PLOT DATE = 1/24/2008
 FILE NAME = c:\pavement\78017\msoedgn
 USER NAME = msoedgn

F.A.I. RTE.	SECTION	COUNTY	TOTAL SHEETS	SHEET NO.
*	**	***	22	21
STA. _____ TO STA. _____				
FED. ROAD DIST. NO. ILLINOIS FED. AID PROJECT				

- FAS 1909 & FAP 322
- ** D9 PAVEMENT PRESERVATION FY08
- *** JACKSON AND UNION COUNTIES

PAVEMENT MARKING DETAIL
 FAP 322 (US 51) AT LOCATION 2
 STA. 365+98 TO STA. 378+65

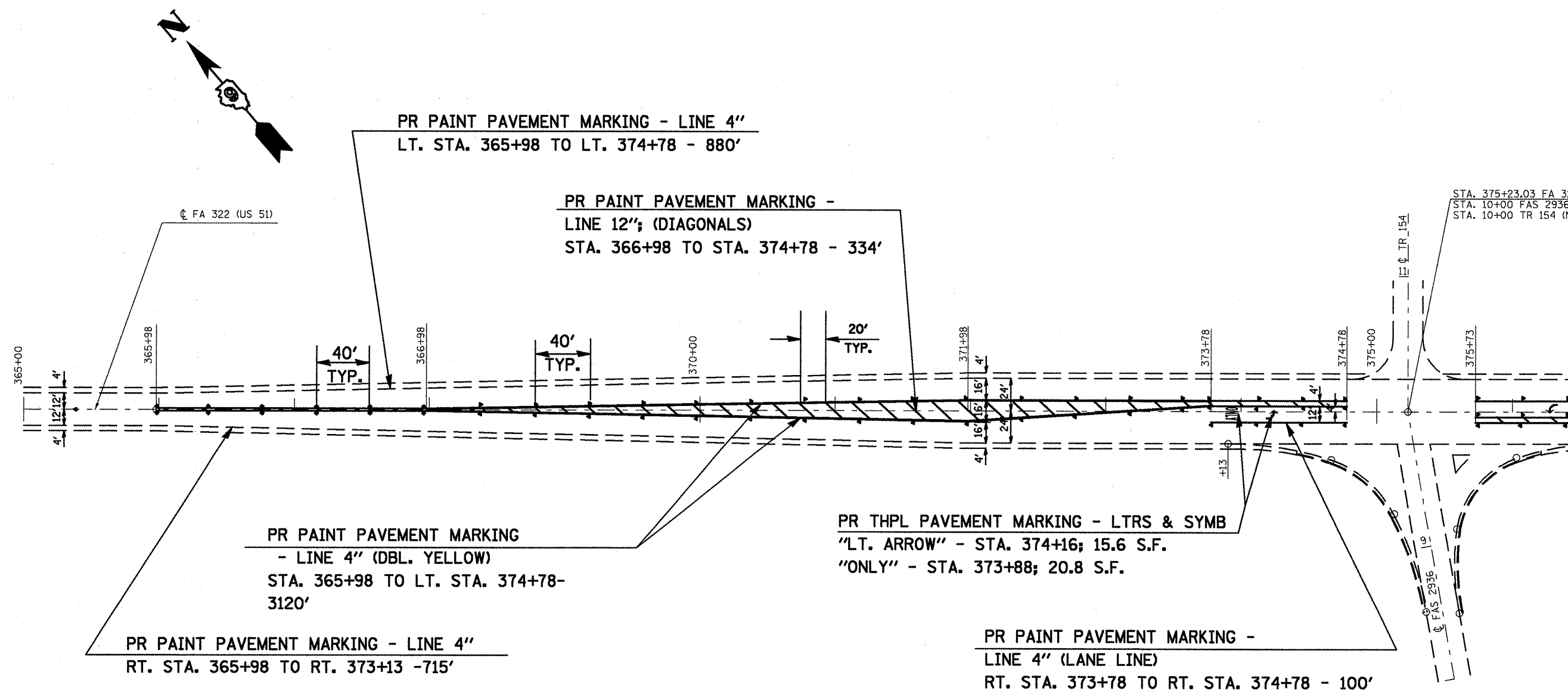

STA. 375+23.03 FA 322 (US 51)=
 STA. 10+00 FAS 2936 (DONGOLA SPUR SOUTH)
 STA. 10+00 TR 154 (NORTH)

PR PAINT PAVEMENT MARKING
 - LINE 4" (DBL. YELLOW)
 STA. 365+98 TO LT. STA. 374+78-
 3120'

PR THPL PAVEMENT MARKING - LTRS & SYMB
 "LT. ARROW" - STA. 374+16; 15.6 S.F.
 "ONLY" - STA. 373+88; 20.8 S.F.

PR PAINT PAVEMENT MARKING -
 LINE 4" (LANE LINE)
 RT. STA. 373+78 TO RT. STA. 374+78 - 100'

NOTES:
 FOR RAISED REFLECTIVE PAVEMENT MARKERS,
 SEE SCHEDULE ON SHEET 14.
 FOR PAVEMENT MARKING BEFORE STATION 365+98,
 SEE SCHEDULE ON SHT. 12.

DATE: 1/24/2008
 FILE NAME: 0817001.dwg
 PLOT SCALE: 1/8" = 1'-0"
 USER: mcorcoran

F.A.I. RTE.	SECTION	COUNTY	TOTAL SHEETS	SHEET NO.
..	22	22

STA. _____ TO STA. _____
 FED. ROAD DIST. NO. _____ ILLINOIS FED. AID PROJECT

- FAS 1909 & FAP 322
- D9 PAVEMENT PRESERVATION FY08
- JACKSON AND UNION COUNTIES

PAVEMENT MARKING DETAIL
 FAP 322 (US 51) AT LOCATION 2
 STA. 365+98 TO STA. 378+65

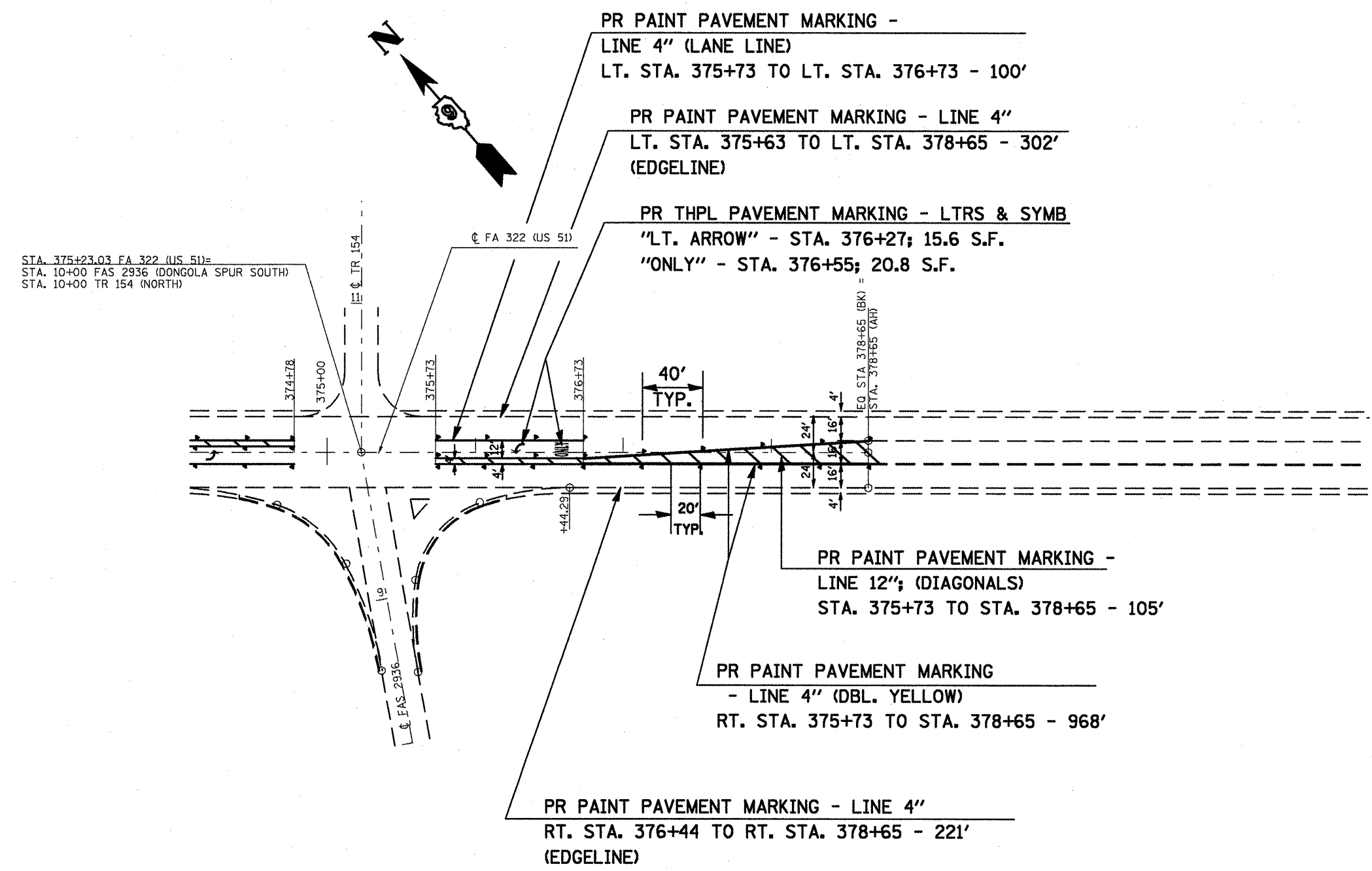

NOTE:
 FOR RAISED REFLECTIVE PAVEMENT MARKERS,
 SEE SCHEDULE ON SHEET 14.

PLT DATE = 1/24/2008
 PLT NAME = [unreadable]
 PLT SCALE = 84.7893 1/1 IN.
 USER NAME = [unreadable]